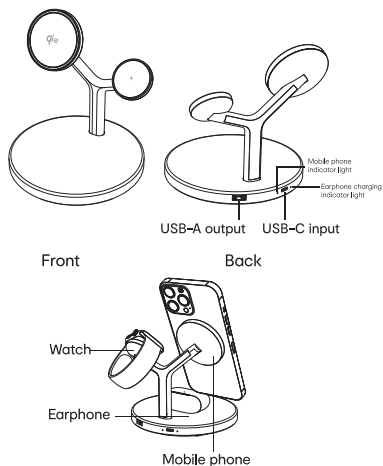

120 mm

anko**DESKTOP WIRELESS CHARGER****User Manual****EWL-22111-B****K: 43-555-499 | T: 71-011-295****1. Device Lay-out**

Front

Back

Watch

Earphone

Mobile phone

2. Includes

- (1) 3 in 1 desktop wireless charger
- (2) USB-C to USB-C charging cable
- (3) User manual

3. Technical specifications**USB-C input:** 5V \Rightarrow 3A, 9V \Rightarrow 3A**Magnetic mobile phone wireless charging output:**

5W/7.5W/10W/15W (iPhone) MAX

15W Max for iPhone12 or above models

10W Max for compatible Samsung phones

15W Max for other compatible Android models

Earphone wireless charging output: 5W MAX**Magnetic watch wireless charging output:** 2W MAX**USB-A output:** 5V \Rightarrow 1A**Total maximum output:** 22W**Charging efficiency:** \leq 75%**Transmission distance:** \leq 6MM*5V \Rightarrow 3A is minimum input for operation, 9V \Rightarrow 3A is for maximum input.*When the input is 5V \Rightarrow 3A, the maximum output is 12W, which cannot support charging three or four devices at the same time.**4. LED Color indication****(1) Standby:** The indicator light will stay on in red.**(2) On charging:** The indicator light will stay on in blue.**(3) Fully Charged:** The indicator light will stay on in blue.**(4) Foreign Object Detection:**

The indicator light will flash in red-blue.

5. Operating instruction

- (1) Plug in the charging cable, the wireless charger indicator will stay on in red.
- (2) Place your wireless charging enabled device on the charging pad to start charging.
- (3) To ensure efficient charging, a complicant charger is required (sold separately).
- (4) When the product to be charged is placed on the charger, the corresponding indicator light will change from red to blue. When fully charged, the indicator light will stay on in blue.
- (5) If the product is removed from the charger, the corresponding indicator light will turn red to be standby mode;

Front

118 mm

(6) If a foreign object is placed on the charging pad, the indicator light will flash red and blue. At this moment, the wireless charging function stops, and the foreign object needs to be removed.

6. Notes

- (1) Do not disassemble or throw it into fire or water to avoid damage.
- (2) Do not use the wireless charger in extremely hot, humid, or corrosive environments to avoid circuit damage and leakage.
- (3) Do not place it too close to magnetic stripe or chip cards (ID cards, credit cards, etc.) to avoid magnetic interference or data loss.
- (4) Please keep a distance of at least 30cm between implantable medical devices (pacemakers, implantable cochlear devices, etc.) and the wireless charger to avoid potential interference with the medical device.
- (5) To ensure the safety of children, make sure they do not play with the wireless charger as a toy.
- (6) Make sure there is no metal foreign object between the charging pad and the phone when charging.

* 12 Month Warranty

Thank you for your purchase.

Your new product is warranted to be free from defects in materials and workmanship for the period stated above, from the date of purchase, provided that the product is used in accordance with accompanying recommendations or instructions where provided. This warranty is in addition to your rights under the Australian Consumer Law. For New Zealand customers, this warranty is in addition to statutory rights observed under New Zealand legislation.

We will provide you with your choice of a refund, repair (where possible) or exchange (availability dependent) for this product if it becomes defective within the warranty period. The business will bear the reasonable expense of claiming the warranty. This warranty will no longer apply where the defect is a result of alteration, accident, misuse, abuse or neglect.

Please retain your receipt as proof of purchase and contact our Customer Service Centre as listed below, for the entity you purchased this product from, for any difficulties with your product. Warranty claims and claims for expense incurred in returning this product can be addressed to the respective Customer Service Centre.

Our goods come with guarantees that cannot be excluded under the Australian Consumer Law. You are entitled to a replacement or refund for a major failure and compensation for any other reasonably foreseeable loss or damage.

You are also entitled to have the goods repaired or replaced if the goods fail to be of acceptable quality and the failure does not amount to a major failure.

Contact for Kmart purchases	Contact for Target purchases
Kmart Australia Ltd. C/- Customer Service Centre 690 Springvale Road, Mulgrave Vic 3170 Customer Service: 1800 124 125 (Australia) or 0800 945 995 (New Zealand) or via Customer Help at kmart.com.au	Target Australia Pty Ltd C/- Customer Service Centre 2 Kendall Street, Williams Landing, Vic. 3027 Customer Service: 1300 753 567 or via Customer Help at target.com.au/help/contact-us

Back