

147x210mm 2024. 4. 26

# anko

## Air Styler

### INSTRUCTION MANUAL



**Model No.: BY-816**

Please read this instruction manual before using your product and keep it in a safe place for future reference. If you pass the appliance on to anyone else, please include this manual.

#### **INTRODUCTION**

---

Use this appliance to style human hair only. Do not use this appliance on artificial hair or animals.

**IMPORTANT! The appliance may have different results depending on the hair type. Therefore, we recommend to trial at a hidden area of hair before first use. The Air Styler is not recommended for damaged or bleached hair.**

#### **SAFETY PRECAUTIONS**

---

- Carefully read all instructions before operation and retain for future reference.
- Do not place air styler near the edge of a bench or table during operation
- Ensure the surface is dry, level, clean and free of liquid and other substances.
- Do not leave the appliance unattended when in use. Always ensure the appliance is turned OFF by switching OFF and unplugging the appliance from mains power when not in use, if left unattended and before cleaning and storing.
- Always keep the appliance clean.
- Fully unwind the cord before use.
- To protect against electric shock, do not immerse the power cord, plug or appliance in water or any other liquid.
- Do not allow the cord to hang over the edge of the table or bench, touch hot surfaces or become knotted.
- This appliance is not intended for use by persons (including children) with reduced physical, sensory or mental capabilities, or lack of experience and knowledge, unless they have been given supervision or instructions concerning use of the appliance by a person responsible for their safety.
- Children should be supervised to ensure that they do not play with this appliance.
- If the supply cord shows any signs of damage, DO NOT use. For electrical safety, any repairs to the product must be carried out by qualified electrical person only or the product must be disposed to avoid a hazard.
- This product is intended for household use only. Do not use it outdoors. Not for commercial purposes.
- NEVER grasp the appliance, power cable or power plug with wet hands.
- Always remove the power cable from the socket by pulling on the plug; do not pull on the cable itself. Do not hold or carry the appliance with the power cord.
- Do not fold or crush the power cable. Ensure that the power cable does not run over sharp edges.
- Please do not attempt to dismantle the appliance. This appliance has no user-serviceable parts inside.
- When the appliance is used in a bathroom, unplug it after use since the proximity of water presents an electrical safety hazard even when the appliance is switched OFF.
- Do not use outdoors or operate where aerosol (spray) products are being used or where oxygen is being administered.
- For additional protection, the installation of a residual current device (RCD/ Safety switch) having a rated residual operating current not exceeding 30mA is advisable in the electrical circuit supplying the power outlet socket in the bathroom. If unsure, check with an electrician.
- **DANGER OF ELECTRIC SHOCK!** Do not insert any foreign objects into the appliance.

- Do not use any accessories not supplied with this product.
- The appliance is not intended to be operated by means of an external timer or separate remote-control system.
- Always keep the hair away from the rear grille of the appliance. Hair may be sucked into the rear of the appliance causing a blockage.
- Never cover or block the rear grille of the appliance. This may lead to overheating. If the rear grille becomes blocked, stop using the appliance immediately and clear the blockage.
- Ensure the brush attachment is free to blockages. Unrestricted airflow is required for correct operation and to prevent overheating.
- The brush attachment will become hot during use. Allow it to cool before removing it.
- For user maintenance, please refer to “Cleaning and Maintenance” section.

#### **RISK OF FIRE**

- Do not leave the appliance unattended when in use.
- To avoid a build-up of heat, NEVER cover the appliance. Do not use the appliance under a blanket or at other poorly ventilated locations
- Avoid the addition of heat from other sources, e.g., from direct sunlight, heating appliances, other devices, etc.
- Do not use an extension cable. In the event of danger, the power cord plug must be quickly and easily accessible.

#### **ELECTRICAL REQUIREMENT**

- Check that the voltage on the rating plate of your appliance corresponds with your house electricity supply which must be 220V-240V AC.

#### **IMPORTANT**

- The plug removed from the mains lead, if severed, must be destroyed as a plug with bared flexible cord is hazardous if connected into a ‘live’ power outlet socket.
- If the supply cord is damaged, DO NOT use. Any repairs to the product must be carried out by qualified electrical person only or the product must be disposed.



**Danger of suffocation! Keep all packaging material away from children. Dispose of the packaging materials in an appropriate way. Contact your local authorities about collection points or waste separation.**



**Caution Risk of Burning! The appliance gets very hot! Take care to avoid contact between the hot surfaces of the unit and skin, paying particular attention to the face, neck, chest and hands.**



**WARNING: Do not use this appliance near bathtubs, showers, basins or other vessels containing water.**



Class II Appliance

**The air styler is for household use only. Not designed for commercial use.**

## PARTS

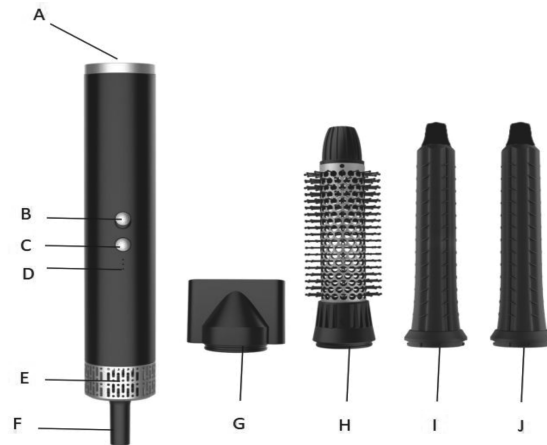

- |                        |                       |
|------------------------|-----------------------|
| A. Air Out             | F. Power cord         |
| B. On/Off switch       | G. Hair drying nozzle |
| C. Heat setting button | H. Styling brush      |
| D. Indicator lamp      | I. Left curling iron  |
| E. Air inlet grille    | J. Right curling iron |

## BEFORE FIRST USE

- After unpacking the appliance, check for transport damage and that all the parts mentioned in this manual are present. In the event of damaged or missing parts, return the product back to Kmart.
- Do not discard the original box. It can be used for storage and dispatch to avoid transport damage.
- Clean the appliance as described under the heading Cleaning and Care. For your safety make particular attention to the safety instructions supplied in the user manual.

## Changing Attachment

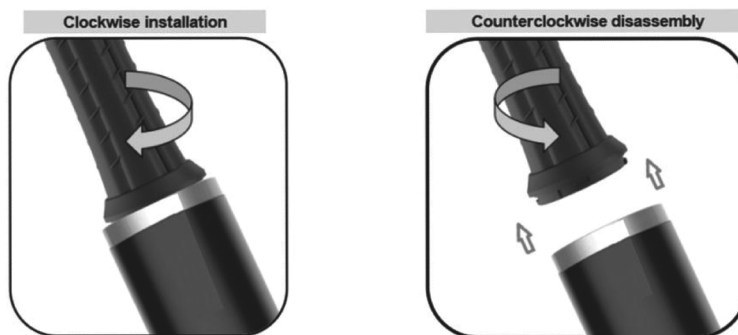

**Hair drying nozzle attachment (G):** to remove excessive moisture pre-styling.  
**Styling Brush attachment (H):** to lift hair to give volume, to help achieve curls and waves.  
**Left/Right curling iron attachment (I & J):** to create fluffy natural curl.

## OPERATION

- The Hair Styler combines the benefits of hair styling and drying in one appliance.
- To use the Hair Styler, fully unwind the mains cable. Make sure the ON/Off Switch is in OFF (0) position.
- Place the appliance on a smooth, flat, dry surface, plug-in and switch on at the mains supply.
- Select the desired attachment head. Use the high heat setting for initial drying, and the low heat setting as the hair begins to dry and for styling.
- Use the cool setting to set the style for longer lasting results after drying and styling.
- Press the Temperature setting button to adjust desired setting:  
GREEN light – COOL & Hi speed  
YELLOW – HOT & Lo speed  
RED – HOT & Hi speed

### Using Brush attachment

- Make sure your hair is 80% dry. Place the appliance into the hair, close to the roots.
- Move the brush through the hair towards the ends. When reach the end of the section, start to rotate the brush inward to make the root lift.
- For even more volume, wind the entire section of the hair around the comb part until you reach the root. Leave the brush in the hair for a few seconds.
- When finished drying or styling, switch the appliance OFF, unplug and allow it to cool down before putting it down or storing.

**IMPORTANT!** Always place the air curler on a heat resistant surface to avoid heat damage to the bench/table surface.

### Using Curling Iron

- Make sure your hair is 80% dry. Choose the appropriate barrel to determine the direction of curls.



- Divide your hair into upper and lower sections. Grasp a section of hair with 4-5cm width, leaving the ends free, ensuring they hang loosely.
- Place the styler behind the hair ends then switch on the styler. Allow hair automatically wrap around at the middle of the barrel.



- When the ends have wrapped around, release the hair section and slowly position the barrel near the roots, allowing the hair to effortlessly wrap around itself. Avoid twisting the styler.
- Hold the barrel in position for 10 seconds, followed by a 10 second of COOL air blow.
- Until your hair is dry to ensure the ideal curve, switch off the styler and gently pull down to unveil the curls.
- Repeat this process to complete your styling.

#### UNBLOCKING THE AIR INLET GRILLE

---

- If during use, the air inlet grille becomes clogged or blocked with dust or dirt, clean the grille.
- Disconnect the appliance from mains power.
- Rotate to unlock the grille. Use a lint-free cloth or soft brush to clean the dust and hair on the grille. After cleaning, refit the air inlet grille, make sure its locked in place.

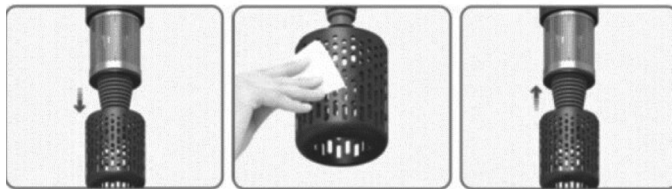

- The grille should be cleaned at least once a month
- Clean the appliance unit with a soft, slightly damp cloth. Make sure that no moisture has entered the appliance during cleaning.

#### Self-cleaning function

1. Switch the air styler off.
2. Press and hold the Temperature setting button (approx. 5sec) to activate the self-cleaning function.
3. The air styler blows air in the opposite direction through the filter.  
Note: Make sure the air inlet and outlet area are free of obstacles.
4. The self-cleaning process takes around 10 seconds.
5. After the cleaning process is completed, refit the air inlet grille.

#### CLEANING AND MAINTENANCE

---

- **Attention!** Turn OFF the appliance before cleaning by disconnecting the supply cord plug from the mains power outlet socket.
- **Attention!** Do not use any alcohol, acetone, gasoline, abrasive cleaning agents, etc. to clean the plastic components. Do not use hard brushes or metal objects for cleaning.
- Risk of burning! Do not clean the appliance while still hot.
- Wipe the appliance with a dry cloth.
- Never submerge the appliance in water or let water run over the heating plates on the appliance.
- Clean the air inlet opening from time to time with a fine brush.

**STORAGE**

---

- Store the appliance in a cool, dry location, away from children and pets.
- If the appliance is not used for an extended period, store it preferably in its original packaging.
- After use do not wrap the cord around the appliance as in time this may cause the cord to fracture. Coil cord loosely by the side of the appliance during storage.

**DISPOSAL**

---

- Do not dispose this product with normal household waste collection. If unsure, contact the local council waste management service for proper disposal facilities available for your area.

**TECHNICAL DATA**

---

Model: BY-816

Voltage: 220-240V

Frequency: 50-60Hz

Power: 1500W

## 12 Month Warranty

Thank you for your purchase.

Your new product is warranted to be free from defects in materials and workmanship for the period stated above, from the date of purchase, provided

that the product is used in accordance with accompanying recommendations or instructions where provided. This warranty is in addition to your rights under the Australian Consumer Law.

For New Zealand customers, this warranty is in addition to statutory rights observed under New Zealand legislation.

We will provide you with your choice of a refund, repair (where possible) or exchange (availability dependent) for this product if it becomes defective within

the warranty period. The business will bear the reasonable expense of claiming

the warranty.

This warranty will no longer apply where the defect is a result of alteration, accident, misuse, abuse or neglect.

Please retain your receipt as proof of purchase and contact our Customer Service Centre as listed below, for the entity you purchased this product from, for any difficulties with your product. Warranty claims and claims for expense incurred in returning this product can be addressed to the respective Customer Service Centre.

Our goods come with guarantees that cannot be excluded under the Australian Consumer Law. You are entitled to a replacement or refund for a major failure and compensation for any other reasonably foreseeable loss or damage. You are also entitled to have the goods repaired or replaced if the goods fail to be of acceptable quality and the failure does not amount to a major failure.

Contact for Kmart purchases	Contact for Target purchases
Kmart Australia Ltd. C/- Customer Service Centre 690 Springvale Road, Mulgrave Vic 3170 Customer Service: 1800 124 125 (Australia) or 0800 945 995 (New Zealand) or via Customer Help at <a href="http://kmart.com.au">kmart.com.au</a>	Target Australia Pty Ltd C/- Customer Service Centre 2 Kendall Street, Williams Landing, Vic, 3027 Customer Service: 1300 753 567 or via Customer Help at <a href="http://target.com.au/help/contact-us">target.com.au/help/contact-us</a>