

# 2.4GHz

## ►►► INSTRUCTION MANUAL

Thank you for choosing our product! Please read this instruction manual carefully before using, as it contains all the information you need to know about how to use this product correctly.

Colours And Contents May Vary From Illustration.

## BUMPER CARS

REMOTE CONTROL EJECTING BUMPER CARS



### Contents

- RC Vehicle x2
- Transmitter x2
- Instruction Manual x1
- USB cable x2

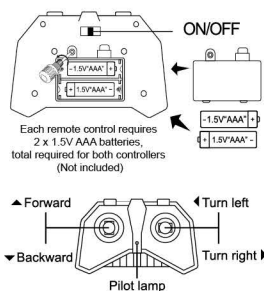
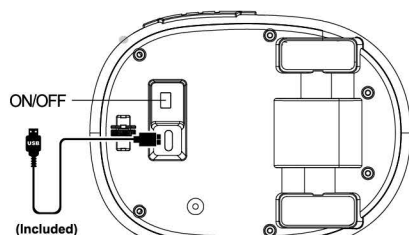

### How to pair

1. Turn on the power switch of the bumper car and then turn on the remote control.
2. When the light of the transmitter is flashing it means it is pairing.
3. If the light is on and not flashing that means the pairing has been successful.
4. If the pairing process is not completed within 8 seconds, please shut down the vehicle restart the pairing process with the remote control.
5. If you have two or more bumper cars, please pair them one by one.

Regarding frequency, when the second bumper car is on the opposite frequency, always maintain the first bumper car and remote control are in the 'on' state.

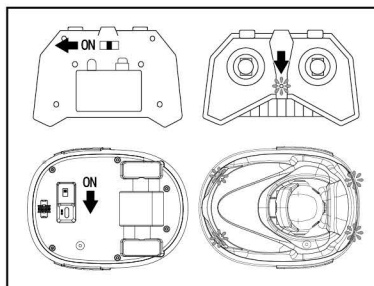

### Disassembly and installation instructions for dolls

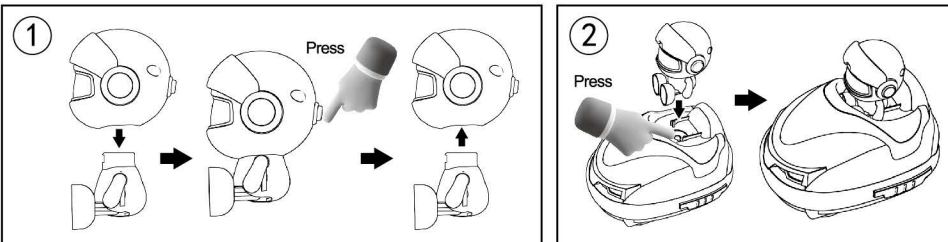

### How to play

#### 1. Forward

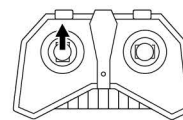

Push the left control stick up, the vehicle moves forward; if you continue to push the left control stick up, the vehicle will keep moving forward.

#### 2. Backward

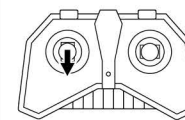

Push the left control stick down, the vehicle moves backward; if you continue to push the left control stick down, the vehicle will keep moving backward.

#### 3. Turn left

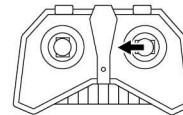

Push the right control stick to the left, the vehicle turns left; if you continue to push the right control stick to the left, the vehicle will keep turning left. This allows for continuous circles to the left.

#### 4. Turn right

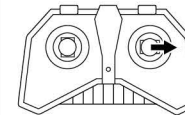

Push the right control stick to the right, the vehicle turns right; if you continue to push the right control stick to the right, the vehicle will keep turning right. This allows for continuous circles to the right.

#### 5. Ejection function

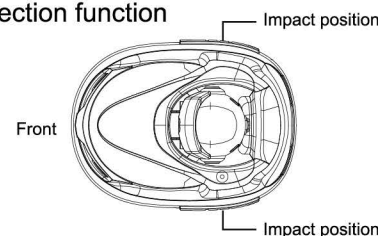

There are collision positions on both sides of the remote control car. When the remote control car collides with other vehicles, the remote control car figurine will be ejected, the body and its head will separate when falling to the ground.

### CAUTION

When the car is in motion, do not touch the wheels by hand to avoid damaging the cars.



Do not play in a place with puddles, mud or sand.



Do not play on the roads or in any other dangerous places to avoid accidents.

### BATTERY SAFETY

- (1) The placement or replacement of batteries is to be performed by an adult.
- (2) Remove the rechargeable battery from the chassis before charging.
- (3) Always remove exhausted batteries from the car and the transmitter.
- (4) Make sure the main switch is set to OFF before installing the battery pack into the car body.
- (5) Batteries must be inserted with the correct polarity.
- (6) Non-chargeable batteries shall not be recharged.
- (7) Do not short-circuit the batteries.
- (8) Always remove the batteries from the car and the transmitter after playing.
- (9) Never throw the batteries into fire to avoid explosion or leakage.
- (10) Do not mix batteries from different producers or new and old batteries.
- (11) You should only use batteries of the same or equivalent types as recommended.
- (12) Check the batteries on a regular basis to avoid leakage.
- (13) Keep this manual well for future reference as it contains important information about this product.

### Charging:

1. Connect USB charging cable with connector on the car, then plug the large end of USB cable into a 5Vd.c. 2A charger (not supplied) or USB port only. The red LED light on car will light up while charging.
2. After charging has finished, the LED light will turn off.
3. Disconnect USB charging cable from the car.

**WARNING:**  
CHOKING HAZARD - small parts,  
Not for children under 3 years.