

Item Ref:	09651KN
Description:	3AAA Battery Instruction Sheet
Date:	19/03/2025
No' Colours	2

BATTERY INSTRUCTIONS.

Requires 3 X 1.5V AAA batteries

3 X AAA

(INCLUDED)

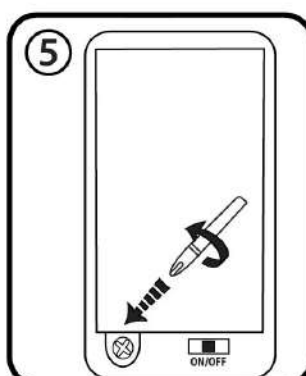
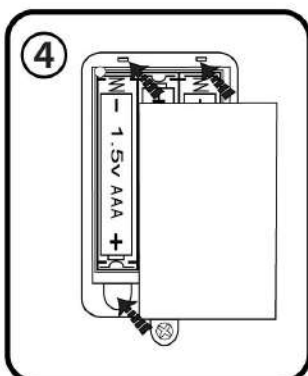
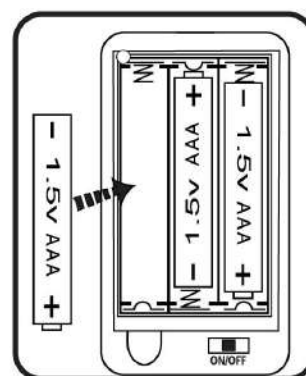
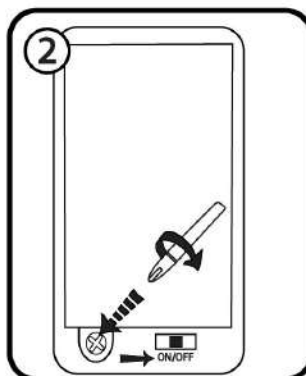
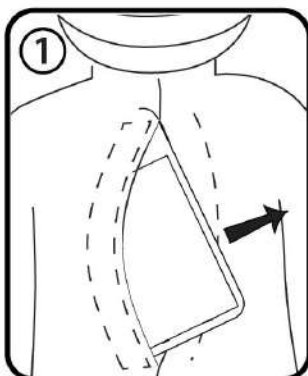

INSTRUCTIONS.

- ① Remove the battery box from inside the dolls body located at the back of the doll.
- ② Unscrew the battery cover retaining screw and remove the battery box cover.
- ③ Replace the batteries as shown in the diagram.
- ④ Refit the battery box cover.
- ⑤ Secure the battery cover retaining screw and refit the battery box inside the dolls body. Select the ON MODE position on the switch.

WARNING:

- Do not mix old batteries with new batteries.
- Always remove exhausted batteries from the toy.
- Non-rechargeable batteries are NOT to be recharged.
- Rechargeable batteries are to be removed from the toy before being charged.
- Rechargeable batteries are only to be charged by an adult.
- Different types of batteries or new and used batteries are not to be mixed.
- Batteries are to be inserted with the correct polarity as shown in the diagram.
- The supply terminals are not to be short-circuited.
- Remove the batteries if the toy is not to be used for a long time.
- Please discard the old batteries for you and your child's safety.

BATTERY INSTALLATION BY AN ADULT IS REQUIRED. DISPOSE OF BATTERIES RESPONSIBLY. DO NOT DISPOSE IN FIRE.

WARNING: DISPOSE OF USED BATTERIES IMMEDIATELY. KEEP NEW AND USED BATTERIES AWAY FROM CHILDREN. IF YOU THINK BATTERIES MIGHT HAVE BEEN SWALLOWED OR PLACED INSIDE ANY PART OF THE BODY, SEEK IMMEDIATE MEDICAL ATTENTION.

Discard old batteries as recommended by your local authority.
Please retain this information for future reference.