

anko

Pet Vacuum Cleaner

User Manual

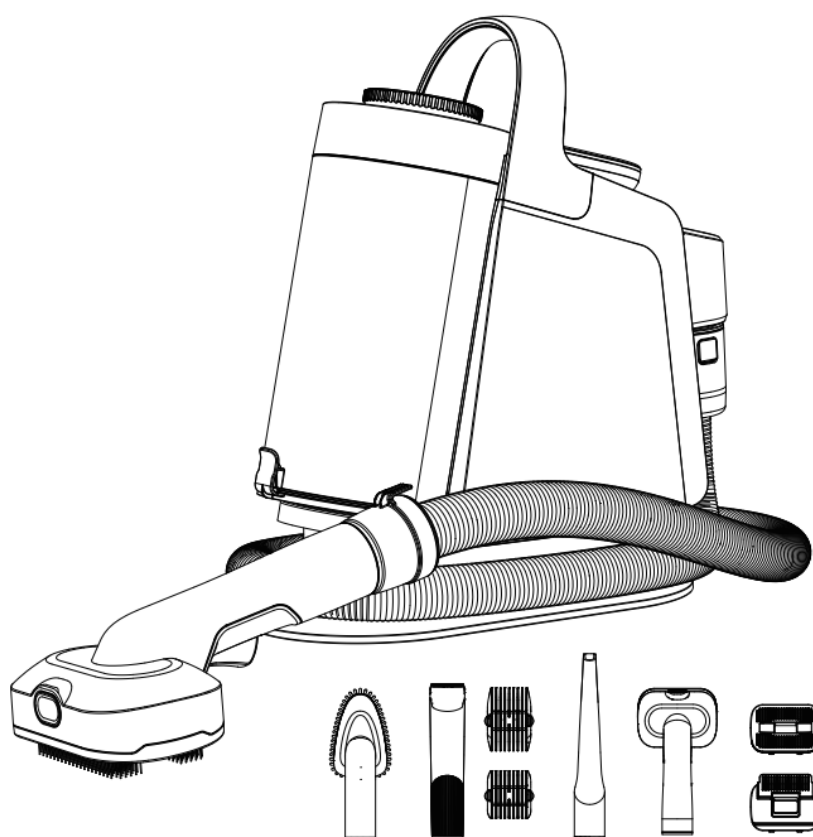

Model no.: PT-23W

Please read the user manual carefully before using this appliance

IMPORTANT SAFETYGUARDS

Please follow all the precautions listed below for safety and to reduce the risk of injury or electric shock.



WARNING: READ ALL INSTRUCTIONS; FAILURE TO FOLLOW ALL INSTRUCTIONS LISTED BELOW MAY RESULT IN ELECTRIC SHOCK, OR SERIOUS PERSONAL INJURY.

- Only use the appliance as described in this manual.
- Do not immerse the appliance in water or any other liquid.
Warning: For electrical safety, keep the appliance dry.
- This product is intended for household use only and should not be used for commercial or industrial purposes.
- Indoor use only.
- Do not allow the appliance to be exposed to rain or moisture during use or storage.
- Unplug the appliance before cleaning.
- Do not leave the appliance unattended when it is plugged in.
- The appliance is not intended for use by persons (including children) with reduced physical, sensory or mental capabilities, or lack of experience and knowledge. Unless they have been given supervision or instruction concerning use of the appliance by a person responsible for their safety.
- Children should be supervised to ensure that they do not play with the appliance.
- Exercise full caution when using the product around children and pets. Ensure that children and pets do not play with the product.
- DO NOT handle plug or vacuum cleaner with wet hands.
- DO NOT operate the appliance with a damaged cord or plug.
- DO NOT use the vacuum cleaner if the appliance malfunctions, abnormal noise, smell, smoke, is dropped or damaged in any manner or any breakage is found during operation.
- For electrical safety, any repairs to the product must be performed by a qualified electrical person only, or the product must be disposed of.
- DO NOT vacuum flammable liquids, ashes, hot coals, cigarette butts, matches or any hot, smoking or burning objects, etc.
- DO NOT pick up flammable or combustible materials (i.e. lighter fluid, petrol, kerosene, etc.) or use in the presence of explosive liquids or vapour.
- DO NOT pull the appliance by the cord or pull to disconnect it from the outlet. Instead, grasp the plug and pull to disconnect.
- DO NOT close door on cord or pull cord around sharp edges or corners.
- DO NOT use the vacuum cleaner if it is blocked. Turn off the cleaner and clear all blockages before continuing.
- DO NOT use with any openings blocked and do not restrict airflow.
- DO empty the Dust Canister regularly for optimal operation of the vacuum
- DO NOT store or use the appliance near high temperature areas.

- DO NOT attempt to modify this product in any way
- Do operate the appliance from a power source of the same voltage, frequency and rating as indicated on the product identification plate.
- Do store your appliance indoors in a cool, dry area.

NOTE:

It is especially important that the filers, dust canister and components are kept clean and free from blockages, etc.

Failure to keep clean and well maintained will reduce the performance of your vacuum cleaner and may cause the motor to overheat.

Please refer to the “User Maintenance” section for further instruction on cleaning.

Addition Safety instruction (for rechargeable clipper)

1. Do not use while bathing or in a shower.
2. Before using the appliance, ensure that the clipper blade is securely fitted.
3. Only charge the clipper with the USB cable supplied with the appliance.
4. Only Charge the appliance with Extra Low Voltage USB Battery Charger (not supplied) with an output rating 5Vd.c. 1A, same as indicated on the appliance's rating label.
5. When charging the appliance, make sure it is switched OFF.
6. Check that your supply voltage is the same as that stated on the clipper.
7. Use this appliance only for its intended use as described in this manual.
8. Use only attachments provided.
9. This product contains sharp blades, please take the utmost care in handling and use.
10. **To avoid personal injury, do not use the hair clipper if it has a damaged blade.**
11. Do not submerge the appliance, nor make it flow under water-tap.
12. Do not use salt water or boiling water when cleaning. Also, do not use cleaning products that are designed for toilets, bathrooms or kitchen appliances.
13. Do not use outdoors or operate where aerosol (spray) products are being used, or where oxygen is being administered.
14. **CAUTION: Electric Shock Hazard. Never operate this appliance if it is not working properly, if it has been dropped or damaged, or if it has been dropped into water.**

WARNING: Do not recharge non-rechargeable batteries.

WARNING: Before charging the product, please make sure your hands are dry.

**WARNING: Only use the USB charging cable supplied with the appliance.
Use of other cable may cause electrical failure and/or fire.**

**WARNING: Do not use this appliance near bathtubs, showers, basins or
other vessels containing water.**

WARNING

Only use the USB cable that was supplied with this Appliance.

Consumers are cautioned against trying to replace the battery. Using and/or purchasing counterfeit and/or inferior quality batteries have the potential to cause fire, personal injury, and/or damage to property. These batteries are typically found on online-auction websites or from other retailers and are known to pose a potential safety risk.

Never try to charge non-rechargeable batteries as they may explode or catch on fire or cause personal injury and/or damage to property.

- Batteries may explode if disposed of in fire.
- The battery is not replaceable. Do Not open the appliance.
- Do not use or store in temperatures above 40°C.

At the end of the appliance's life, it must be disposed of correctly.

Contact your local waste management authority for more information on Battery Recycling and disposal regulations in your area.

Do not dispose of electrical appliances or batteries as unsorted municipal waste, use separate collection facilities. Contact your local council for information regarding the collection systems available. If electrical appliances are disposed of in landfills or dumps, hazardous substances can leak into the groundwater and get into the food chain, damaging your health and well-being. Please contact your local council or regional authority for more information on the collection, reuse, and recycling programmes.

SAVE THESE INSTRUCTIONS

ACCESSORIES LIST

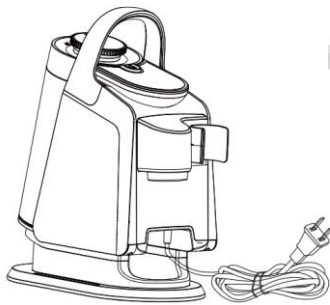

Main Unit*1

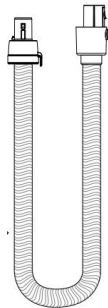

Hose*1



**Electric Clipper
Charging Cable*1**



User Manual*1

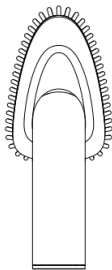

Cleaning Brush*1



Electric Clipper*1



Crevice Tool*1

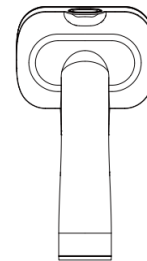

**Grooming Comb
Handle*1**

INSTALLATION INSTRUCTIONS

1. Assemble the parts by following the direction indicated by the arrow.

2. Attach desired accessories to the main unit through the hose.

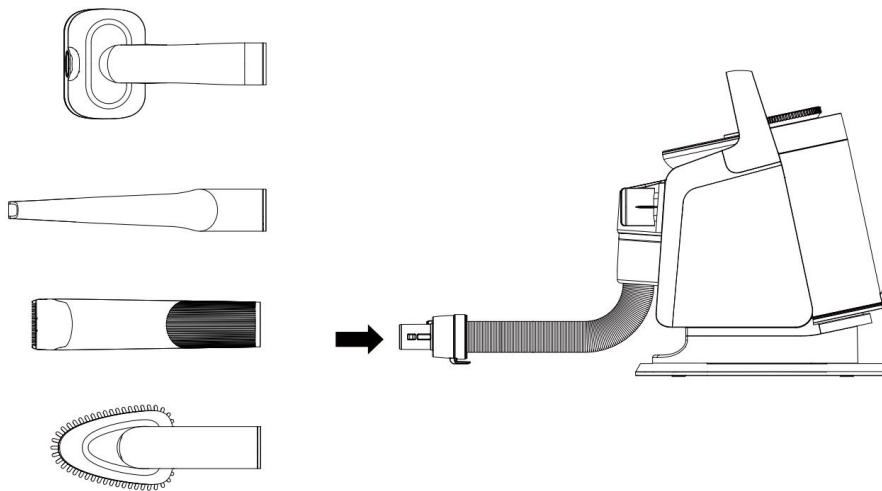

ATTENTION: Please be cautious about the sharp edges of the accessories during use to avoid cuts.

OPERATION INSTURCTIONS

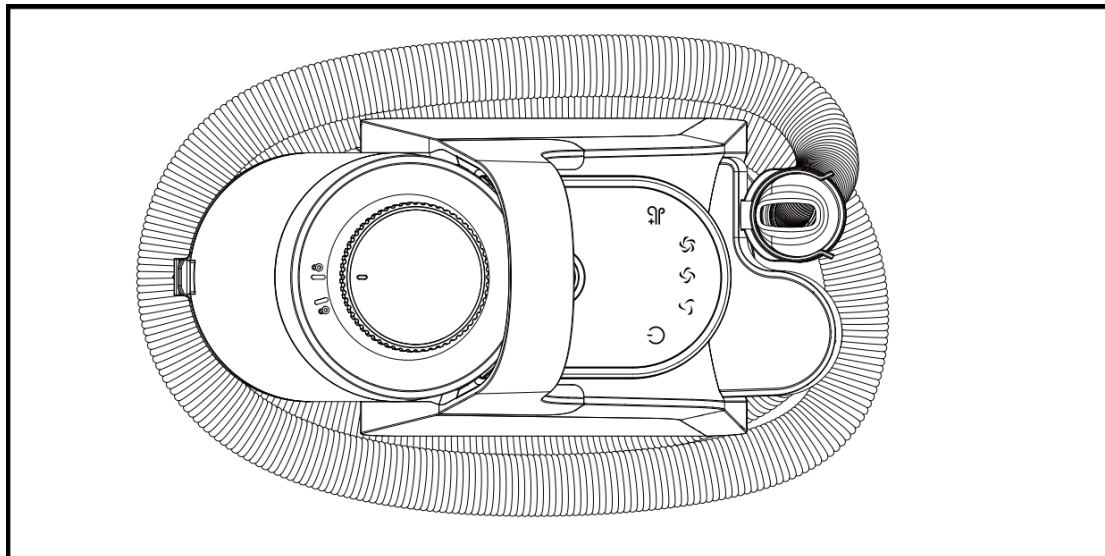

Main Unit Control Panel

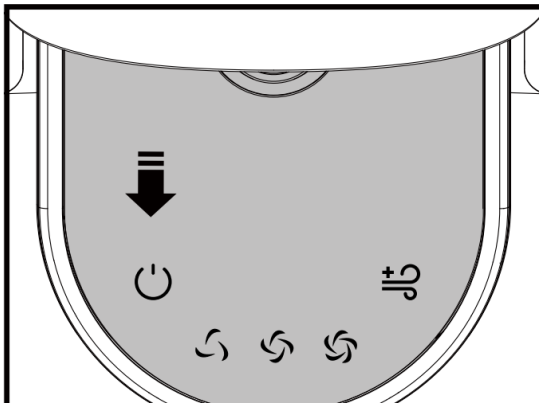

Power Switch

Press the Power Switch to turn on and off the unit.

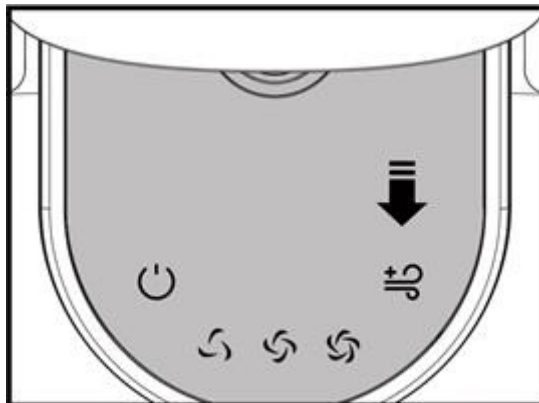

Speed Control Switch

Press the Speed Control Switch to select desired Corresponding speed indicator will be on.

USE as PET VACUUM

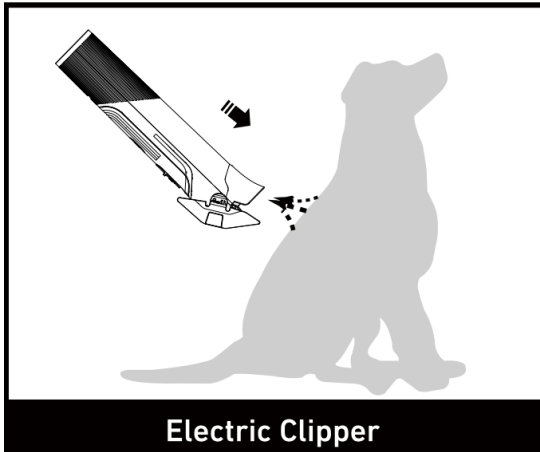

Electric Clipper

Trim and vacuum pet hair without spreading it.

Note: When using, be aware of the blade and sharp edges to avoid excessive force that could cause cuts to the skin.



Fabric & Hair Cleaning Brush

Used to remove fallen hair from clothing and your pet's body

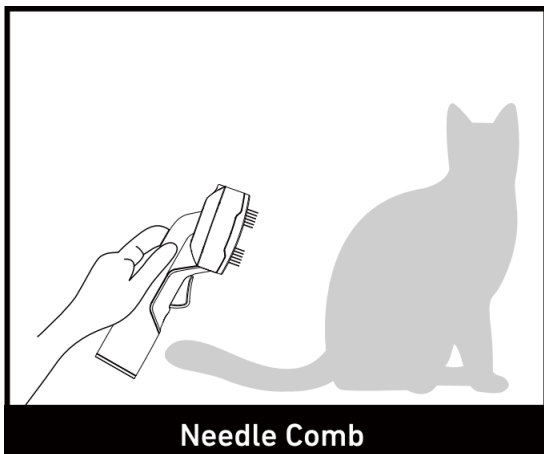

Needle Comb

Effectively cleans loose and old hair and debris from your pet's body while fluffing up the coat.

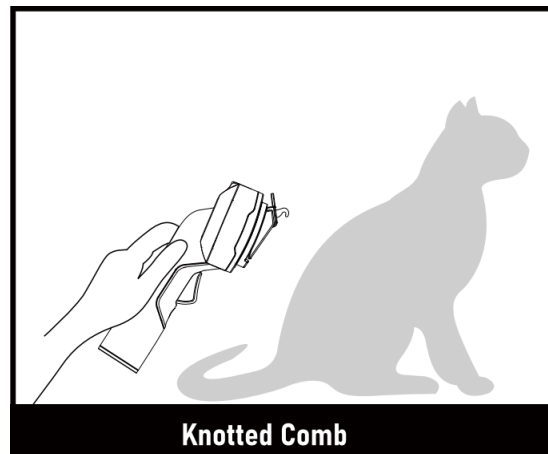

Knotted Comb

Thins pet's coat for a grooming effect.
Note: Avoid applying excessive force to sensitive areas of your pet's skin to prevent cuts.

CLEANING & MAINTENANCE

Cleaning the dust cup



Press the button in the direction of the arrow and pull it outwards.

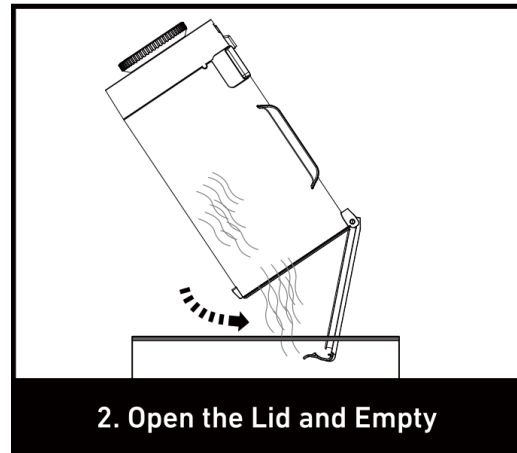

Press the bottom lid release button of the dust cup to open it and empty the debris.



Place the bottom of the dust cup on the main unit's bracket, rotate it in the direction of the arrow to align it with the main unit, and secure it in place.



ATTENTION: Handle the dust cup with care when removing or inserting it. If you wash the duct cup, make sure to dry it thoroughly before putting it back on the unit. This is to prevent the electric motor from getting wet and causing an electric shock or damage to the machine.

Cleaning the filter

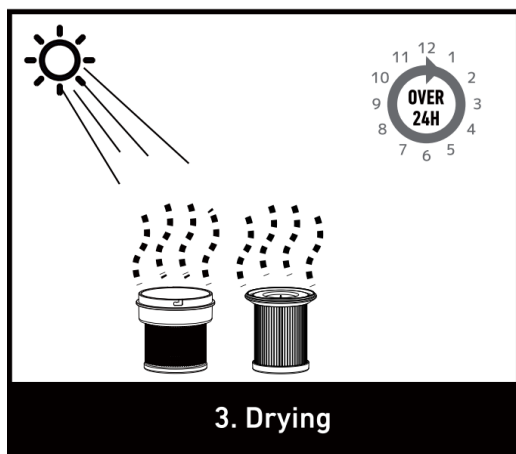
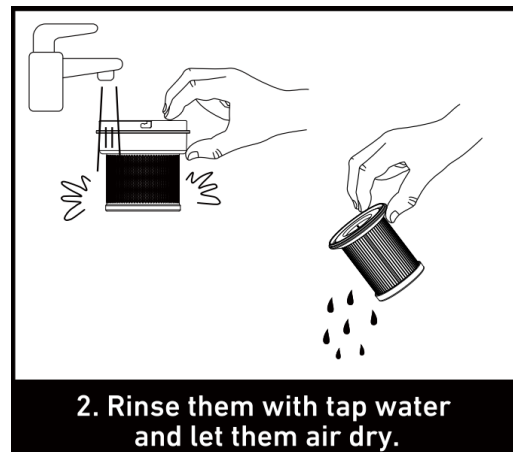

Place them in a well-ventilated area for at least 24 hours to ensure thorough drying.

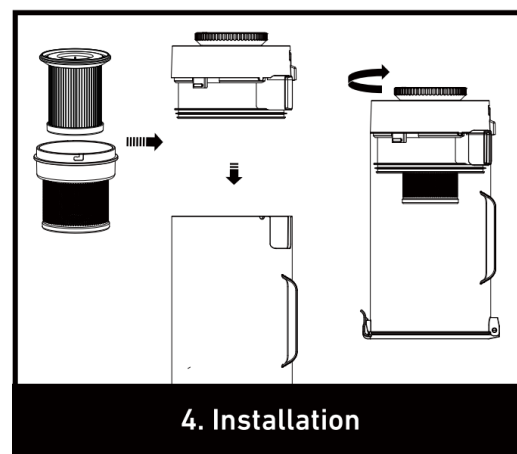

After they are completely dry, reinstall the HEPA and metal mesh, put them back in their original positions.

ATTENTION: Clean the HEPA and metal mesh with cold water at least once a month. The maintenance frequency may vary depending on usage and conditions. Remember to disconnect the power and unplug the device from the socket before replacing or cleaning the filter components. Make sure to install the HEPA and metal mesh after they are fully dried. Using them without proper drying may result in electric shock or malfunction.

Storage

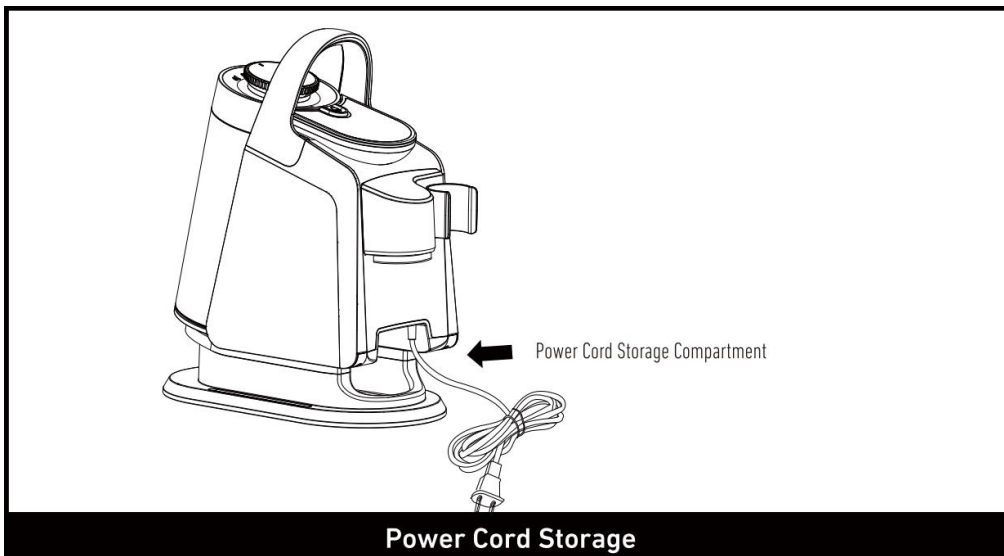

After properly winding the power cord, place it inside the power cord storage compartment on the side of the machine.

SPECIFICATIONS

Model no.: PT-23W

Voltage: 220-240V~50-60Hz

Power :350W

Clipper Input voltage:5V d.c. 1A

Clipper battery: li-ion, 3.7V 1500mAh x 1cell

12 Month Warranty

Thank you for your purchase.

Your new product is warrantied to be free from defects in materials and workmanship for the period stated above, from the date of purchase, provided that the product is used in accordance with accompanying recommendations or instructions where provided. This warranty is in addition to your rights under the Australian Consumer Law.

For New Zealand customers, this warranty is in addition to statutory rights observed under New Zealand legislation.

We will provide you with your choice of a refund, repair (where possible) or exchange (availability dependent) for this product if it becomes defective within the warranty period. The business will bear the reasonable expense of claiming the warranty.

This warranty will no longer apply where the defect is a result of alteration, accident, misuse, abuse or neglect.

Please retain your receipt as proof of purchase and contact our Customer Service Centre as listed below, for the entity you purchased this product from, for any difficulties with your product. Warranty claims and claims for expense incurred in returning this product can be addressed to the respective Customer Service Centre.

Our goods come with guarantees that cannot be excluded under the Australian Consumer Law. You are entitled to a replacement or refund for a major failure and compensation for any other reasonably foreseeable loss or damage. You are also entitled to have the goods repaired or replaced if the goods fail to be of acceptable quality and the failure does not amount to a major failure.

Contact for Kmart purchases	Contact for Target purchases
Kmart Australia Ltd. C/- Customer Service Centre 690 Springvale Road, Mulgrave Vic 3170 Customer Service: 1800 124 125 (Australia) or 0800 945 995 (New Zealand) or via Customer Help at kmart.com.au	Target Australia Pty Ltd C/- Customer Service Centre 2 Kendall Street, Williams Landing, Vic, 3027 Customer Service: 1300 753 567 or via Customer Help at target.com.au/help/contact-us