

# Paint Your Own Mug

8+  
years

## Instructions



Clean mug with a cloth. Then paint on it with the paintbrush.



After you have finished painting, leave the mug to dry for 24 hours.

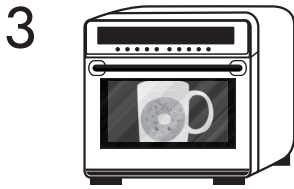

Place the mug in an oven (normal gas or electrical), but NOT a microwave.

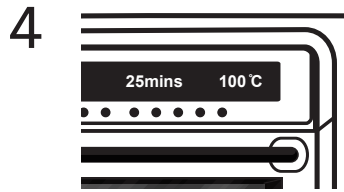

Heat the mug in the oven at a temperature of 100°C / 212°F for around 25 minutes. Do not take it out immediately, allow time to cool off.

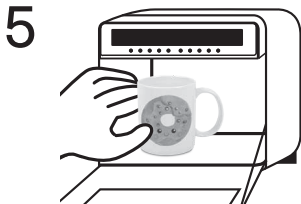

After cooling off, take the mug out of your oven.



Your mug is now complete!

## PREPARATION:

1. Wear a protective apron at all times.
2. Refer to the packaging box as inspiration when painting, or create your own design.
3. Use newspaper or a protective cover on your work area before you start painting.

## CAUTION:

1. Before you place the mug in the oven, ensure it has dried for 24 hours after you have finished painting. Paint colours will be dull if it is not completely dry.
2. Ensure to let your mug cool down before removing it from the oven as it will be very hot.
3. Only use a normal gas or electrical oven, NOT a microwave.

## TIPS:

1. Add a couple of drops of water to the paint if it looks dry or sticky.
2. Mix different paints together to create new colours.
3. If you make a mistake when you are painting, just wipe the paint off using a tissue or wash the mug. However, the paint cannot be washed or wiped off easily after baking.
4. Allow the mug to cool completely before use.
5. Keep the paint lids closed after use.
6. Thoroughly wash the paint brush with water after each use and before dipping it into another paint tub.

## NOTE:

Mixing white and other colours will make a close shade to pastel colours.

**ATTENTION:** ALL ART MATERIALS LIKE PAINT, MAY CAUSE STAINS. PLEASE TAKE THE NECESSARY PRECAUTIONS TO PROTECT CLOTHING AND FURNISHINGS. AVOID INGESTION AND EYE CONTACT. WASH HANDS AFTER USE.

**CAUTION:** RINSE EYES IMMEDIATELY IF THE PAINT COMES INTO CONTACT WITH THEM. IF IRRITATION PERSISTS, SEEK MEDICAL ATTENTION.

ADULT SUPERVISION IS RECOMMENDED.  
PRODUCT MAY VARY FROM IMAGE SHOWN.

PLEASE KEEP THE PACKAGING FOR FUTURE REFERENCE.

**WARNING:** THIS PAINTED MUG IS DESIGNED FOR DISPLAY ONLY. NOT FOR LIQUID USE. NOT DISHWASHER SAFE.



MADE IN CHINA

K: 43-471-683 | T: 70-383-126