

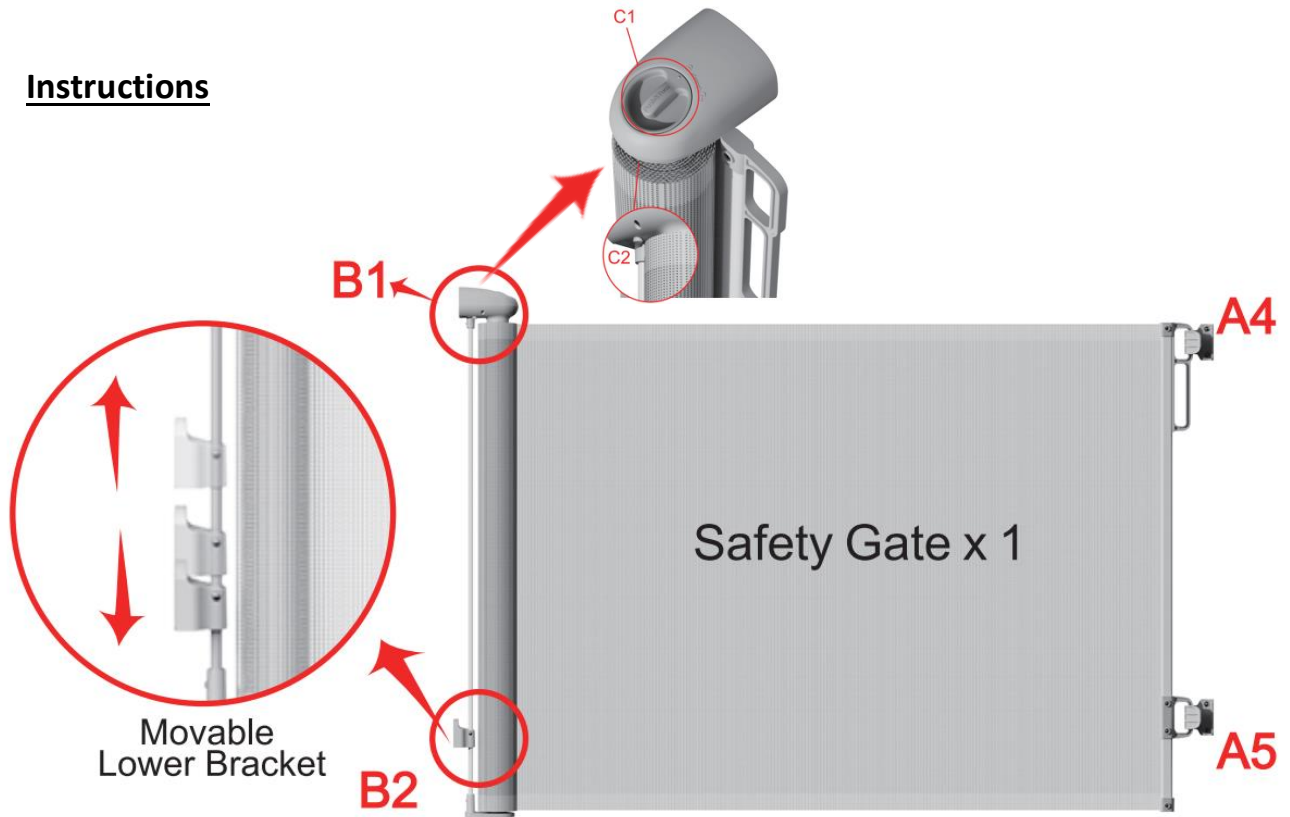







**anko**

## PET RETRACTABLE MESH GATE



## Instructions

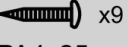

Component Parts		
<b>Brackets</b>  <b>A1x1</b>  <b>A2x1</b>  <b>A3x2</b>	<b>Extra Adhesive Tape</b>  <b>x2 For A1P</b>  <b>x2 For A2P</b>	<b>Fixing screws</b>  <b>x9 M8x40</b>  <b>x9 PA4x50</b>  <b>x9 PA4x25</b>

### Warmly notice:

#### Before installation, make sure the screws are suitable for the surface.

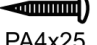
 PA4x25 Shorter screws are used on wood surfaces. According to the hardness of the wood surface, it may be necessary to pre-drill holes with 2.5mm diameter before applying the screw.

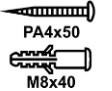
 PA4x50  
M8x40 Longer screws and expansion screws are used in solid walls such as concrete walls or tiled walls with skirting boards. (Please pre-drill the holes on the solid wall before using the expansion tube.)

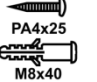
 PA4x25  
M8x40 Shorter screws and expansion screws are used in solid walls such as concrete walls or tiled walls without skirting board. (Please pre-drill the holes on the solid wall before using the expansion tube.)

#### Before installation, make sure the 2x A3 pieces are on a proper surface.

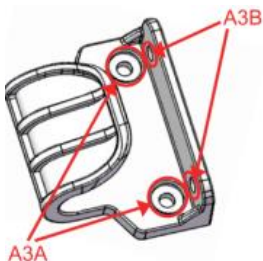

If you are securing all the brackets along the same surface, your screws need to be secured into holes A3A on the bracket.

If you are securing your bracket on the side through A3B holes, ensure your screws are secured into holes A3B on the bracket.

## How to installation

### Step 1.

Apply the safety gate to the wall lightly and adjust the height of the movable lower bracket (B2) to where it's suitable for the base boards. Place A1 & A2 into B1 & B2 respectively. *Please note: Always put the lower bracket (B2) as close to the base board as possible. If there is no base board on the wall, please do not place the lower bracket(B2) over 12cm from the floor.*

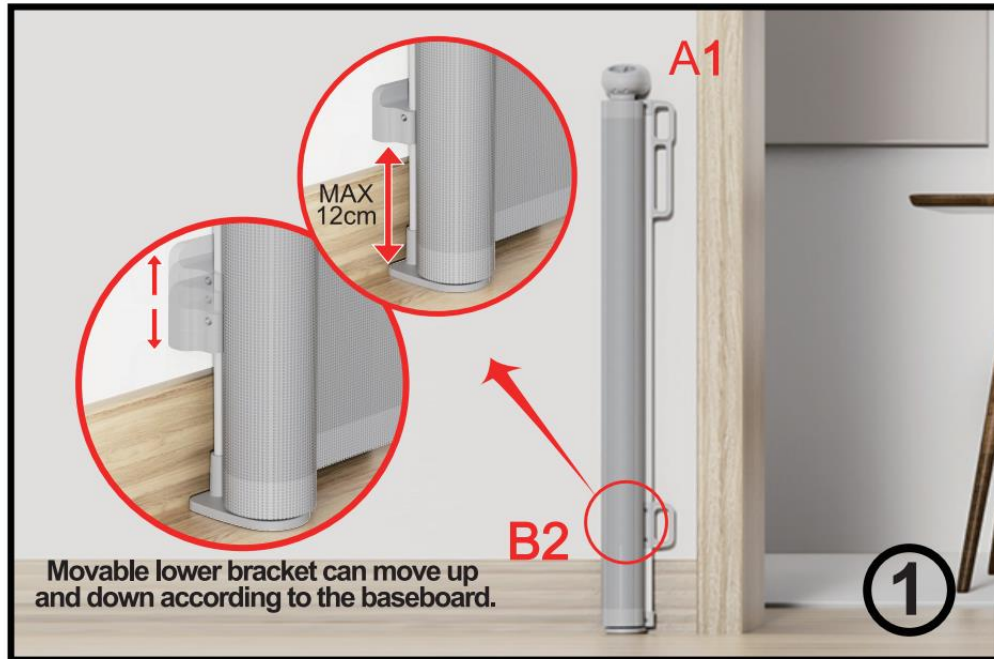

### Step 2.

Clean the surface and let dry. Tear off the release paper from the tapes on the brackets (A1 & A2). Stick the safety gate to the wall with the stickers, note not to touch the adhesive side.

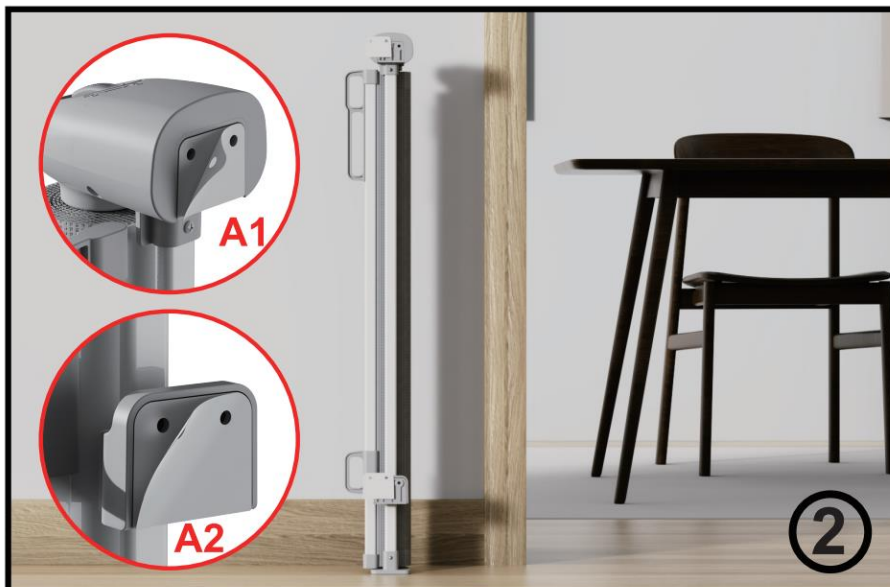

**Step 3.**

Press the C2 button to lift it up, then the safety gate can be removed out from A1 & A2.

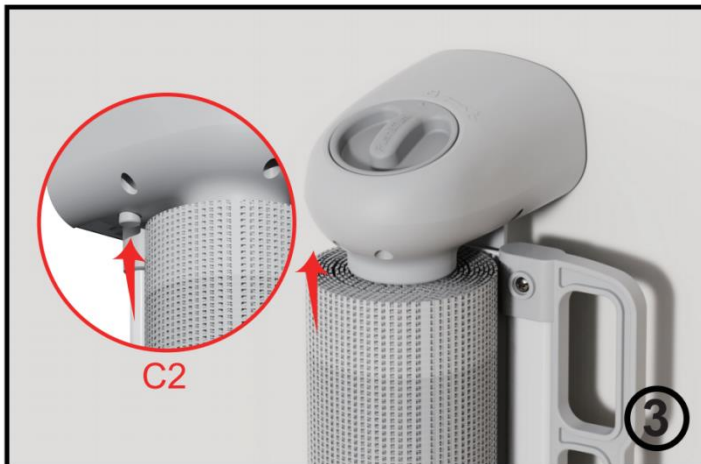

**Step 4.**

Mark the screw holes for A1 & A2 and make sure A1 & A2 are vertical.



**Step 5.**

Remove the brackets (A1 & A2) from the wall, drill the marked screw holes, insert the expansion tubes, and then use the screws to fix bracket (A1 & A2) properly.

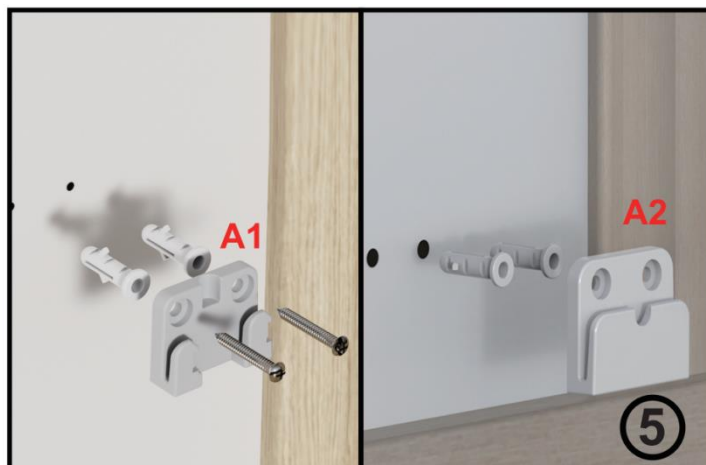

**Step 6.**

Place B2 into A2 and B1 into A1. Make sure that A1 & B1, A2 & B2 is secured into their brackets properly.

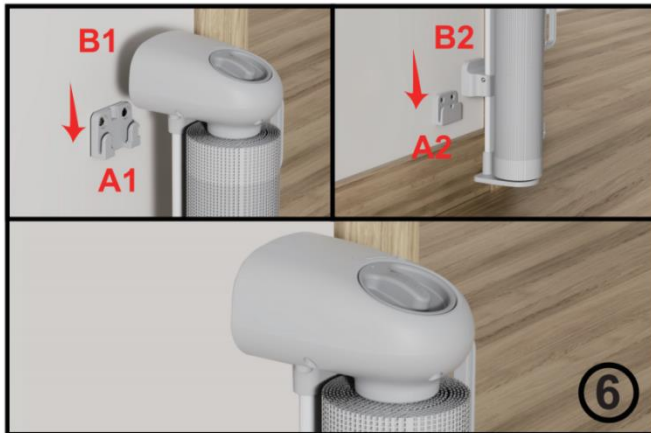

**Step 7.**

Test the gate by opening it and making sure the mesh is flat and wrinkle free. Apply A3Open the safety gate, make sure the mesh is flat and wrinkles free. Apply bracket A3 x 2 to the desired position and mark the position of the screw holes for the A3 brackets accordingly. Make sure both the A3 marks are vertical.

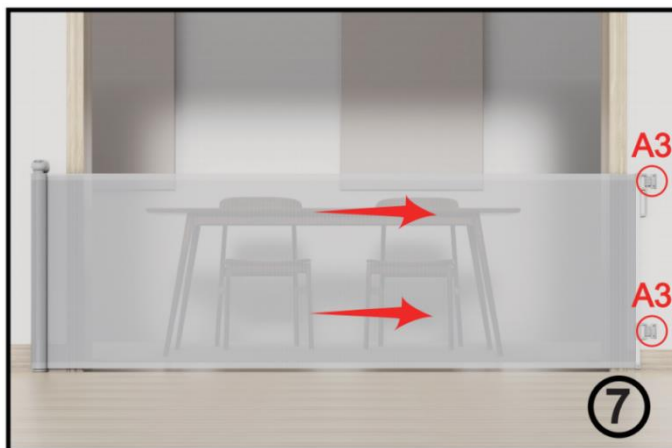

**Step 8.**

Remove the 2x A3 brackets, drill the marked screw holes, insert the expansion tubes and then use screws to fix the 2x A3 brackets properly.

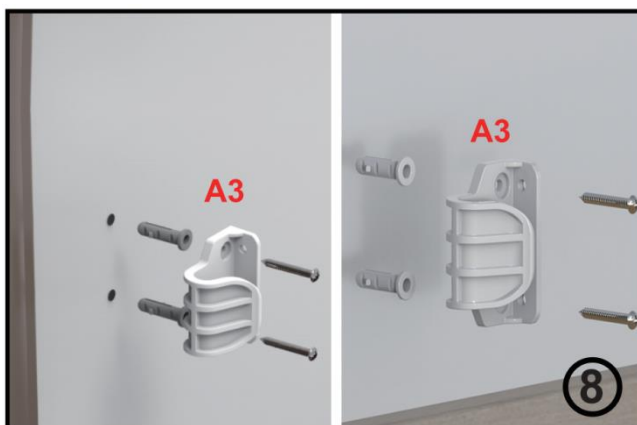



### Step 9.

Installation of the gate is now complete. Make sure the gate is in the locked position when not in use.



### How to use

1. Press and turn the cap of the gate clockwise to unlock the gate.



2. Hold the handle and pull-out the retractable mesh barrier, keep the mesh surface vertically flat and hook A4 & A5 to both A3 brackets.

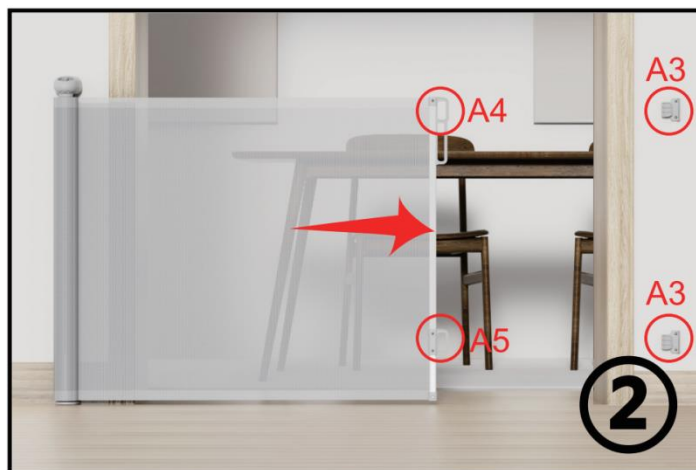

3. Make sure that A4 & A5 are hooked well into the A3 brackets.



4. Press and turn the cap of the gate counterclockwise to lock the gate.

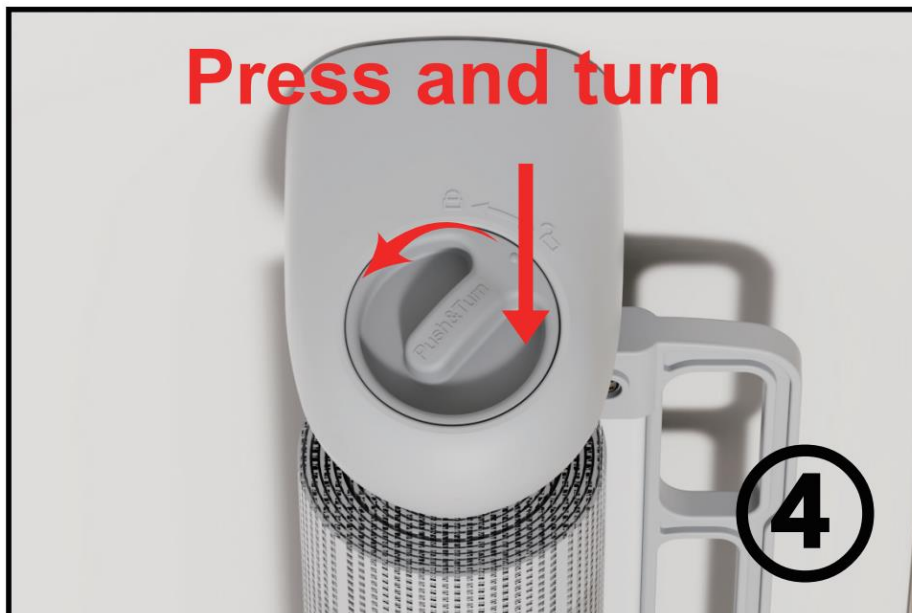

## How to remove the gate from the wall

Press the C2 button, and lift it up to remove the gate easily.

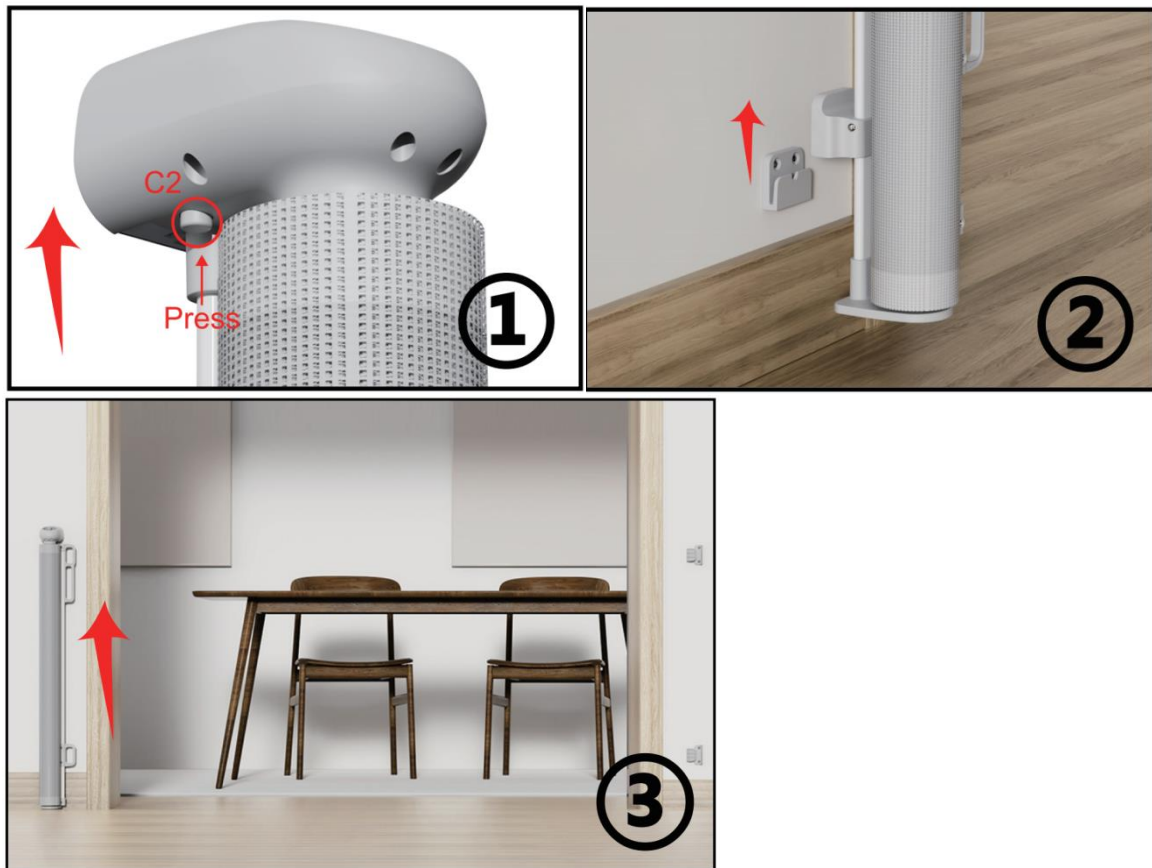

### **WARNING:**

This mesh gate is for pet use only.

Mesh gate is to be fitted between rigid walls e.g. timber or brick.

If in doubt, we highly recommend you have a specialist to install.

It is the responsibility of the pet owner if this mesh gate is suitable for their pet.