

**MARVEL**  
© MARVEL  
**SPIDER-MAN  
RC DRONE**

8+ YEARS



**Attention:** The drone includes a built-in rechargeable battery that is non-replaceable. The included rechargeable battery is not fully charged prior to shipment and must be charged before the first use.

**DRONE**

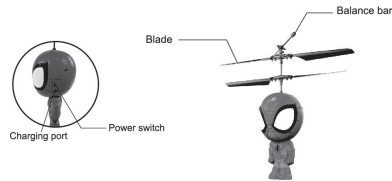

**CONTROLLER**

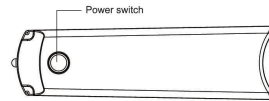

**CONTROLLER BATTERY INSTALLATION**

1. Unscrew to open battery cover, insert 4 x 1.5V AA batteries, see Diagram 1.
2. Replace battery cover.

**Attention:** Remove batteries after you have finished using your product.

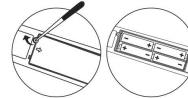

Diagram 1

**LITHIUM BATTERY CHARGE INFORMATION**

**Attention:** Do not charge battery immediately after each play, let the battery cool down for a while. shown in this instruction manual.

1. Turn off the drone.
2. Pull the charging cable from the back of the controller and plug it into the drone. (see Diagram 2)
3. The indicator light of the drone will lights up when it has started charging.
4. Once the indicator light extinguishes, the drone is fully charged. Unplug the charging cable from the drone.



Diagram 2

**HOW TO USE**

Before use, please ensure an adult has installed the battery correctly using the instructions shown in this instruction manual.

1. Turn on the drone. The drone will light up to indicate that it is activated.
2. Hold the drone carefully in the palm of your hand, and press the button on the remote control to start the flight.



**NOTE:** Please do not attempt to hit the drone with the paddle or remote control. The drone will switch off when the batteries are low. Only use the remote control included in this pack to re-charge the drone. Press the remote control button for Auto-flight and paddle control. Press again for Auto-shut down.

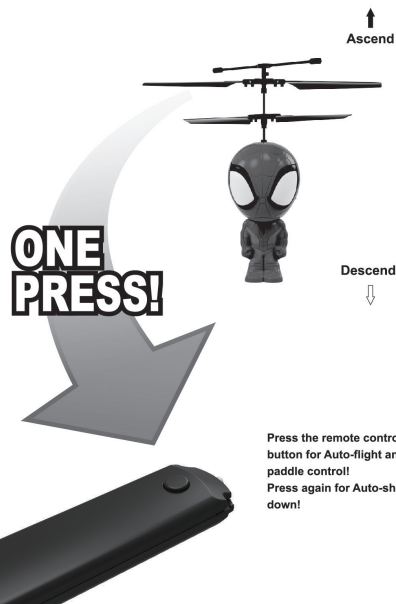

Press the remote control button for Auto-flight and paddle control!  
Press again for Auto-shut down!

**Use your hands, feet or leg for a unique remote control game experience!**

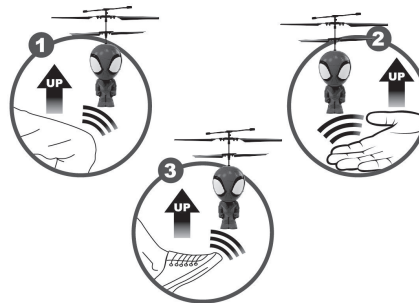

**TROUBLESHOOTING**

Problem	Cause	Correction
Propeller can't move	<ul style="list-style-type: none"> <li>● ON/OFF switch is off</li> <li>● Weak battery</li> </ul>	<ul style="list-style-type: none"> <li>● Set switch to on</li> <li>● Re-charge the drone</li> </ul>
Suddenly stops and drops when flying	<ul style="list-style-type: none"> <li>● Weak power</li> </ul>	<ul style="list-style-type: none"> <li>● Re-charge the drone</li> </ul>
Loss of control	<ul style="list-style-type: none"> <li>● Affected by strong lighting</li> </ul>	<ul style="list-style-type: none"> <li>● Change to another environment to avoid direct lighting</li> </ul>
Drone hit hand before moving away	<ul style="list-style-type: none"> <li>● Weak power</li> </ul>	<ul style="list-style-type: none"> <li>● Re-charge the drone</li> </ul>
Drone does not move up in a straight line	<ul style="list-style-type: none"> <li>● Air turbulence in room</li> </ul>	<ul style="list-style-type: none"> <li>● Turn off air conditioner or shut window/door</li> </ul>

**WARNING**

- Please follow the instructions for correct installation and use. Some parts require assembly by an adult.
- The product contains small parts and is a choking hazard.
- Do not touch the hot motor and batteries.
- Do not touch working propellers.
- Do not fly towards yourself or other people.
- Adult supervision is required.
- Non-rechargeable batteries are not rechargeable.
- Rechargeable batteries are only to be charged under adult supervision.
- Do not mix old and new batteries or batteries of different types.
- Do not short circuit the battery or put the battery in fire.
- Do not leave the toy unattended while charging it.
- When the battery is low, please return the drone and recharge it.
- Charge the toy on non-flammable surface and keep it away from flammable items.
- Turn the charger off when the toy's battery is charged, and always unplug it from the toy.
- If the toy has been damaged, immediately stop use, unplug, and safely move the toy away from flammable materials.
- Follow the manufacturer's instructions for charging the toy. Do not charge longer than recommended.
- Do not use the product for a long time. Remove the battery when not in use.
- To avoid injury, do not touch the rotating parts.
- Do not impact or drop the drone or remote control.
- Please use a clean soft cloth to clean the product.
- The user is responsible for ensuring that the product will not cause harm to themselves or others.
- The manufacturer and dealers accept no responsibility for injuries or damage to property caused by improper use.
- The packaging and instructions contain important information of products, please keep for future reference.
- Only fly during the day and keep your drone within visual line-of-sight. This means being able to see the drone with your own eyes (rather than through a device) at all times.
- Do not fly your drone higher than 120 metres (400ft) above the ground.
- Keep your drone at least 30 metres away from other people.
- Do not fly your drone over or near an area affecting public safety or where emergency operations are underway (without prior approval). This could include situations such as a car crash, police operations, a fire and associated firefighting efforts and search and rescue.
- Only fly one drone at a time.
- Do not fly over or above people. This could include beaches, parks, events, or sport ovals where there is a game in progress.
- Keep at least 5.5km away from controlled aerodromes if your drone weighs more than 100g. Flying within 5.5km of a non-controlled aerodrome or hover ball landing site (HLS) is possible, but only if no manned aircraft are operating to or from the aerodrome. If you become aware of manned aircraft operating to or from the aerodrome/HLS, you must manoeuvre away from the aircraft and land as soon as safely possible.
- Do not operate your drone in a way that creates a hazard to another aircraft, person or property.
- Respect personal privacy, do not record or photograph people without their consent-this may breach state laws.

K: 43-383-764  
T: 69-562-471