

# Highchair Booster Seat

## Instruction Manual

**6-36**  
months

**15**  
kg

MAXIMUM  
WEIGHT  
OF CHILD

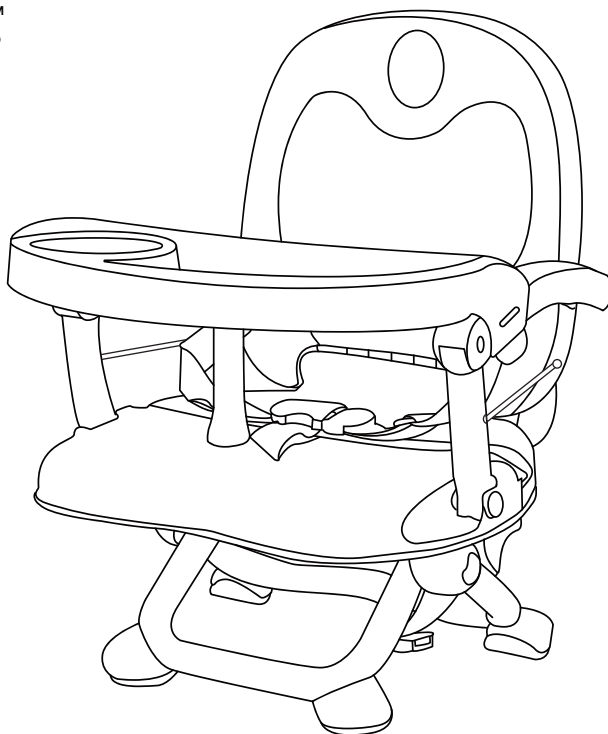

**IMPORTANT!**  
**READ CAREFULLY**  
**AND KEEP FOR**  
**FUTURE REFERENCE**

# 1 Safety Notes

---



## CAUTION:

**Read these instructions carefully before assembly and keep for future reference.**

**The child may be hurt if you do not follow these instructions.**



## WARNING:

1. Never leave the child unattended.
2. Always use the restraint system and ensure it is correctly fitted.
3. Always use the chair attachment system and ensure it is correctly fitted before use.
4. Always check the security and the stability of this item on the adult chair before use.
5. Do not use this product on stools or benches.
6. Do not use the chair alone without attaching to adult chair.
7. This product is intended for children able to sit unaided (minimum 6 months) and up to 36 months or a maximum weight of 15kg.
8. Before attaching this product to an adult chair, ensure the chair meets the minimum dimensions shown below.

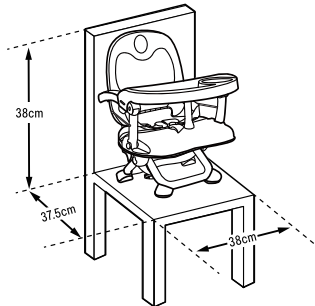

9. Place the adult chair with the booster seat in a position where the child is not able to use its feet to push against a table or any other structure as this can cause the chair to tip over
10. Adult assembly required.
11. Take care when unpacking and during assembly.
12. Dispose of all packing materials carefully after assembly.
13. Inspect the product before assembly and periodically during use.
14. Never use this product if there are any loose or missing fasteners, joints or broken parts.
15. Any additional or replacement parts should only be obtained from the manufacturer or distributor.
16. Never substitute parts.

## 2 Parts List

---

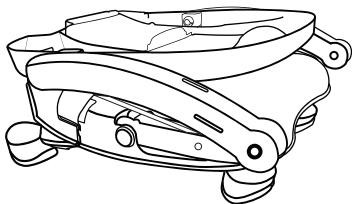

**A x 1**  
booster seat

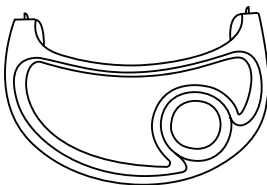

**B x 1**  
tray

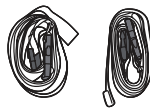

**C x 2**  
securing straps

## 3 Assembly

---

### 3.1 Unfold booster seat

Lift the backrest completely. When reaching the correct position of the backrest, you will hear a “click”.

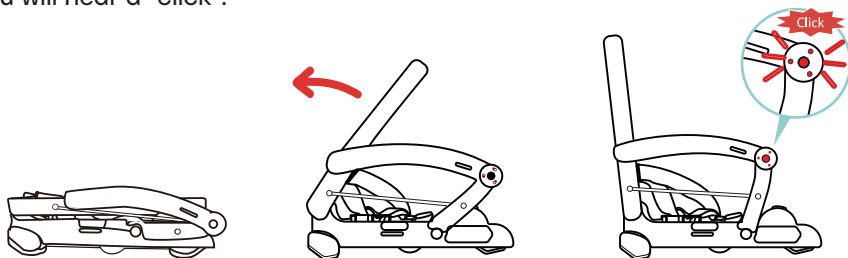

### 3.2 Tray installation

Insert the two plastic hooks of the tray into the armrest slots.

Press the tray downwards until it snaps into the correct place. You will hear a “click”.

To support the tray, pull down the plastic bar under the tray and secure it into the slot of the booster seat.

**Check that the tray is fully locked into place by pulling and gently lifting up the tray.**



# 3 Assembly

## 3.3 Height adjustment

To adjust booster seat height, push the two buttons on the sides and push down the legs.

**IMPORTANT: MAKE SURE THE BUTTONS HAVE POPPED OUT BEFORE USE.**

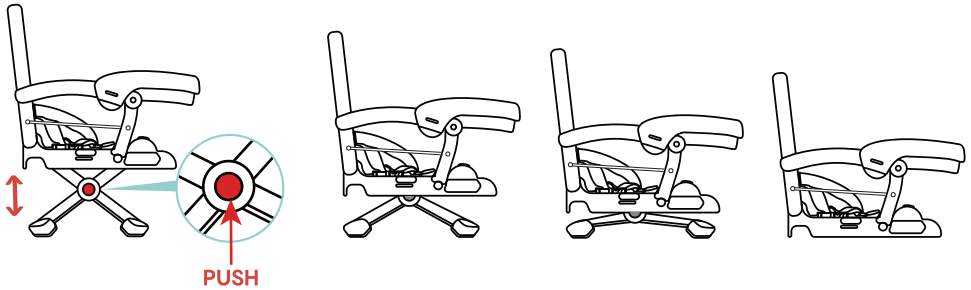

## 3.4 Securing straps installation

Run one of the securing straps into the notch of both C-rings of the backrest. Once the strap has been installed, turn the notch of each C-ring into the loop. Then run the second securing strap from the right to the left side at the bottom of the booster seat. Follow the sequence from fig.1 to fig.4 to insert the strap on both of the right and left side of the seat.

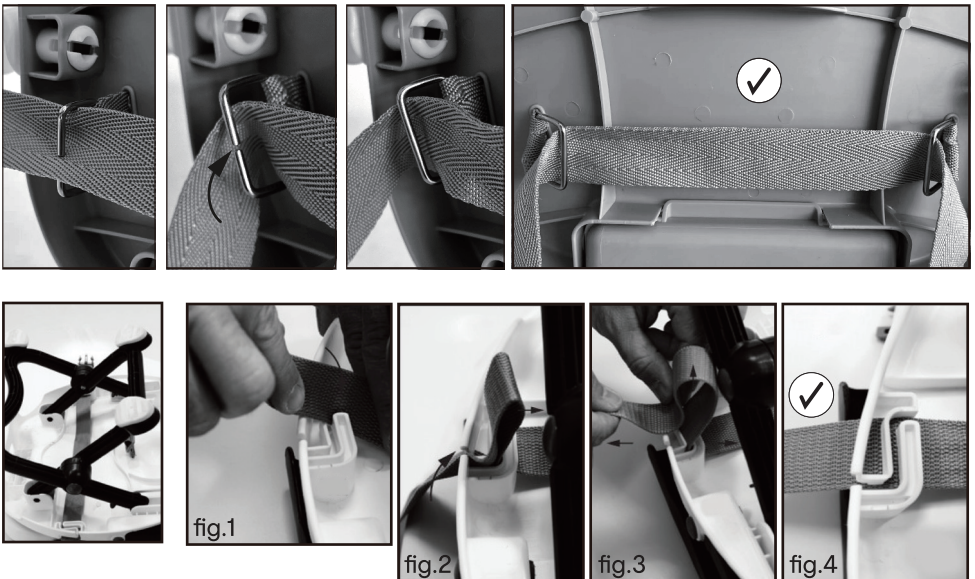



# 3 Assembly

## 3.5 Attaching to an adult chair

Place the booster seat at the center of the chair, ensuring that the chair is larger than the booster seat. Refer to page 2.  
Adjust the height of booster seat according to your needs.  
Position the booster seat tightly against the backrest of the adult chair and secure it by fastening the rear strap around the backrest of the chair.  
Then secure the bottom strap under the seat of the chair.

**Note:** Pass the end of both straps through the slot of buckle then tighten both straps by pulling on the loose ends.

**WARNING:** Before use, ensure the booster seat is correctly fixed on the chair to prevent it from moving.

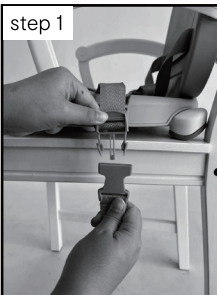
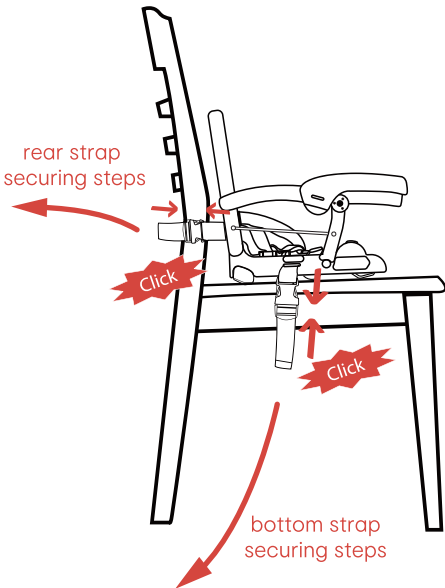
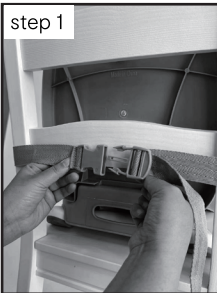

## 3 Assembly

---

### 3.6 Secure child

To secure your child in the harness, push the buckle into the buckle housing until they snap into position.

Adjust the waist strap to ensure a snug fit for your child.

**IMPORTANT: Always use the secure system when the child is sitting in the booster seat.**

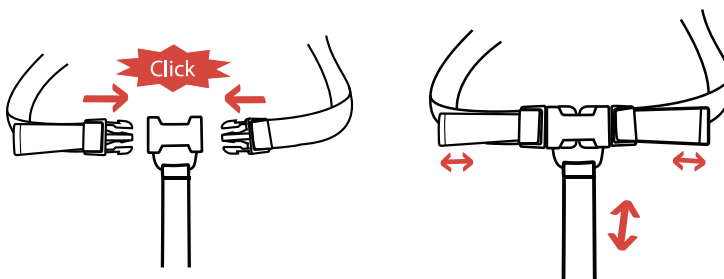

## 4 Folding

---

Fold up the plastic bar under the tray.

Simultaneously push the two buttons at the armrests to lower the backrest.

Then simultaneously push the two buttons on the legs.

This product is very compact and easy to carry or store.

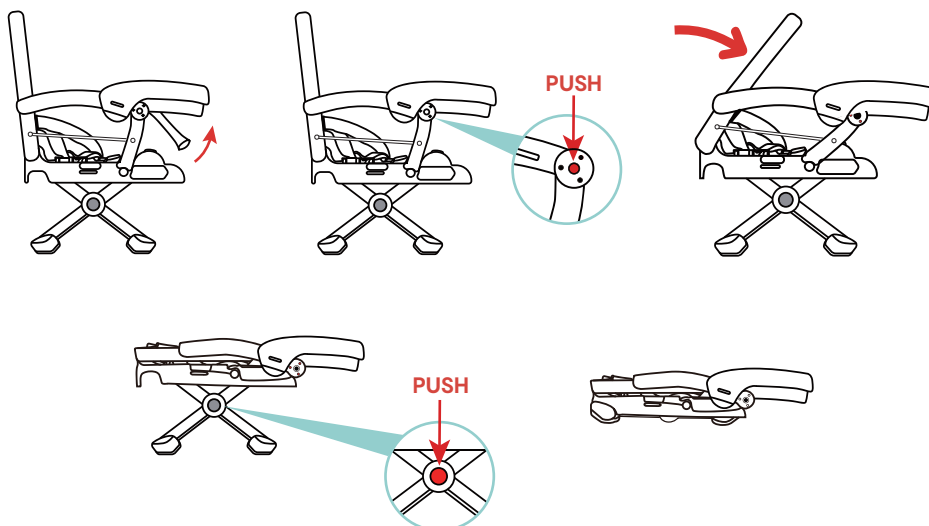

## 5 Care & Maintenance

---

To prolong the life of your nursery product, keep it clean and do not leave it in direct sunlight for extended periods of time.

Clean with a damp cloth with mild detergent.

Allow it to fully dry, preferably away from direct sunlight.

KEYCODE: 43-265-077

### **MADE IN CHINA**

© KMART AUSTRALIA LIMITED

FOR AU / NZ: IMPORTED FOR KMART STORES IN AUSTRALIA AND NEW ZEALAND.

KMART AUSTRALIA - 690 SPRINGVALE ROAD, MULGRAVE, VIC 3170 AUSTRALIA.

KMART NEW ZEALAND - REGIONAL OFFICE C/O KMART PAPATOETOE STORE,  
HUNTERS PLAZA, GREAT SOUTH ROAD, PAPATOETOE, AUCKLAND, NEW ZEALAND.

### **KMART CUSTOMER SERVICE**

**AU: 1800 124 125 NZ: 0800 945 995**