

anko

Long Handled Scrubbing Brush

DB-1001

User Manual



**PLEASE READ AND SAVE THESE
INSTRUCTIONS FOR FUTURE REFERENCE**

IMPORTANT SAFEGUARDS

When using any electrical product, always follow these basic safety precautions:



READ ALL INSTRUCTIONS BEFORE USE.

1. Please read all instructions carefully before using this product.
2. This appliance must only be supplied at safety extra low voltage corresponding to the marking on the appliance.
3. After charging, when unplugging the plug, please grab by the plug when pulling it out. Do not pull from the wire.
4. Do not immerse the main unit in water or other liquids to avoid damage to the motor.
5. This appliance is not intended for use by persons (including children) with reduced physical, sensory or mental capabilities, or lack of experience and knowledge, unless they have been given supervision or instructions concerning use of the appliance by a person responsible for their safety.
6. Children should be supervised to ensure that they do not play with the appliance.
7. In the absence of supervision, the cleaning and maintenance work should not be done by a child.
8. Stay away from flammable and explosive substances at any time.
9. Use of accessories not recommended or supplied with the product may cause fire, electric shock or personal injury.
10. For electrical safety, any repairs to the product should be carried out by a qualified electrical person only or the product must be disposed of.
11. This appliance must be always used in accordance with the user instructions supplied with the product and must not be used for other purposes.
12. Misuse may cause serious injury.
13. Switch OFF the appliance before changing accessories.
14. Before using the product, please check if the brush is fixed in place.
15. Do not use it in front of people to avoid the brush hitting others if it is dropped.
16. Do not operate the product near the any explosive, flammable object or liquid.
17. Keep hair, loose clothing, and all parts of body away from moving parts.
18. Do not make the product wet except the brushes
19. This appliance contains batteries that are non-replaceable.
20. Fix the brushes firmly before operation.
21. Always wear eye protection when using the scrubber with irritating substances. Rubber gloves are also recommended.
22. Do not insert attachments/accessories when the unit is running.
23. Do not operate without charging port cover in place.
24. For cleaning, please refer to CLEANING AND STORAGE section.

CAUTION!

25. The product has built-in lithium-ion batteries. Pay attention to the following:
 - a) Only use and store the product in an environment where the temperature is between -5°C and $+35^{\circ}\text{C}$.
 - b) If not used for a long time, re-charge every three months to prevent battery damage.
 - c) Charging time may be longer when the room temperature is below 10°C .
 - d) Charge the battery when the battery power goes low, avoid allowing the battery to go flat.
26. DO NOT squeeze, puncture, or short circuit the product or put it into water, fire or use in an environment where the temperature is higher than 60°C .
27. This product is for household use only and not designed for commercial use.
28. Do not expose the product to high temperatures (above $+35^{\circ}\text{C}$), strong magnetic fields, near flammable and explosive gases (such as natural gas, methane, etc.) to avoid accidents such as abnormal operation or fire.

**SAVE THESE INSTRUCTIONS
FOR FUTURE REFERENCE**

KNOW YOUR LONG HANDLED SCRUBBING BRUSH

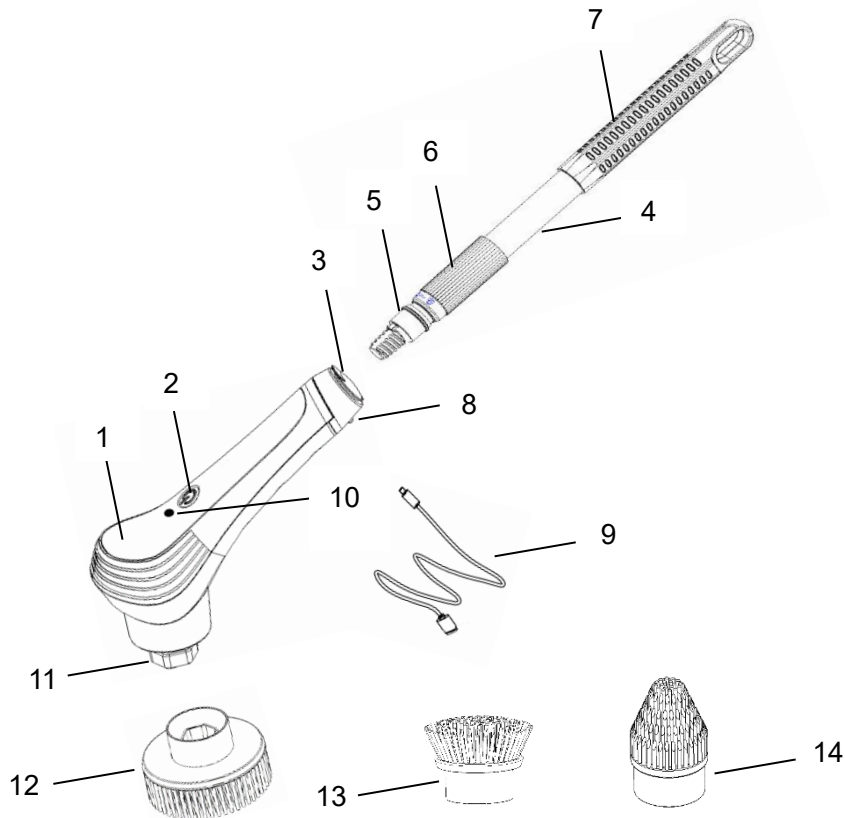

- | | |
|------------------------|--------------------------------|
| 1. Main unit | 8. Charging port with cover |
| 2. On/Off button | 9. USB cable |
| 3. Joint cover | 10. Charging/working indicator |
| 4. Extension rod | 11. Magic joint |
| 5. Safety clip | 12. Flat brush |
| 6. Rod length adjuster | 13. Ball brush |
| 7. Handle | 14. Pointed brush |

IMPORTANT!

Please make sure that your appliance is received with the right components as shown above. Check everything carefully before use. If any part is missing or damaged, do not use. Return the product to Kmart for replacement.

BEFORE FIRST USE

Note: When using the appliance for the first time, carefully remove all internal and external packaging, protective film and accessories.

- Fully charge the appliance before first use.
- Always power off the appliance before charging.
- The supplied USB charging cable should be inserted into the standard USB power source rated at 5Vd.c. 1A specification.
- The charging time is around 2.5 hours.
- The indicator light will keep flashing during charging and light up when fully charged.

USING YOUR LONG HANDLED SCRUBBING BRUSH

1. Attach the extension rod to the main unit if needed.
 - To attach the rod, open the joint cover and screw the rod clockwise until the safety clip installed in place with “click”.
 - To remove the rod, pull back and hold the safety clip, and screw it off anticlockwise.
 - To reach your desired length of the rod, loosen the adjuster by rotating it anticlockwise. Lock the rod by rotating the adjuster clockwise tightly.

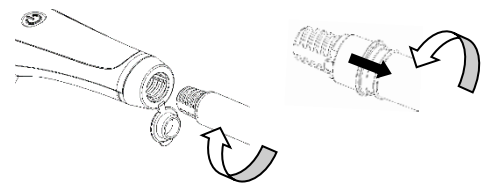

Note: Before the extension rod is used, make sure that it is properly assembled.

2. Select the appropriate brush according to the cleaning requirements. Connect it to the main body via the magic joint.
3. Make sure the charging port is properly sealed by the cover. Now the appliance is ready for use.
4. Push the On/Off button, and the working indicator will light up and the appliance starts working.
5. Push the On/Off button again to turn off the appliance, and the working indicator light will go off.

Tips for better performance:

- Make sure the appliance is fully charged before each cleaning. The normal working time is around 1 hour after fully charged.
- This appliance can work with different kinds of cleaners such as spray, foam, gel, liquid, as well as bleach. Frictional cleansers should not be used.
- **⚠ Warning! Please wear safety gloves and glasses for safety.**
- If you are not sure the surface can be used with the brush, test it on inconspicuous places first.
- Power off the appliance before removing from the cleaning surface to avoid spraying from the rotating brush.
- The cleaner is powerful, excessive force is not required. It is better to brush in a circular motion for big areas. Do not keep brushing in a small area for a long time.

CLEANING AND STORAGE

- Please clean the product and its accessories after each use to maintain and prolong the life of the product.
- Do not use a steel ball, abrasive cleaner or corrosive liquid (such as gasoline, acetone) to clean the product.
- The main unit and extension rod can be wiped with mild detergent and a soft sponge. Do not rinse with soap or spray water or other liquids to avoid damage to the appliance.
- Soak the brushes in soapy water before rinsing. Keep the surface of the cleaning brush clean to guarantee sealing ability.
- Ensure the product is clean and dry before storage.
- Store the product indoors.
- This product contains a Li-ion battery. It should be stored in a clean, dry, ventilated room with an ambient temperature range of -5°C to $+35^{\circ}\text{C}$ and a relative humidity of 25% to 75%.

TECHNICAL SPECIFICATION

Input: 5Vd.c. 1A

Battery: Li-ion 3.7V 2600mAh

12 Month Warranty

Thank you for your purchase from Kmart.

Kmart Australia Ltd warrants your new product to be free from defects in materials and workmanship for the period stated above, from the date of purchase, provided that the product is used in accordance with accompanying recommendations or instructions where provided. This warranty is in addition to your rights under the Australian Consumer Law.

Kmart will provide you with your choice of a refund, repair or exchange (where possible) for this product if it becomes defective within the warranty period. Kmart will bear the reasonable expense of claiming the warranty. This warranty will no longer apply where the defect is a result of alteration, accident, misuse, abuse or neglect.

Please retain your receipt as proof of purchase and contact our Customer Service Centre on 1800 124 125 (Australia) or 0800 945 995 (New Zealand) or alternatively, via Customer Help at Kmart.com.au for any difficulties with your product. Warranty claims and claims for expense incurred in returning this product can be addressed to our Customer Service Centre at 690 Springvale Rd, Mulgrave Vic 3170.

Our goods come with guarantees that cannot be excluded under the Australian Consumer Law. You are entitled to a replacement or refund for a major failure and compensation for any other reasonably foreseeable loss or damage. You are also entitled to have the goods repaired or replaced if the goods fail to be of acceptable quality and the failure does not amount to a major failure.

For New Zealand customers, this warranty is in addition to statutory rights observed under New Zealand legislation.