

Weight Plate Stand

Key Code: 43035991

Thank you for purchasing the sturdy and compact Weight Plate Stand. This product is designed to keep your workout area organized and to provide easy access to your weights.

Product

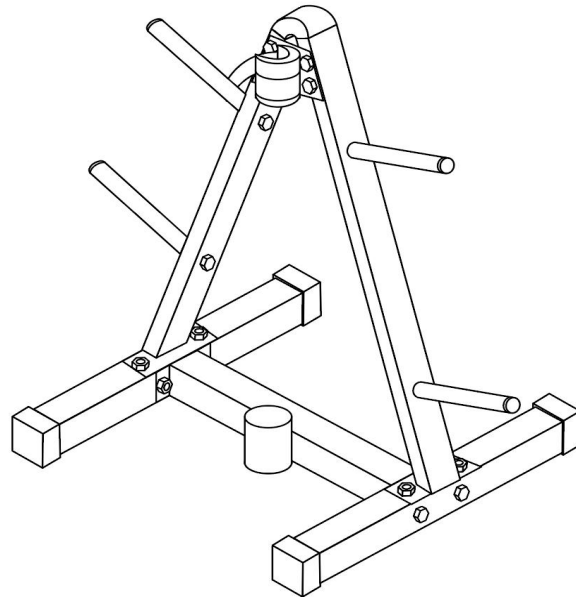

Parts and Hardware List & Exploded Drawing

1. Stabilizer x 2pc
2. Cross Bar x1pc
3. Right Upright Pole x1pc
4. Left Upright Pole x1pc
5. Weight Tube x4pc
6. Curl Bar Holder x1pc
7. Top Cap x1pc
8. M8 x 61mm Carriage Bolt x4pc
9. M8 Washer x11pc
10. M8 Lock Nut x11pc
11. M8 x 65mm Bolt x7pc
12. M12 x 16mm Bolt x4pc
13. 8mm Alley Wrench x1pc
14. Clip x4pc

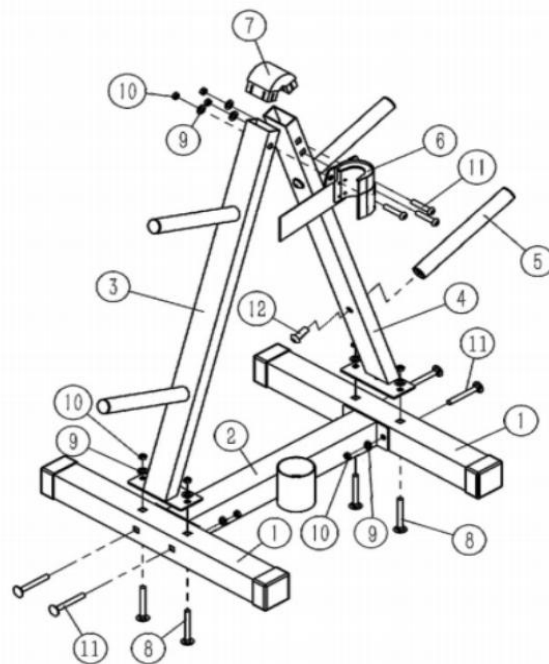

Assembly Instruction

Note: To assemble easily and successfully, please keep the bolts 70% of tightness while installing the parts, then fasten all the bolt and nuts fully after finished assembly.

Step 1. Connect 2pc stabilizer (1) and 1pc cross bar (2) together, then secure them with bolt, washer and nut (9,10,11).

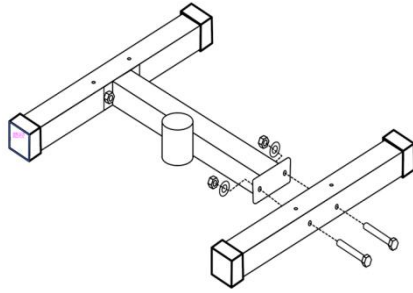

Step 2. Put right & left upright pole (3,4) on the part of step 1, then secure them with bolt, washer and nut (8,9,10). Insert the top cap (7) into the tube of right & left upright pole.

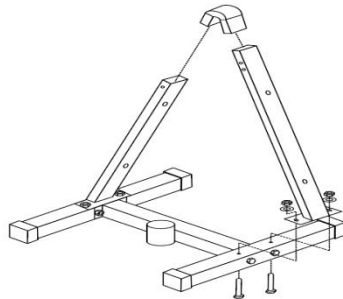

Step 3. Connect curl bar holder (6) and the part of step 2 together, then secure them with bolt, washer and nut (9,10,11)

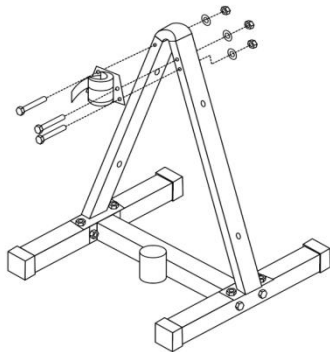

Step 4. Insert the 4pcs weight tube (5) into the hole of right & left upright pole, secure them with bolt (12). After this. The product is finalised and ready for use.

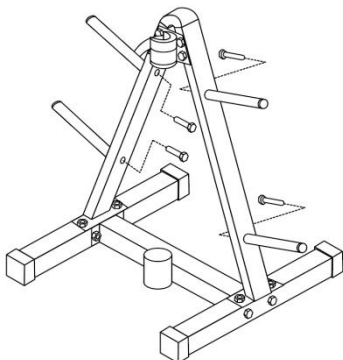

WARNING:

1. Always put a clip on the outside of weight tube to prevent the weight plate coming off.
2. The product must be placed on a hard, flat surface, cover the floor with carpet to prevent damage to the ground.
3. Check the parts and tighten all bolts and nuts regularly, never use the product if all components are **NOT** fully secure.
4. Always keep children away from the product unless they are supervised by an adult.
5. Wipe clean with damp cloth. Do not use abrasive materials or solvents.
6. Always store the product on a flat surface, and in a dry and well ventilated area.

FOR AU/NZ: IMPORTED FOR KMART STORES IN AUSTRALIA AND NEW ZEALAND.

Made in China