

# anko INSTRUCTION MANUAL

## Wooden Ice-cream Shop

3+  
years

### PARTS LIST

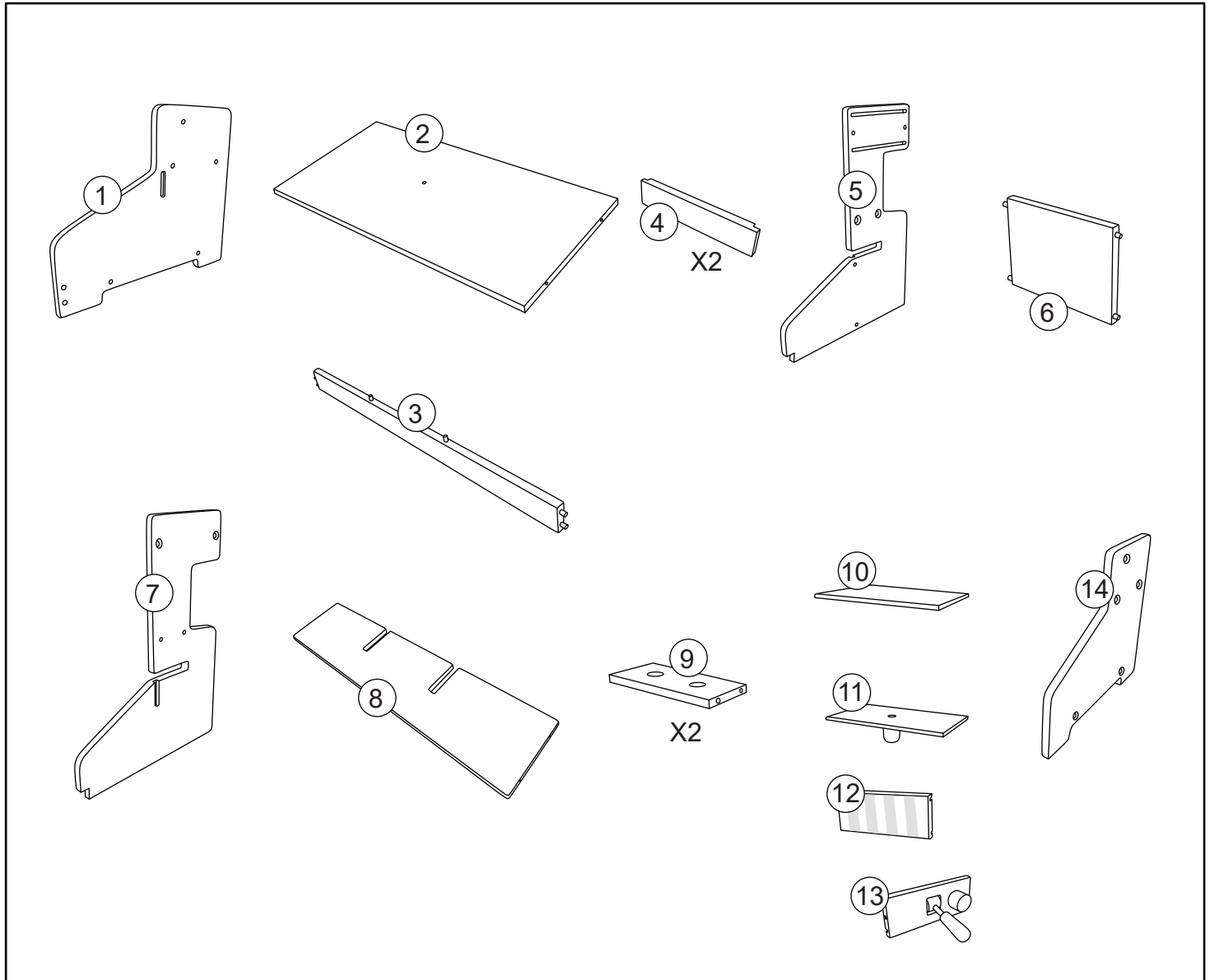

### HARDWARE

A  X19

Cross screwdriver  
(not included) 

## STEP 1

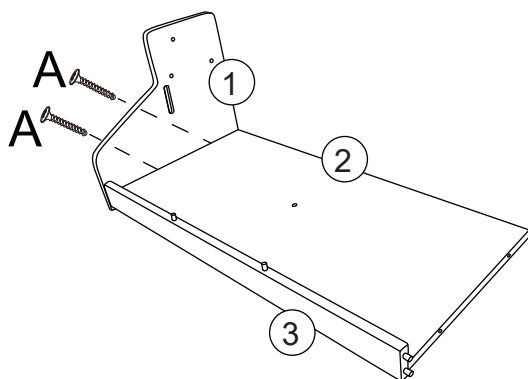

## STEP 2

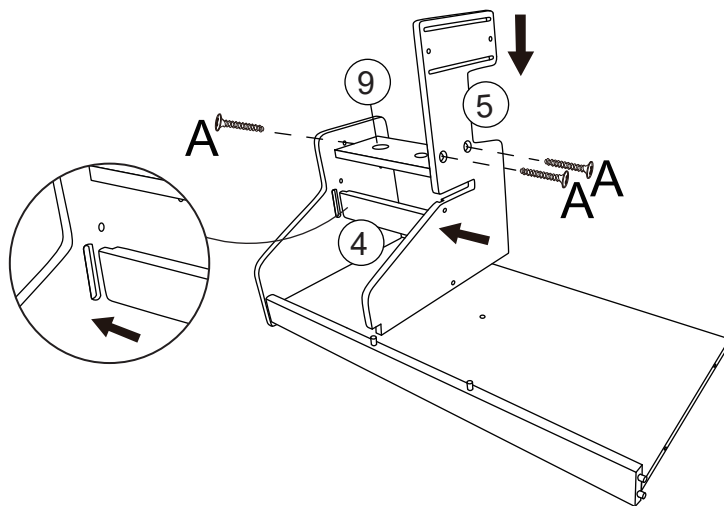

## STEP 3

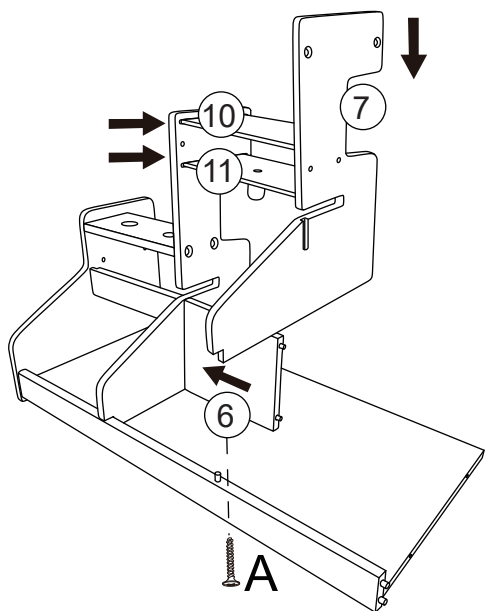

## STEP 4

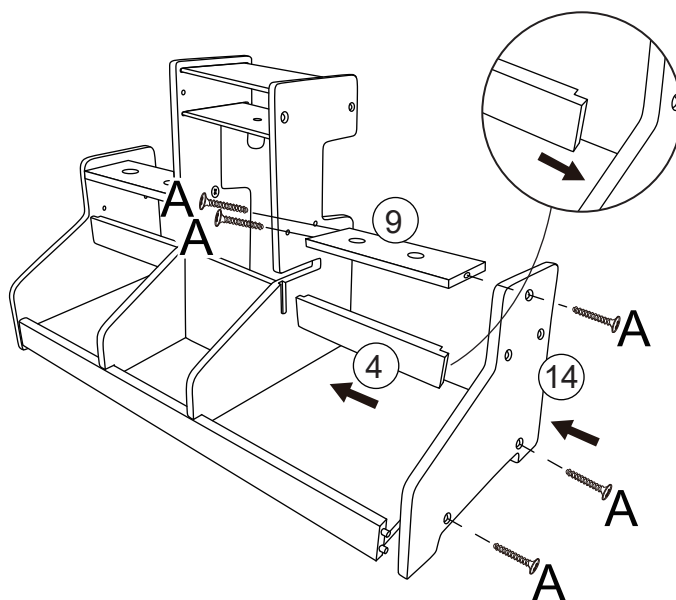

## STEP 5

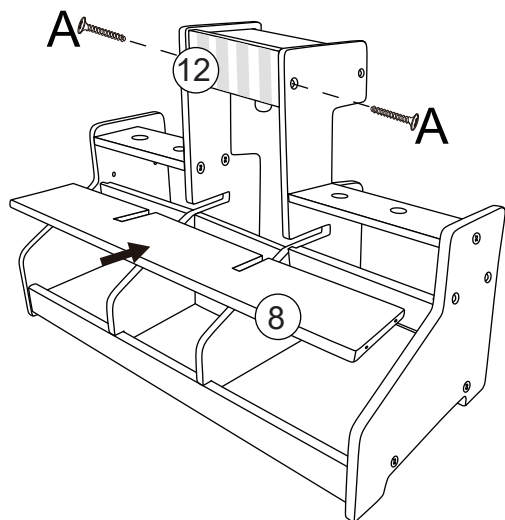

## STEP 6

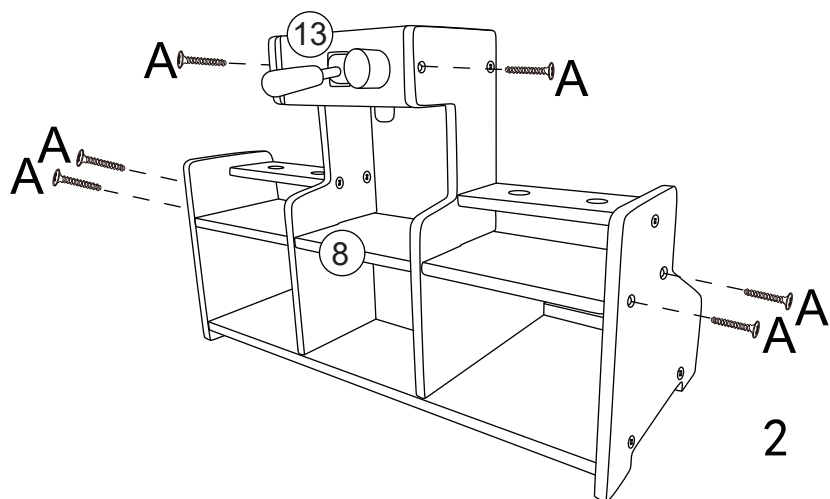

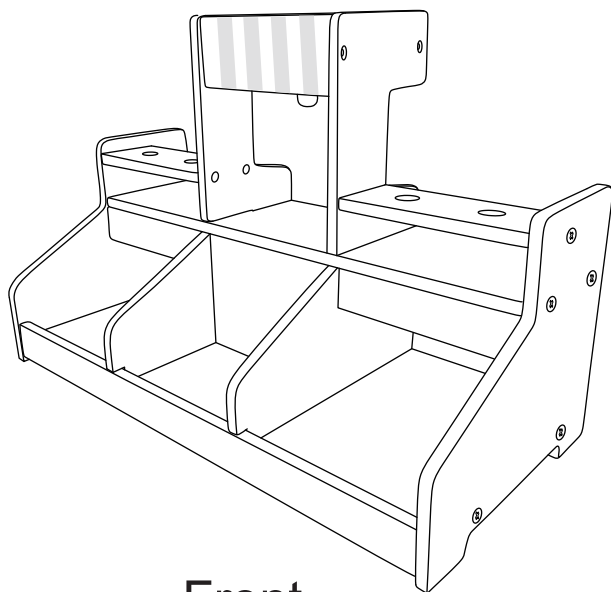

Front

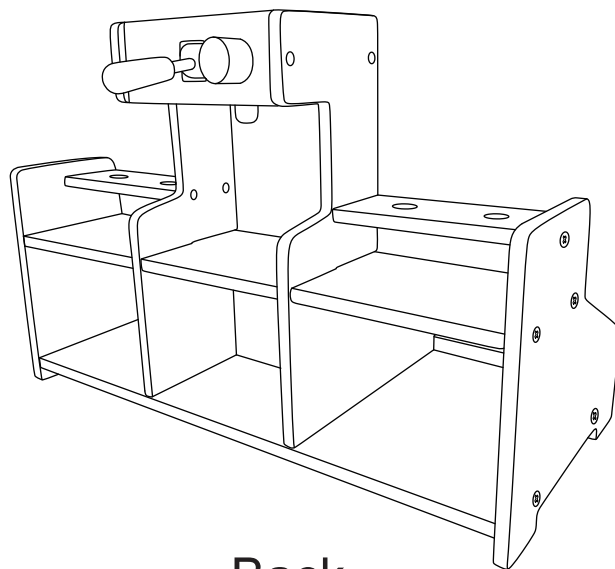

Back

## Assembly Instructions

- Check all components are present before assembling.
  - The toy requires adult assembly.
  - In unassembled state, product contains hardware with sharp points.
- Keep unassembled parts out of reach of small children.  
 Cross screwdriver(not included) is required for assembly.  
 Dispose of all packing materials carefully after assembly.

## Maintenance

Inspect the product before assembly and periodically during use.  
 Never use this product if there is any loose or missing fasteners,  
 points or broken parts.  
 Regularly check that all fittings remain tight.Tighten if required.

Keycode: 43029198

MADE IN CHINA

© KMART AUSTRALIA LIMITED