

How to install?

Step 1

Press axis switch to adjust degree of the first leg.

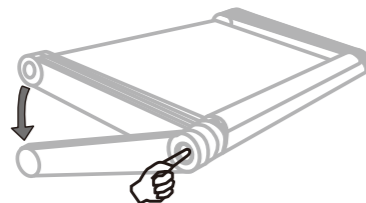

Step 2

Press axis switch to adjust degree of second leg.

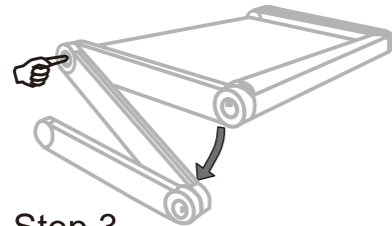

Step 3

Press axis switch to adjust degree of the table. If you want to use different angles, you can adjust angle by pressing axis switches.

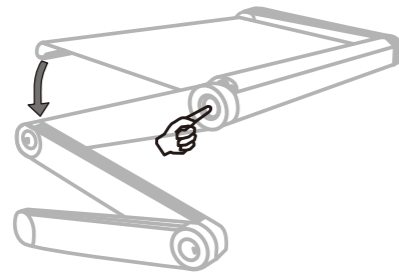

How to fold?

Step 1

Press table axis switch to level with second leg.

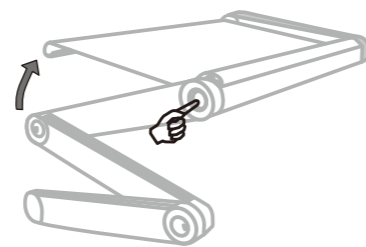

Step 2

Level first and second leg.

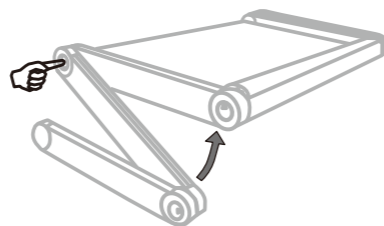

Step 3

After all legs are level with table it is folded.

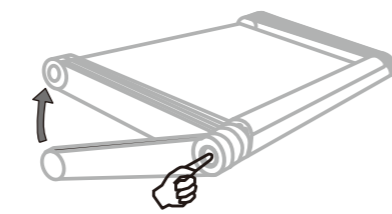

WARNING: PUT THE DESK TO A HARD AND FLAT AREA TO USE. WHEN SETTING UP OR ADJUSTING THE DESK, DON'T LEAVE THE COMPUTER ON IT TO AVOID COMPUTER FALLING OFF. ENSURE LEFT AND RIGHT AXIS SWITCH IS ADJUSTED TO KEEP THE LEGS AT THE SAME DEGREE. DON'T PLACE WATER CUP ON THE DESK.

Max rated Loading: 7.5KGS

Height and angle adjustment

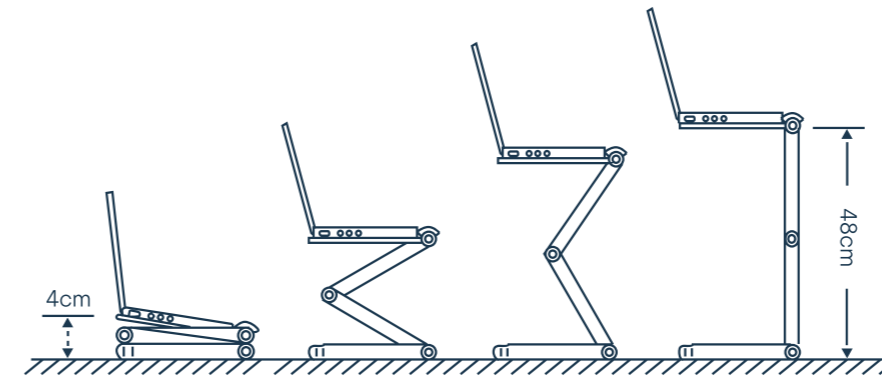

Multiple functions

