

anko

INSTRUCTION MANUAL

Touch Button Electric Single Breast Pump

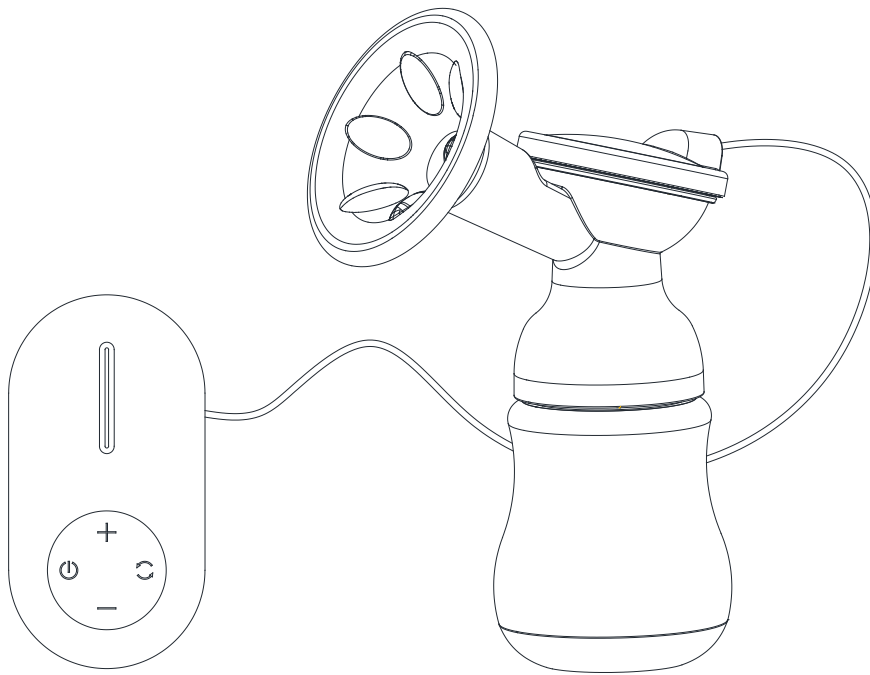

PLEASE READ CAREFULLY BEFORE USE AND KEEP FOR FUTURE REFERENCE.

The illustrations shown in this manual are for reference only. The manufacturer reserves the right to change any specification or feature without further notice.

WARNING: For the purpose of recharging the battery, only use the detachable supply unit provided with the appliance.

Caution:

1. Please read the instructions carefully before use.
2. Do not place this electrical device into water or into a steam steriliser.
3. Ensure you do not twist the connecting tube or knot during use.
4. Please seek medical advice and guidance when using this product in less lactation stage.
5. For hygiene reasons, do not share this product with anybody else.
6. This appliance is not to be used by any person with reduced physical, sensory or mental capabilities, or lack of experience and knowledge, unless under supervision.
7. This item is not a toy. Do not allow children to use or play with it. KEEP THIS ITEM AWAY FROM BABIES AND CHILDREN.
8. Do not disassemble this product if it is damaged.
9. This appliance contains batteries that are non-replaceable.

Contents:

Full set Electric Single Breast Pump x 1

Micro USB charging cable x 1

Spare Gas check valve x 1

User manual x 1

Product specification:

Keycode	42963097
Product Name	Touch Button Electric Single Breast Pump
(Power Supply)	DC 5V /2A

Product Features:

Electric breast pump adopts stimulation lactation and normal Suckling mode to simulate the baby's sucking, which is designed for the mother's breastfeeding.

Professional lactation and milking to relieve the pain of breast swelling.

5V energy saving, USB multiple power supply mode.

Product components

Please check the product parts before use. If there are any missing parts, please contact the dealer.

(Note: the below illustration is for reference only).

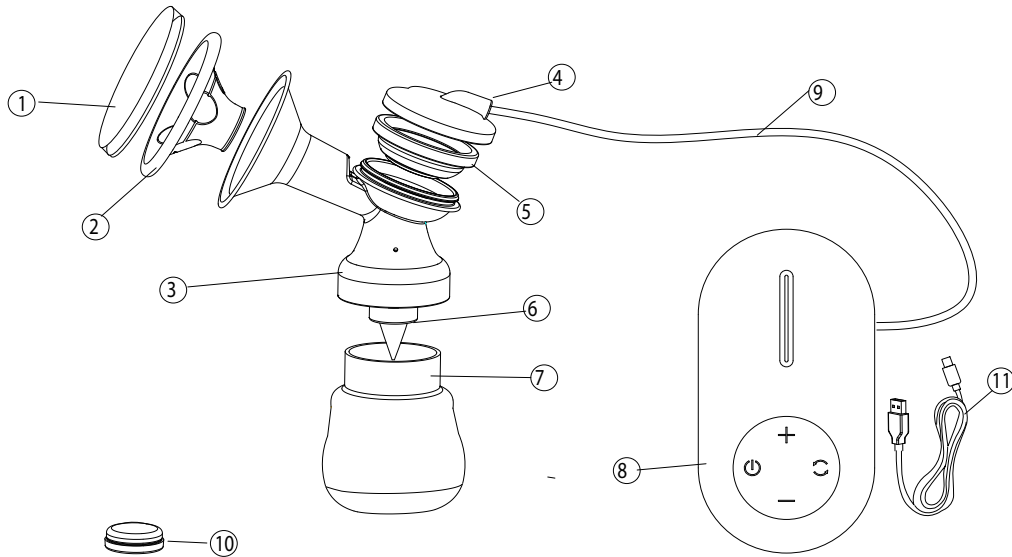

No.	Part Name	Material	Heat resistance temperature	Quantity
1	Anti Dust cover	PP	-20~120℃	1
2	Massage petals	Silicone	-20~200℃	1
3	Electric suction tee	PP	-20~120℃	1
4	Suction strap cap	PP	-20~120℃	1
5	Silicone suction cap	Silicone	-20~200℃	1
6	Gas check valve	Silicone	-20~200℃	2
7	Milk Bottle	PP	-20~120℃	1
8	Main Engine	ABS	-20~80℃	1
9	Air pipe	Silicone	-20~200℃	1
10	Milk bottle screw cap	PP	-20~120℃	1
11	USB power cord			1

Assembly Method

Note: the below illustrations are for reference only.

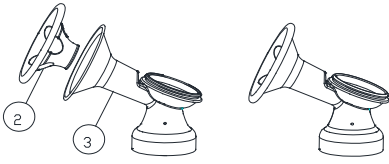

Place the massage petal (2) into suction tee (3). Ensure to cover the edge of the suction tee with the groove of the massage petal to ensure a close match.

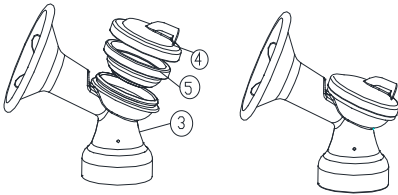

First, put silicone suction cap (5) into suction tee (3), Ensure to cover the suction tee edge with the edge groove of silicone suction cap. Then press the suction strap cap (4) onto the suction tee. Refer to the above illustration.

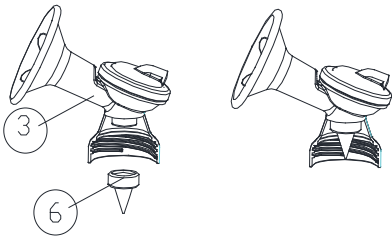

Place the gas check valve (6) on the bottom of the suction tee (3) as shown.

Note: Carefully hold the gas check valve to prevent damage. Do not use the gas check valve if it is damaged. Replace it with a new one.

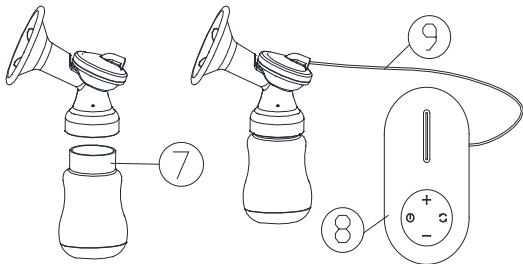

Screw the milk bottle (7) into the bottom of the suction tee (3), and connect the air pipe (9) with the main engine (8) as shown in the above illustration. Ensure to insert tightly to prevent air leakage.

Operation instructions

1. The machine has 4 keys in total: on-off key  lactation and suction mode switch key  gears plus key  gear reduction key .

Indicator Light:

Blue for lactation mode, white for suction mode.

When charging, white is charging in progress, blue is fully charged.

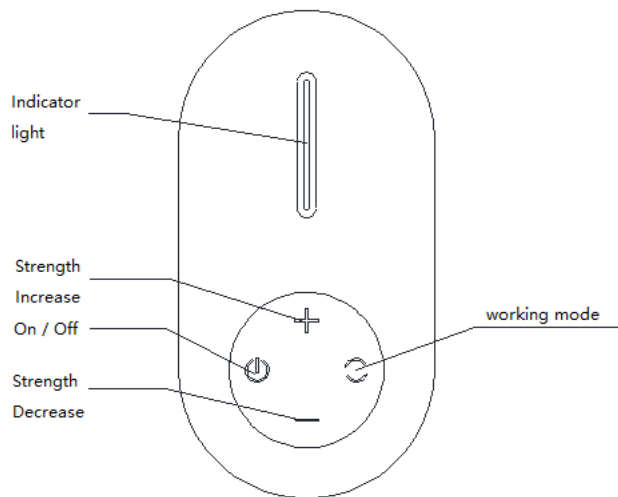

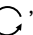
2. Please wash your hands before use and make sure the breast pump components are thoroughly cleaned and properly assembled.
3. The user maintains a normal and relaxing sitting position. Place a footstool under your feet during breast sucking to help maintain a sitting position and avoid pressing on the waist. (a warm towel can be used to hot compress and massage the breast before breast suction).
4. Aim the assembled suction tee at the nipple and hold it tightly against the breast with the other hand to ensure no air enters.
5. Press the “” key on the main engine to automatically enter the buffer breast collection mode-- the indicator light will turn blue. The massage stage has a small suction so as to massage the breast and stimulate the breast. Press "+", "-" in the process of use to adjust the selection of appropriate gear. The lactation mode has 5 strength gears in total. Each time the "+" or "-" button is pressed, the indicator light flashes once. When the indicator continuously flashes rapidly, it means that the gear has reached maximum strength or first gear. (note: the lactation will automatically enter the suction mode after 3 minutes).
6. Press the suction mode switch key “” on the main engine. When the indicator light turns white, it enters the regular breast suction mode. There are 9 suction strength gears in this mode. During usage you can touch "+" and "-" several times to adjust and select the right gear and lactation strength.

Tips for use

How to find the most suitable suction for you personally:

Gradually increase the suction until you feel slightly uncomfortable and then slightly reduce the suction.

Recommended to use the routine "suction" function directly after the "lactation" mode.

The breast pump automatically shuts down after default working time of 30 minutes.

Storage/heating of breast milk- For reference

After the breast milk is absorbed, the collected breast milk is to be sealed in a storage bag or other container and then stored in the fridge.

Note: This Table is only for healthy full-term infants.

	room temperature	fridge compartment	fridge freezer
Fresh breast milk	Do not place at room temperature	Store for 3-5 days at 4 °C	Store at -16 °C for 6 months
Thawed breast milk	Do not store	10 hours	Do not freeze again

When freezing, in order to keep space for liquid expansion, do not fill milk more than 3/4 of the total capacity of the container.

In order to ensure that the nutrients are not lost, the breast milk should be thawed in the fridge's freezer or thawed in warm water. Before feeding, shake the milk container gently so that the milk fat can be evenly distributed.

WARNING: Do not microwave or boil. Always test the temperature of the milk before feeding.

Cleaning method:

Before first use, place feeding bottle and accessories in boiling water for 5 minutes. This is to ensure hygiene.

Before sterilising, wash accessories thoroughly in warm soapy water to ensure all milk deposits are removed.

Sterilise by immersing in a feeding bottle sterilising solution.

Do not clean or allow to come into contact with solvents or harsh chemicals. Damage could result.

Please disassemble all accessories that come into contact with your breasts.

Please clean the accessories immediately after use. Please keep in a cool and ventilated place after cleaning.

When disassembling or assembling, ensure that each component is assembled in the correct sequence.

Do not place the electrical device into water for washing or into a steam steriliser.

Troubleshooting Methods

Failure Phenomenon: The appliance cannot work.

Solution:

1. Check the battery power; replace the power adapter; make sure that the adapter interface is inserted into the host's DC interface correctly.

Failure Phenomenon: Insufficient suction

Solution:

1. Replace the parts of the closed valve; check whether the closed valve is installed correctly or not; usually put the closed valve in boiling water for 3 minutes and re-install it, then the suction can be restored.
2. Battery power is insufficient; when the indicator light becomes dim, it means that the power is insufficient. Please charge it in time before use.
3. Check if the breast cover and the breast are completely fitted and there is no air leakage.
4. If the room temperature is below 15 °C, please continue to run for 30 seconds before breast sucking operation.

12 Month Warranty

Thank you for your purchase from Kmart.

Kmart Australia Ltd warrants your new product to be free from defects in materials and workmanship for the period stated above, from the date of purchase, provided that the product is used in accordance with accompanying recommendations or instructions where provided. This warranty is in addition to your rights under the Australian Consumer Law.

Kmart will provide you with your choice of a refund, repair or exchange (where possible) for this product if it becomes defective within the warranty period. Kmart will bear the reasonable expense of claiming the warranty. This warranty will no longer apply where the defect is a result of alteration, accident, misuse, abuse or neglect.

Please retain your receipt as proof of purchase and contact our Customer Service Centre on 1800 124 125 (Australia) or 0800 945 995 (New Zealand) or alternatively, via Customer Help at Kmart.com.au for any difficulties with your product. Warranty claims and claims for expense incurred in returning this product can be addressed to our Customer Service Centre at 690 Springvale Rd, Mulgrave Vic 3170.

Our goods come with guarantees that cannot be excluded under the Australian Consumer Law. You are entitled to a replacement or refund for a major failure and compensation for any other reasonably foreseeable loss or damage. You are also entitled to have the goods repaired or replaced if the goods fail to be of acceptable quality and the failure does not amount to a major failure.

For New Zealand customers, this warranty is in addition to statutory rights observed under New Zealand legislation.

KEYCODE: 42963097

MADE IN CHINA

© KMART AUSTRALIA LIMITED

FOR AU/ NZ: IMPORTED FOR KMART STORES IN AUSTRALIA AND NEW ZEALAND.

KMART AUSTRALIA – 690 SPRINGVALE ROAD, MULGRAVE, VIC 3170 AUSTRALIA.

KMART NEW ZEALAND – REGIONAL OFFICE C/O KMART PAPATOETOE STORE, HUNTERS PLAZA, GREAT SOUTH ROAD, PAPATOETOE, AUCKLAND, NEW ZEALAND.