

anko Gaming Mouse Instruction Manual KC42902058



*Please read all the information carefully before you use the product and keep the manual for future reference.

100.0 mm

100.0 mm

Safety Instructions:

Please read the instruction manual before using this device and follow all the safety instructions to avoid damage caused by improper use.

- Keep the instruction manual for future reference. Should this device be given to a third party, then this instruction manual must also be handed over.
- Use this device solely for its intended purpose.
- Only use this appliance indoors
- Keep the appliance away from all hot surfaces and naked flames.
- Always put the appliance on a level, stable, clean, dry surface.
- Protect the appliance from extreme heat and cold, dust, direct sunlight, humidity and drops or jets of water.
- Do not immerse the appliance in water or in other liquids.
- Do not open the housing under any circumstances. Do not introduce any objects into the interior of the housing.
- Should the device malfunction due to electrostatic discharge or a short power surge, disconnect it from your computer and then reconnect it again.

100.0 mm

Product overview:



Connecting the Mouse :

1. Plug the USB cable into a free USB port on the computer.
2. The Mouse will connect automatically and can be used immediately.

100.0 mm

Feature:

- DPI value: 1000-2400-3600-5000-7000-10000DPI (which can be set)
- Default lamplight DPI first level/red, second level/green, three level/blue, four level/yellow, five level/Cyan, six level/purple.
- 6 kinds of RGB light effect. (YO-YO mode / Neon mode / Breathing mode / Wave mode / Steady mode / LED OFF) The RGB light mode can be adjusted by "Left button + Right button".
- For more customized functions, please visit <http://www.in-trainindustry.com/downloads.html> to download the KM42902058 driver.



100.0 mm

Supports:

Windows 2000/XP/Vista/Windows 7/8/10

Main interface of Driver and functions description:

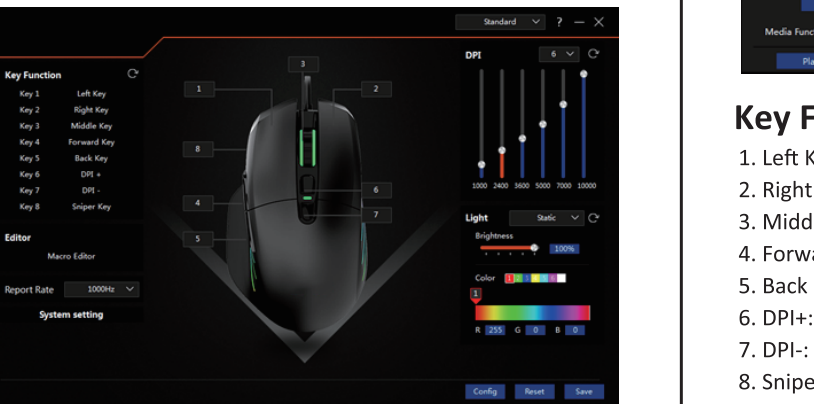

100.0 mm

Key Function:

1. Left Key: left key function
2. Right Key: right key function
3. Middle Key: middle key function
4. Forward Key: enter to next page
5. Back Key: back to previous page
6. DPI+: switch to higher DPI value, without loop switch
7. DPI-: switch to lower DPI value, without loop switch
8. Sniper Key: locking DPI
9. Double Fire: Equivalent to click the left key for 2 times

100.0 mm

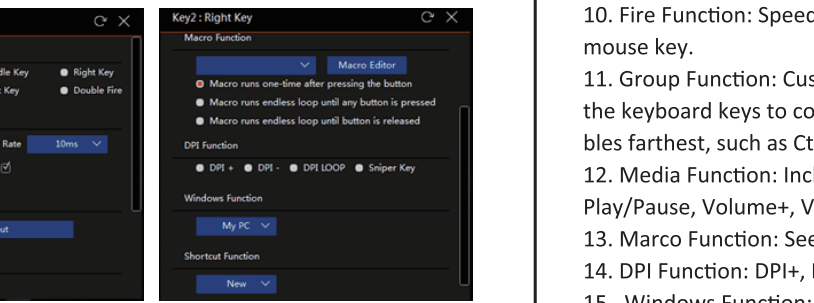

100.0 mm

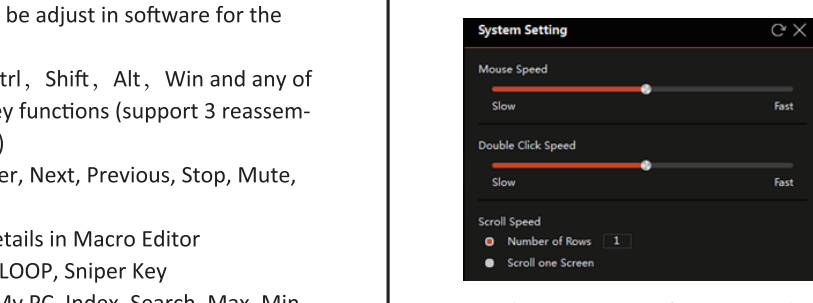

100.0 mm

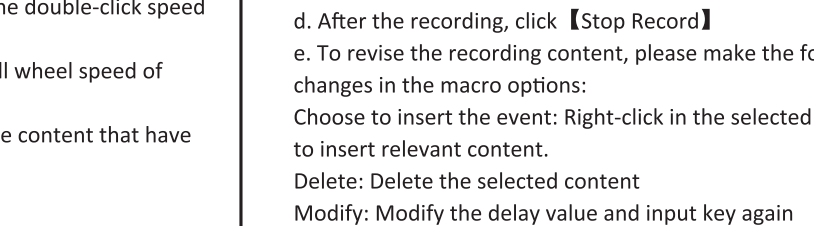

100.0 mm

10. Fire Function: Speed rate can be adjust in software for the mouse key.
11. Group Function: Customize Ctrl, Shift, Alt, Win and any of the keyboard keys to combine key functions (support 3 reassembles farthest, such as Ctrl + A + B)
12. Media Function: Include Player, Next, Previous, Stop, Mute, Play/Pause, Volume+, Volume-.
13. Marco Function: See more details in Macro Editor
14. DPI Function: DPI+, DPI-, DPI LOOP, Sniper Key
15. Windows Function: Include My PC, Index, Search, Max, Min, Desktop, Run
16. Shortcut Function: Include New, Cut, Copy, Paste, Save, Print, Find, Redo, Undo, Select All.

Macro Editor :

Macro management can record any keys of keyboard and the keys reaction time, number of keys cycles.

- a. Click **【New】** to create a new file, such as a, b, c...
- b. Select whether to increase the delay and the times of cycles
- c. Click **【Start Record】** and start recording any keys of keyboard. The keys you recorded will display in the macro edit box.
- d. After the recording, click **【Stop Record】**
- e. To revise the recording content, please make the following changes in the macro options:
Choose to insert the event: Right-click in the selected location to insert relevant content.
Delete: Delete the selected content
Modify: Modify the delay value and input key again

100.0 mm

- f. After recording is completed, just exit the macro recording interface, no need to click the confirmation keys
- g. Execute a macro, such as the mouse key (4) key set to "macro functions", after recording is complete, press the mouse (4) key to play the recorded content

DPI settings:

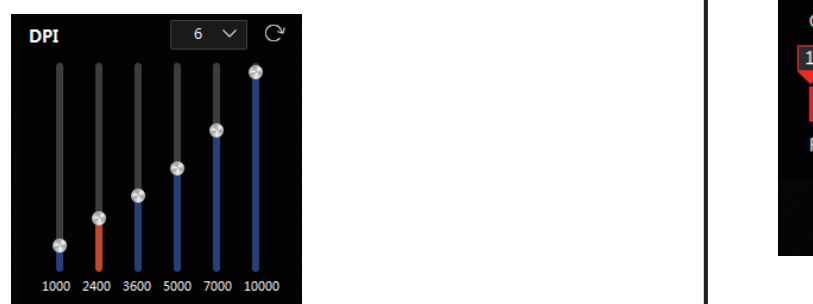

100.0 mm

1. Six groups DPI: gear 1 / gear 2 / stalls 3 / stalls 4 / stalls 5 / stalls 6, check the selections
2. DPI setting: set the 6 groups DPI value, adjust the range of 200 ~ 10000DPI

Lighting settings:

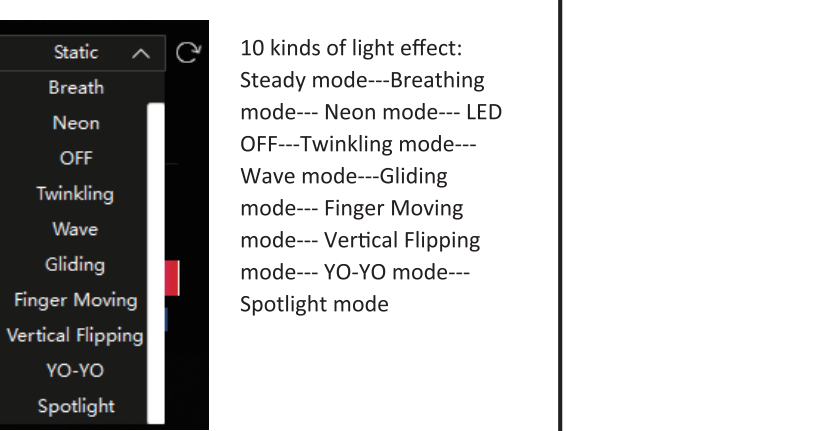

100.0 mm

Uninstall:

Open the control panel and open the "Add or Remove Programs" window, find "KM42902058 Gaming Mouse" and click "delete" to complete the uninstall program.

100.0 mm