

ROBO ALIVE COLLECTION



Robotic Enhanced Motion  
Predator Warning Colouration  
Light Reflecting Eyes  
Continuously Flicking Tongue

LIFELIKE ROBOTIC SNAKE

1. PLAY INSTRUCTIONS

- First insert 2xAAA/LR03 alkaline batteries (not included in pack)
- Use the ON/OFF switch on the underneath of your Snake's head to turn him ON and OFF. Don't forget to turn OFF your Snake while you are not playing to conserve battery power.
- Get the most out of your Snake by playing on flat, smooth surfaces. Your Snake is not suitable for carpet or other non-smooth surfaces as well as uneven surfaces.

**TIP:** If your Snake starts to slither more slowly than when you first got him, it'll mean his batteries are running low. 2x AAA/LR03 batteries will last approximately 160 minutes.

2. CHANGING THE BATTERIES (BATTERIES NOT INCLUDED)

Note: Batteries should only be handled by an adult and kept away from children.

- Press down on the button on the first rung of your Snake. Then pull gently on the rest of the body to detach the full tail as shown in picture.
- Turn the head of your Snake over and check to ensure the ON/OFF button is in the OFF position.
- Using a crosshead screwdriver, unscrew the screw on the battery cover and remove the batteries. Remove the old batteries and replace with the following: 2x AAA/LR03 alkaline batteries. Pay attention to the - and + signs on the batteries and on your Snake, ensuring these are aligned when inserting into the battery case.
- Place the battery cover back on and screw tightly closed. Hold down the same button on the top first rung of your Snake and connect the rest of the body back onto the Snake head.

**WARNING:** Keep your Snake away from long hair while turned ON. Hair can get caught in moving wheels.

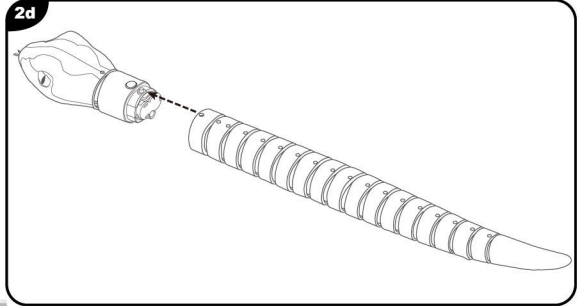
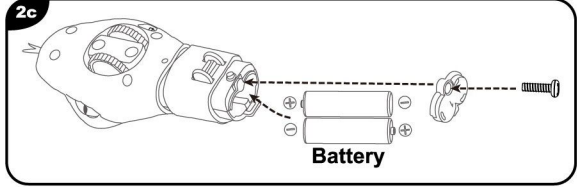
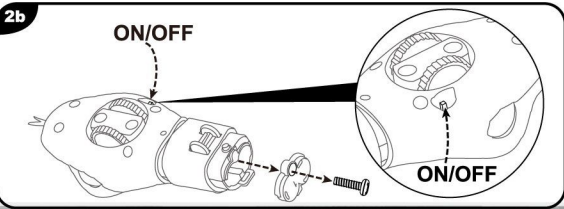
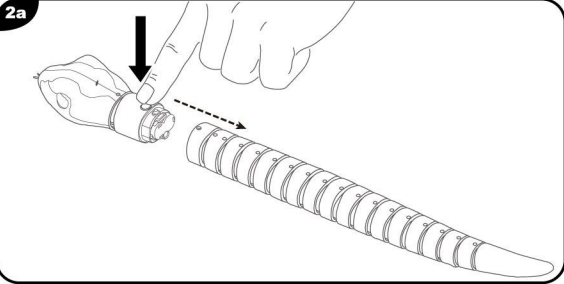

3. CONNECTING YOUR SNAKE BACK TOGETHER

If by chance pieces of your Snake come loose or become disconnected from each other it is important to reconnect them in the right order shown below. There are 19 pieces that make up your Snakes body and you can find these numbers on each piece. Connect them back together in the order shown here following figures 3a and 3b.

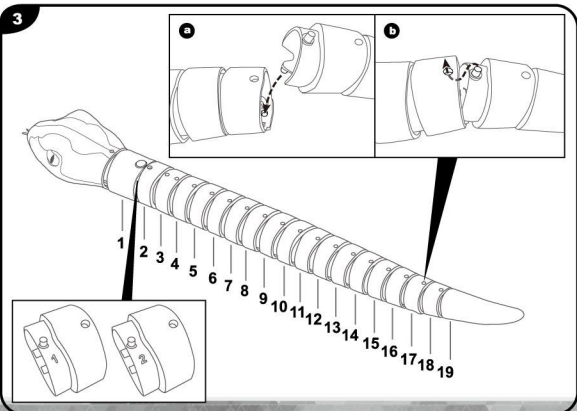

IMPORTANT: BATTERY INFORMATION

**CAUTION:** To prevent entanglement, keep hair away from wheels.

AAA/LR03 batteries are classified as small parts and should be kept away from small children and children who are prone to putting things in their mouths. If batteries are swallowed, see a doctor immediately and have your doctor call a poison control centre. Always follow the instructions, inserting batteries correctly and matching the - and + signs. Do not mix old and new batteries or carbon-zinc batteries with alkaline batteries. IMMEDIATELY remove and dispose of old batteries from the product and remove the batteries if the product is not going to be played with for a significant length of time. Always store batteries in the blister so they are not touching each other. Do not bring batteries in contact with water.

To discard batteries, please wrap batteries individually in paper or tape after removing from your Snake as per image above. Discard immediately. Do not leave sitting out. Should this product be affected by local electrical interference, move it away from other electrical equipment.

Reset if necessary by removing and then reinserting the batteries. Non-rechargeable batteries are not to be recharged. Rechargeable batteries are to be removed from the toy before being charged. Rechargeable batteries are only to be charged under adult supervision. Do not short circuit the supply terminals.



**WARNING:**  
CHOKING HAZARD-Small parts.  
Not for children under 3 years.



COLLECT THEM ALL  
REAL-LIFE ROBOTIC PETS

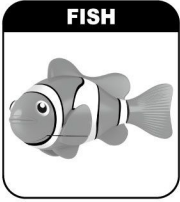

AGES  
3+



REAL-LIFE ROBOTIC PETS!

SLITHERING  
SNAKE