

# Instruction Manual

## Jackeroo 12 Person Cabin Tent (Keycode: 42120834)

### Product Image-



### Parts list-

No.	Part name	Quantity	Image
1	Inner tent body	X1	
2	Flysheet	X1	
3	Room divider sheet	X1	
4	Steel pole A(2M)	X4	
5	Steel pole B(1.9M)	X2	
6	Steel pole C(2.4M)	X2	
7	Fiberglass pole D(3.94M)	X2	
8	Fiberglass pole E with grey marking (2.55M)	X1	
9	Steel awning pole F(1.8M)	X2	
10	Plastic three ways knuckle G with red marking (attached to inner)	X2	
11	Plastic three ways knuckle H with red marking (attached to inner)	X2	
12	Plastic two ways knuckle I (attached to inner)	X2	
13	Guy ropes	X8	
14	Pegs	X18	

**Please read all instructions carefully and make sure you have all parts before starting to assemble**

### Assembly steps-

#### Step 1,

Locate all the poles and assemble them as shown below.



Pole A(2M)



Pole B(1.9M)



Pole C(2.4M)

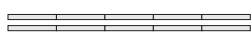

Pole D(3.94M)



Pole E(2.55M)



Pole F(1.8M)

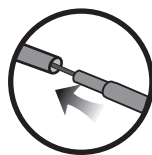

#### Step 2,

Spread out the inner tent body. Insert the pole D & E through the pole sleeve on the inner tent body, insert all the pole end into the knuckle. Match the color marking. Insert the pole C into knuckle and attach the hooks to each pole.

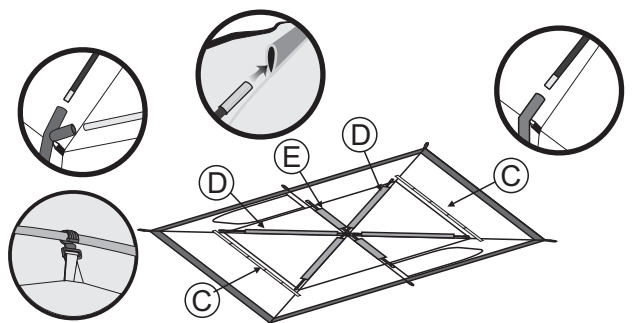

### Step 3,

Erect the tent with pole A and B, insert into the knuckle and insert the pin in the pole end at the bottom of each corner.

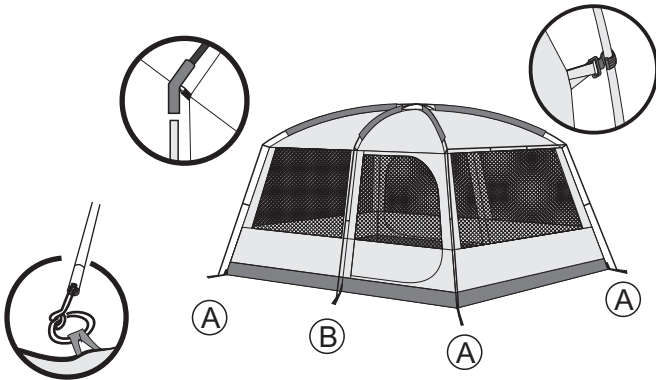

### Step 4,

Cover the flysheet body on the inner tent. Fix the bottom corners with buckle on the inner tent body. Move the tent to where you want to build your campsite. Peg down and secure the pre-attached guy ropes. Erect the door on flysheet body with pole F to make a canopy area. The tent is complete.

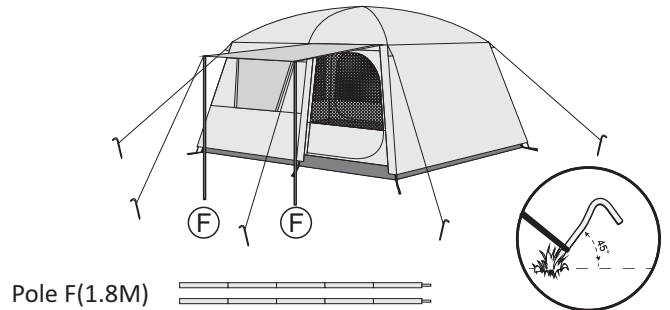

## Warning -

- KEEP ALL FLAME AND HEAT SOURCE AWAY FROM THIS TENT FABRIC
- DO NOT USE CANDLE, MATCHES OR OPEN FLAME OF ANY KIND IN OR NEAR THE TENT
- DO NOT COOK INSIDE THE TENT
- DO NOT SMOKE IN THE TENT
- DO NOT STORE FLAMMABLE LIQUIDS INSIDE THE TENT
- EXTINGUISH OR TURN OFF ALL LANTERNS BEFORE GOING TO SLEEP
- CHOOSE LEVEL SITE TO ERECT TENT THAT IS CLEAR FROM OVERHANGING BRANCHES AND NOT IN LOW LYING AREAS THAT COULD BE SUBJECT TO FLOODING

## Care instruction-

- WIPE CLEAN WITH A DAMP CLOTH
- DO NOT USE ABRASIVE MATERIALS AND SOLVENTS
- ENSURE TENT IS CLEAN & DRY BEFORE PACKING OR STORAGE TO PREVENT DAMAGE FROM MOULD & MILDEW

Made In China