

# anko

**Food Processor**

**WCP-06A**

**User Manual**



**PLEASE READ AND SAVE THESE  
INSTRUCTIONS FOR FUTURE REFERENCE**

# IMPORTANT SAFEGUARDS

When using any electrical product, always follow these basic safety precautions:



## READ ALL INSTRUCTIONS BEFORE USE.

1. This appliance is not intended for use by persons (including children) with reduced physical, sensory or mental capabilities, or lack of experience and knowledge, unless they have been given supervision or instructions concerning use of the appliance by a person responsible for their safety.
2. Children should be supervised to ensure that they do not play with the appliance. Close supervision is necessary when the appliance is used near children. Keep the appliance out of the reach of children.
3. **THIS PRODUCT IS INTENDED FOR HOUSEHOLD USE ONLY.** Do not use this appliance for anything other than its intended use. Do not use outdoors.
4. **WARNING! Misuse of the appliance may cause injury!**
5. Check the voltage indicated on the appliance corresponds to the local mains voltage before you connect the appliance.
6. **DO NOT** immerse the appliance or the power plug and cord in water or any other liquid.
7. **DO NOT** operate the appliance with wet hands.
8. **DO NOT** leave the appliance unattended when in use.
9. Remove the power cord from the electrical power outlet socket when not in use, before assembling or disassembling parts and before cleaning. To unplug, grasp the plug and pull from the mains power outlet socket. Never pull from the power cord.
10. **DO NOT** abuse the power cord. Never carry the appliance with the power cord or yank it to disconnect from the electrical outlet.
11. **DO NOT** let the power cord hang over the edge of the table or counter or touch hot surfaces such as the stove.
12. If the power cord is damaged, it must be replaced by a qualified electrical person to avoid a hazard or the appliance must be disposed of.
13. **DO NOT** operate the appliance with a damaged cord or plug, after the appliance malfunctions, or has been dropped or any parts damaged in any manner.
14. Always use the appliance on a dry, level surface. Sinks, drain boards or uneven surfaces must be avoided.
15. **DO NOT** operate this appliance on or near any hot surface (such as gas or electric burner or in a heated oven).
16. The use of attachments or accessories not supplied with the product may cause fire, electric shock or personal injury.
17. **DO NOT** overfill. **DO NOT** operate the appliance empty.
18. **CAUTION: The blades and discs are sharp, handle with care.** Use caution when emptying the bowl, cleaning the appliance or when attaching or detaching parts.
19. **CAUTION:** To avoid a hazard due to inadvertent resetting of the thermal cut-out, this appliance must not be supplied through an external switching device, such as a timer, or connected to a circuit that is regularly switched on and off by the utility.

20. Avoid contact with moving parts. Always disconnect the appliance from the mains power and wait until all the parts come to a complete stop before attaching or detaching parts.
21. **WARNING!** DO NOT process hot liquids or ingredients. Hot liquids/ingredients can eject out of the appliance due to sudden steam and cause severe scalding. Allow hot ingredients to cool down before placing them in the bowl.
22. For cleaning, please refer to CLEANING AND STORAGE section.
23. The appliance is intended to be used in household and similar applications such as:
  - staff kitchen areas in shops, offices and other working environments,
  - farmhouses,
  - by clients in hotels, motels and other residential type environments,
  - bed and breakfast type environments.
24. **WARNING!** This appliance must not be supplied through an external switching device, such as a timer, or connected to a circuit that is regularly switched ON and OFF by the utility.
25. For their safe use of the accessories, please see “HOW TO USE YOUR FOOD PROCERSSOR”.
26. Switch off the appliance and disconnect from supply before changing accessories or approaching parts that move in use.

### **IMPORTANT!**

**To prevent damage to the electric motor, the maximum operating time is 40 seconds. Allow it to rest for at least 3 minutes before using it again. After 5 cycles of operation, allow it to cool down for approx. 30 minutes before using it again.**

**Note: The appliance is incorporated with a non-self resetting thermal motor protection circuit to protect the motor from overheating. If the motor shuts OFF while in use, unplug the unit from main power outlet. Remove the blending jug from motor unit and free the blade of any obstructions. Allow the unit to cool down for 10 minutes. After then, plug the unit back into mains power for normal operation.**

**SAVE THESE INSTRUCTIONS  
FOR HOUSEHOLD USE ONLY**

# KNOW YOUR FOOD PROCESSOR

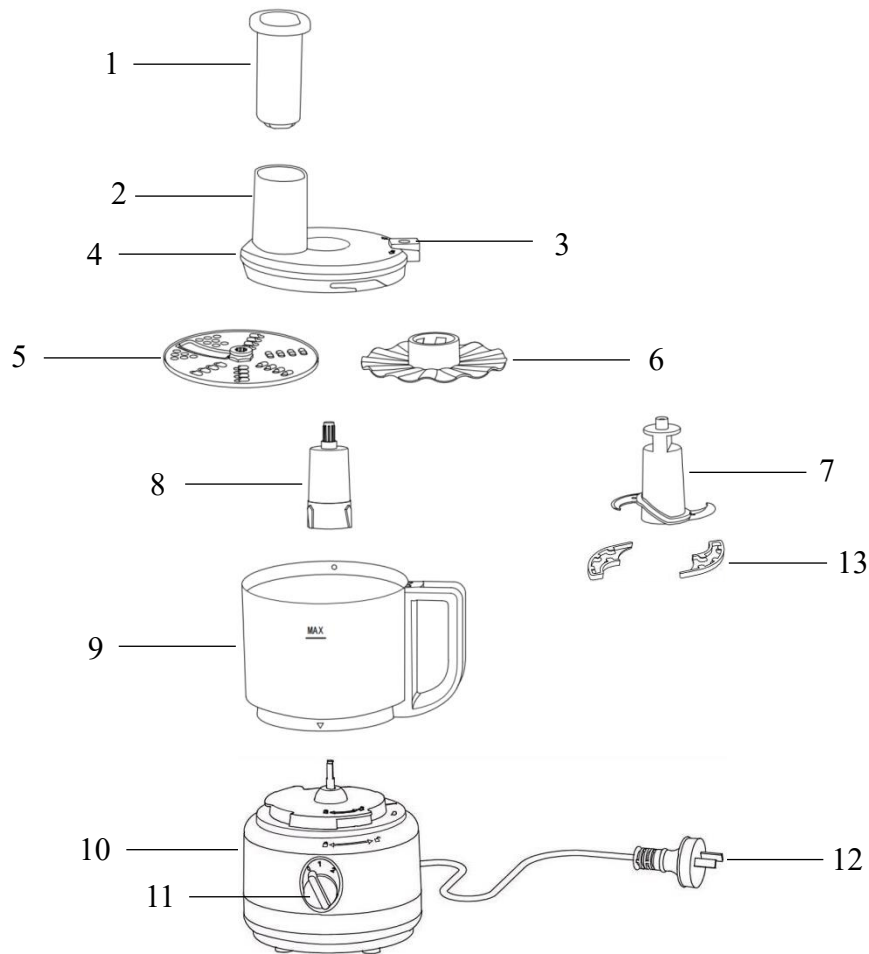

- |                           |                                     |
|---------------------------|-------------------------------------|
| 1. Pusher                 | 7. Chopping blade assembly          |
| 2. Feed tube              | 8. Drive shaft (for use with discs) |
| 3. Operation button       | 9. Bowl                             |
| 4. Lid                    | 10. Main unit                       |
| 5. Shredding/Slicing disc | 11. On/Off/Speed switch             |
| 6. Emulsifying disc       | 12. Power plug & cord               |
|                           | 13. Blade cap                       |

## IMPORTANT!



Please make sure that your appliance is received with the right components shown above. Check everything carefully before using. If any parts are missing or damaged, return the product back to place of purchase for replacement.

## BEFORE FIRST USE

- Carefully remove all packaging.
- Clean the appliance according to the instructions in CLEANING AND STORAGE section. Dry thoroughly.

# HOW TO USE YOUR FOOD PROCESSOR

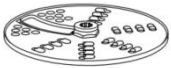
- Place the main unit and the accessories on a flat, stable surface.
- Point the triangle on the bowl to the unlock symbol on the main unit, rotate the bowl clockwise until the triangle points to the lock symbol, the bowl is assembled in place.
- Choose the right accessories to process your food.

Shred/Slice	Emulsify	Chop
		
Potato, onion, cucumber, beetroot, apple, carrot (shred: 280g/batch, slice: 400g/batch) etc.	mayonnaise, sauces, egg Whites (Max.5pcs), whip cream (Max.300mL).	Cheese, fruit, vegetables, meat (250g/batch).

## IMPORTANT!

- DO NOT process boiling liquids or hot ingredients. Allow hot ingredients to cool before placing them in the bowl.
- DO NOT fill the bowl above the MAX mark (600mL). Some mixtures increase in volume during processing and create pressure in the bowl.
- Do not use the product to stir thick mixtures such as dough. Use soft ingredients only.
- Do not operate the product empty.
- Do not operate the product until it is properly assembled.
- **To prevent damage to the electric motor, the maximum operating time is 40 seconds. Allow it to rest for at least 3 minutes before using it again. After 5 cycles of operation, allow it to cool down for approx. 30 minutes before using it again.**

## CAUTION! Blades are extremely sharp, handle with care.

### Using the Shredding/Slicing disc

- Place the drive shaft inside the bowl, seat the shred/slice disc on the drive shaft. Place the lid onto the bowl, turn it clockwise until the operation button aligns with the handle, the lid is assembled in place.
- Connect the appliance to the mains power supply, turn the On/Off/Speed switch to position "1" or "2" to choose the speed. The appliance is now in standby mode.
- Use the pusher to feed fruit/vegetable (cut into the right size to fit the feed tube) into the feed tube, press and hold the operation button to process the food. Release the operation button to stop operation.

### Using the Emulsifying disc/chopper

- Place the drive shaft inside the bowl, put on the emulsifying disc to use the emulsify function. For chop function, simply place the chopping blade assembly in the bowl.
- Place the ingredients into the bowl evenly. Place the lid with pusher onto the bowl, turn it clockwise until the operation button aligns with the handle, the lid is assembled in place.

- Connect the appliance to the mains power supply, turn the On/Off/Speed switch to position "1" or "2" to choose the speed. The appliance is now in standby mode.
- Press and hold the operation button to process the food. Release the operation button to stop operation. Press the operation button rhythmically to use pulse function.
- Turn off the appliance by turning On/Off/Speed switch to "0" position, unplug the appliance from the mains power outlet after processing.
- When the blades/discs have come to a complete stop, disassemble the lid and blades/disc to get the food.

**WARNING! Always unplug the appliance when it is not in use or when left unattended.**

## CLEANING AND STORAGE

Clean the appliance after every use.

1. Remove the power plug and cord from the mains power outlet socket and allow the appliance to come to a complete stop before detaching parts and cleaning.
2. Cleaning:

**WARNING! Do not use harsh abrasives, sharp objects, caustic cleaners or oven cleaners when cleaning this appliance.**

**Do not wash in a dishwasher.**

parts	Cleaning method	Dishwasher safe
<ul style="list-style-type: none"> <li>• Main unit</li> <li>• Power Plug &amp; cord</li> </ul>	<ul style="list-style-type: none"> <li>• Wipe with damp cloth.</li> </ul> <p><b>WARNING! Do not immerse the main unit, the power plug and cord in water or any other liquids to clean.</b></p>	Yes
<ul style="list-style-type: none"> <li>• Bowl</li> <li>• Lid</li> <li>• Discs</li> <li>• Pusher</li> <li>• Blade assembly</li> <li>• Drive shaft</li> </ul>	<ul style="list-style-type: none"> <li>• Use a small brush (not included) to remove particles of food lodged on the parts.</li> <li>• Wash in warm, soapy water, rinse.</li> </ul>	Yes

3. Make sure all parts are clean and dry thoroughly before storing or using it again.
4. Store the appliance in a safe, cool, dry place.

## TECHNICAL SPECIFICATION

Voltage: 220-240V~ 50-60Hz

Power: 250W

Max Capacity: 600mL

## **12 Month Warranty**

Thank you for your purchase.

Your new product is warranted to be free from defects in materials and workmanship for the period stated above, from the date of purchase, provided that the product is used in accordance with accompanying recommendations or instructions where provided. This warranty is in addition to your rights under the Australian Consumer Law.

For New Zealand customers, this warranty is in addition to statutory rights observed under New Zealand legislation.

We will provide you with your choice of a refund, repair (where possible) or exchange (availability dependent) for this product if it becomes defective within the warranty period. The business will bear the reasonable expense of claiming the warranty.

This warranty will no longer apply where the defect is a result of alteration, accident, misuse, abuse or neglect.

Please retain your receipt as proof of purchase and contact our Customer Service Centre as listed below, for the entity you purchased this product from, for any difficulties with your product. Warranty claims and claims for expense incurred in returning this product can be addressed to the respective Customer Service Centre.

Our goods come with guarantees that cannot be excluded under the Australian Consumer Law. You are entitled to a replacement or refund for a major failure and compensation for any other reasonably foreseeable loss or damage. You are also entitled to have the goods repaired or replaced if the goods fail to be of acceptable quality and the failure does not amount to a major failure.

<b>Contact for Kmart purchases</b>	<b>Contact for Target purchases</b>
Kmart Australia Ltd. C/- Customer Service Centre L2/ 1 Middle Road, Chadstone Vic 3148 Australia Customer Service: 1800 124 125 (Australia) or 0800 945 995 (New Zealand) or via Customer Help at <a href="http://kmart.com.au">kmart.com.au</a>	Target Australia Pty Ltd C/- Customer Service Centre L2/ 1 Middle Road, Chadstone Vic 3148 Australia Customer Service: 1300 753 567 or via Customer Help at <a href="http://target.com.au/help/contact-us">target.com.au/help/contact-us</a>