

# anko

## Multipurpose Scrubber DB-5001 User Manual



PLEASE READ AND SAVE THESE  
INSTRUCTIONS FOR FUTURE REFERENCE

### IMPORTANT SAFEGUARDS

When using any electrical product, always follow these basic safety precautions:



#### **READ ALL INSTRUCTIONS BEFORE USE.**

1. This appliance must only be supplied by AS/NZS 61558.1 & AS/NZS 61558.2.16 certified power supply unit with SELV output voltage corresponding to the marking on the appliance.
2. After charging, when unplugging the plug, please grab by the plug when pulling it out. Do not pull from the wire.
3. This appliance is not intended for use by persons (including children) with reduced physical,

sensory or mental capabilities, or lack of experience and knowledge, unless they have been given supervision or instructions concerning use of the appliance by a person responsible for their safety.

4. Children should be supervised to ensure that they do not play with the appliance.
5. Cleaning and user maintenance shall not be done by children without supervision.
6. Stay away from flammable and explosive substances at any time.
7. Keep hair, loose clothing, and all parts of the body away from moving parts.
8. To protect against a fire, electric shock or personal injury, do not immerse the main unit or the USB cable in water or other liquids.
9. Do not touch the USB cable or the appliance with wet hands.
10. Use of accessories not supplied with the product may cause fire, electric shock or personal injury.
11. Do not leave the appliance unattended when powered on.
12. For electrical safety, any repairs to the product should be carried out by a qualified electrical person only or the product must be disposed of.
13. This appliance must always be used in accordance with the user instructions supplied with the product and must not be used for other purposes.
14. Misuse may cause serious injury.
15. Switch OFF the appliance before changing accessories.
16. Before using the product, please check if the brush is fixed in place.
17. Do not operate without charging port cover in place.
18. Do not use it in front of people to avoid the brush hitting others if it is dropped.
19. This appliance contains batteries that are non-replaceable.
20. Always wear eye protection when using the scrubber with irritating substances. Rubber gloves are also recommended.
21. For cleaning, please refer to CLEANING AND STORAGE section.

## **CAUTION!**

22. The product has built-in lithium-ion batteries. Pay attention to the following:
  - a) Only use and store the product in an environment where the temperature is between  $-5^{\circ}\text{C}$  and  $+35^{\circ}\text{C}$ .
  - b) If not used for a long time, recharge every three months to prevent battery damage.
  - c) Charging time may be longer when the room temperature is below  $10^{\circ}\text{C}$ .
  - d) Charge the battery when the battery power goes low, avoid allowing the battery to go flat.
23. DO NOT squeeze, puncture, or short circuit the product or put it into water, fire or use in an environment where the temperature is higher than  $60^{\circ}\text{C}$ .
24. This product is for household use only and not designed for commercial use.
25. Do not expose the product to high temperatures (above  $+35^{\circ}\text{C}$ ), strong magnetic fields, near flammable and explosive gases (such as natural gas, methane, etc.) to avoid accidents such as abnormal operation or fire.

# SAVE THESE INSTRUCTIONS FOR FUTURE REFERENCE

## KNOW YOUR MULTIPURPOSE SCRUBBER

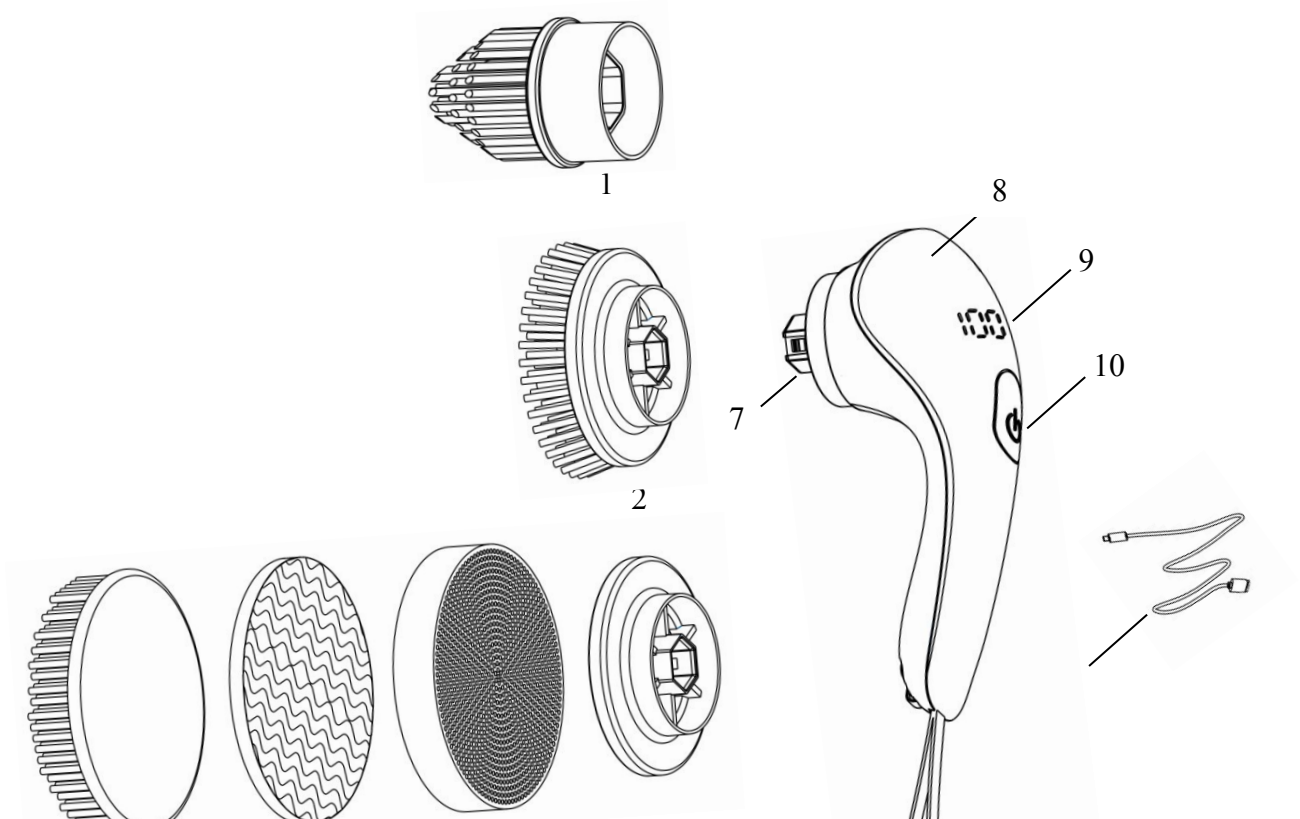

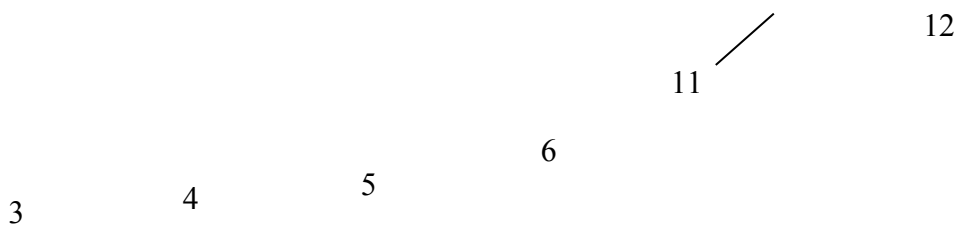

- |                  |                               |
|------------------|-------------------------------|
| 1. Pointed brush | 7. Drive shaft                |
| 2. Flat brush    | 8. Main unit                  |
| 3. Chenille pad  | 9. Battery percentage display |
| 4. Scouring pad  | 10. On/Off button             |
| 5. Foam pad      | 11. Charging port with cover  |
| 6. Pad holder    | 12. USB cable                 |

## IMPORTANT!

Please make sure that your appliance is received with the right components shown above. Check everything carefully before use. If any parts are missing or damaged, return the product to the respective customer service centre.

When using the appliance for the first time, carefully remove all internal and external packaging and dispose of them responsibly.

### BEFORE FIRST USE

- Fully charge the appliance before first use.
- The supplied USB charging cable should be inserted into a standard USB power source rated at 5Vd.c. 2A specification.

**WARNING! Use only the supplied USB charging cable to charge the appliance.**

- The battery percentage displays when charging and shows "100" when fully charged.
- The charging time is approx. 2 hours.
- After being fully charged, the product can work up to approx. 1 hour.

### USING YOUR MULTIPURPOSE SCRUBBER

1. Choose the appropriate brush or pad according to the cleaning requirements.

Attachment	Application
Pointed brush	Cleaning wash basins, bathtubs
Flat brush	Cleaning large, flat surfaces such as tiles, cleaning grills
Chenille pad	Polish smooth surfaces, e.g. windows, mirrors
Scouring pad	Cleaning stubborn dirt from pots, hobs
Foam pad	Cleaning smooth surfaces, e.g. vehicle cleaning

Pad holder	Attach the cleaning pads
------------	--------------------------

2. Align the hexagonal slot of the brush or pad holder to the drive shaft of the main unit, and push into place.
3. Make sure the charging port is properly sealed by the cover. Now the appliance is ready for use.
4. Press the On/Off button, the remaining battery percentage displays, and the appliance starts working at high speed. Press the On/Off button a second time to get low speed. Press the On/Off button a third time to turn off the appliance, the battery percentage indicator will go off.

#### **Tips for better performance:**

- Make sure the appliance is fully charged before each cleaning.
- This appliance can work with different kinds of cleaners, such as spray, foam, gel, liquid, as well as bleach. Frictional cleansers should not be used.
-  **WARNING! Please wear safety gloves and glasses for safety.**
- If you are not sure the surface can be used with the brush, test it on inconspicuous places first.
- Power off the appliance before removing it from the cleaning surface to avoid spraying from the rotating brush.
- The cleaner is powerful, so excessive force is not required. It is better to brush in a circular motion for big areas. Do not keep brushing in a small area for a long time.

## **CLEANING AND STORAGE**

- Clean the product and its accessories after use to maintain and prolong the life of the product.
- Keep the surface of the pad holder clean to guarantee attach ability.

1. Turn off the appliance and make sure the USB cable is disconnected before cleaning.

**WARNING! Do not immerse the main unit or USB cable in water or any other liquid to clean.**

Do not use abrasive material to clean the appliance.

Do not place any parts into extremely hot water.

2. The main unit can be wiped with mild detergent and a soft sponge. Dry thoroughly.

3. Soak the brushes, pads and holder in soapy water, then rinse, and dry thoroughly.

4. Ensure the product is clean and dry before storage.

5. Store the appliance in a clean and dry location.

- This product contains a Li-ion battery. It should be stored in a clean, dry, ventilated room with an ambient temperature range of -5°C to + 35°C and a relative humidity of 25% to 75%.

## **TECHNICAL SPECIFICATION**

Input: 5Vd.c. 2A

Battery: Li-ion 3.65V 2600mAh

Ingress Protection: IP67

## 12 Month Warranty

Thank you for your purchase.

Your new product is warranted to be free from defects in materials and workmanship for the period stated above, from the date of purchase, provided that the product is used in accordance with accompanying recommendations or instructions where provided. This warranty is in addition to your rights under the Australian Consumer Law.

For New Zealand customers, this warranty is in addition to statutory rights observed under New Zealand legislation.

We will provide you with your choice of a refund, repair (where possible) or exchange (availability dependent) for this product if it becomes defective within the warranty period. The business will bear the reasonable expense of claiming the warranty.

This warranty will no longer apply where the defect is a result of alteration, accident, misuse, abuse or neglect.

Please retain your receipt as proof of purchase and contact our Customer Service Centre as listed below, for the entity you purchased this product from, for any difficulties with your product.

Warranty claims and claims for expense incurred in returning this product can be addressed to the respective Customer Service Centre.

Our goods come with guarantees that cannot be excluded under the Australian Consumer Law. You are entitled to a replacement or refund for a major failure and compensation for any other reasonably foreseeable loss or damage. You are also entitled to have the goods repaired or replaced if the goods fail to be of acceptable quality and the failure does not amount to a major failure.

**Contact for Kmart purchases**

**Contact for Target purchases**

Kmart Australia Ltd.  
C/- Customer Service Centre  
L2/ 1 Middle Road, Chadstone Vic 3148  
Australia  
Customer Service: 1800 124 125 (Australia)  
or 0800 945 995 (New Zealand)  
or via Customer Help at [kmart.com.au](http://kmart.com.au)

Target Australia Pty Ltd  
C/- Customer Service Centre  
L2/ 1 Middle Road, Chadstone Vic 3148  
Australia  
Customer Service: 1300 753 567  
or via Customer Help at  
[target.com.au/help/contact-us](http://target.com.au/help/contact-us)