



Portable USB Rechargeable Washing Machine

GZ-XYJ02

User Manual



**PLEASE READ AND SAVE THESE
INSTRUCTIONS FOR FUTURE REFERENCE**

IMPORTANT SAFEGUARDS

When using any electrical product, always follow these basic safety precautions:



READ ALL INSTRUCTIONS BEFORE USE.

1. Read all instructions before using this appliance.
2. This appliance is not intended for use by persons (including children) with reduced physical, sensory or mental capabilities, or lack of experience and knowledge, unless they have been given supervision or instruction concerning use of the appliance by a person responsible for their safety.
3. Children should be supervised to ensure that they do not play with the appliance.
4. Cleaning shall not be made by children without supervision.
5. Always turn the appliance OFF and disconnect the USB cable when not in use, before cleaning or storing.
6. Never use the appliance if the cable, main unit or any parts are damaged.
7. Do not store this appliance outdoors. Do not charge the battery outdoors.
8. Do not add water above 40°C to the washing machine.
9. Do not immerse the appliance in water or any other liquids.
10. Do not tilt or move the appliance when it is in use.
11. Do not reach into the washing machine during operation. Turn off the appliance before loading or removing clothing.
12. Use of accessories not supplied with the product may cause fire, electric shock or personal injury.
13. Do not touch the USB cable or the appliance with wet hands.
14. For electrical safety, any repairs to the product should be carried out by a qualified electrical person only or the product must be disposed of.
15. This appliance must be always used in accordance with the user instructions supplied with the product and must not be used for other purposes.
16. Misuse may cause serious injury.
17. Ensure that the USB charging cable is not stretched tightly or kinked.
18. The appliance may heat up while it is charging. Place the appliance in a well-ventilated location during the charging process and do not cover it.
19. Do not use solvents, abrasive or aggressive cleaning agents to clean the appliance.
20. Do not store gasoline or other combustible gases and liquids in the vicinity of the washing machine.
21. The product is equipped with a non-replaceable lithium-ion battery. When the battery is at end of life, the appliance shall be properly disposed of. Do not throw the rechargeable battery into fire and do not subject it to high temperatures. There is a risk of an explosion and or fire!
22. Use only USB power supply with the following specifications: 5Vdc, 2A or less than 3A.
23. For cleaning, please refer to CLEANING AND STORAGE section.

CAUTION!

24. The product has built-in lithium-ion batteries. Pay attention to the following:
 - a) Only use and store the product in an environment where the temperature is between 0°C and +35°C.
 - b) If not used for a long time, re-charge every three months to prevent battery damage.
 - c) Charging time may be longer when the room temperature is below 10°C.
 - d) Charge the battery when the battery power goes low, avoid allowing the battery to go flat.
25. DO NOT squeeze, puncture, or short circuit the product or put it into water, fire or use in an environment where the temperature is higher than 60°C.
26. Do not expose the product to high temperatures (above +35°C), strong magnetic fields, near flammable and explosive gases (such as natural gas, methane, etc.) to avoid accidents such as abnormal operation or fire.
27. The maximum weight of dry clothes used in the washing machine should not exceed 160g.
28. This product is for household and indoor use only.
29. This product contains a Li-ion battery. If the battery leaks, please avoid direct contact with the skin or eyes. If accidentally touched, please clean with plenty of water. If discomfort occurs, please seek medical attention immediately.
30. Electrical and electronic goods and batteries should not be disposed of as part of regular household waste but should be separately collected for recovery and recycling.

**SAVE THESE INSTRUCTIONS
FOR FUTURE REFERENCE**

KNOW YOUR PORTABLE USB RECHARGEABLE WASHING MACHINE

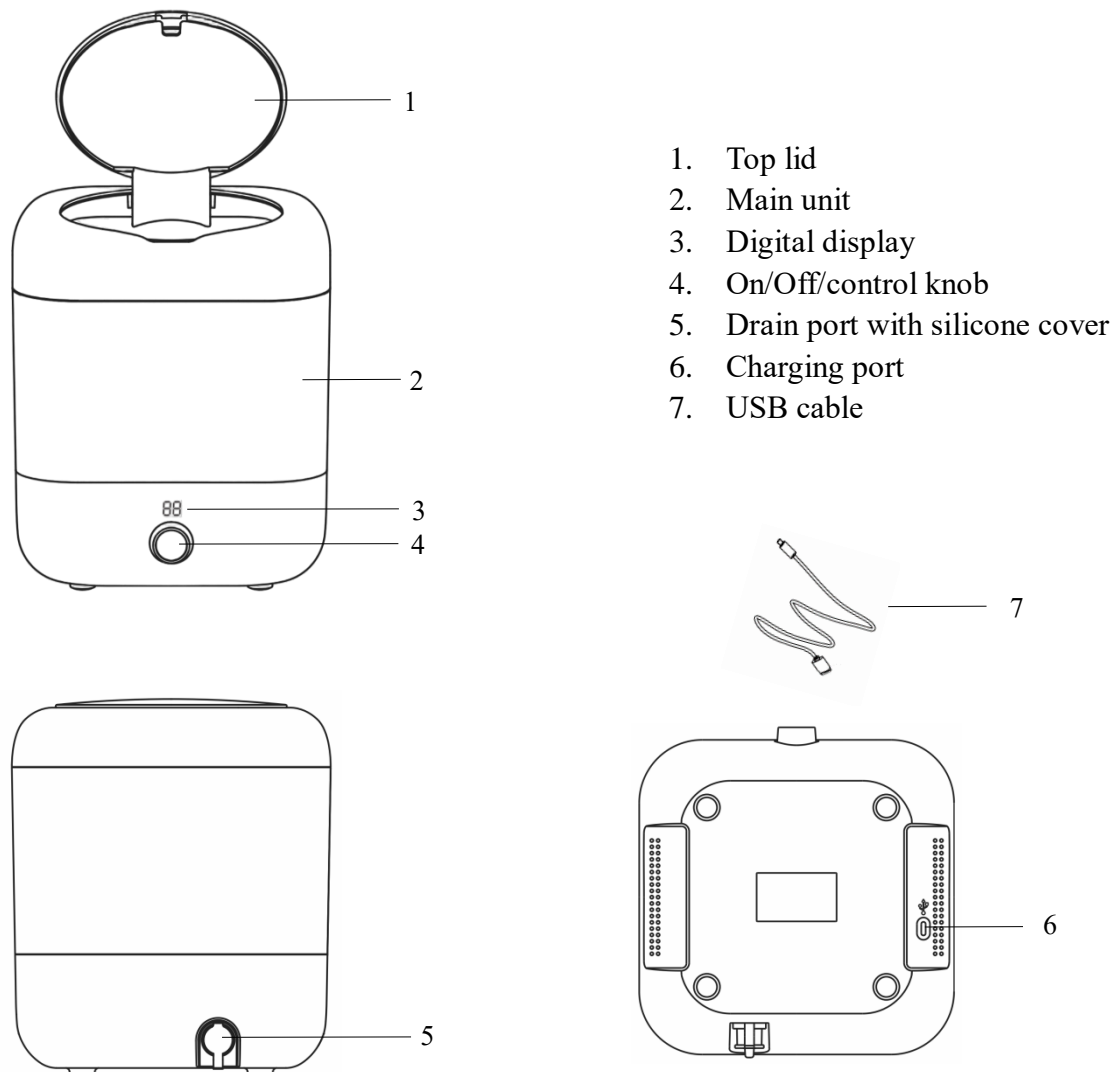

IMPORTANT!

Please make sure that your appliance is received with the right components shown above. Check everything carefully before use. If any parts are missing or damaged, return the product to place of purchase for replacement.

When using the appliance for the first time, carefully remove all internal and external packaging and dispose them responsibly.

BEFORE FIRST USE

Charge the battery

- Fully charge the appliance before first use.
- **The supplied USB charging cable should be inserted into a standard USB power source rated at 5Vd.c. 2A specification.**

WARNING: Use only the supplied USB charging cable to charge the appliance.

- The battery level is displayed when charging. When fully charged, “99” is displayed for 30 seconds, then goes out.
- The charging time is around 2 hours 30 minutes.
- After being fully charged, the product can work up to approximately 1 hour of continuous use.

Tips: The product can be used while charging.







Clean the product

- Clean the appliance with a moist cloth, wipe dry with a soft dry cloth.

WARNING! Do not immerse the appliance in water or any other liquid to clean.

USE YOUR PORTABLE USB RECHARGEABLE WASHING MACHINE

Laundry load

					
underpants	underwear	socks	Sports underwear	Small towels	Baby clothes
2pcs	1pc	4pairs	1pc	2pcs	2pcs

Operation

1. Flip up the top lid and add an appropriate amount of water into the washing tub.

WARNING! Do not add water beyond MAX water level. Do not add water above 40°C.

2. Add approx. 5mL laundry detergent to the water. Apply detergent directly to heavily soiled areas if necessary.

Notes:

Detergents can effectively reduce the adhesion of stains and enhance the washing effect.

It is recommended to use low-foam or non-foam soap powder.

3. Completely submerge the clothes (maximum recommended weight 160g) in the water to ensure the clothes can move freely with the agitator for effective cleaning.
4. Close the lid.
5. Click the On/Off/Control knob to turn ON the appliance, the battery level is displayed for 2 seconds and goes out. “--” will be displayed, and the appliance is now in standby mode. The appliance will turn off automatically with a “beep” if no operation is performed within 1 minute.

WARNING! Do not touch the appliance or cable with wet hands.

6. Turn the On/Off/Control knob clockwise or anticlockwise to start washing immediately and to set the desired washing time. Washing time is displayed. There are 3 settings available: 5min, 10min, 20min.

7. The 2 blue lights in the tub will illuminate, and the remaining washing time will be displayed.

During washing, you can set the washing time. Click the knob to pause washing. Press and hold the knob to turn off the appliance.

“Lo” is displayed when battery is low and not able to operate. Connect the appliance with power supply to continue washing.

8. When the set time run out, “00” is displayed with a “beep” and goes out after 1 minute with a “beep”.

9. Open the silicone cover (5) on the drain port and let the water drain away.

WARNING! Make sure to disconnect the USB cable from the appliance and power supply before draining the water.

10. IMPORTANT! You may have to repeat the above process one or more times to clean the clothes.

11. Take out the clothes after finish washing. Hand-wring and allow it to air dry.

Notes: The appliance has no spin-dry function.

CLEANING AND STORAGE

- Turn off the appliance and make sure the USB cable is disconnected from the appliance and power supply before cleaning.
- Drain the dirty water after cleaning. Ensure to place the drain cover back to avoid water from leaking when you use the appliance next time. Do not leave water in the washing machine for an extended period, as it may become stale.
- Clean the appliance with a moist cloth, wipe dry with a soft dry cloth.

WARNING! Do not immerse the appliance or USB cable in water or any other liquid to clean. Do not use abrasive material to clean the appliance.

- Ensure the product is clean and dry before storage.
- This product contains a Li-ion battery. It should be stored in a clean, dry, ventilated room with an ambient temperature range of 0°C to + 35°C and a relative humidity of 25% to 75%.

TECHNICAL SPECIFICATION

Input: 5Vd.c. 2A

Battery: Li-ion 3.7V 2000mAh

MAX water capacity: 2.8L

MAX laundry load: 160g

12 Month Warranty

Thank you for your purchase.

Your new product is warranted to be free from defects in materials and workmanship for the period stated above, from the date of purchase, provided that the product is used in accordance with accompanying recommendations or instructions where provided. This warranty is in addition to your rights under the Australian Consumer Law.

For New Zealand customers, this warranty is in addition to statutory rights observed under New Zealand legislation.

We will provide you with your choice of a refund, repair (where possible) or exchange (availability dependent) for this product if it becomes defective within the warranty period. The business will bear the reasonable expense of claiming the warranty.

This warranty will no longer apply where the defect is a result of alteration, accident, misuse, abuse or neglect.

Please retain your receipt as proof of purchase and contact our Customer Service Centre as listed below, for the entity you purchased this product from, for any difficulties with your product.

Warranty claims and claims for expense incurred in returning this product can be addressed to the respective Customer Service Centre.

Our goods come with guarantees that cannot be excluded under the Australian Consumer Law. You are entitled to a replacement or refund for a major failure and compensation for any other reasonably foreseeable loss or damage. You are also entitled to have the goods repaired or replaced if the goods fail to be of acceptable quality and the failure does not amount to a major failure.

Contact for Kmart purchases	Contact for Target purchases
Kmart Australia Ltd. C/- Customer Service Centre 690 Springvale Road, Mulgrave Vic 3170 Customer Service: 1800 124 125 (Australia) or 0800 945 995 (New Zealand) or via Customer Help at kmart.com.au	Target Australia Pty Ltd C/- Customer Service Centre 2 Kendall Street, Williams Landing, Vic, 3027 Customer Service: 1300 753 567 or via Customer Help at target.com.au/help/contact-us