

anko

Ultimate Slime Mix & Play kit

3+ years

Blue Slime

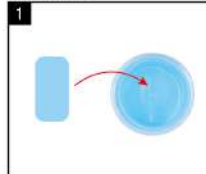

Take out the blue light clay and blue slime, then mix them together.



Choose your favorite small accessories (e.g., beads, hearts) and add them to the slime.



Put the mixed slime back into the plastic jar and shape it into your favorite design.

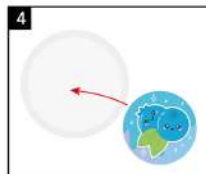

Stick a round fruit sticker on the lid of the plastic jar.



Attach a square sticker to the body of the plastic jar, then choose a resin decoration that you like and place it on top.



Pink Slime

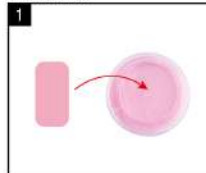

Take out the pink light clay and pink slime, then mix them together.



Choose your favorite small accessories (e.g., pom-poms, hearts) and add them to the slime.



Put the mixed slime back into the plastic jar and shape it into your favorite design.



Stick a round fruit sticker on the lid of the plastic jar.



Attach a square sticker to the body of the plastic jar, then choose a resin decoration that you like and place it on top.

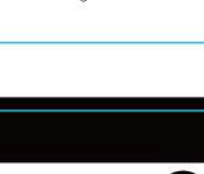

Ultimate Slime Mix & Play kit

3+ years

Light Purple Slime

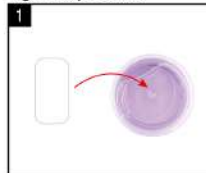

Take out the white light clay and purple slime, then mix them together.



Choose your favorite small accessories (e.g., barrel beads, holographic mix-ins) and add them to the slime.



Put the mixed slime back into the plastic jar and shape it into your favorite design.

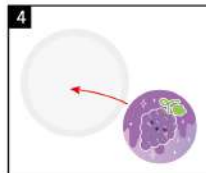

Stick a round fruit sticker on the lid of the plastic jar.



Attach a square sticker to the body of the plastic jar, then choose a resin decoration that you like and place it on top.



Orange Slime



Take out the orange slime.



Choose your favorite small accessories (e.g., beads, holographic mix-ins) and add them to the slime.



Put the mixed slime back into the plastic jar and shape it into your favorite design.



Stick a round fruit sticker on the lid of the plastic jar.

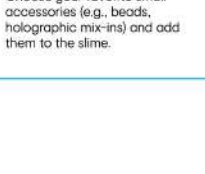

Attach a square sticker to the body of the plastic jar, then choose a resin decoration that you like and place it on top.

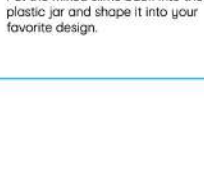

anko

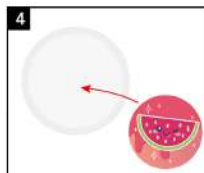

Stick a round fruit sticker on the lid of the plastic jar.



Attach a square sticker to the body of the plastic jar, then choose a resin decoration that you like and place it on top.



Purple Slime

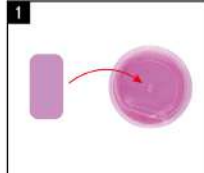

Take out the purple light clay and red slime, then mix them together.



Choose your favorite small accessories (e.g., holographic mix-ins, hearts) and add them to the slime.



Put the mixed slime back into the plastic jar and shape it into your favorite design.

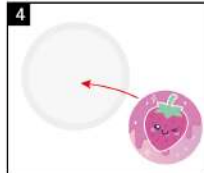

Stick a round fruit sticker on the lid of the plastic jar.



Attach a square sticker to the body of the plastic jar, then choose a resin decoration that you like and place it on top.



anko

Ultimate Slime Mix & Play kit

3+ years

Light Purple Slime

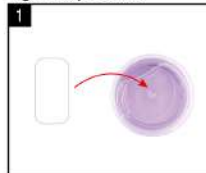

Take out the white light clay and purple slime, then mix them together.



Choose your favorite small accessories (e.g., barrel beads, holographic mix-ins) and add them to the slime.



Put the mixed slime back into the plastic jar and shape it into your favorite design.

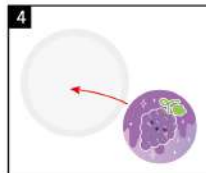

Stick a round fruit sticker on the lid of the plastic jar.



Attach a square sticker to the body of the plastic jar, then choose a resin decoration that you like and place it on top.



Orange Slime



Take out the orange slime.



Choose your favorite small accessories (e.g., beads, holographic mix-ins) and add them to the slime.



Put the mixed slime back into the plastic jar and shape it into your favorite design.



Stick a round fruit sticker on the lid of the plastic jar.

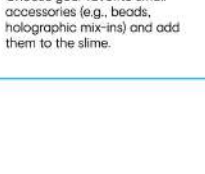

Attach a square sticker to the body of the plastic jar, then choose a resin decoration that you like and place it on top.

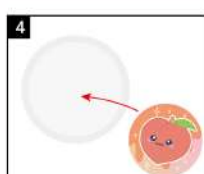
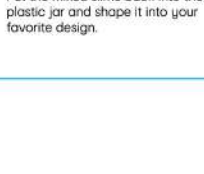

Stick a round fruit sticker on the lid of the plastic jar.



Attach a square sticker to the body of the plastic jar, then choose a resin decoration that you like and place it on top.



Green Slime



Take out the green slime.



Choose your favorite small accessories (e.g., barrel beads, pom-poms) and add them to the slime.



Put the mixed slime back into the plastic jar and shape it into your favorite design.

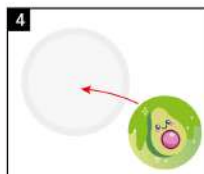

Stick a round fruit sticker on the lid of the plastic jar.



Attach a square sticker to the body of the plastic jar, then choose a resin decoration that you like and place it on top.



WARNING: IMITATION FOOD.
NOT FOR HUMAN CONSUMPTION.

ATTENTION: ALL ART MATERIALS LIKE CLAY AND SLIME, MAY CAUSE STAINS. ALWAYS PROTECT CLOTHES, CARPETS, WORK SURFACES, FURNITURE AND OTHER OBJECTS. ALWAYS USE A PROTECTIVE COVER TO PREVENT STAINS. AVOID INGESTION AND EYE CONTACT. WASH HANDS AFTER USE.

WARNING:
CHOKING HAZARD - SMALL PARTS.
NOT FOR CHILDREN UNDER 3 YEARS.