

148 mm

210 mm

**anko**

**Shredder  
Instruction Manual**

K: 43-646-135 | T: 72-137-611  
Model No. ZB277-B

**Accessories:**

- > 1 x Shredder
- > 1 x Instruction manual



**IMPORTANT SAFETY INTRODUCTIONS  
BEFORE FIRST USE**

**WARNING**

1. User information / safety instructions.

2. Please do not allow children to use the machine.

\* There are sharp blades inside the machine, so please exercise caution to avoid injury when using it.

3. Please do not put your hand close to the shredder blades and the paper feed opening.

\* There are sharp blades inside the machine, so please exercise caution to avoid injury when using it.

4. Please do not let your hair get close to the shredder's feed opening.

\* If your hair is accidentally sucked in, please use the "reverse function" to avoid the danger.

5. Please keep your clothing or some small items away from the feed opening of the paper shredder, such as ties, necklaces, sleeves, jewelry, etc.

6. Please don't use flammable liquids, gases, water, or cleaners to clean the machine.

\* To avoid fire accidents.

7. Please don't touch the sharp edges to avoid any injury.

8. This equipment is not intended for use by children. Avoid touching the media feed opening with your hands, clothing, or hair. Unplug this equipment when not in use for an extended period of time. Hazardous moving parts are present in this equipment, so keep your body parts away from them.

9. The quantity of shredded paper cannot exceed 6 sheets at one time. **One folded sheet of paper equates to 2 sheets of paper. Using heavier or higher humidity paper, or using a power supply with voltage lower than the rated voltage, may reduce the shredding capacity. 85% Maximum sheets per pass to avoid jams.**

**KNOW YOUR SHREDDER**

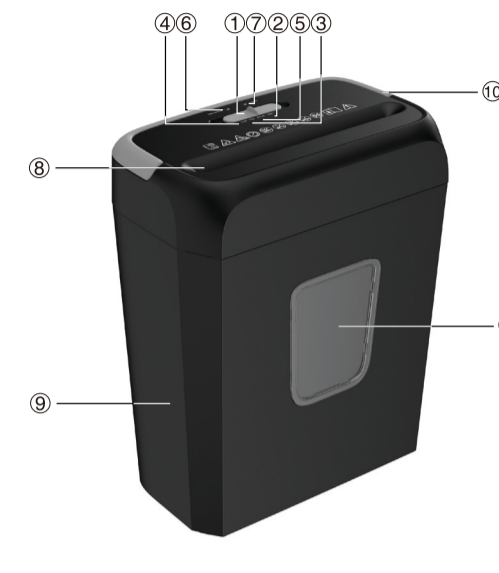

For safety reasons, shredder will operate only if the shredder head is in correct position and used with supplied basket.

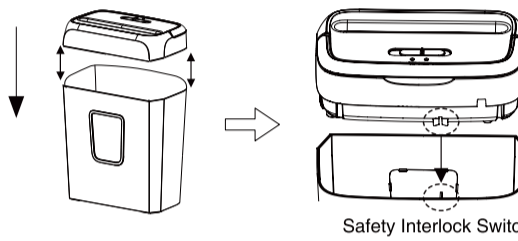

**TECHNICAL SPECIFICATIONS**

Voltage	220-240VAC, 50-60Hz	Shred Type	Particle cut
Shred Capacity	6 sheets/time(A4 75g/m <sup>2</sup> ) One sheet of credit card/time	Feed Opening (L*W)	220 x 4.0mm
Basket Capacity	13L	Shred Paper Size	5 x 14mm
Product Size (L*W*H)	300 x 180 x 362mm	Shreddable Medium	Paper, credit card, staple, clips

**WARNING!**

**1. Waste bin full:**

If you can see the shredded material is filling up the window, please empty it to prevent a jam.

**Do not let the waste bin become full. Otherwise, the shredded material may be pulled back into the shredder and cause a jam.**

- If the shredder is jammed, please unplug it, empty the bin, and clean the paper scraps in the cutter.
- Place the shredder head on the bin properly, plug in the machine, and slide the Control Switch to the REV position for 5 seconds, then slide it to the FWD position for 5 seconds again, repeat 2-3 times.

**2. No Trash bag:**

If you use a plastic bag to line the wastebasket, please remove it, as this may cause the shredder to not operate properly.



Empty the wastebasket when you can see through the window that it is full.



If the wastebasket becomes full and is not emptied, it will cause the paper to clog the machine's output.



No Trash bag

**Do not shred:**

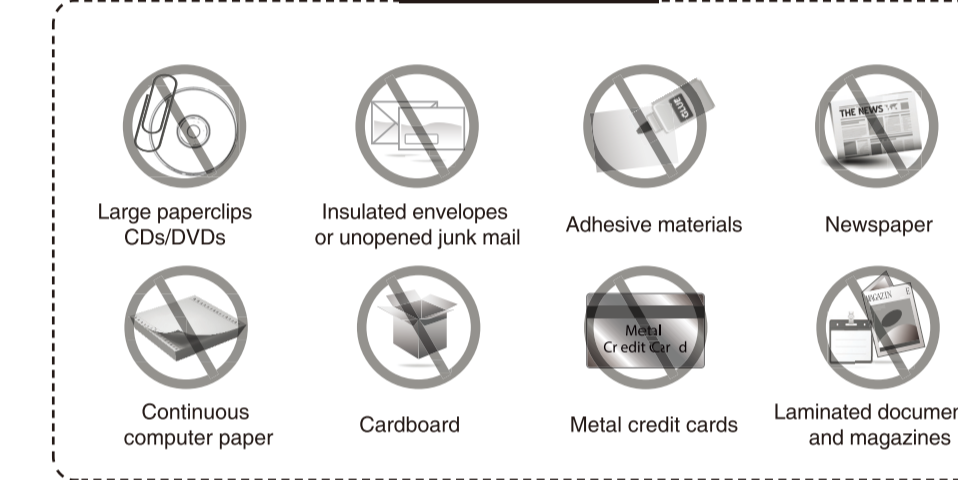

**OPERATING INSTRUCTIONS**

**Control Switch**

Using the switch located on the device, select one of the following settings by sliding the switch either left or right.



**AUTO**

This setting allows the shredder to be automatically started by inserting paper into the paper entry. Always feed the paper as vertically as possible. When the paper has completely passed through the paper entry, the shredder will automatically stop.



**Continuous operation for approximately 3 minutes.**

**OFF**

This setting can turn off all functions of the shredder. For safety reasons, we recommend leaving the shredder in the OFF position when it is unattended or not in use.



**REV(REVERSE)**

In the rare event of a paper jam, you can use the reverse function to help remove the paper that did not pass through. But never attempt to use the reverse function to clear a paper jam before emptying the waste bin.

**FWD(forward normal rotation)**

Please slide the switch to this position and use hard paper like folded paper, postcards or cardboard to push out the jammed paper. This allows you to manually activate the shredder into cutting mode. The machine will not stop automatically after the paper passes through. You should slide the Control Switch to the AUTO or OFF position(to stop it).

**LED Status Indicators**

**Ready(Power On)**

The LED light turns green, indicating that the shredder is on and ready to operate when paper is inserted.

**Overheat**

Red light - The shredder operates continuously beyond the maximum shredding time and will need to cool down for a period of time before it can be restarted. If this happens, turn off the shredder and wait 40 minutes or longer before resuming normal operation.

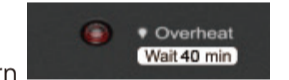

**Jam**

Please move Control Switch from the AUTO position to the REV position and pull out the jammed paper.



Move the Control Switch from the REV position to the FWD position and keep it there for 3-5 seconds (Repeat the operation 2-3 times if there is a very serious paper jam).

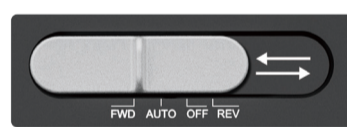

**PRODUCT MAINTENANCE**

**Warning: Failure to properly maintain your shredder will void the warranty.**

Oil the shredder blades every month with household vegetable cooking oil or shredder-specific oil.

Follow the oiling procedure below (FIGURE 1). It helps to keep the shredder blades operating well over many years of use.



FIGURE 1

**Oiling procedure:**

- Turn off the shredder.
- Apply shredder oil at the manual feed opening.
- Press the REV button and run continuously for 3-5 seconds.

**Note: Lubricant oil not included.**



**WARNING: Risk of explosion!**

- Do not spray or keep any aerosol products in or around the product.
- Do not use compressed air cans to clean the shredder.

**TIPS**

Only use the professional shredder lubricant pack to maintain the shredder.

**IMPORTANT!**

- Please read and keep the manual for future reference.
- Carefully read each step and follow the correct sequence of operation.
- Please place the device on a flat and stable surface to prevent it from tipping over, as it may result in the machine cracking or becoming unusable.
- The device should be placed as close as possible to an accessible wall outlet.
- Do not disassemble, modify or repair the device on your own to avoid electric shock, injury or damage to the machine.
- When you empty the basket, move the device, or do not need to use the device for a period of time, make sure the device is tured off and unplug the power plug to prevent fire or electric shock.
- Do not use flammable liquids, gases, water or cleaners to clean the device to avoid fire or electric shock.
- Do not use the device in a high temperature, high humidity, or heavily dusty environment to prevent fire, electric shock, or machine malfunction.
- Do not put tape, carbon copy paper, fabric, plastic film, etc. into the device for shredding to avoid damage to the machine.
- Do not damage or process the power cord, and do not place heavy objects on the cable to avoid fire, injury or electric shock.
- If smoke or odor occurs during use, immediately turn off the power and stop using it to prevent fire or electric shock.
- Do not use the shredder or power cord if it is damaged or defective to avoid fire or electric shock.
- Do not shred greeting cards with sound chips or batteries to avoid fire or electric shock.

**TROUBLESHOOTING**

Malfunction	Reason	Solution
The power plug doesn't connect to the power supply.		Please check if you are using the correct power voltage, or reinsert it properly.
The shredder "Control Panel" is not moved to the AUTO position.		Make sure the plug is inserted into the correct power outlet, and then move the "Control Panel" to the AUTO position, the power indicator light will turn on.
Prolonged use can cause overheating.		If the shredder operates continuously beyond the maximum running time and overheats, the device will automatically shut off. If this occurs, please turn off the shredder for about 40 minutes before resuming normal operation.
The shredder does not work.		Make sure that the shredder head is properly installed onto the accompanying wastebasket, with all the words and icons facing towards you. The head unit is specifically designed to work only with the integrated wastebasket. The shredder is equipped with a safety interlock mechanism that prevents the shredder from working when the head unit is lifted, removed, or accidentally overturned. The shredder will only function properly when the head unit is assembled correctly, as illustrated.
	A plastic bag was placed over the wastebasket.	Please remove it. This may cause the shredder not to operate properly.
	The basket is full.	Empty the basket.
	The activation sensor of the shredder is located near the center of the feed entry.	Be sure to feed directly into the center area to activate the machine (especially applies to smaller pieces of paper or credit cards).
	The power cable is damaged.	Please replace the power cable with the same parameters by a professional person or contact our customer service for help.
	The machine is defective.	Please contact our customer service for help.
The shredder is constantly running in Auto (On) mode.	Paper dust and other foreign objects cover the sensor. The location of the sensor is in the center of the shredder's feeding opening, and it looks like a small plastic divider.	It is possible that the activation sensor, which starts the shredder, is blocked with paper. Insert a discarded plastic credit card or any rigid sheet of cardboard (such as an old greeting card or a folded file folder) directly into the center of the feeding opening while applying force to help push the jammed paper through. This usually clears any paper blocking the sensor and feeding opening.
The shredder operates in REV (Reverse) mode, but not in AUTO mode.	The feeding opening may be blocked by paper.	Insert a discarded plastic credit card or any rigid sheet of cardboard (such as an old greeting card or a folded file folder) directly into the center of the feeding opening while applying force to help push the jammed paper through. This usually clears any paper blocking the feeding opening.

Malfunction	Reason	Solution
Won't shred MAX sheets.	The paper is jammed.	NEVER SHRED THE FOLLOWING ITEMS: Large paper clips (remove small clips whenever possible); Envelopes (especially windowed or glued flaps); Adhesive materials such as labels, stickers, or glued paper; Newspaper, tissue, or any similar thin paper stock; Transparencies, film, or laminated documents; Continuous forms or paper rolls; Cardboard / Corrugated board or fabric; Plastic or hard items (except Credit Cards & CDs if applicable).  1) Lift up the shredder head and check if the outlet is blocked by paper. If there is a lot of paper attached to the outlet, please disconnect the power supply, manually remove the paper from the outlet, and then place the shredder on the basket correctly. Move the "Control Panel" from the REV position to the FWD position for 3-5 seconds (repeat the operation around 2-3 times if there is a very serious jam). 2) Move the "Control Panel" to the REV position in reverse mode, the shredder will back up and release the jammed paper. You need to pull out and reduce the number of sheets to effectively clear the jam. Once the jam is loosened or removed, move the "Control Panel" back to the AUTO position and continue shredding. Repeat the process 2-3 times if necessary. 3) In stubborn situations where the Reverse function doesn't help, you need to soak the jammed paper with shredder oil (edible oil is acceptable, but avoid using aerosol sprays). First, drip the oil onto the feed entry where the paper is jammed. Allow it to soak for about 30 minutes to fully penetrate. Then, move the "Control Panel" to the AUTO (or FWD) position. If needed, you can insert a discarded credit card or a stiff piece of cardboard (such as an old greeting card or folded file folder) into the shredder to help push the jammed paper through. 4) With the shredder unplugged, you can use a set of needle-nose pliers or tweezers to remove the blockage.

**12 Month Warranty**

Thank you for your purchase.

Your new product is warranted to be free from defects in materials and workmanship for the period stated above, from the date of purchase, provided that the product is used in accordance with accompanying recommendations or instructions where provided. This warranty is in addition to your rights under the Australian Consumer Law. For New Zealand customers, this warranty is in addition to statutory rights observed under New Zealand legislation.

We will provide you with your choice of a refund, repair (where possible) or exchange (availability dependent) for this product if it becomes defective within the warranty period. The business will bear the reasonable expense of claiming the warranty. This warranty will no longer apply where the defect is a result of alteration, accident, misuse, abuse or neglect.

Please retain your receipt as proof of purchase and contact our Customer Service Centre as listed below, for the entity you purchased this product from, for any difficulties with your product.

Warranty claims and claims for expense incurred in returning this product can be addressed to the respective Customer Service Centre.

Our goods come with guarantees that cannot be excluded under the Australian Consumer Law. You are entitled to a replacement or refund for a major failure and compensation for any other reasonably foreseeable loss or damage. You are also entitled to have the goods repaired or replaced if the goods fail to be of acceptable quality and the failure does not amount to a major failure.

MADE IN VIETNAM  
CUSTOMER SERVICE:  
SMART AU: 1800 124 125  
SMART NZ: 0800 945 995  
TARGET AU: 1300 753 567