

3+ YEARS

DINO BOT

MANUAL



PACKAGE CONTENTS

•Dinosaur •Remote Control •User Manual

IMPORTANT SAFETY PRECAUTIONS

READ ALL INSTRUCTIONS BEFORE USING YOUR DINOSAUR

1. Do not use your dinosaur near water. Clean using a soft cloth or paper towel.
2. Do not place your dinosaur on any wet surfaces.
3. Do not allow children under the age of three to play with the dinosaur.
4. Do not expose your dinosaur to excessive heat, flames or fire.
5. Always press all buttons or switches carefully.
6. Do not use in extremely dry environments, as this can lead to static discharge during usage
7. Do not expose your dinosaur to temperatures above 40°C. Keep out of direct sunlight.
8. Do not drop, puncture or expose your dinosaur to excessive trauma.
9. Your dinosaur is not intended for commercial use.

DINOSAUR



REMOTE CONTROL

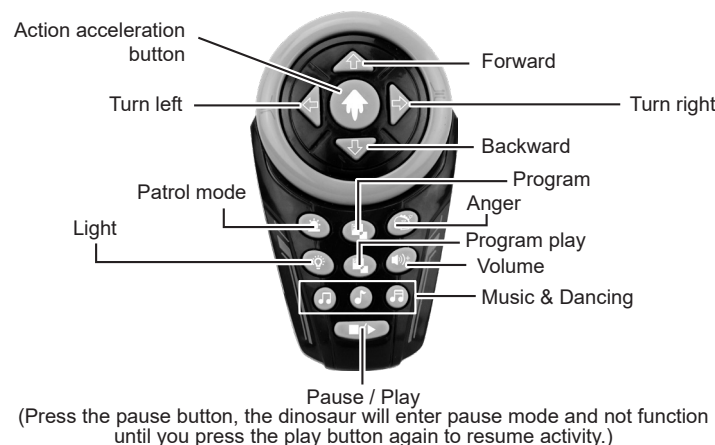

INSERTING BATTERIES

Dinosaur

1. Unscrew to open battery cover, insert 4 X 1.5V AA batteries.
2. Replace battery cover.
Attention: remove batteries after you have finished using your product.

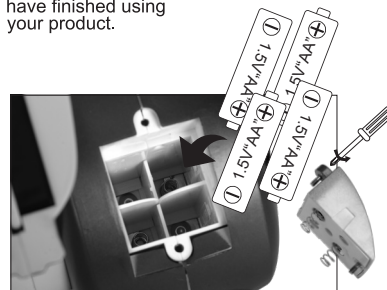

Remote Control

1. Unscrew to open battery cover, insert 2 X 1.5V AA batteries.
2. Replace battery cover.
Attention: remove batteries after you have finished using your product.

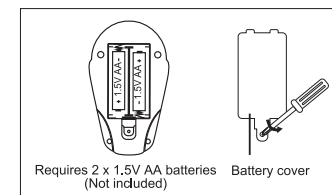

POWERING ON YOUR DINOSAUR

Once you have inserted batteries into your dinosaur and remote control, you can go ahead and power on your dinosaur. To do so, switch the ON / OFF button to turn on the dinosaur.
(The LED light of the eyes will be on.)

When you do not operate the dinosaur for about 2 minutes, it will make a sound and enter sleep mode, you can restart by switching the ON /OFF button to resume use.

When you have finished playing with your dinosaur, switch the ON / OFF button to turn off the dinosaur.
NOTE: When your dinosaur is running low on power, it will emit an audible tone and power down.

Once the batteries are completely depleted, replace the batteries as soon as possible to continue use.

MOVING YOUR DINOSAUR

You can use your remote control to move your dinosaur around in different directions.

By pressing the left and right arrow buttons, your dinosaur will turn left or right.

By pressing the forward / backward button, the dinosaur will walk forward / backward for a distance.
By pressing the action acceleration button, the dinosaur will enter action acceleration mode, press the forward / backward button, the dinosaur will accelerate forward / backward for a distance.
Press the action acceleration button again to return normal mode.

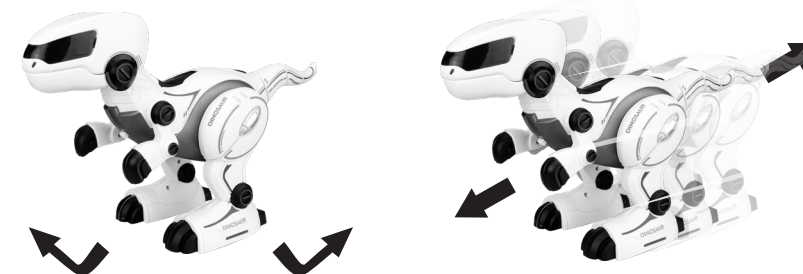

PROGRAMMING YOUR DINOSAUR

Press the program button and your dinosaur will enter program mode.
Once in program mode, you can press any buttons on the controller to create your own commands.
The dinosaur can be programmed with up to 30 actions. Press the program play button to make dinosaur perform the programmed actions.

WARNING: BATTERIES ARE TO BE INSERTED WITH THE CORRECT POLARITY (+ AND -). DO NOT MIX DIFFERENT TYPES OF BATTERIES OR NEW AND USED BATTERIES. NON-RECHARGEABLE BATTERIES ARE NOT TO BE RECHARGED. RECHARGEABLE BATTERIES ARE ONLY TO BE CHARGED BY AN ADULT. RECHARGEABLE BATTERIES ARE TO BE REMOVED FROM THE TOY BEFORE BEING CHARGED. THE SUPPLY TERMINALS ARE NOT TO BE SHORT-CIRCUITED. REMOVE BATTERIES FROM THE TOY WHEN NOT IN USE FOR AN EXTENDED TIME OR WHEN BATTERIES BECOME EXHAUSTED. BATTERY INSTALLATION BY AN ADULT IS REQUIRED. DISPOSE OF BATTERIES RESPONSIBLY. DO NOT DISPOSE OF IN FIRE.

WARNING: FOR SAFETY REASONS, REMOVE ALL TAGS, LABELS AND PLASTIC FASTENERS BEFORE GIVING THIS TOY TO YOUR CHILD.

WARNING: CHOKING HAZARD
SMALL PARTS. NOT FOR CHILDREN UNDER 3 YEARS.

WARNING: THIS TOY PRODUCES FLASHES THAT MAY TRIGGER EPILEPSY IN SENSITISED INDIVIDUALS.



ADULT SUPERVISION REQUIRED.
PRODUCT MAY VARY SLIGHTLY FROM IMAGE SHOWN.
PLEASE KEEP THE PACKAGING FOR FUTURE REFERENCE.
READ THE INSTRUCTION BEFORE OPERATING THE PRODUCT.

K: 43-643-639
T: 71-877-846