

MINI WORLD INSTALLATION

BOOK NOOK -RETRO BOOKSTORE

43-643-219



WARNING: BATTERIES ARE TO BE INSERTED WITH THE CORRECT POLARITY (+ AND -). DO NOT MIX DIFFERENT TYPES OF BATTERIES OR USED BATTERIES. NON-RECHARGEABLE BATTERIES ARE NOT TO BE RECHARGED. RECHARGEABLE BATTERIES ARE ONLY TO BE CHARGED UNDER ADULT SUPERVISION. THE SUPPLY TERMINALS ARE NOT TO BE SHORT-CIRCUITED. REMOVE BATTERIES FROM THE TOY WHEN NOT IN USE FOR AN EXTENDED TIME OR WHEN BATTERIES BECOME EXHAUSTED. BATTERY INSTALLATION BY AN ADULT IS REQUIRED. DISPOSE OF BATTERIES RESPONSIBLY. DO NOT DISPOSE OF IN FIRE.

WARNING: CHOKING HAZARD - SMALL PARTS. NOT FOR CHILDREN UNDER 3 YEARS.

WARNING: THIS TOY PRODUCES FLASHES THAT MAY TRIGGER EPILEPSY IN SENSITIZED INDIVIDUALS.

ADULT ASSISTANCE AND SUPERVISION REQUIRED. PRODUCT MAY DIFFER FROM IMAGE SHOWN. PLEASE KEEP THE PACKAGING FOR FUTURE REFERENCE.

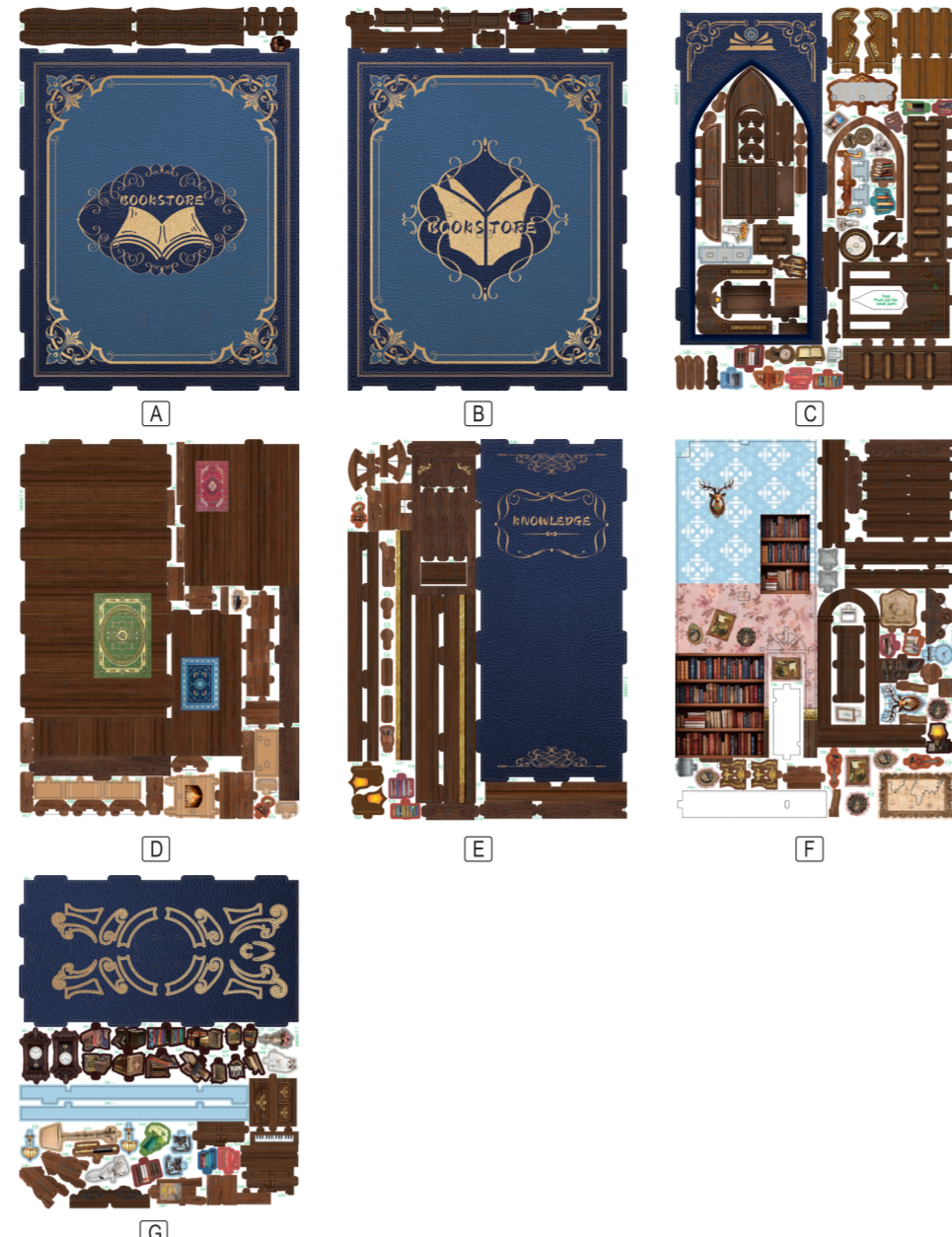

Accessories List			
Battery case X1	Circuit board with switch X1	Light Strip X2	Sandpaper X1



Precautions Before Assembly

- The electronic kit have been assembled in advance, please use them directly and do not disassemble, otherwise it will be damaged and won't work.
- Make sure no parts are missing and remove the parts from the board in the order of assembly. (If you take out all the parts before assembly, you don't know the order, and it's hard to assemble.)
- Please be careful not to lose small parts.
- Try to avoid removing parts by hand, (included) It is an auxiliary tool for removing parts, used to push out small parts on the wooden board.
- Glue needs to be used at some points. After the glue is pasted, leave the product untouched for two hours to ensure a firm paste. To save time, you can do the pasting step first and then assemble the rest of the plugins.

Safety Precautions

- Burns on the edge of the wood, please pay special attention to them.
- Since they are made of wood, too much force may break them.
- Keep away from fire and keep in a dry place to avoid damage.
- This product is not waterproof, please do not place in damp places.
- Never put small parts in your mouth as there is a risk of suffocation, and choking.
- Keep out of reach of infants.

Special attention Angle of conversion Using glue (The glue is not included and needs to be purchased separately by the consumer.)

ASSEMBLE STEPS

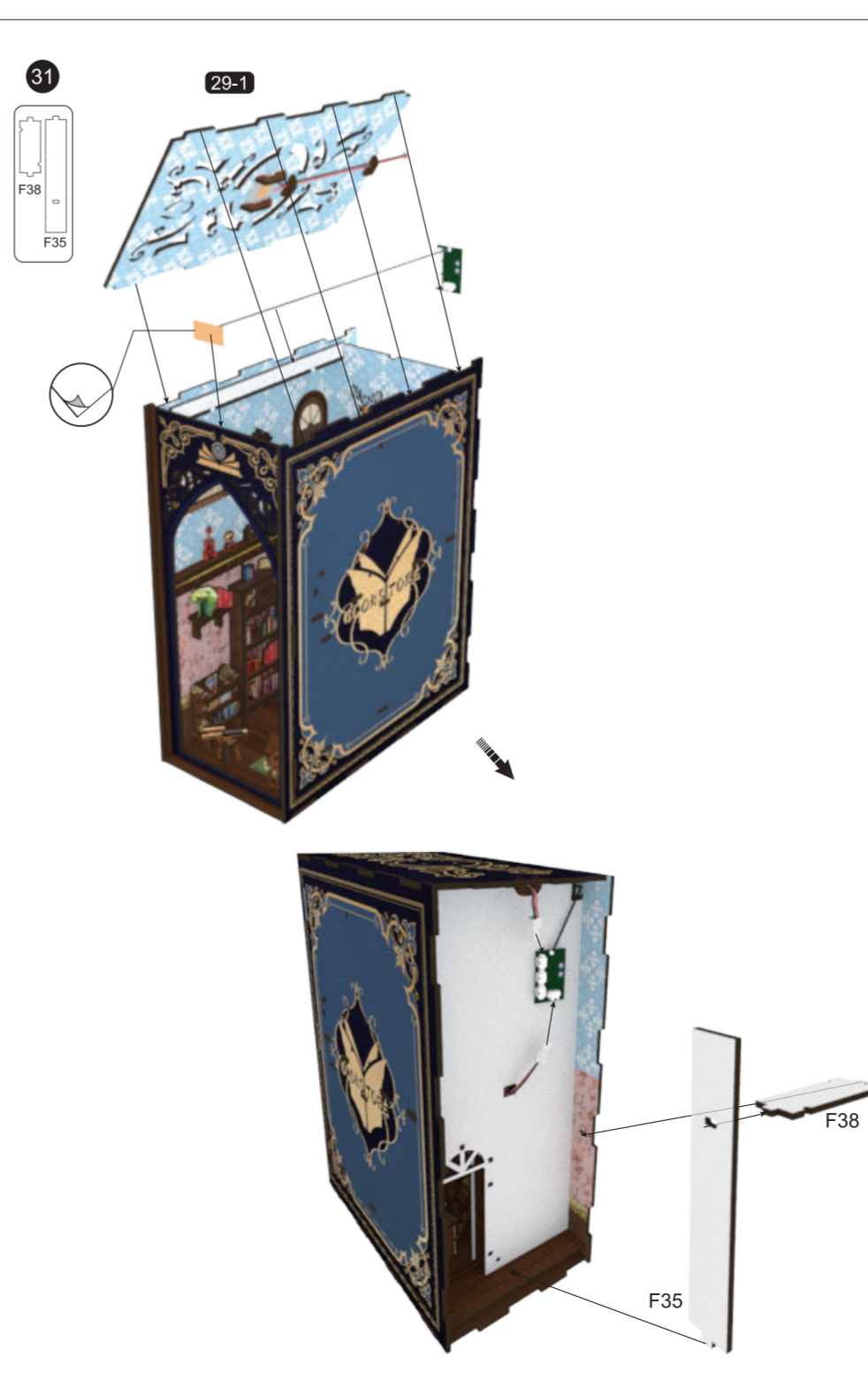
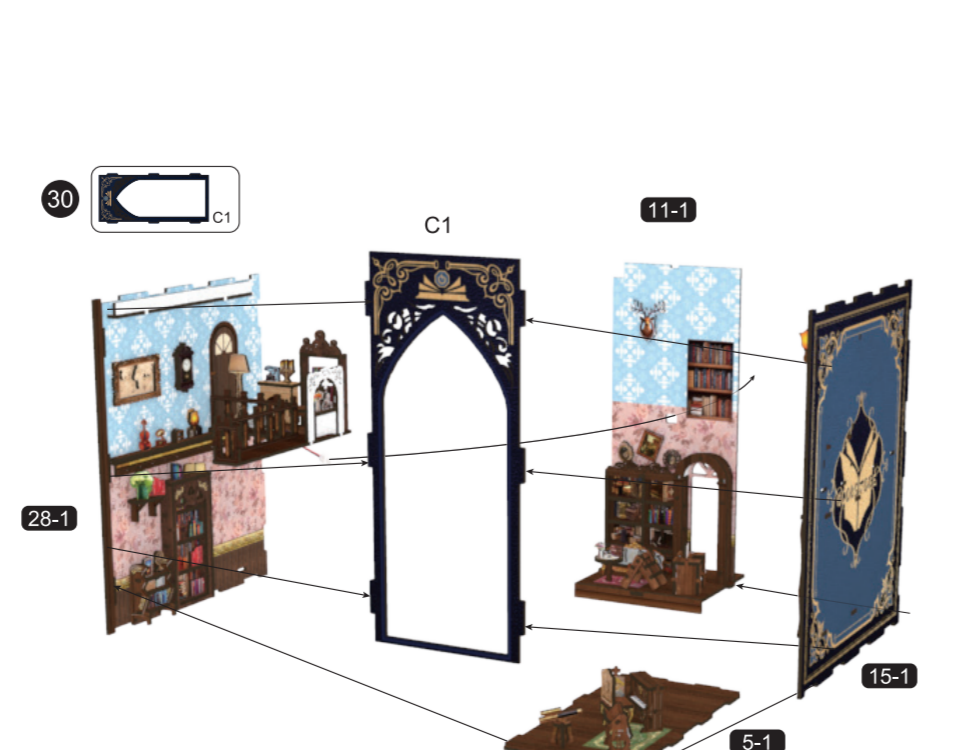
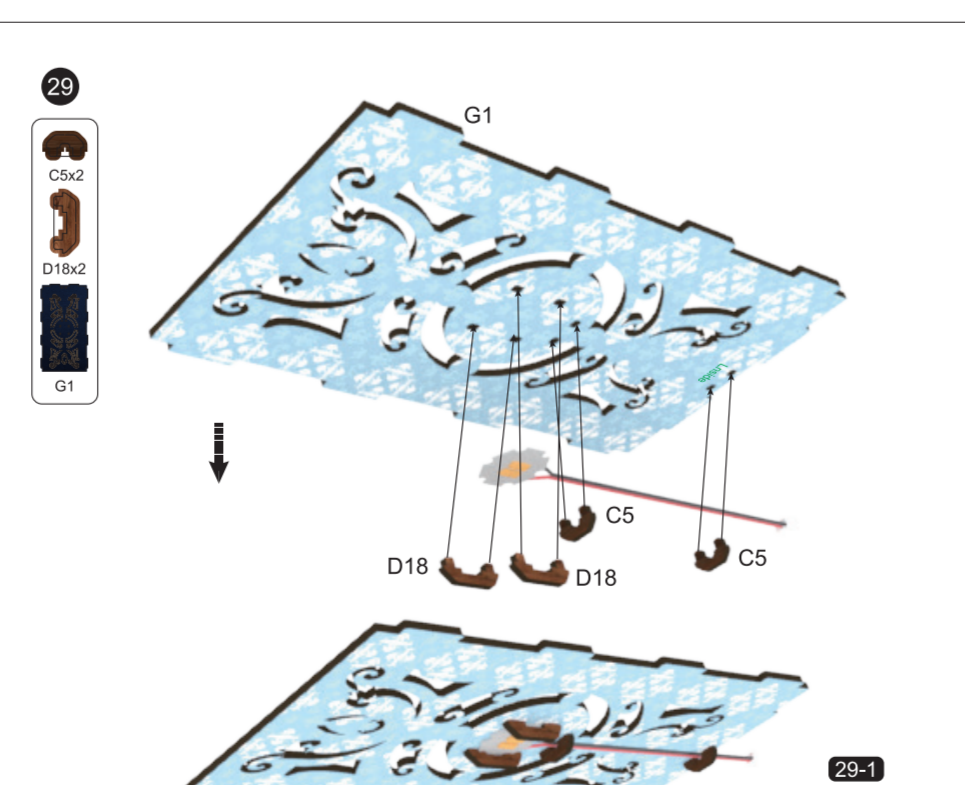
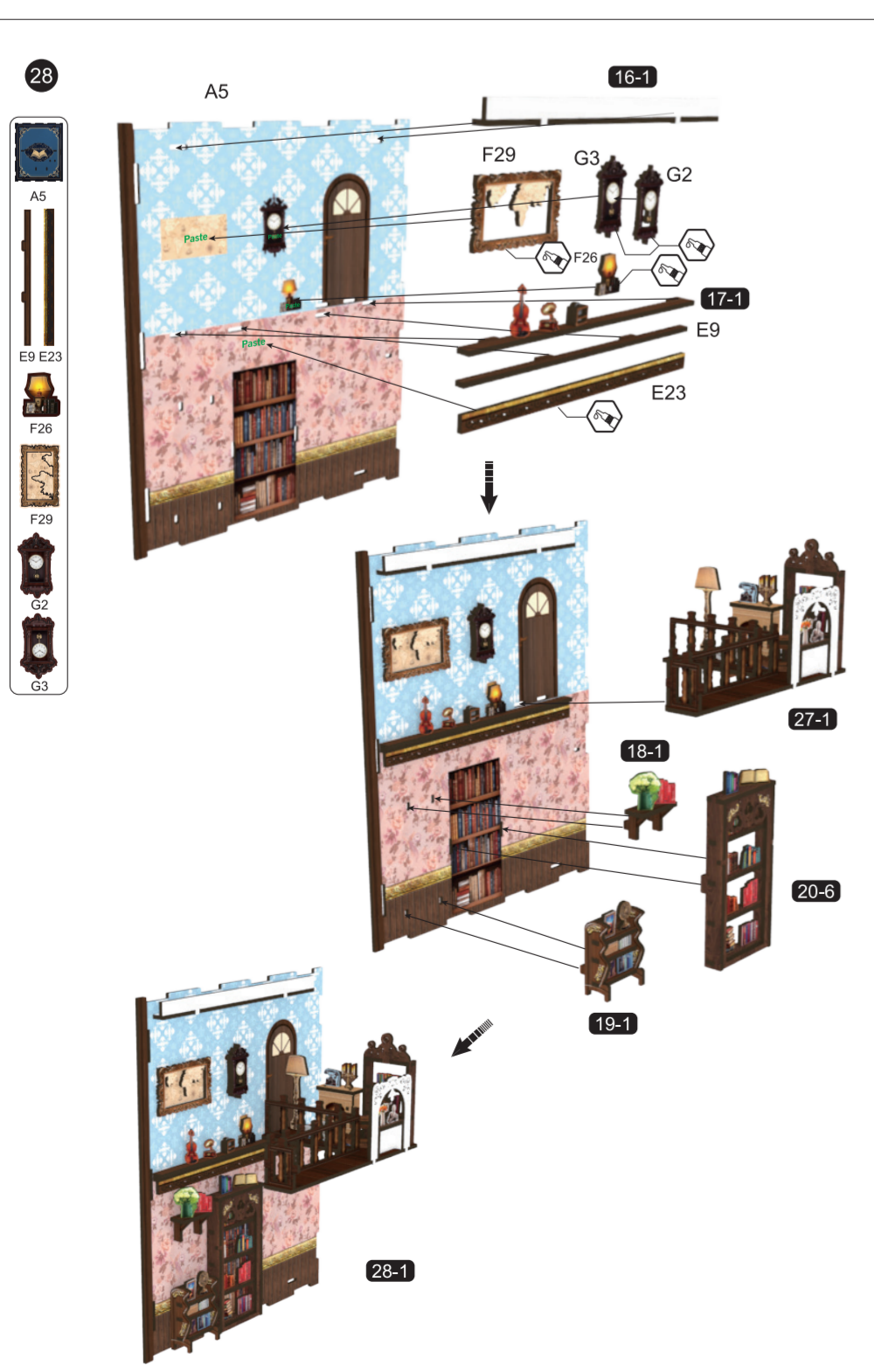
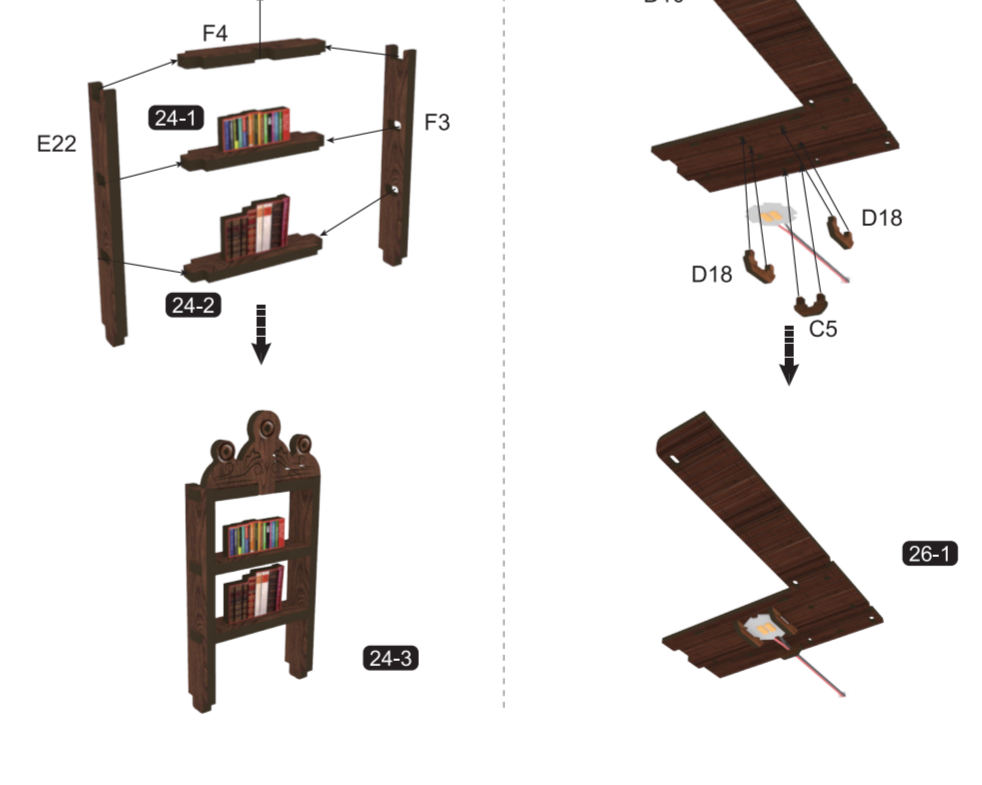
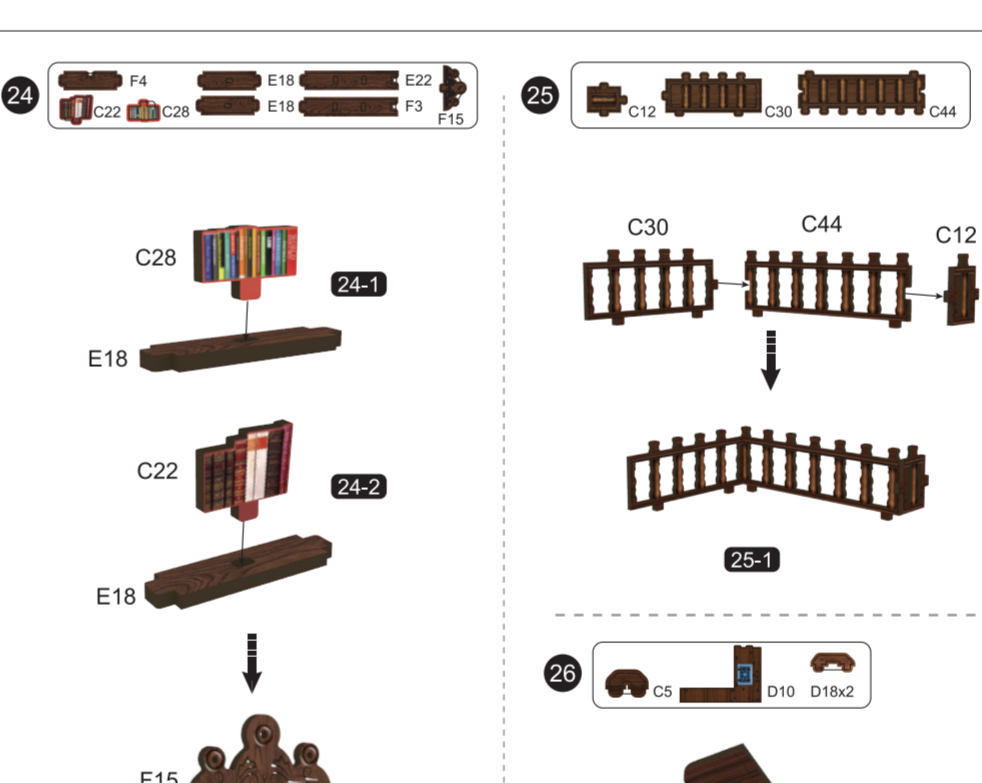
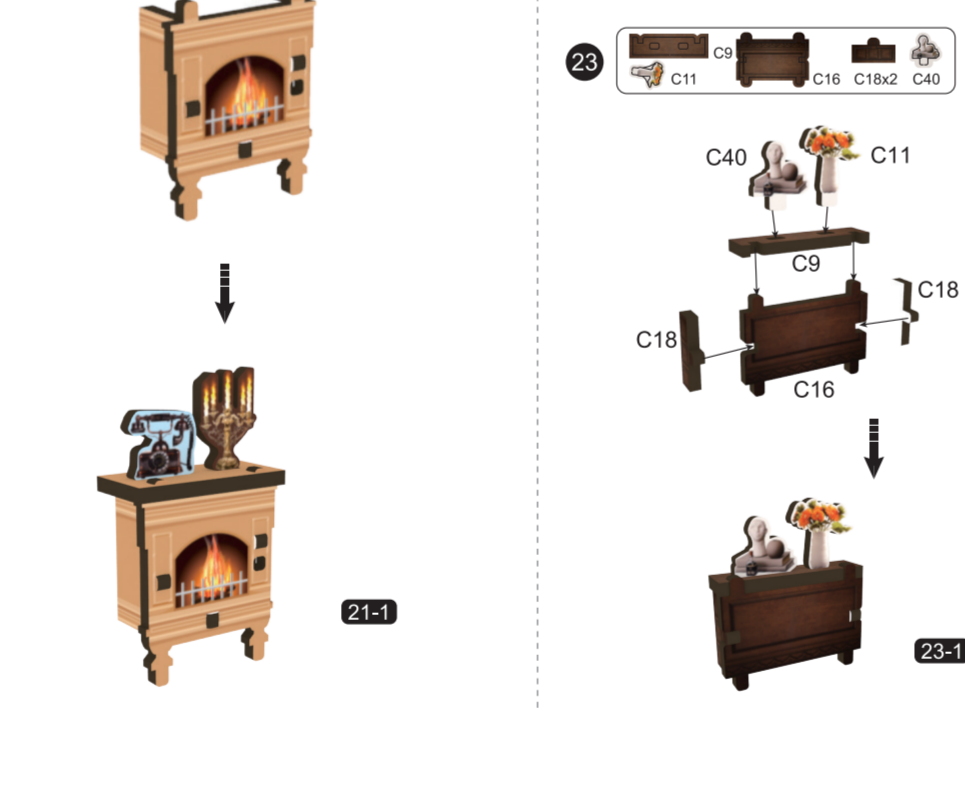
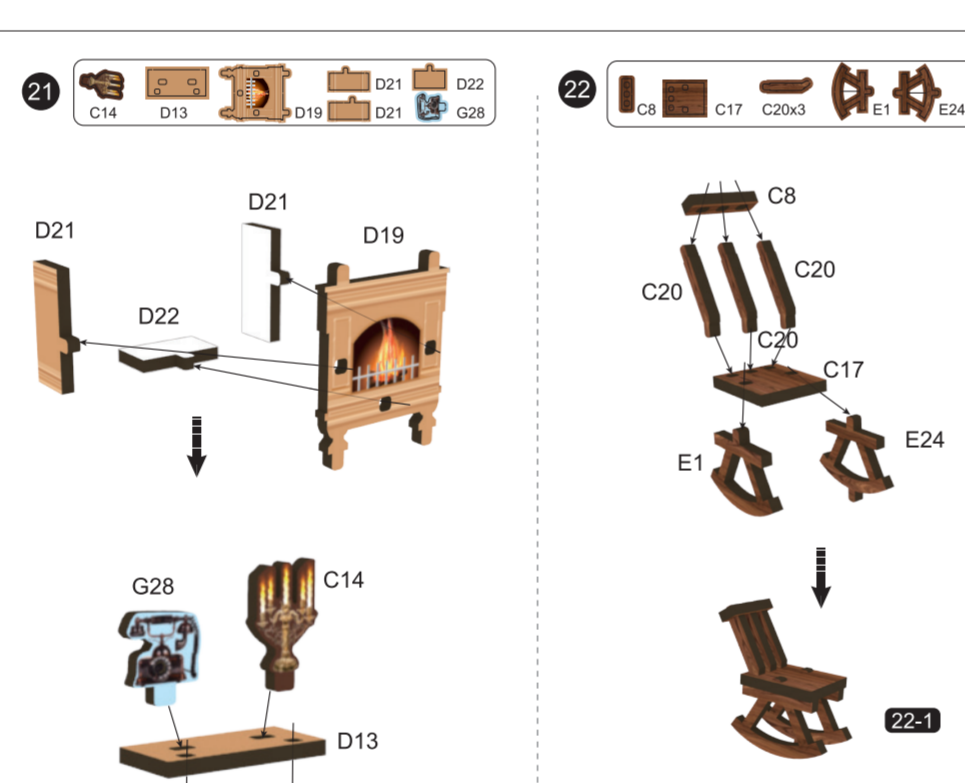
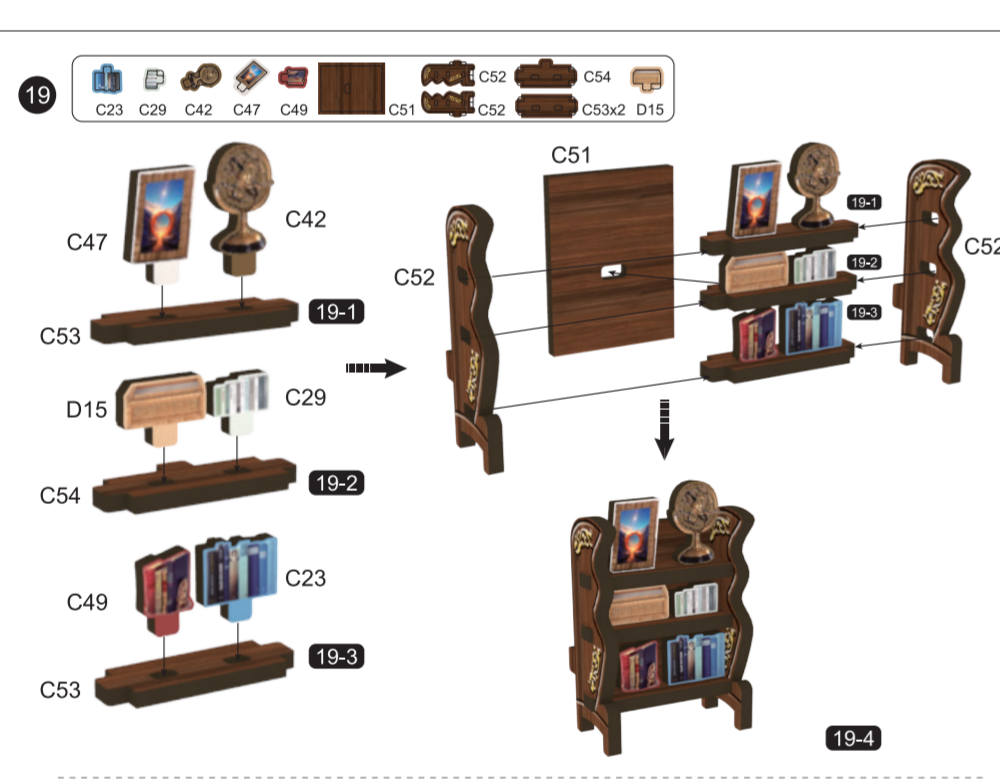
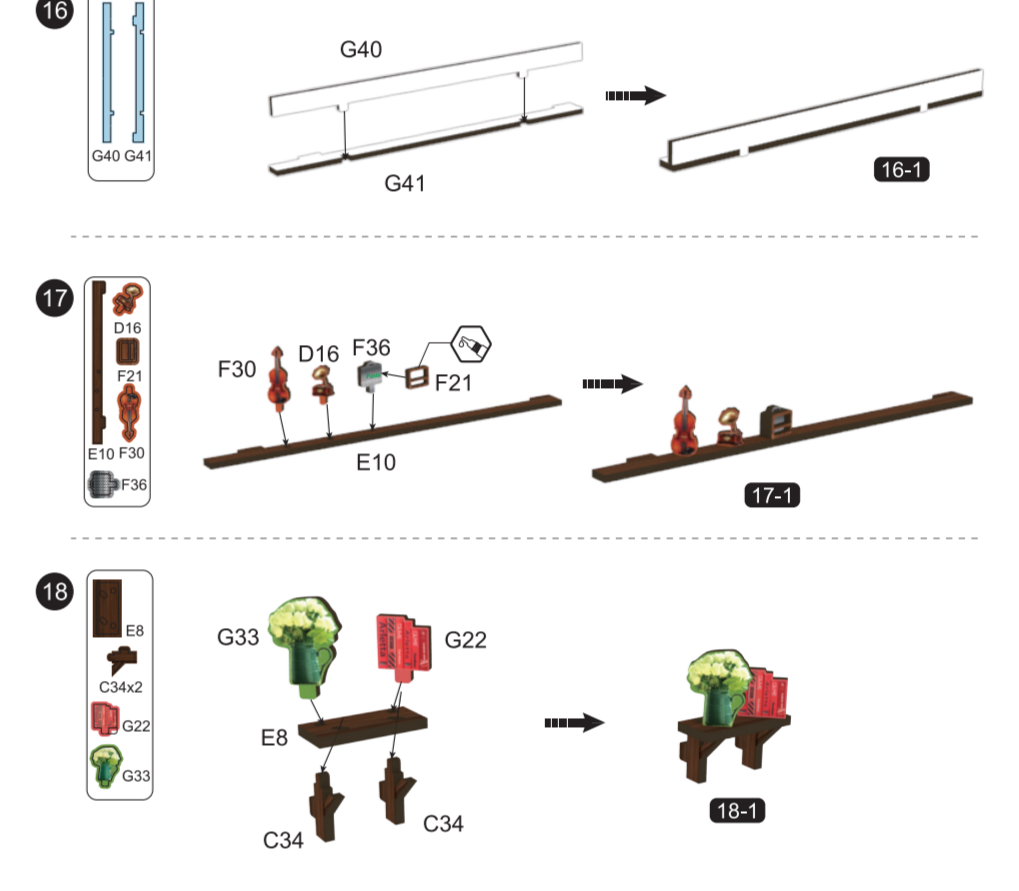
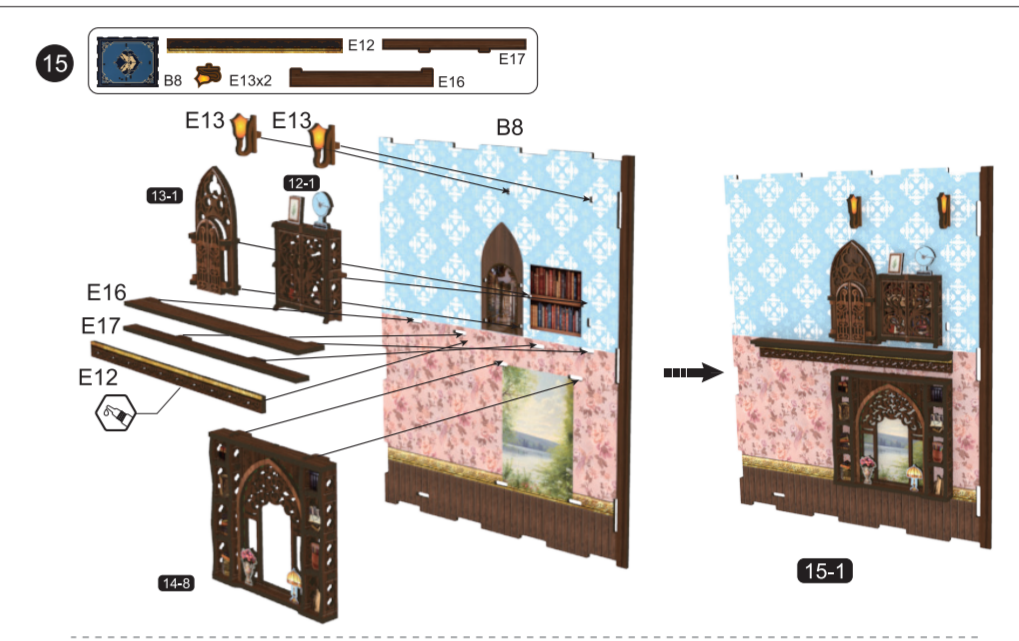
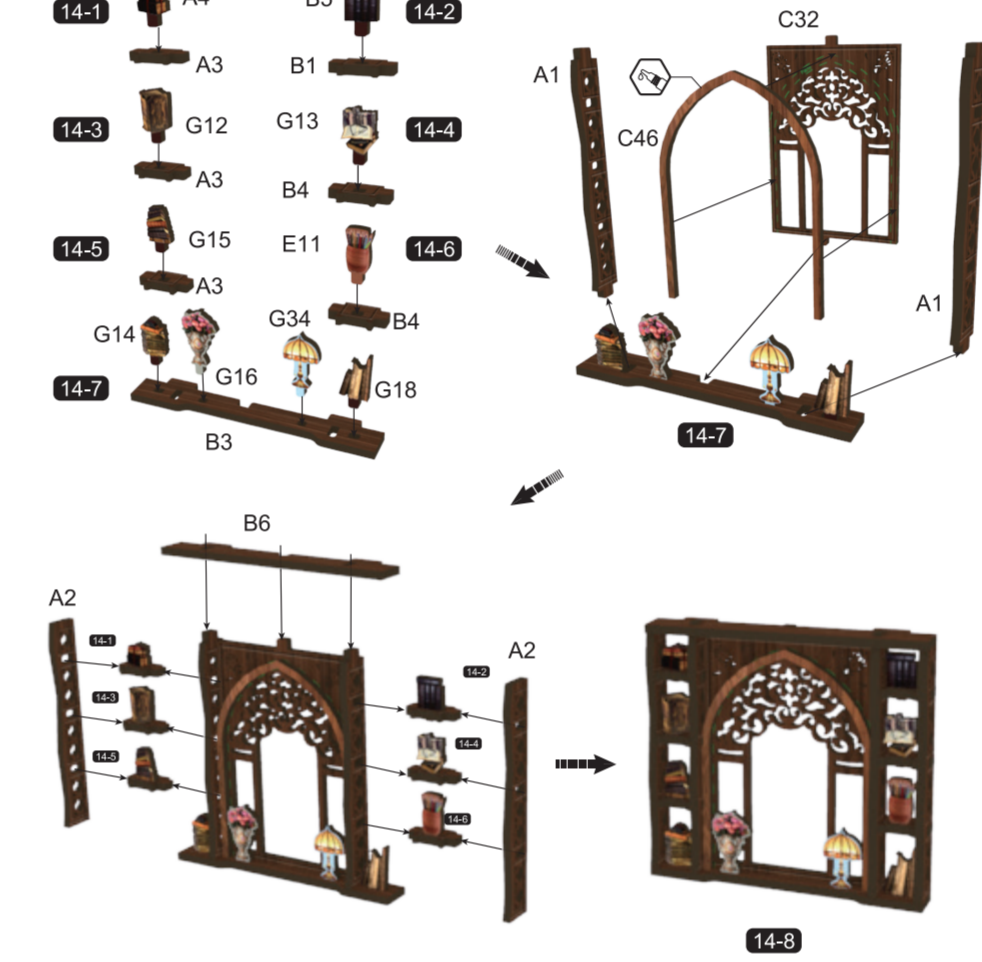
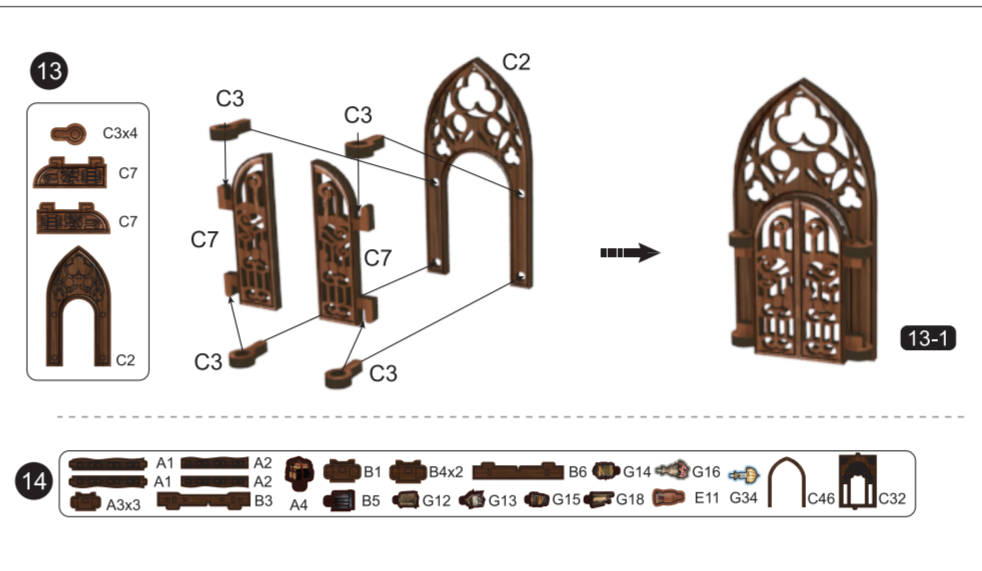
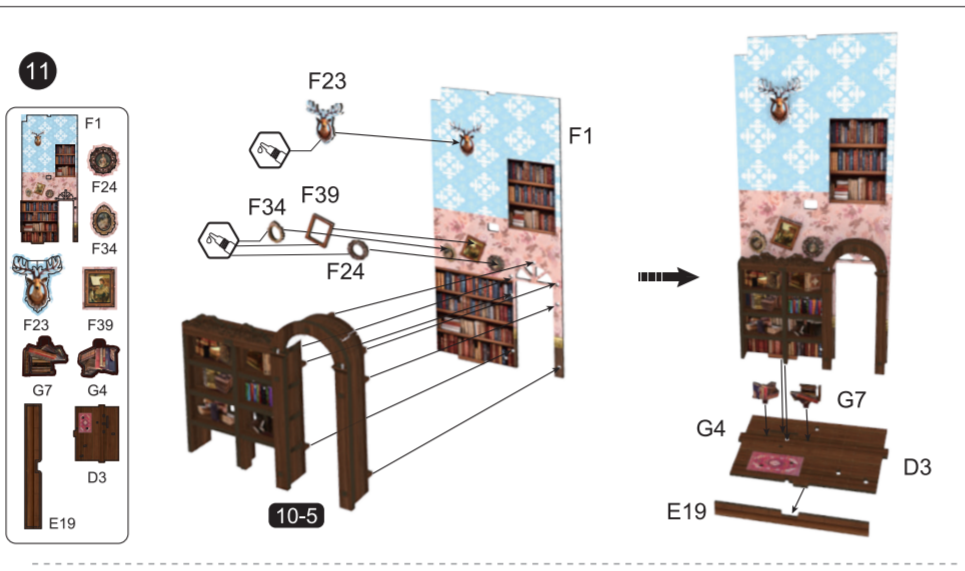
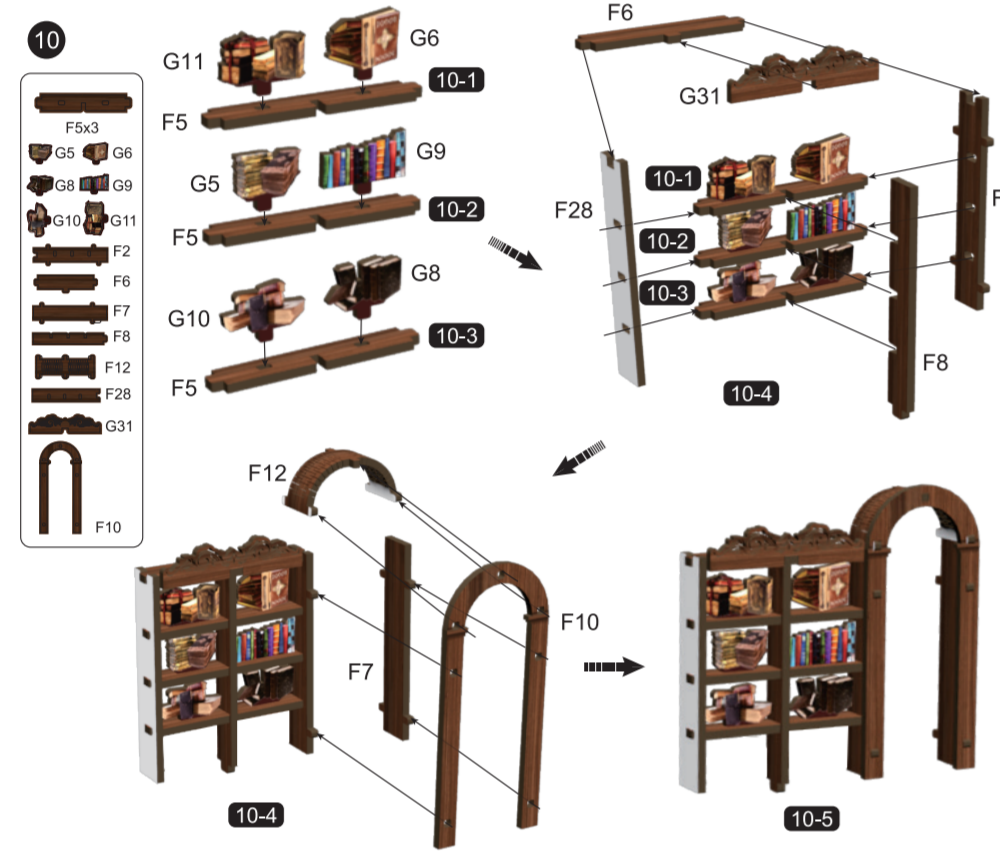
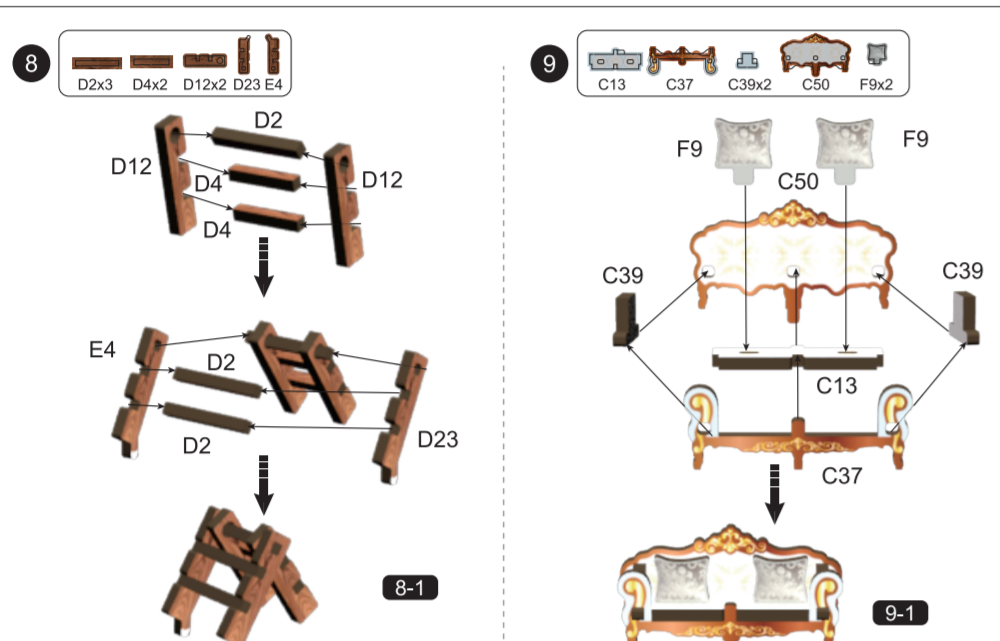
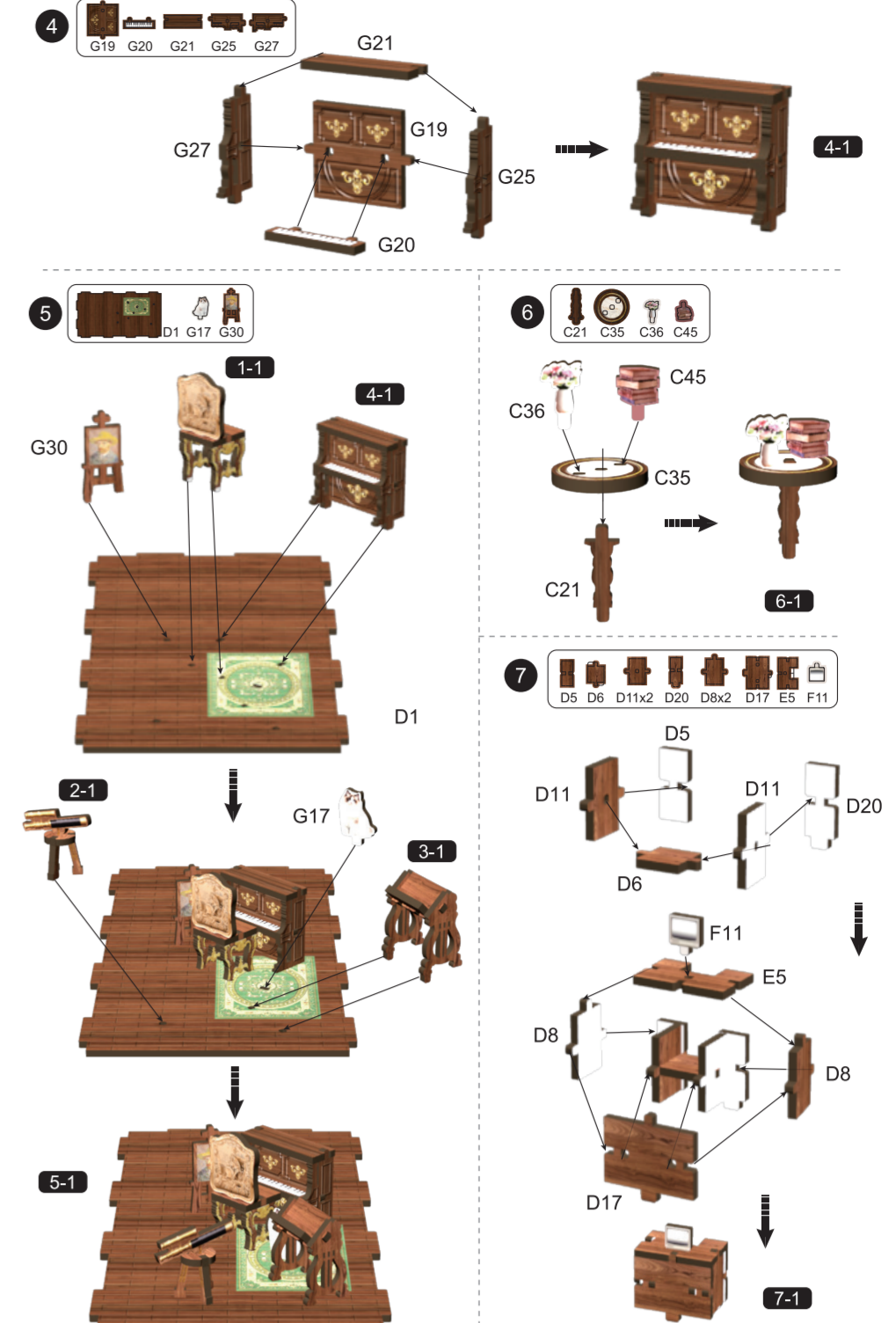
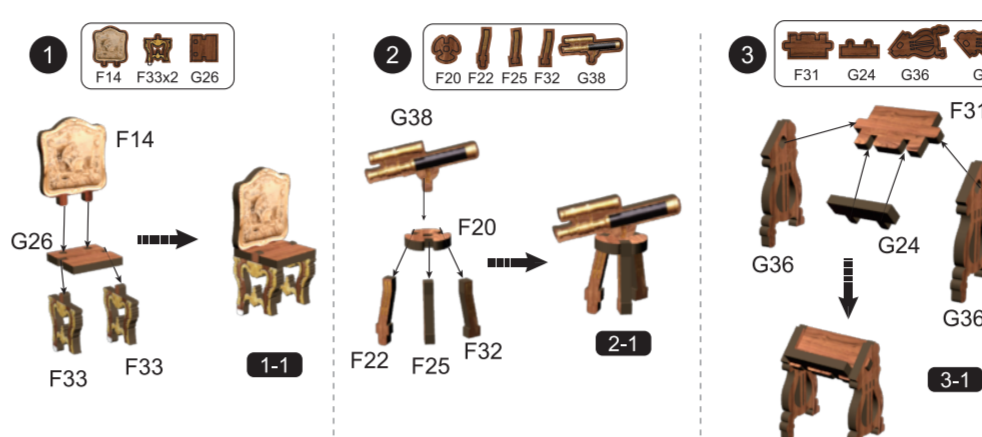

MINI WORLD INSTALLATION

BOOK NOOK-
FLYING HOUSE
43-643-219



Light up button

WARNING: BATTERIES ARE TO BE INSERTED WITH THE CORRECT POLARITY (+ AND -). DO NOT MIX DIFFERENT TYPES OF BATTERIES OR NEW AND USED BATTERIES. NON-RECHARGEABLE BATTERIES ARE NOT TO BE RECHARGED. RECHARGEABLE BATTERIES ARE ONLY TO BE CHARGED UNDER ADULT SUPERVISION. THE SUPPLY TERMINALS ARE NOT TO BE SHORT-CIRCUITED. REMOVE BATTERIES FROM THE TOY WHEN NOT IN USE FOR AN EXTENDED TIME OR WHEN BATTERIES BECOME EXHAUSTED. BATTERY INSTALLATION BY AN ADULT IS REQUIRED. DISPOSE OF BATTERIES RESPONSIBLY. DO NOT DISPOSE OF IN FIRE.

WARNING: CHOKING HAZARD - SMALL PARTS. NOT FOR CHILDREN UNDER 3 YEARS.

WARNING: THIS TOY PRODUCES FLASHES THAT MAY TRIGGER EPILEPSY IN SENSITIZED INDIVIDUALS.

ADULT ASSISTANCE AND SUPERVISION REQUIRED. PROCEED WITH CARE FROM MAKE SOURCE. PLEASE KEEP THE PACKAGING FOR FUTURE REFERENCE.

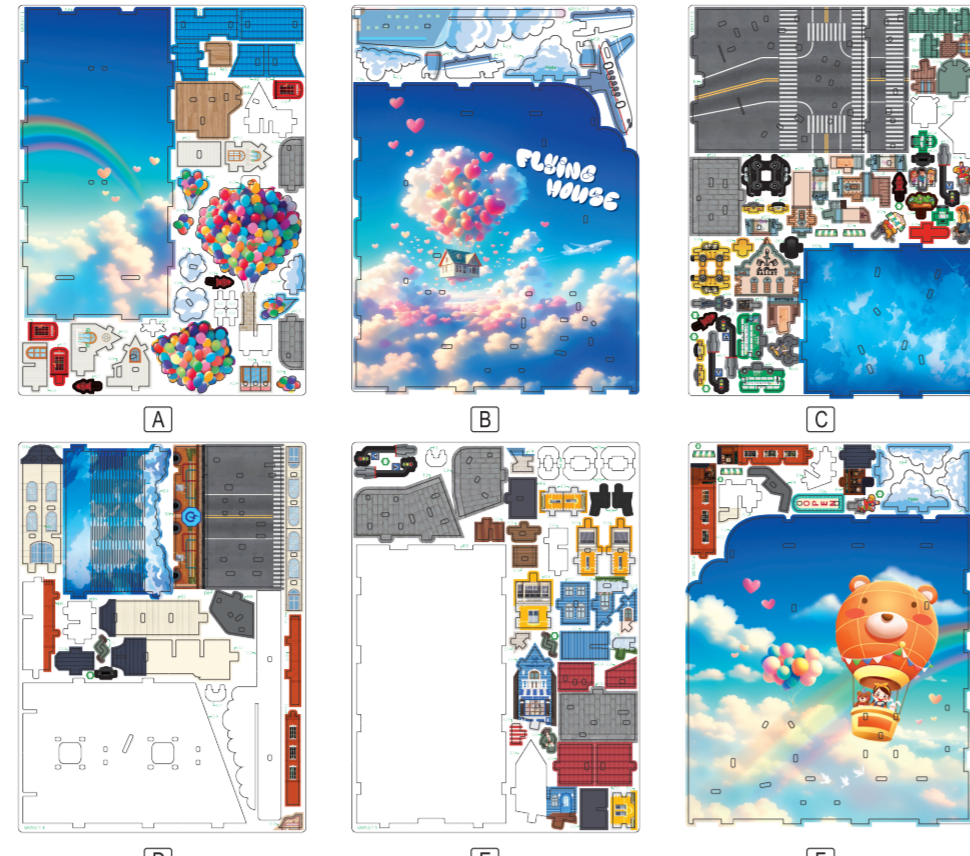

Accessories List				
Mirror	Circuit board switch X1	Battery case X1	Light Strip X2	Sandpaper X1

[Precautions Before Assembly]

- The electronic kit have been assembled in advance, please use them directly and do not disassemble, otherwise it will be damaged and won't work.
- Make sure no parts are missing and remove the parts from the board in the order of assembly. (If you take out all the parts before assembly, you don't know the order, and it's hard to assemble.)
- Please be careful not to lose small parts.
- *Try to avoid removing parts by hand, (included) is an auxiliary tool for removing parts, used to push out small parts on the wooden board.
- Glue needs to be used at some points. After the glue is pasted, leave the product untouched for two hours to ensure a firm paste. To save time you can do the pasting step first and then assemble the rest of the plugins.

[Safety Precautions]

- Burns on the edge of the wood, please pay special attention to them.
- Since they are made of wood, too much force may break them.
- Keep away from fire and keep in a dry place to avoid damage.
- This product is not waterproof, please do not place in damp place.
- Never put small parts in your mouth as there is a risk of suffocation and choking.
- Keep out of reach of infants.

ASSEMBLE STEPS

1.

2.

3.

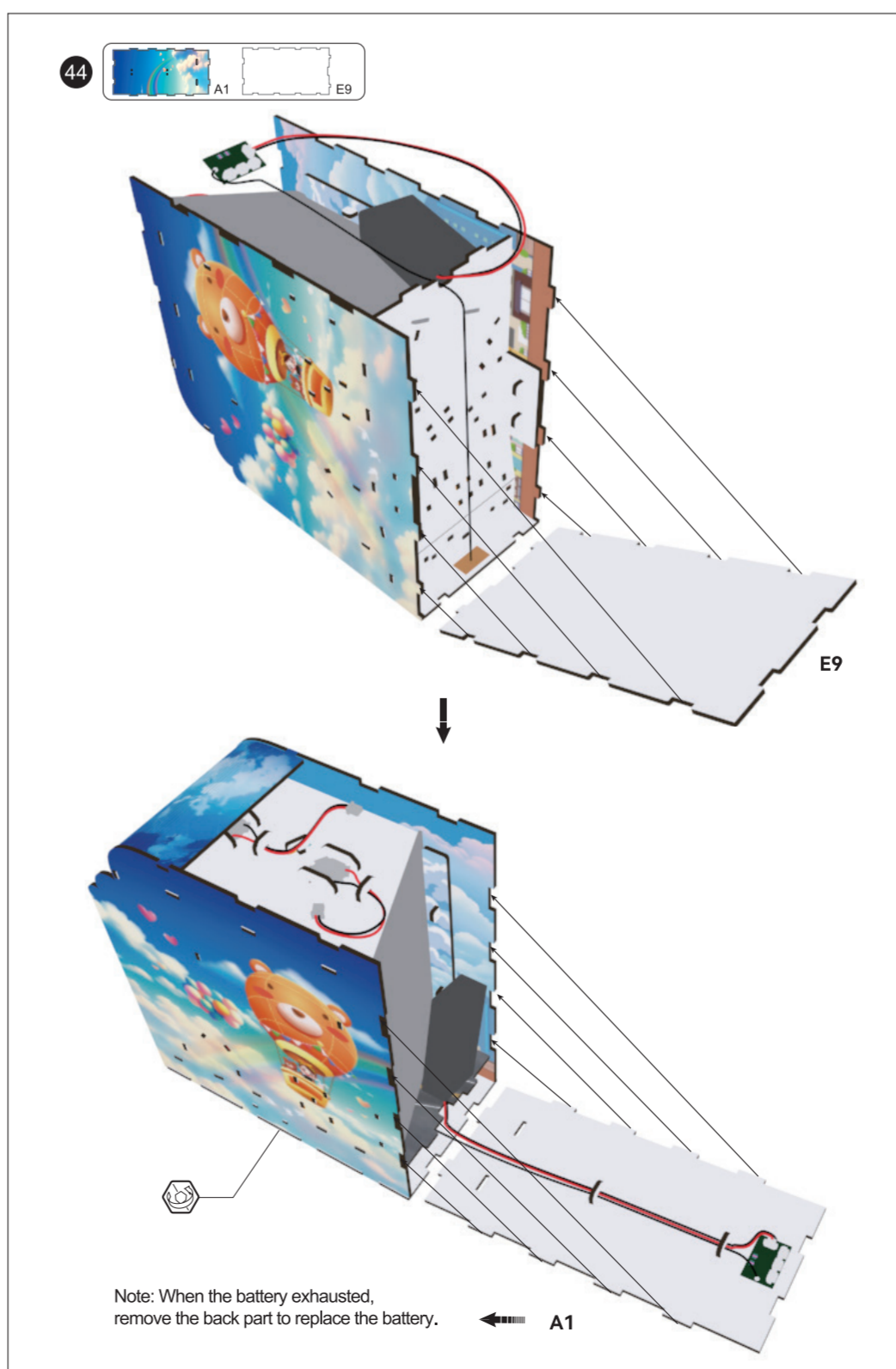
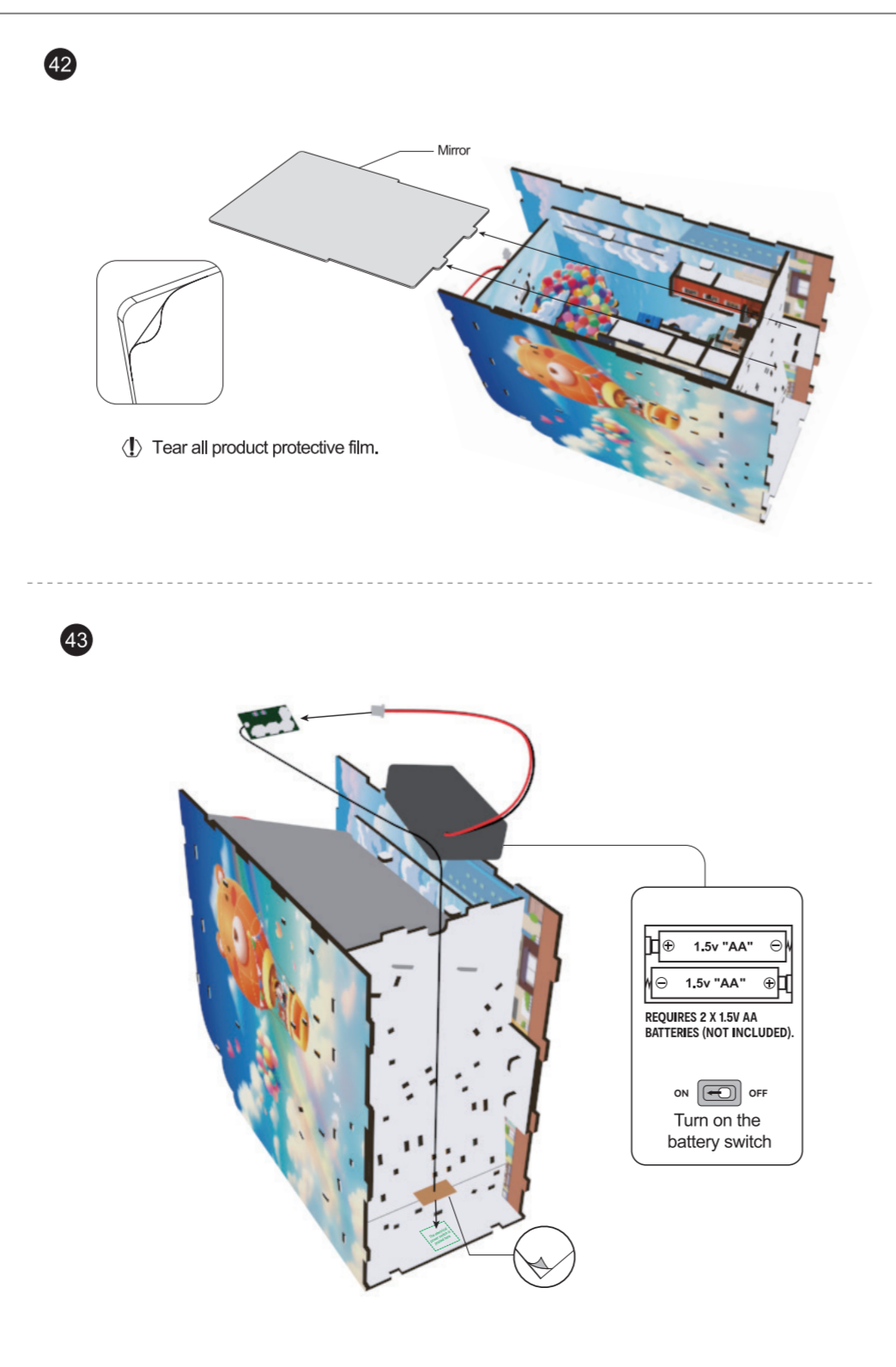
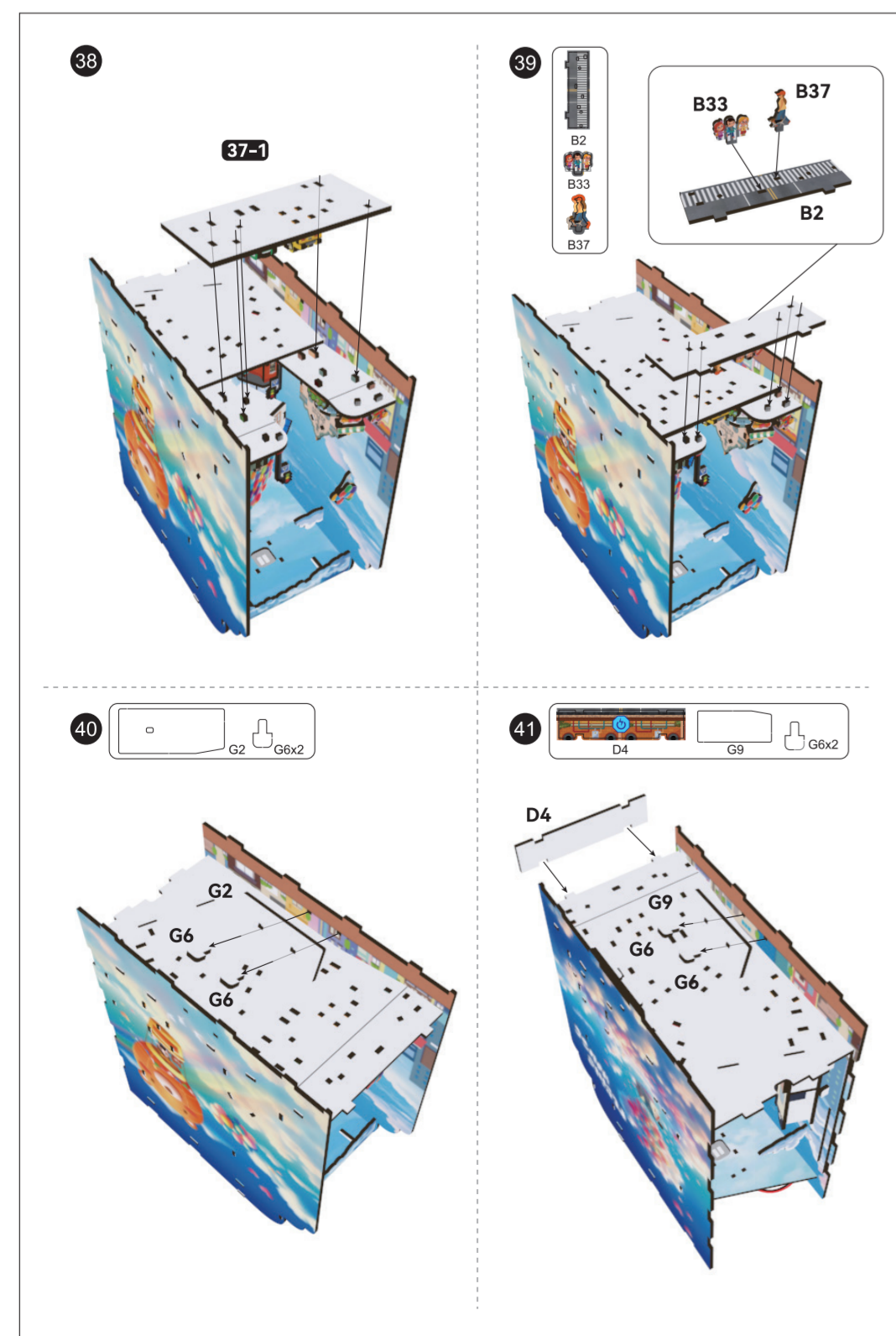
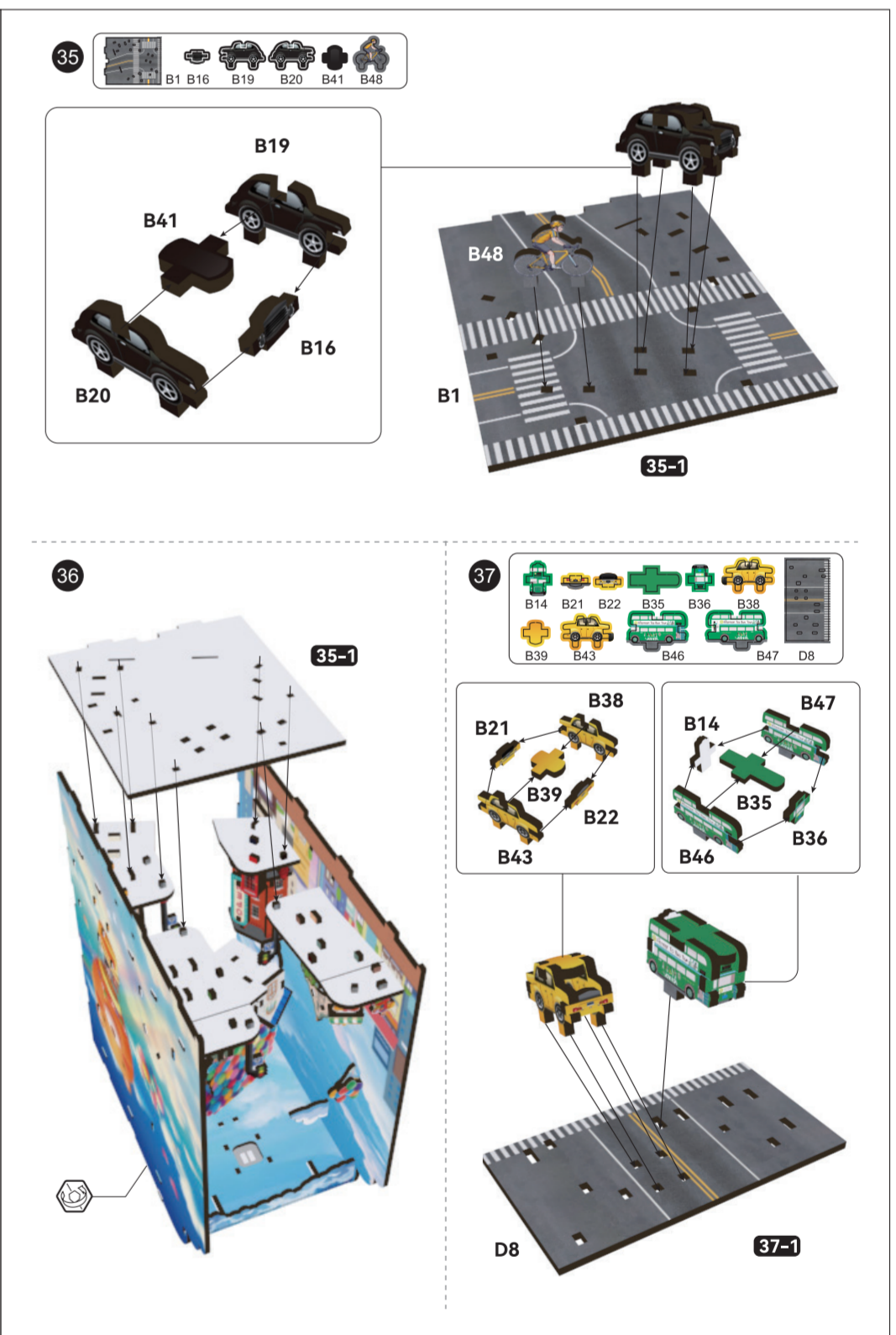
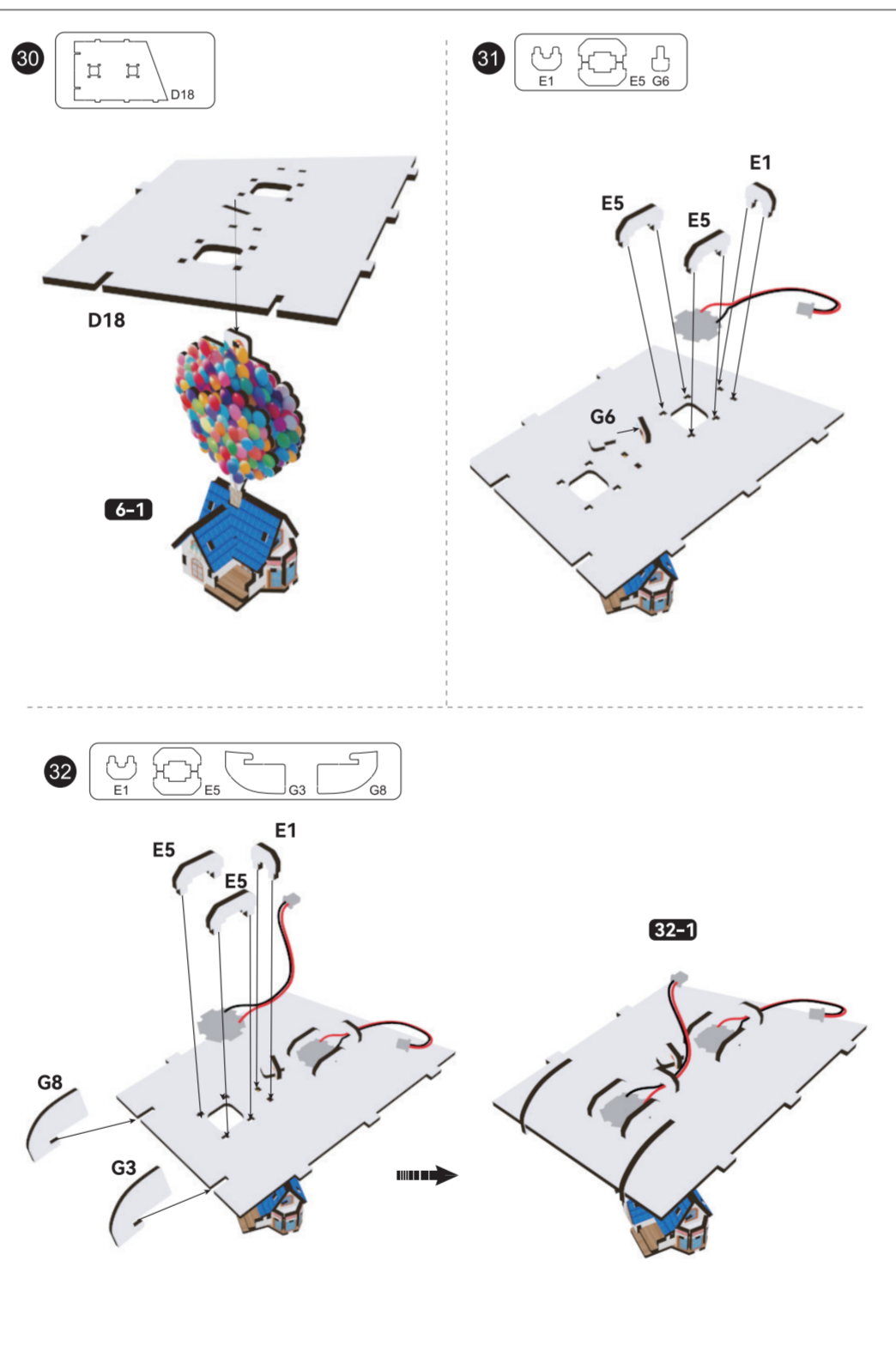
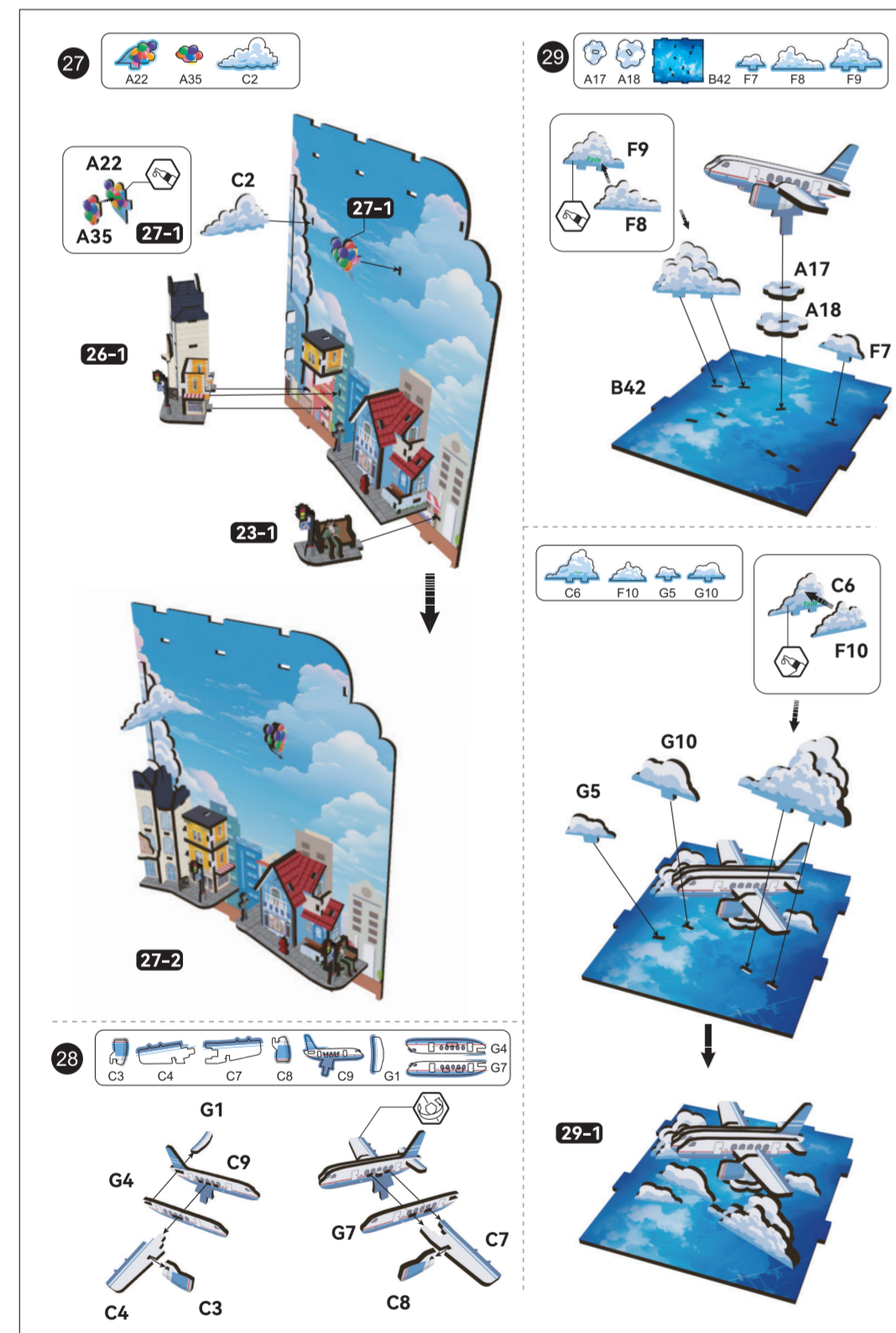
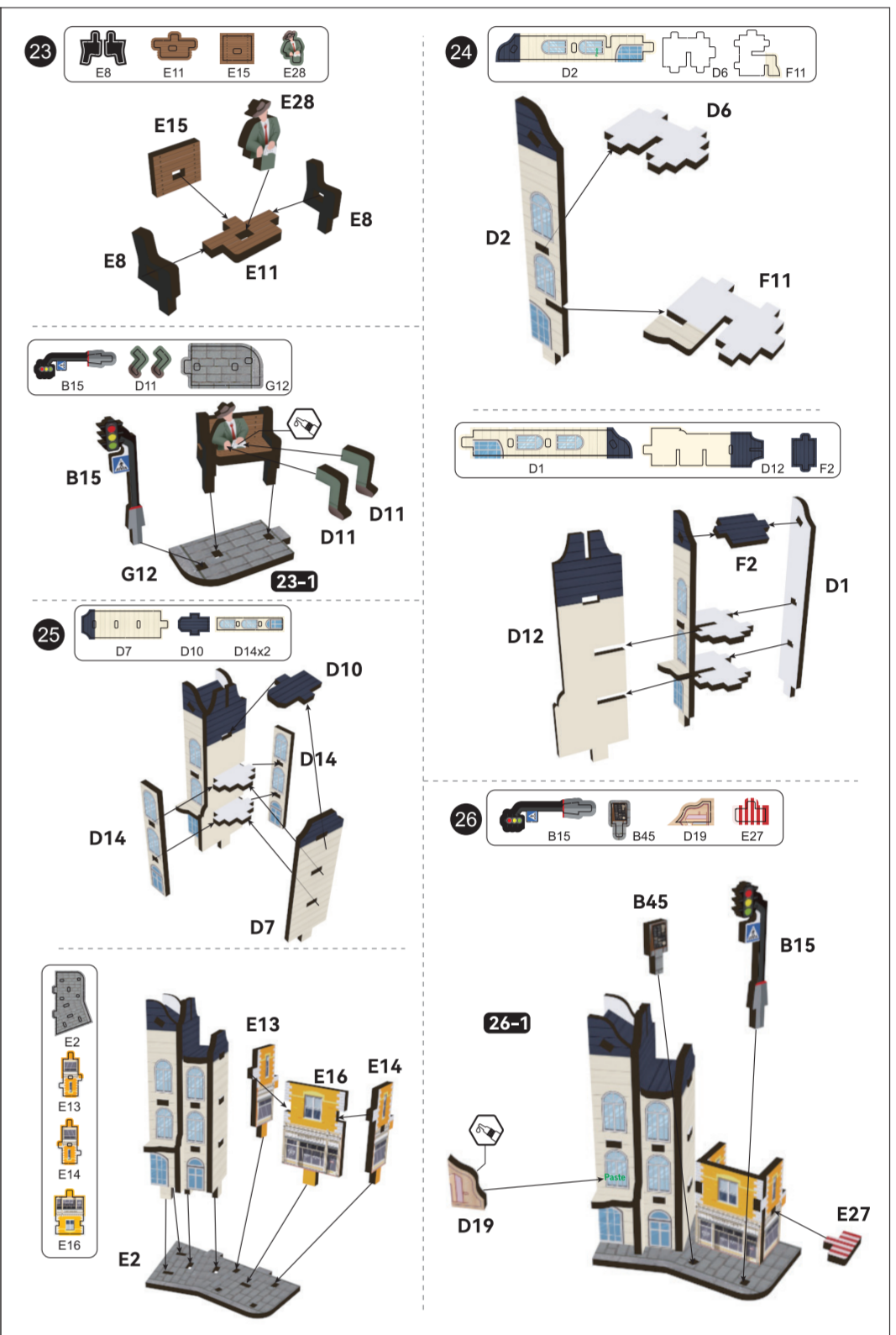
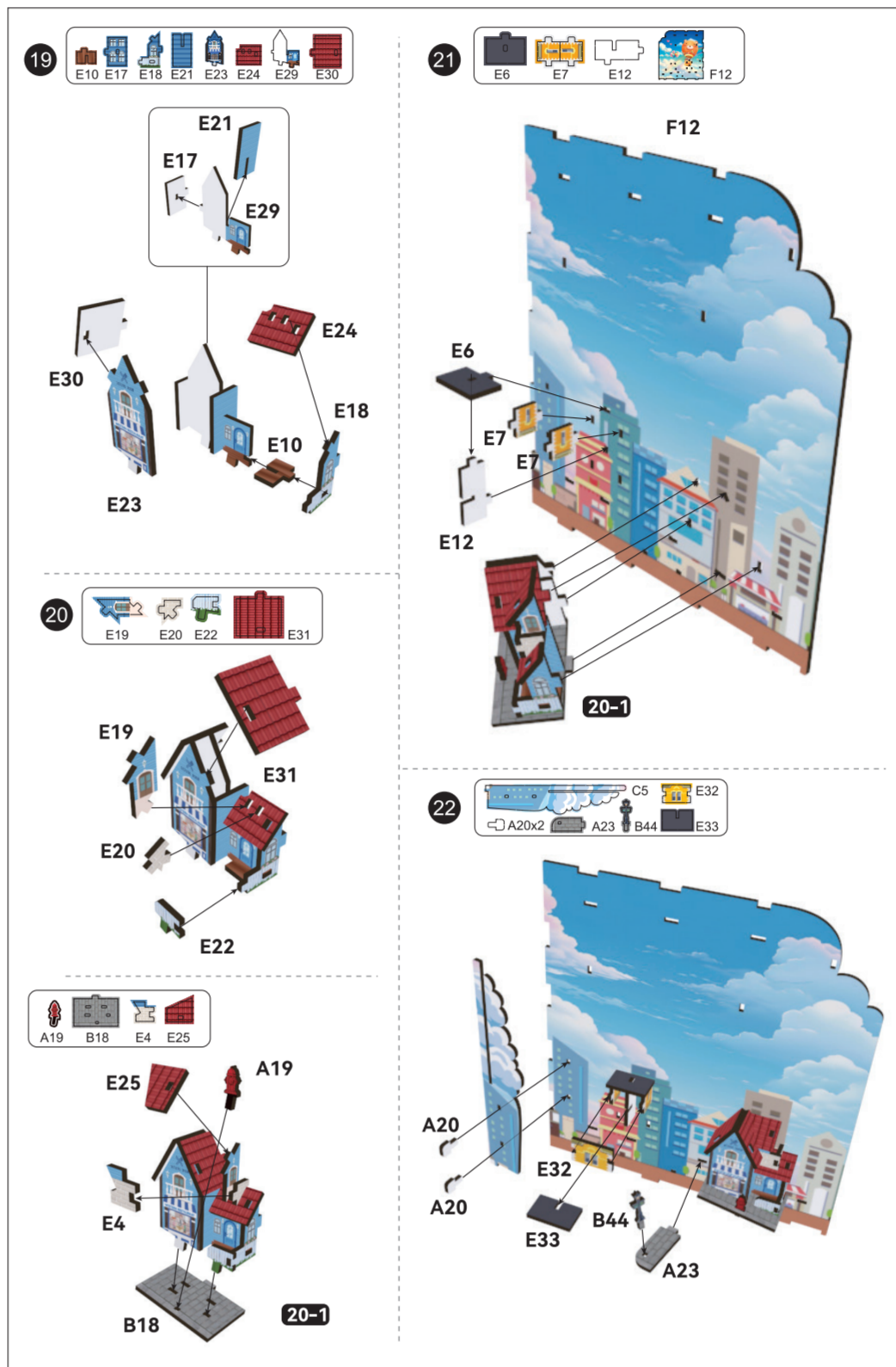
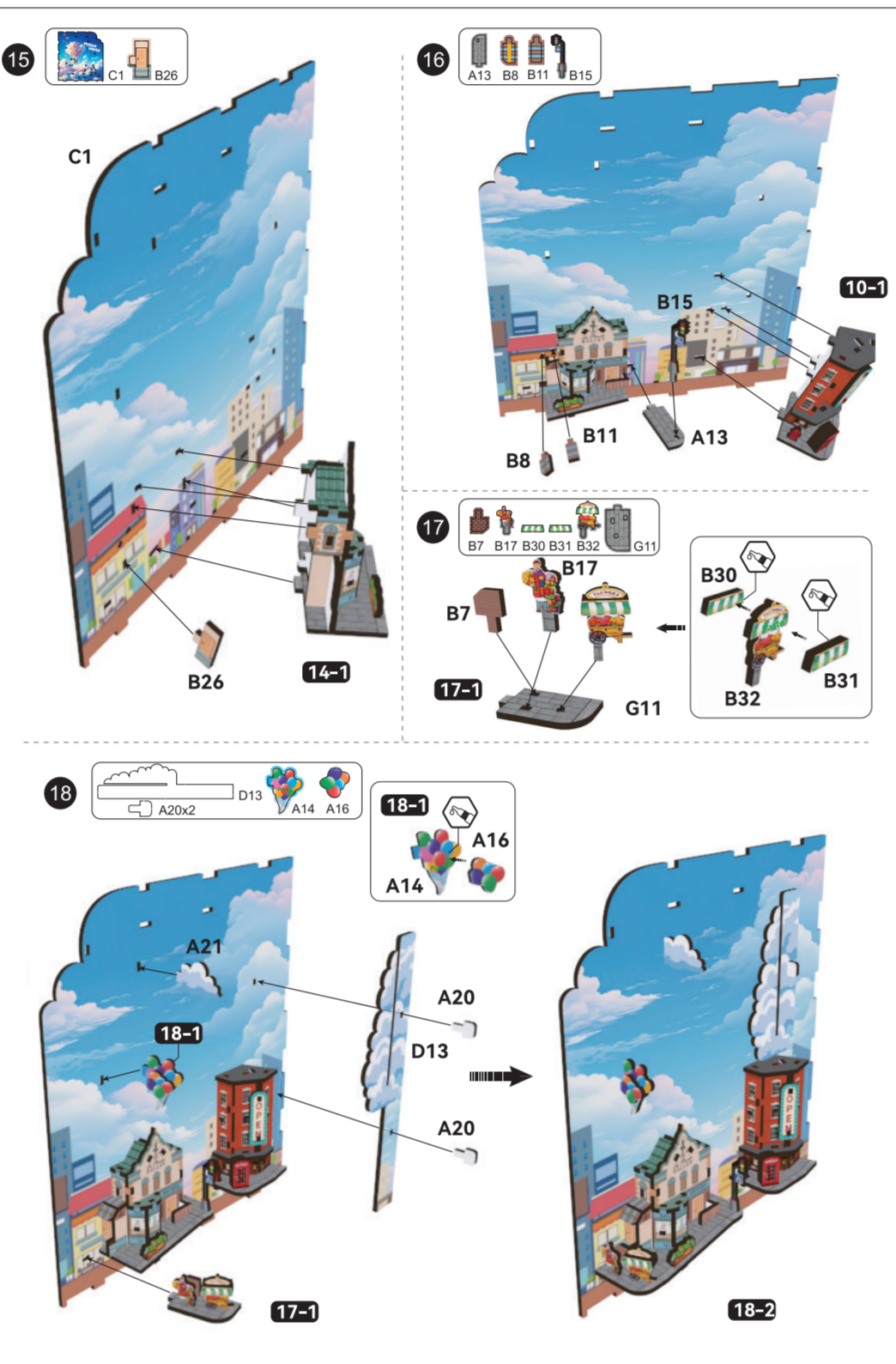
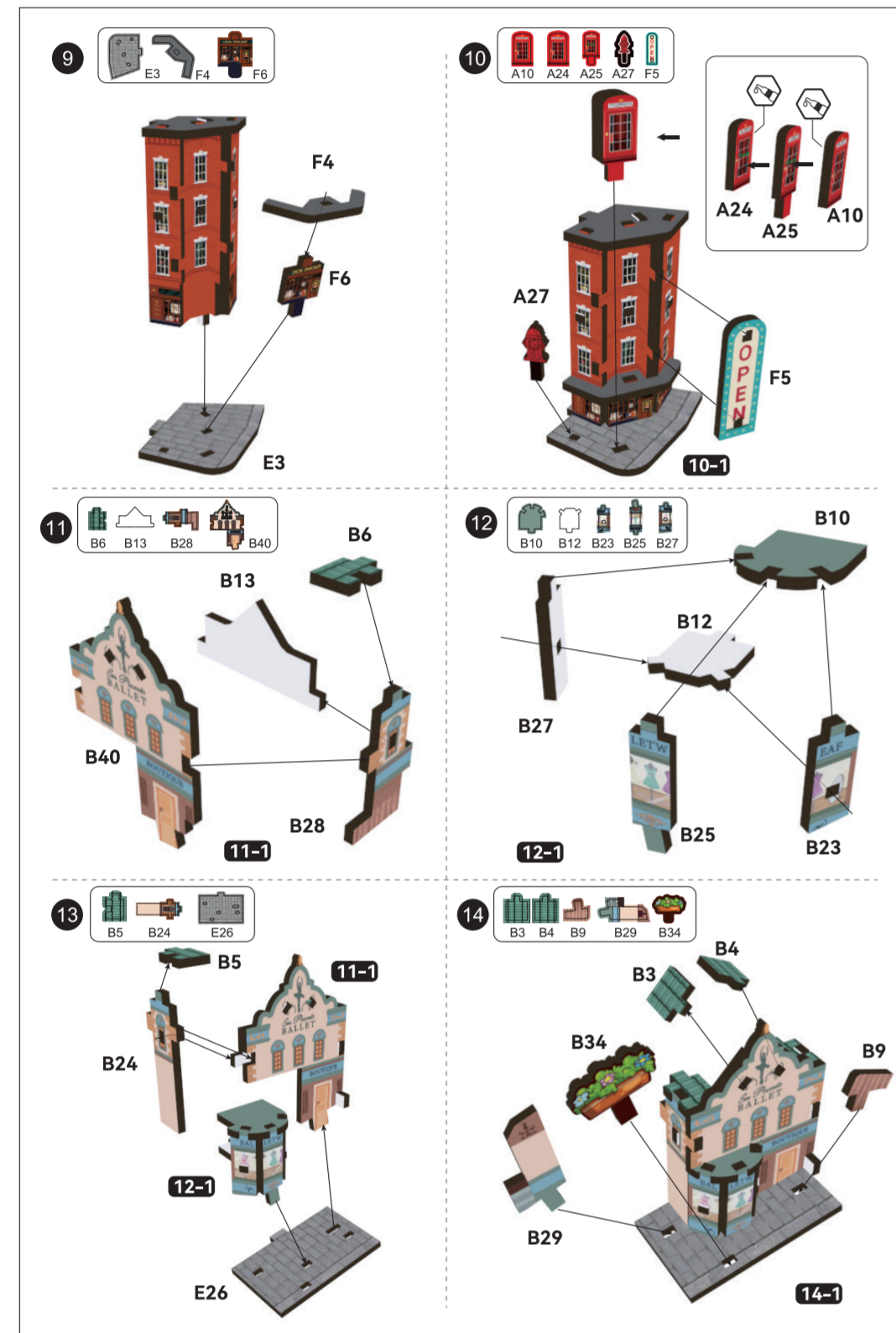
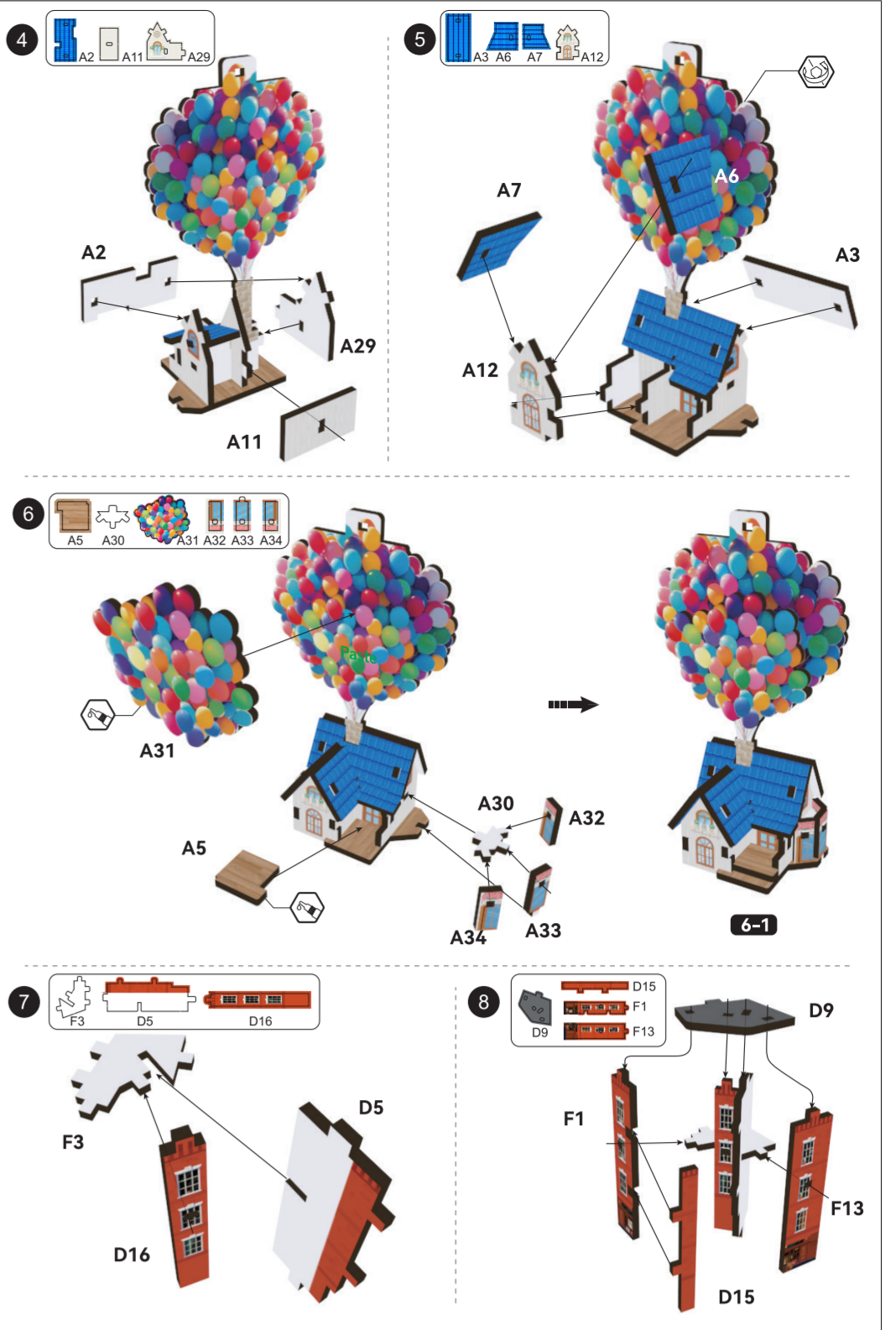

Note: When the battery exhausted, remove the back part to replace the battery.

Complete.