

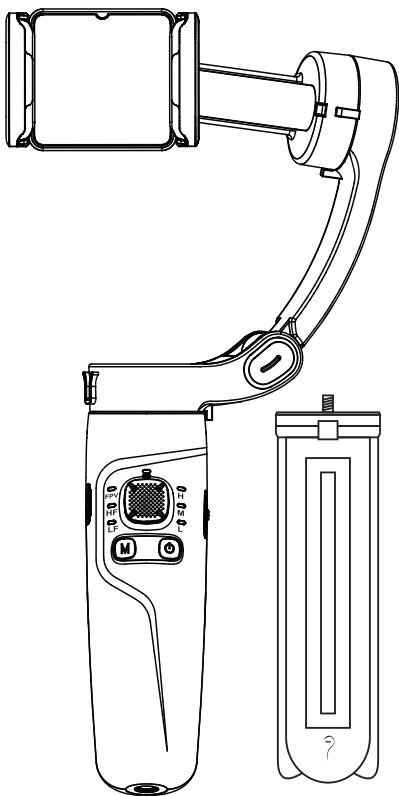

Instruction Manual



3 AXIS HANDHELD GIMBAL

K: 43-635-047 | T: 71-780-382

Model No: EB500738

MADE IN CHINA

please read before use, and retain this manual for future use.

Safety Instruction

- This product contains no user serviceable parts and do not attempt to repair the product yourself. Leave any servicing or repairs to qualified personnel only.
- Do not block the rotation of the gimbal axes with external force when the gimbal is switched on.
- Do not mechanically strike, roll or throw the product, and do not place heavy objects on the product.
- Do not open the product housing.
- Do not insert any foreign objects into the inside of the housing.
- Only use original parts and accessories and use the included charging cable to charge the product.
- Never use accessories which are not recommended by the manufacturer. They could pose a safety risk to the user and might damage the product.
- Do not leave the product near heat sources such as furnaces or heaters, or inside vehicles on hot days.
- The maximum temperature the product can withstand is 40°C.
- The 3 AXIS HANDHELD GIMBAL is a non-waterproof product. Do not immerse the appliance in water or allow the product come into contact with any kind of liquid. Contact with liquid inside the product may cause corrosion reaction, which will cause spontaneous combustion of the battery, or even cause explosion.
- Protect the product from extreme heat and cold, dust, direct sunlight, humidity and drops or jets of water during use.
- Always put the appliance on a level, stable, clean, dry surface.
- Do not store the product fully discharged for an extended period, to prevent damage caused by over-discharge.
- Do not handle damaged or leaking batteries. Keep the battery out of the reach of children. Keep the battery dry.
- Dispose of the item at a suitable waste station, as the battery cannot be added to normal waste.



Battery Warnings

- This product contains batteries that are non-replaceable.
- Before disposal, the battery must be removed from the product. Contact qualified professional.
- Do not leave the battery charging for a prolonged period of time when the product is not in use.
- Do not charge the battery overnight. If the product appears to be bulging or shows other undesirable phenomena (e.g. excess noise), stop using the product immediately.
- Do not cover the product while charging the battery. Charge the product in a well-ventilated environment.
- When in long term storage, charge the battery to its 70 % capacity once every 3 months to avoid shortening its life.
- Batteries produce heat when charging and discharging. If the product becomes too hot to touch, switch the product off and unplug immediately.
- Charge the product only with a compatible power source from reputable manufacturer e.g. power adapter or power bank. The maximum rating should not exceed 5V  2A.
- If the battery leaks, avoid contact with skin and eyes. Rinse affected areas immediately with plenty of clean water, then consult a doctor.
- Avoid placing the product in water as it may cause chemical breakdown of the battery and ignite a fire or even lead to an explosion.

Intended Use

- 1. The product is intended for stabilizing and mounting smartphones to take photos and videos.
- 2. Tripod legs can be attached to the product to provide a stable platform for capturing hands-free shots, time-lapse videos or stable footage.
- 3. The product can be held by the handle to capture dynamic shots and smooth footage while on the move.
- 4. The product can support horizontal and vertical shooting of the mobile phone, and can control the direction button to manually adjust the shooting angle of the mobile phone, to meet the requirements of shooting and video production.
- 5. The product is intended for private use only.
- 6. The product is intended to be used in indoor and outdoor areas, however it is not water-proof. Keep away from rain.

Specifications

Model number	K: 43-635-047 T: 71-780-382
Input	5V  1A, USB-C
Voltage/Battery type	3.7V  2600mAh Li-ion
Twisting angle	-30°~+30°
Pitching angle	-100°~+220°
Heading angle	-160°~+160°
Battery capacity	2600mAh
Thread hole	6mm (1/4")
Charging time	2 hours 50 mins
Operating time	5-8 hours
Bluetooth® version	5.3
Compatible	< 7 inch phone
Optimal load-bearing weight	280g
Product weight	335g
Working temperature	0-40°C
Packaging list	Gimbal*1 + Portable Tripod*1 + Instruction Manual*1 + 30cm 2A Charging Cable*1 + Pouch*1

Before First Use



DANGER

Risk of suffocation!

Keep any packaging materials away from children and pets – these materials are a potential source of danger, e.g. suffocation.

1. Remove all the packing materials.
2. Remove and review all components before use.
3. Check the product for transport damages.
4. It is recommended to fully charge the product before first use.

Cleaning and Maintenance

NOTICE

1. Switch the product off before cleaning.
2. During cleaning do not immerse the electrical parts of the product in water or other liquids. Never hold the product under running water.

Cleaning

1. To clean the product, wipe with a soft, lint-free cloth.
2. Never use corrosive detergents, wire brushes, abrasive scourers, metal or sharp utensils to clean the product.

Storage

Store the product in its original packaging in a dry area. Keep away from children and pets. The maximum storage temperature for the product is 40°C.

Preparation

iOS: Search for "**Gimbal Play**" in the App Store

Android: Search for "**Gimbal Play**" in the Google Apps



Scan code to download "**Gimbal Play**" app

Bluetooth Connection



The Bluetooth function is used to connect the gimbal and the mobile device.

1. On your mobile phone, Go to Setting > Bluetooth > click "Anko43635047" to Connect.
2. Once you enter the Gimbal Play app, a connection prompt will appear.
3. Click "Connect" and then the gimbal can control the mobile phone to use the camera focus function and the shooting start function of the Gimbal Play app.

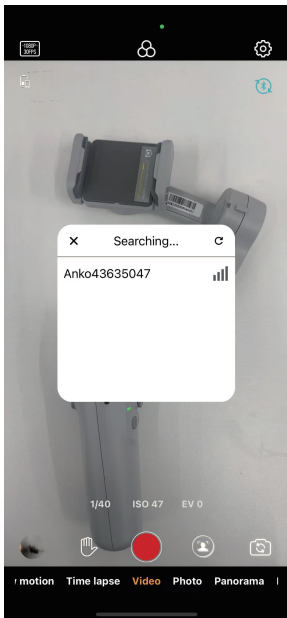
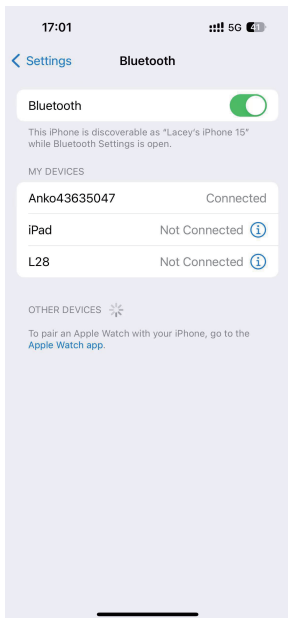

Product Instruction

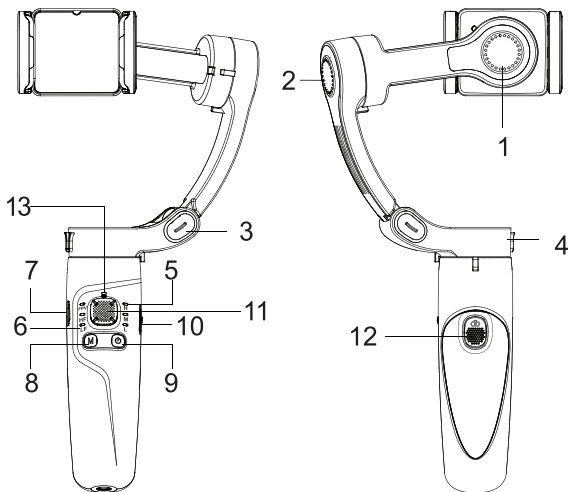

1. P-AXIS
2. R-AXIS
3. SHAFT OF FOLDING
4. Y-AXIS
5. CHARGE/INDICATOR LIGHT
6. STATUS LIGHT
7. USB-C CHARGING PORT
8. MODE
9. POWER
10. FOCUS
11. ROCKER
12. TRIGGER
13. BLUETOOTH & LOW POWER INDICATOR
14. TRIPOD

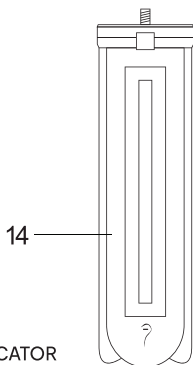

Charging

Use the standard USB-C charging cable to connect the USB charger (not included) to charge the gimbal. When the three indicator lights are green, it means that the charging is complete.

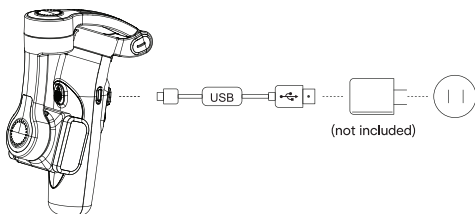

Installing a Mobile Phone

Unfold the cradle head and release the locking state of pitchshaft, heading shaft and phone clip.

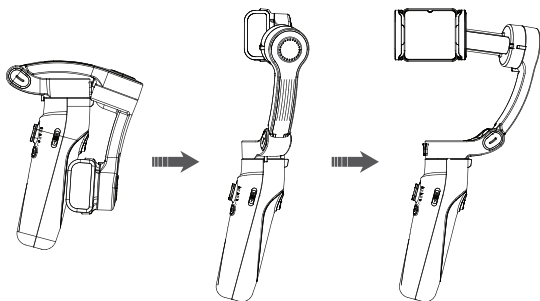

Folding

Fold the head and release the locking state of pitch shaft, heading shaft and phone clip.

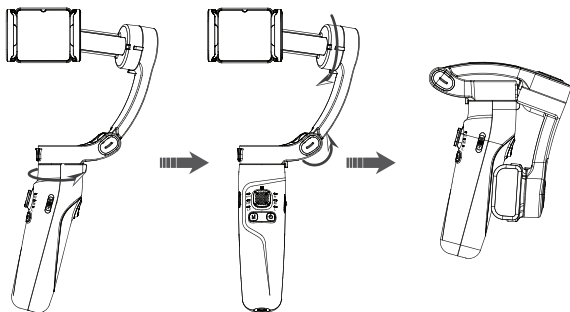

Adjustment balance

1. When the phone is in the horizontal position, adjust the position of the phone left and right until the phone can touch the ground when it is stationary. Close to horizontal.
2. When the phone is in vertical photography state, move the phone clip position left and right until the phone is close to the ground when it is stationary.



Function of the button



Power

- ① Hold down for 3 seconds to turn on and 3 seconds to turn off
- ② Click to switch the screen
- ③ Double click back when the gimbal is not in the initial zero state after turn on



Bluetooth indicator light

- ① Green blinking-Bluetooth connection is down
- ② Steady green-Bluetooth is connected
- ③ Blinking red: The device is low and needs to be charged



Mode

- ① By default, all three mode indicators are on in full Follow mode
- ② Press M to enter full lock mode LF is on
- ③ Double-click M key to enter the semi-follow, (Y-axis follow) HF light will be on
- ④ Hit M three times to enter FPV mode, person first view, FPV light on, Paxis, Raxis, Yaxis three motor linkage at the same time, follow the direction of the mobile phone lens movement. Push the joystick up and down in FPV mode to achieve Inceptionmode (rotation mode)
- ⑤ Four click M keys to enter full follow mode Three mode lights are all on (Y axis and R axis follow at the same time)



Capacity indicator light

- ① Full charge: L-M-H, three green lights are steady on
- ② Steady power: L-M, two green lights are steady on
- ③ Low power: L, a green light is steady on
- ④ Low power alarm -The Bluetooth light is blinking red
- ⑤ Green light: The indicator light is always on when Bluetooth is connected, and it flashes when Bluetooth is disconnected.



Focus

Push upward in the direction of W to enlarge the focal length in the APP, push downward in the direction of T to reduce the focal length in the APP



Trigger

- ① Click the "Photo" button to take a photo/video for the mobile phone
- ② Double click the "Photo" button to switch the front and rear lenses of the phone
- ③ Press the "Photo" button three times to switch photo and video
- ④ Long press the "Photo" button to start recording directly



Rocker

Adjust the four directions of the head



All green lights flashing

The device enters the high current protection state (Please check whether the upper and lower distance of the mobile phone clip is the same or whether the mobile phone is installed in the middle of the mobile phone clip)

Trouble Shooting

Problem	Solution
Product does not switch on.	Product is out of battery. Charge the product.
Product switches off automatically.	Low battery. Charge the product.
Gimbal does not work properly as stabilizer.	<ul style="list-style-type: none">• Ensure that the smartphone mounted on the phone clamp is properly balanced.• Adjust the position of the smartphone when needed.• Ensure that the gimbal's arm, joint, and motor have unobstructed range of motion.
The product's battery life seems shorter than expected.	<ul style="list-style-type: none">• The product's battery may have drained due to charging a device with a bigger battery capacity than itself (2600mAh).• Check that the product is fully charged before use. If the problem persists, the battery might be faulty. Contact a professional repair center.
Cannot find production Bluetooth® device list.	Restart the product and re-establish the connection.
"Auto Follow" Function cannot turn off	<p>Note on Turn off/Turn on the "Auto Follow"</p> <p>After turning off "Auto Follow" in the app's [Settings], the function may stay temporarily on (per current program design).</p> <p>How to fully turn off</p> <p>To ensure it's completely off, use one of these methods:</p> <ol style="list-style-type: none">1. Restart the app – the function will be off when you re-enter.2. Tap the "Auto Follow" icon directly – it will turn off instantly.
"Multilens Shooting" Function cannot Exit & Mode Switch	After entering the multi-lens shooting mode, click the return button on the top right to be able to use other shooting modes.

12 Month Warranty:

Thank you for your purchase.

Your new product is warranted to be free from defects in materials and workmanship for the period stated above, from the date of purchase, provided that the product is used in accordance with accompanying recommendations or instructions where provided. This warranty is in addition to your rights under the Australian Consumer Law. For New Zealand customers, this warranty is in addition to statutory rights observed under New Zealand legislation.

We will provide you with your choice of a refund, repair (where possible) or exchange (availability dependent) for this product if it becomes defective within the warranty period. The business will bear the reasonable expense of claiming the warranty. This warranty will no longer apply where the defect is a result of alteration, accident, misuse, abuse or neglect.

Please retain your receipt as proof of purchase and contact our Customer Service Centre as listed below, for the entity you purchased this product from, for any difficulties with your product. Warranty claims and claims for expense incurred in returning this product can be addressed to the respective Customer Service Centre.

Our goods come with guarantees that cannot be excluded under the Australian Consumer Law. You are entitled to a replacement or refund for a major failure and compensation for any other reasonably foreseeable loss or damage. You are also entitled to have the goods repaired or replaced if the goods fail to be of acceptable quality and the failure does not amount to a major failure.

MADE IN CHINA

CUSTOMER SERVICE:

KMART AU: 1800 124 125

KMART NZ: 0800 945 995

TARGET AU: 1300 753 567



The Bluetooth® word mark and logos are registered trademarks owned by Bluetooth® SIG, Inc., and any use of such marks by KMART AUSTRALIA is under licence.