

Pitcher Water Filtration System

Use and Safety Instructions



- FOR HOUSEHOLD USE ONLY -

IMPORTANT SAFEGUARDS

Definitions

Whenever used, the following terms identify safety and property damage messages and designate a level of hazard seriousness.

 - This is the safety alert symbol. It alerts you to potential personal injury hazards. Obey all safety messages that follow this symbol to avoid possible injury or death.

DANGER - Indicates an imminently hazardous situation, which, if not avoided, will result in death or serious injury. Usage of this signal word is limited to the most extreme situations.

WARNING - Indicates a potentially hazardous situation, which, if not avoided, could result in death or serious injury.

CAUTION - Indicates a potentially hazardous situation, which, if not avoided, may result in minor/moderate injury.

NOTICE - Addresses practices not related to personal injury, such as product and/or property damage.



READ ALL INSTRUCTIONS BEFORE USE.



WARNING-- To reduce the risk of serious personal injury:

- This product is intended to filter tap water only. Do not use water of unknown quality or that has been microbiologically impaired with this product.
- If official instructions have been issued to boil tap water before consuming it, the water placed into this product must also be boiled, either before or after passing through the Filter.
- If persons with weak immune systems, such as babies or the elderly, have been advised to boil tap water before consuming it, the water placed into this product for consumption by these persons must also be boiled, prior to or after filtration.

NOTICE-- To reduce the risk of product damage:

- Filter only cold or room temperature water with this product. Do not pass warm or hot water through it.
- Do not apply concentrated cleaning agents such as heavy oxidants, bleach, chlorinated solvents, or the like to any part of this product. Do not use abrasive pads on the product.
- Do not boil any part of this product.
- Do not place any part of this product in a dishwasher for cleaning.
- If the Pitcher or Reservoir is broken or cracked, replace the whole product. If the Filter is damaged, replace only the Filter.

SAVE THESE INSTRUCTIONS FOR FUTURE REFERENCE

The water filtration system reduces impurities in tap water, while improving the taste, smell, and clarity. It also provides a more economical and environmentally friendly alternative to buying bottled water.

Save money and enjoy the fresh, crisp taste of filtered water.

Parts

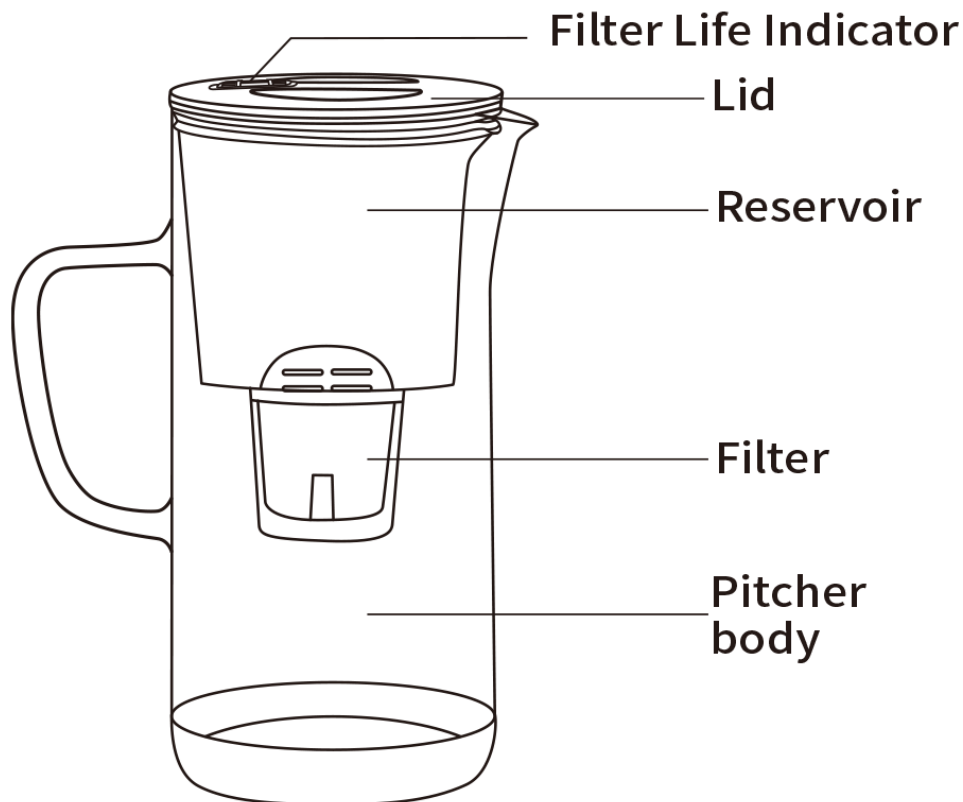

To Set Up and Use

1. Remove the Lid by pulling up on both sides.
2. Remove the Filter (in packaging) from the Reservoir and set it aside.
3. Hand wash the Pitcher, Reservoir, and Lid with a soft cloth or sponge and a mild liquid soap. Rinse and let dry.
NOTICE: The scrubber side of a sponge will slightly scratch the surface of the Pitcher, so use the soft side.

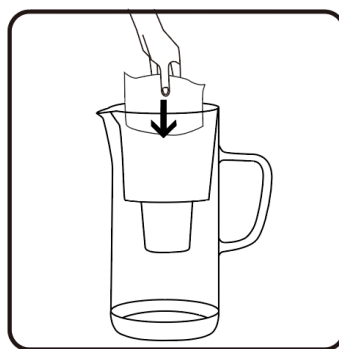
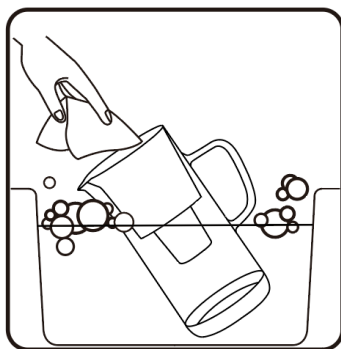

4. Replace the Reservoir into the Pitcher. The tallest part of the Reservoir must face the front of the Pitcher.

5. Prepare and Install the Filter:

****Use cold or room temperature water.**

- a. Wash your hands and then remove the Filter from its package. Soak it upright in water for 10 minutes.
- b. Rinse the Filter under running water for 10 seconds.
- c. Press it firmly down into the tube of the Reservoir to ensure a tight seal.

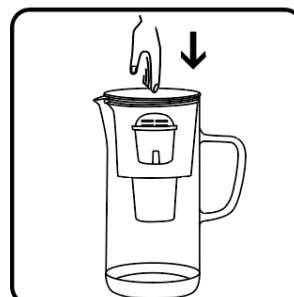
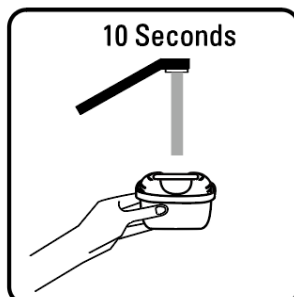

6. Attach the Lid.



7. Fill the Pitcher:

****Always use cold or room temperature water when filling the Pitcher.**

Press down on the tab next to the Filter Life Indicator to open the hole in the Lid. Fill the Reservoir with water and allow all the water to filter through. Discard the water and repeat. The third pitcher of water is ready for drinking.

- Always allow all the water in the Reservoir to pass through the Filter before pouring the water.

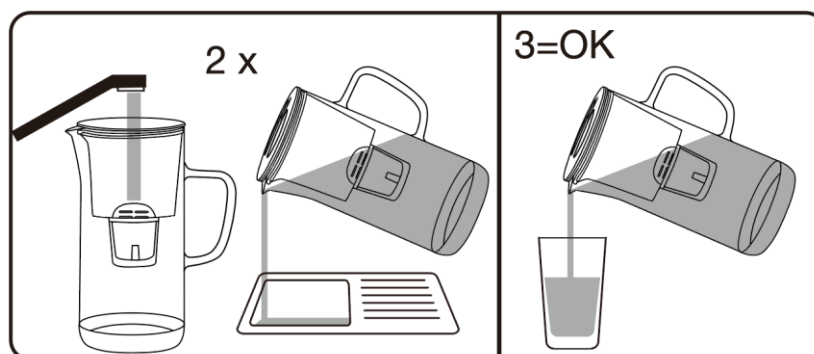

8. Set the Filter Life Indicator:

Use the dials to set the Filter Life Indicator to a date 60days in the future. If the day you wish to select is not available, select the next available day.

Filter Life Indicator

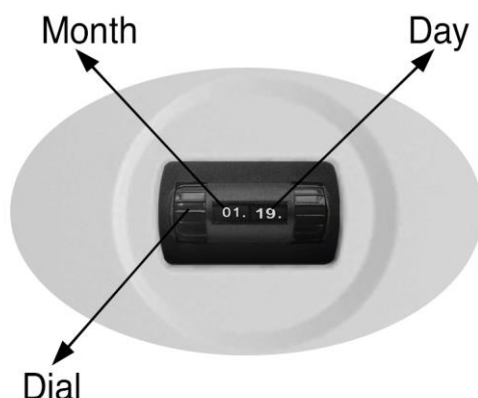

For best results:

- Keep the Filter moist by maintaining the water level in the Pitcher above the bottom of the Filter.
- Store the Pitcher in the refrigerator or in a cool location. If the water has been sitting for several days, discard it and refill the Pitcher with fresh water.

Replacing the Filter

Replace the Filter every 60days or 160L water,pull it out of the pitcher by its loop. Repeat steps 5-8 to install a new Filter.

Care and Maintenance

NOTICE:

- Do not use harsh or abrasive cleaners or pads on the product.
- Do not place any part of the product in a dishwasher for cleaning.

To Clean:

Clean the Pitcher, Reservoir and Lid as described in step 3. A small brush may be used to remove any deposits, which mostly occur near the edges of the parts.