

anko

**Juicer
PC725
User Manual**



PLEASE READ AND SAVE THESE
INSTRUCTIONS FOR FUTURE REFERENCE

IMPORTANT SAFEGUARDS

When using any electrical product, always follow these basic safety precautions:



READ ALL INSTRUCTIONS BEFORE USE.

1. This appliance is for household and indoor use only.
2. This appliance is not intended for use by persons (including children) with reduced physical, sensory or mental capabilities, or lack of experience and knowledge, unless they have been given supervision or instruction concerning use of the appliance by a person responsible for their safety.
3. Children should be supervised to ensure that they do not play with the appliance.
4. This appliance should not be used and cleaned by children. Children must be kept away from the appliance.
5. Always turn OFF the appliance and disconnect with the mains power when not in use, before cleaning or storing.
6. Switch off the appliance and disconnect from mains power, wait until the moving parts come to a stop before remove or approaching parts.
7. Do not move the appliance by pulling the cord. Make sure the cord cannot get caught in any way. Do not wind the cord around the appliance and do not bend it.
8. Do not operate any appliance with a damaged cord or plug, or after the appliance malfunctions, has been dropped or damaged in any manner.
9. For electrical safety, any repairs to the product should be carried out by a qualified electrical person only or the product must be disposed of.
10. CAUTION! In order to avoid a hazard due to inadvertent resetting of the thermal cut-out, this appliance must not be supplied through an external switching appliance, such as a timer, or connected to a circuit that is regularly switched on and off by the utility.
11. Check the voltage indicated on the appliance corresponds to the local mains voltage before you connect the appliance.
12. This appliance is intended to extract the juice from soft fruits and vegetables.
13. This appliance is not suitable for mincing hard foods (e.g. nuts, fruit stone) or hard fruit and vegetable cores. Stone fruits must be pitted before being juiced.
14. CAUTION! Handle the juice extractor with care, extremely sharp bottom!
15. Keep your head, hands, hair, jewellery or clothing away from rotating parts of the appliance.
16. Do not reach into the feed tube to push down food. Always use the pusher supplied.
17. Do not forcefully push fruits and vegetables into the appliance.
18. Only turn on the appliance when it has been completely and properly assembled and the locking lever is properly engaged.
19. DO NOT operate the appliance empty.
20. Do not put hot ingredients above 40°C into the appliance.
21. Do not leave the appliance unattended during operation.

22. Remove the power cord from the electrical outlet when not in use, before assembling or disassembling parts and before cleaning.
23. Keep hands, hair, clothing, as well as utensils out of the feed tube while processing to reduce the risk of severe injury to persons or damage to the appliance.
24. Avoid contact with moving parts.
25. The appliance is intended to be used in household and similar applications such as:
 - staff kitchen areas in shops, offices and other working environments,
 - farmhouses,
 - by clients in hotels, motels and other residential type environments,
 - bed and breakfast type environments.
26. Do not place any open flames, e.g. burning candles, in the vicinity of the appliance, power cord and plug.
27. Never immerse the motor unit in water or any other liquid, nor rinse it under the tap. Use only a moist cloth to clean the motor unit.
28. Use of accessories not supplied with the product may cause fire, electric shock or personal injury.
29. This appliance must be always used in accordance with the user instructions supplied with the product and must not be used for other purposes.
30. For cleaning, please refer to CLEANING AND STORAGE section.
31. Do not leave the appliance keep running for more than 1 minutes in all speed setting at a time. Allow the appliance to cool down for 10 minutes before use it again.
32. Do not use the appliance if the rotating sieve or the protecting cover is damaged or has visible cracks.
33. Switch off the appliance and disconnect from supply before changing accessories or approaching parts that move in use
34. If the supply cord is damaged, it must be replaced by the manufacturer, it service agent or similarly qualified persons in order to avoid a hazard.

IMPORTANT!

The appliance incorporated with a self-resetting thermal motor protection circuit to protect the motor from overheating. If the motor shuts OFF while in use, unplug the unit from main power outlet. Allow the unit to cool down for at least 6 minutes. After then, plug the unit back into mains power for normal operation.

**SAVE THESE INSTRUCTIONS
FOR FUTURE REFERENCE**

KNOW YOUR JUICER

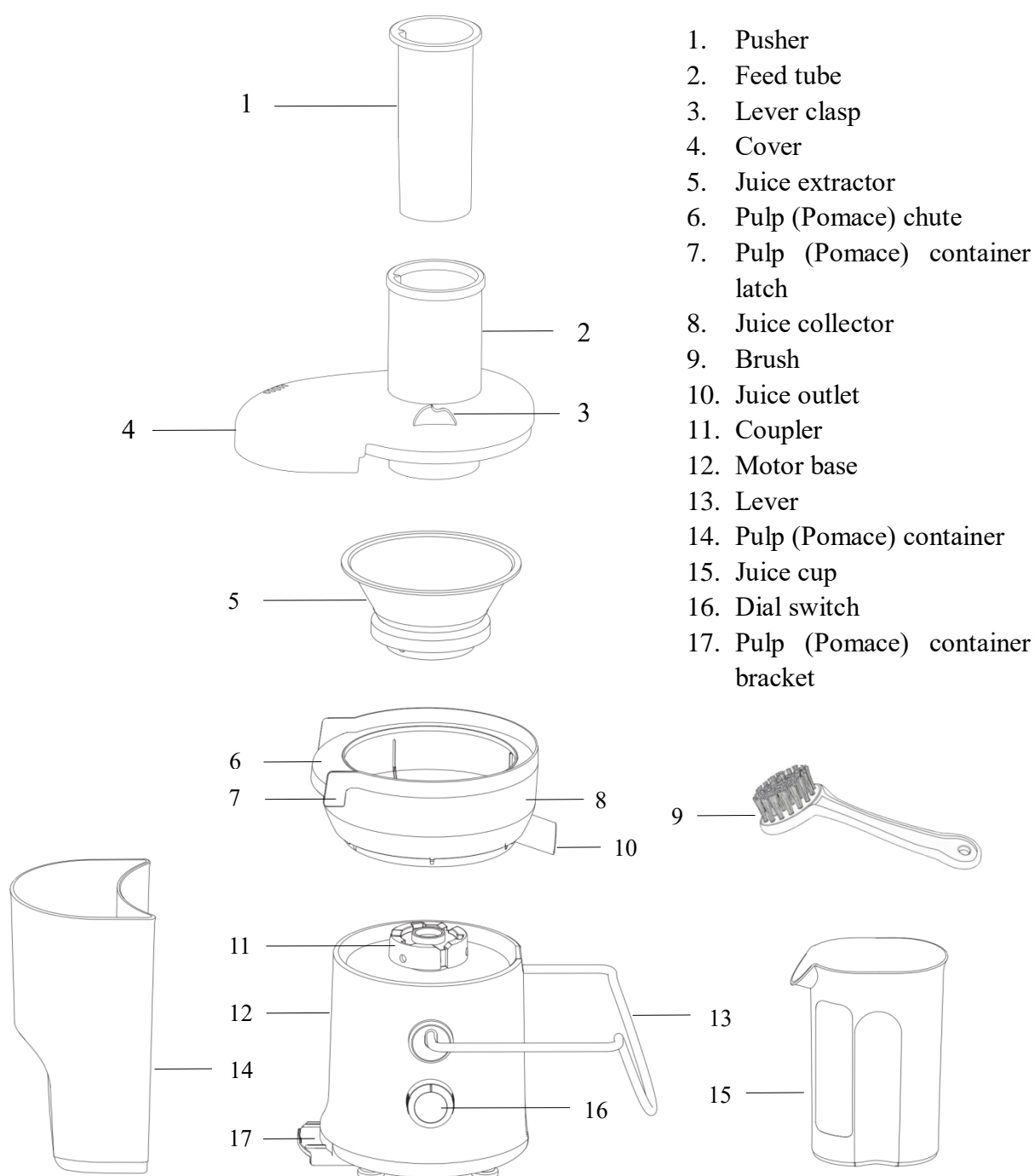

IMPORTANT!

Please make sure that your appliance is received with the right components shown above. Check everything carefully before use. If any parts are missing or damaged, return the product to respective customer service centre.

BEFORE FIRST USE

Notes: When using the appliance for the first time, carefully remove all internal and external packaging and dispose them responsibly.

1. Before using the product for the first time, wash all the parts except the motor base in warm, soapy water, then rinse and dry thoroughly.
2. Clean the motor base with a damp cloth or sponge. Wipe dry with a soft dry cloth.

WARNING! Do not immerse the motor base in water or other liquids. Do not use abrasive cleaners on any part of the product. Do not place any parts into a dishwasher or extremely hot water.

CAUTION! Handle the juice extractor with care, extremely sharp bottom!

Place the motor base on a flat, stable surface.

USE YOUR JUICER

ASSEMBLY

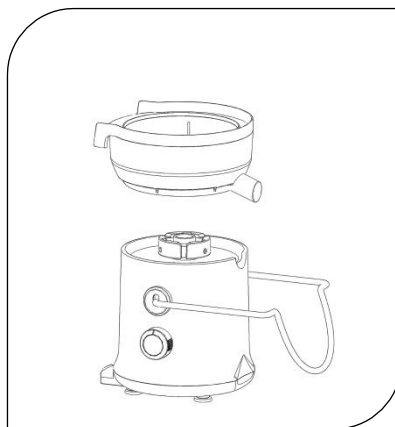

1. Align the outlet with the notch and push down the juice collector.



2. Assemble the juice extractor firmly on the motor base by the coupler.

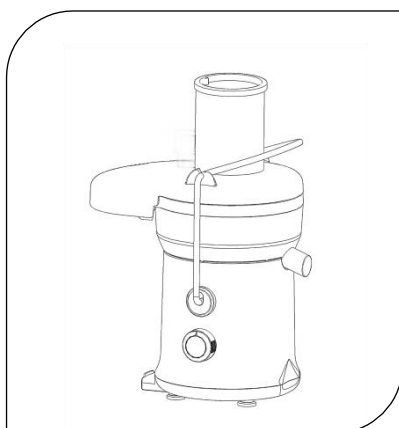

3. Put the cover on the juice collector in a proper way so that it cannot be rotated. Fasten both sides of the lever by the clasps until you hear a click sound.

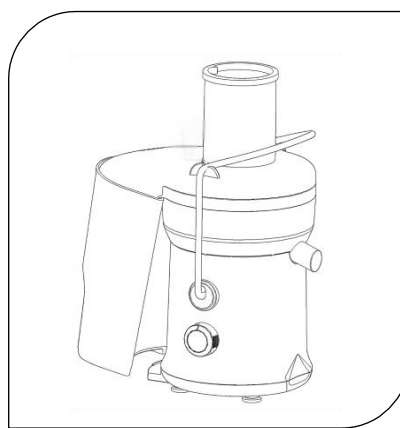

4. Attach the Pulp (pomace) container to the latch and slide the bottom onto the bracket.

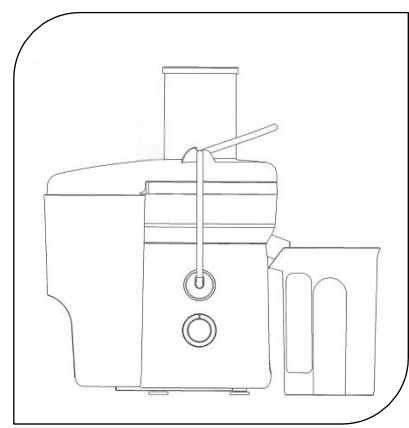

5. Put the juice cup beneath the outlet. Now the appliance is well assembled and ready for use.

OPERATION

1. Place the appliance on a flat, stable surface.
2. Ensure the dial switch is in the “0” (OFF) position.
3. Connect the appliance to the mains power supply.
4. Turn the switch to the desired speed: position “1” for low speed or position “2” for high speed.
5. Add fruits and/or vegetables into the feed tube and use the pusher to gently press the food down.

IMPORTANT!

- **Cut fruit and vegetables into pieces smaller than the feed tube opening.**
- **Remove the stones from hard or large stone fruits before juicing to prevent damage to the appliance.**
- **If the appliance stops operating during use, switch it off and unplug it from the mains power outlet. Remove any obstruction from the juicer and allow it to cool for at least 6 minutes before reconnecting and resuming operation.**

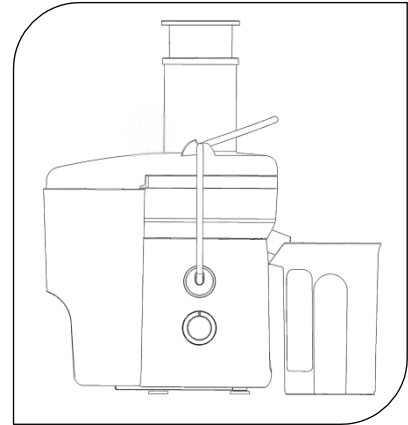

Tips:

- Cutting fruit and vegetables into smaller pieces can improve juice yield.
 - When making mixed juice from more than two types of fruit or vegetables, juice the items with higher fibre content first, followed by those with less fibre.
 - Clean the pulp container promptly to maintain good juice yield.
6. Switch off the appliance once no more juice is flowing.
 7. Disconnect the appliance from mains power after use.

CLEANING AND STORAGE

Clean the appliance after each use.

1. Make sure the appliance is turned off and remove the power plug from the power outlet socket. Allow the appliance to cool down completely before disassembly and hand cleaning.
2. Slide out the bottom of the pomace container to take it off, release the lever and take off the cover. Take off the juice extractor and collector. Now the appliance is completely disassembled for cleaning.

CAUTION! Handle the juice extractor with care, extremely sharp bottom!

3. Wash all the parts except the motor base in warm, soapy water, use the brush if necessary. Then rinse and dry all parts thoroughly.
4. Clean the motor base with a damp cloth or sponge. Wipe dry with a soft dry cloth.

WARNING! Do not immerse the motor base in water or other liquids. Do not use abrasive cleaners on any part of the product. Do not place any parts into extremely hot water or dishwasher.

- 5. Make sure all parts are clean and dried thoroughly before storing.
- 6. Assemble the appliance and store it upright in a clean and dry location. Do not place anything on top.

RECIPE

Ingredient	Quantity	Operation
Soaked carrots	0.8kg	Extract the carrots within 1 minute, allow the appliance to rest at least 5 minutes before using it again.

TECHNICAL SPECIFICATION

Voltage: 220-240V~ 50-60Hz
Power: 300W

12 Month Warranty

Thank you for your purchase.

Your new product is warrantied to be free from defects in materials and workmanship for the period stated above, from the date of purchase, provided that the product is used in accordance with accompanying recommendations or instructions where provided. This warranty is in addition to your rights under the Australian Consumer Law.

For New Zealand customers, this warranty is in addition to statutory rights observed under New Zealand legislation.

We will provide you with your choice of a refund, repair (where possible) or exchange (availability dependent) for this product if it becomes defective within the warranty period. The business will bear the reasonable expense of claiming the warranty.

This warranty will no longer apply where the defect is a result of alteration, accident, misuse, abuse or neglect.

Please retain your receipt as proof of purchase and contact our Customer Service Centre as listed below, for the entity you purchased this product from, for any difficulties with your product.

Warranty claims and claims for expense incurred in returning this product can be addressed to the respective Customer Service Centre.

Our goods come with guarantees that cannot be excluded under the Australian Consumer Law. You are entitled to a replacement or refund for a major failure and compensation for any other reasonably foreseeable loss or damage. You are also entitled to have the goods repaired or replaced if the goods fail to be of acceptable quality and the failure does not amount to a major failure.

Contact for Kmart purchases	Contact for Target purchases
Kmart Australia Ltd. C/- Customer Service Centre 690 Springvale Road, Mulgrave Vic 3170 Customer Service: 1800 124 125 (Australia) or 0800 945 995 (New Zealand) or via Customer Help at kmart.com.au	Target Australia Pty Ltd C/- Customer Service Centre 2 Kendall Street, Williams Landing, Vic, 3027 Customer Service: 1300 753 567 or via Customer Help at target.com.au/help/contact-us