

JELLYFISH LAMP SLR-24243

IMPORTANT SAFETY INSTRUCTIONS:

The following safety precautions should always be followed, to reduce the risk of electric shock, personal injury or fire. It is important to read all of these instructions carefully before using the product, and to save them for future reference or new users.

1. This product must only be used as intended in accordance with the enclosed operating instructions.
2. Plug off USB plug when not in use, before cleaning or changing accessories.
3. Keep the appliance and cable away from sources of heat, sharp objects or anything that may cause damage.
4. Keep product out of reach of small children and pets. This item is NOT a toy.
5. Keep the cable, its connections and any ports intended to connect free from dust, lint etc.
6. Never force a connection into a port, check for obstructions in the cable and port.
7. Do not operate the cable in water or any other liquid.
8. Do not operate the cable with wet hands.
9. Do not operate the cable if it has been exposed to water, moisture or any other liquid, to prevent against electric shock, explosion and/or injury to yourself and damage to the cable.
10. Do not use the cable for anything other than its intended use.
11. Do not store the cable in direct sunlight or in high humidity conditions.
12. Do not short-circuit.
13. Do not stack up with other electrical or electronic cables to avoid overheating.
14. This cable is intended for domestic use only. It should not be used for commercial purposes.
15. This cable is not suitable for charging high drain devices such as laptops or tablets.
16. Use only with the product this cable was supplied with.
17. Do not leave unattended whilst connected to a device.
18. The lamp should only be used on a flat, stable, heat resistant surface.
19. Do not store the charging cable in a kinked or twisted manner. Regularly check its condition for damage before use. If damaged DO NOT USE!
20. Do not pull, twist or strain the cable.
21. The cable should be unobstructed when in use. Do not place items on the cable.
22. When connecting and disconnecting from devices, remove gently using the solid plastic head at either end of the cable. Do not pull on the cable or flex as this can cause damage.
23. Do not use the cable if it or if any connected devices are damaged. Discontinue use immediately.
24. Contains non-replaceable LED bulbs.
25. To clean product, use a dry cloth. DO NOT submerge in water.
26. Operate carefully to not cause any damage by dropping or physical shocking it.
27. This product is intended for personal indoor household use only – DO NOT use outdoors.

Warning

1. Do not eat the granules or other parts.
2. Keep out of direct sunlight.
3. Please keep the product on a flat surface to avoid spilling.
4. Change the water once a week and clean the container.
5. This product produces flashes that may trigger epilepsy in sensitised individuals.
As with all electric products, precautions should be observed during handling and use to prevent electric shock.

Product specification

- USB input: 5V DC 1000mA 5W
- This lamp contains non-replaceable LED bulbs

Instructions for installation:

1. Open the top lip. ①
2. Fill tap water into the container. ②
3. Put the jellyfish into container. ③
4. Add 4 drops of dish soap (not included). ④
5. Stir the water with the provided stick to dissolve the dish soap in the water and remove air bubbles from the container and jellyfish. ⑤
6. After closing the lid, connect the provided USB cable to the power supply, and then turn on the switch to use.
7. If you see air bubble trapped, shake them off using the stick included.

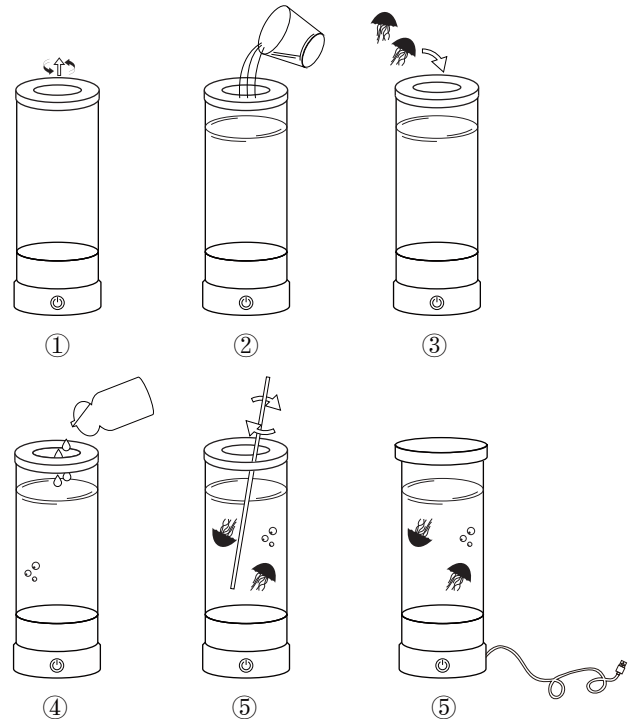

Trouble shooting

Problem	Possible Cause	Solution
The jellyfish is not swimming smoothly.	Dish soap is not enough.	Add more 1-2 drops dish soap to make the jellyfish swim more smoothly.