

anko

CITRUS JUICER

Instruction Manual

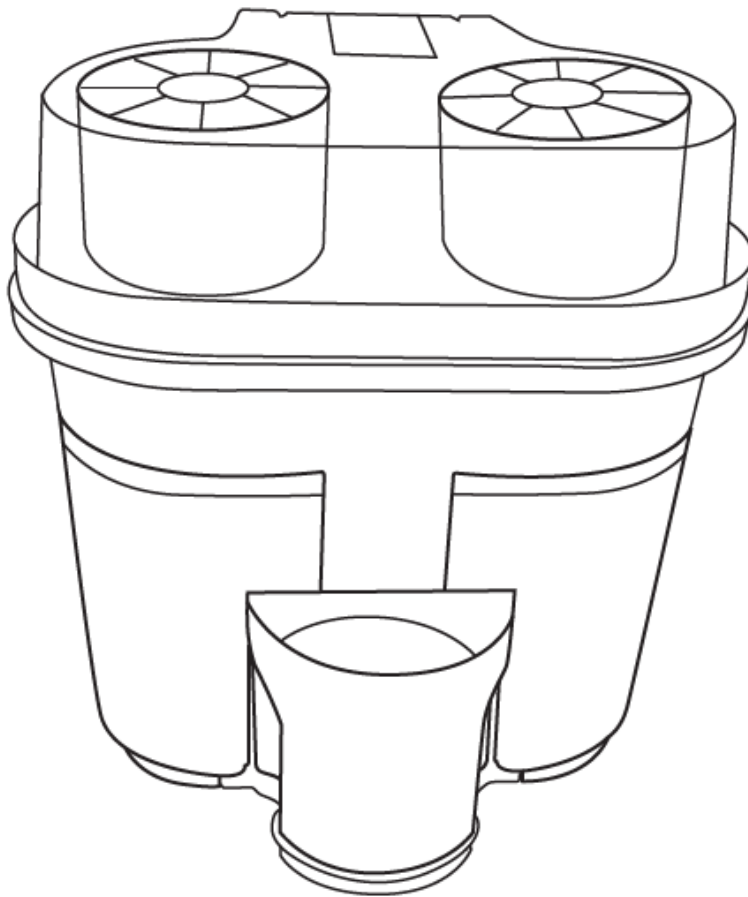

Model No.: ACJ802

Rev.:01

To ensure the proper operation of this product, please read this instruction manual carefully before using the product and keep them for further reference.

Important Safeguards



Read all instructions thoroughly before first use, even if you are familiar with this type of product. The safety precautions mentioned in this manual reduce the risk of burns, fire, electric shock, and injury when correctly followed. Keep this manual in a safe place for future reference, along with the purchase receipt and packaging. If applicable, pass these instructions onto the next owner of this product.

Explanation of Symbols



This signal symbol/word designates a hazard with moderate risk, which may result in death or severe injury if not avoided.



This signal symbol/word designates a hazard with low risk, which may result in minor or moderate injury if not avoided.



This signal word warns of possible damage to property.



This symbol provides you with useful additional information about assembly or operation.



This symbol indicates that the product complies with the protection class II.

When using electrical appliances, to reduce the risk of personal injury or damage to property, basic safety precautions must be observed, including the following:

- This product is designed exclusively for juicing prepared, suitable food.
- This product is exclusively intended for domestic use and not for the commercial sector.
- Only use the product as described in this manual. Any other use is improper and may lead to product damage or even personal injury.
- This product is not a toy.
- The manufacturer or retailer assume no liability for damage caused by improper or incorrect use.
- The product is intended to be used in households and similar applications such as:
 - Staff kitchen areas in shops, offices and other working environments.
 - Farmhouses.
 - By clients in hotels, motels and other residential type environments.
 - Bed and breakfast type environments.



Risk of electric shock!

Faulty electric installation or excess mains voltage can cause an electric shock.

- Only connect the power cable if the mains voltage of the socket matches the information shown on the rating plate.
- Only connect the power cable to an easily accessible socket so that you can quickly disconnect it from the mains power in the event of a malfunction.
- Do not use the product if there is visible damage or if the power cable is defective.
- Do not open the product. Leave repairs to a qualified service technician or contact Customer Service. Liability and warranty claims are excluded if you carry out repairs yourself, improperly connect the product to the power supply or operate it incorrectly.
- Do not immerse the product or the power cable in water or other liquids.
- Never touch the power cable with wet/damp hands.
- Never pull the power cable out of the socket by the cord; always grip the plug instead.
- Never use the power cable as a carry handle.
- Do not place any objects on the power cable.
- Keep the product, the mains plug and the mains cable away from open flames and hot surfaces.
- Connect the power cable so that no-one can trip over it.
- Do not bend the power cable and do not pass it over sharp edges.
- For electrical safety, if the power cable of the product is damaged, it must be replaced by qualified electrical person only.
- Only parts that match the original product data may be used for repairs. This product contains electrical and mechanical parts that are essential for protection against sources of danger.
- Only use the product indoors. Never operate it in damp rooms, outdoors or in the rain.

- Never store or use the product where it can fall into a tub or sink. Do not use the product if it has fallen into water.
- Never reach for the product if it has fallen into water. Immediately disconnect the product from the power supply.
- Disconnect the product from the mains in the case of a fault (such as unusual noise or smoke).
- Do not operate the product with an external timer or separate remote control system.
- Do not use the product during a thunderstorm. Switch it off and pull the power cable out of the socket.
- While the product is not in use or is being cleaned, or if a malfunction occurs, always turn the product off and disconnect it from the power supply.
- **IMPORTANT! The maximum operating time is 15 seconds for 2 halves of fruit. Allow the product to rest for 15 seconds before using it again. After 10 cycles of operation, allow the product to cool down to room temperature before using it again. Failing to follow above instructions may cause damage to the product.**



Danger to children and persons with reduced physical, sensory or mental abilities (e.g. partially disabled, elderly people with reduced physical and mental abilities) or lack of experience and knowledge (e.g. older children).

- This product shall not be used by children.
- Children must not clean and/or service the product.
- Keep the product and its cable out of reach of children.
- This product is not intended for use by persons (including children) with reduced physical, sensory or mental capabilities, or lack of experience and knowledge, unless they have been given supervision or instruction concerning use of the product by a person responsible for their safety.
- Children must not play with the product.
- Do not leave the product unattended while in use.
- Do not let children play with the packaging film. They may become tangled when playing and suffocate.
- Make sure that children do not insert objects into the product.



Risk of injury!

Faulty operation due to the improper handling can cause injuries.

- Only start the product when it is fully and properly installed.
- Switch the product off and disconnect the power cable from the power supply before changing accessories or coming close to moving parts.
- Always disconnect the product from the power if it is left unattended and before assembling, disassembling or cleaning.
- Never reach into the product or the accessories with your hands or other objects during operation.
- Do not use the product if it is damaged or has visible cracks.
- Keep body parts, especially fingers, hair, and other objects away from sharp and/or rotating accessory parts.

- Clean surfaces and product parts that come in contact with food at regular intervals as described in the section "Cleaning & Maintenance"

NOTE!

Risk of damage!

Improper handling can damage the product.

- Never operate the product when it is empty.
- Do not apply excessive pressure to the product.
- Do not use the product if it blocked or damaged.
- Do not move the product during operation.
- Do not place any objects on the product or cover it.
- Operate the products on an easily accessible, level, dry and heat resistant and stable work surface. Never place the product on the edge of the work surface.
- Never place the product on or near hot surfaces (stove tops, etc.) and never expose the product to high temperatures (heaters etc.) or to bad weather (rain etc.).
- Never immerse the product in water to clean it.
- Stop using the product if any of its components are cracked or deformed. Only replace the damaged components with matching original spare parts.
- Dismantling the product beyond the degree shown in the illustrations can lead to irreparable damage and void the warranty.

NOTICE!

Modifications of the product by the user/s may cause damage to property or persons and will be deemed as not in accordance with the instruction manual and no liability for damages will be accepted by the manufacturer.

NOTICE!

Non-compliance: We accept no liability for any eventual damages caused by improper use or inappropriate handling, or by any other non-compliance with the instructions in this manual.



- To reduce the risk of electric shock, do not immerse or expose the product, flexible cord or plug to rain, moisture, or any liquid.
- Do not use the product near baths, basins or other vessels containing water or other liquids, or when standing in or on damp or wet surfaces.
- In the event that the appliance is dropped into water, turn off the power at the power outlet and remove the plug immediately.

DO NOT REACH INTO THE WATER TO RETRIEVE IT UNTIL IT HAS BEEN DISCONNECTED FROM THE POWER OUTLET.

- It is important to note that the appliance will have to be inspected by a qualified technician before using it again.

SAVE THESE INSTRUCTIONS

Parts Guide

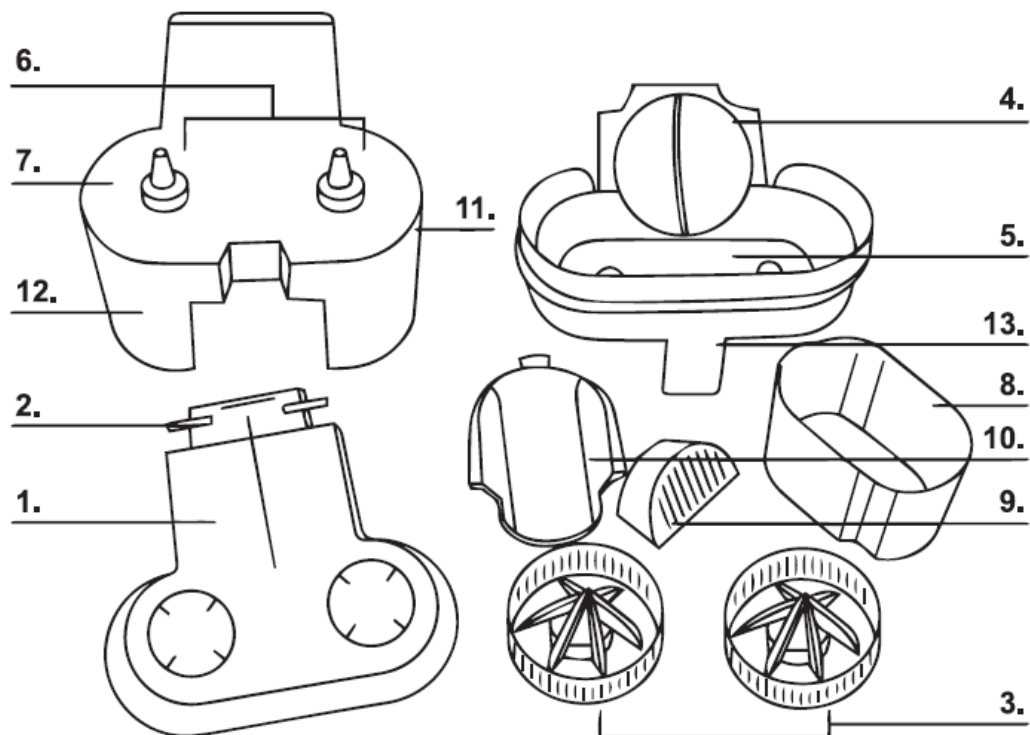

- 1. Lid with cutting blade
(removable and easy to clean)
- 2. Lid locating rods
- 3. Juicing cones with strainer
baskets
- 4. Slicing compartment
- 5. Juicing chamber
- 6. Drive shafts

- 7. Motor base
- 8. Juice container
- 9. Pip and pulp sieve
- 10. Removable juice drip tray
- 11. On/off power switch
- 12. Cord storage
compartment(underneath unit)
- 13. Front disassembly lever

Instructions

GETTING STARTED

NOTICE!

Risk of damage!

If you are not cautious when opening the packaging with a sharp knife or other pointed object, it may damage the product.

Carefully unpack the product and remove any packaging. Check to make sure that all parts are included (see "Parts Guide") and check whether the product or individual parts are damaged. If any parts are missing or damaged return the product back to place of purchase for replacement, do not use the product. Ensure to read all instructions carefully and keep them for future reference.

- Ensure you clean all parts with a soft, damp cloth.
- Thoroughly wipe all parts and let dry.

Assembly Instructions

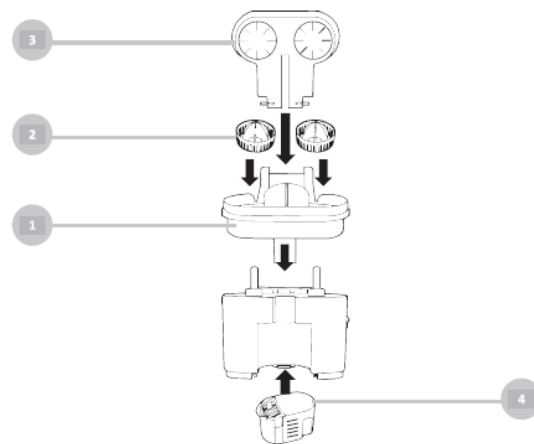

1. When assembling the juicing tank, simply align the three protruding prongs on the rear of the juicing tank with the three holes on the motor base, insert them, and then press down the components to complete the installation.
2. Place the orange juicing cones onto the drive shafts.
3. Snap the two metal shafts on the transparent cover into the upper cover's grooves of the juicing chamber.
4. Insert the juice container along the pre-installed juice drip tray.

How to use your juicer

The product is suitable for cutting and juicing citrus fruits such as oranges, lemons, limes etc.

NOTE: Ensure to connect the product only according to the voltages indicated on the rating plate.

1. Ensure that the product is assembled correctly prior to use.
2. Plug the product into power outlet and switch on the wall outlet.
3. Make sure the juice container is in the correct position, then press the power switch on the side of the motor base to the "I" position.
4. Place your chosen fruit into the slicing compartment with the top of fruit facing the left side of the compartment.

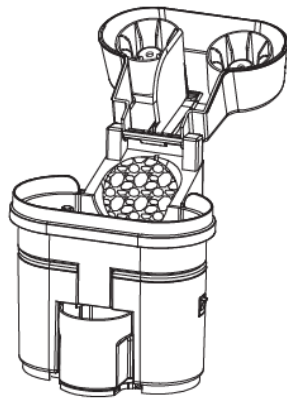

5. Lower the lid of the product to cut through the centre of the fruit. Excess juice will run into the juice container.



6. Place the juicer cones onto the drive shaft

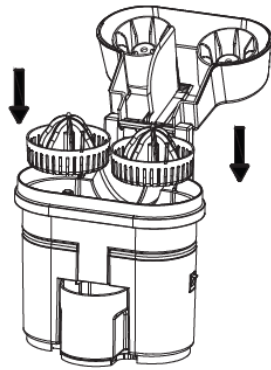

7. Place the halves of the cut fruit onto the cones one at a time. Remember, put pressure on both cones simultaneously to begin operation.

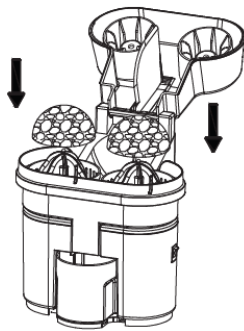

8. Close the lid and, using both hands on either side of the lid, apply firm pressure. This will start the juicing operation. Juice will flow into the container below.

NOTE: Both juicing cones must have fruit loaded for the product to work.

9. When the halves of fruit are fully juiced, discard the peel and repeat steps above until the juice container is full (approximately 500ml). Do not fill above the MAX fill line.
10. Slide out the juice container to serve the juice. The removable sieve will strain the excess pulp and any pips from the juice, if you prefer a higher fibre drink simply remove the sieve. The drip tray will catch any juice remaining in the juicing chamber.

NOTE: It is recommended to rinse the cones and juicing chamber periodically when preparing large quantities of fruit to remove any build-up of pulp.

NOTE: If the product stops operating during use, remove the cones and rinse the juicing chamber to remove excess pips which may lodge underneath the cones and prevent the product from operating.

Cleaning and Maintenance



Risk of electric shock!

Moisture in the product can cause a short circuit and electric shock.

- Disconnect the power plug from the socket before cleaning.
- Do not immerse the product in water or other liquids.
- Make sure that no water or other liquids gets into the housing.
- Dry the product thoroughly before using it again after cleaning.

NOTE!

Risk of damage!

Improper handling of the product can cause damage to the product.

- Do not use aggressive cleaning agents, brushes with metal or nylon bristles or sharp or metallic cleaning objects such as knives, hard spatulas and the like, unless otherwise described. These can damage the surfaces.
- Do not attempt to clean the product in the dishwasher – this will destroy the product.

General cleaning

Clean the product after every use and before storing.

Unplug the product from the power socket and allow the product to cool completely.

Disassemble instructions

1. Slide out the juice container and the drip tray.
2. To remove the lid, open fully and apply pressure with thumbs. The lid will unclip from the juicing container together.
3. To prevent juice from dripping, remove the cones and the juicing chamber together by opening the front lever.
4. Hold the motor base with one hand, and with the other, grasp the juicing chamber at the front and pull up over the drive shafts. The cones will lift off with the juicing chamber. The cones may also be removed separately from the juicing chamber by simply lifting them off the drive shafts.
5. The juice container and drip tray slide out for cleaning.

Cleaning

All removable parts can be washed by hand in warm soap water.

NOTE: The natural colourings of the fruit that is being juiced may cause parts of the product to discolour.

The motor unit can be wiped with a damp cloth and cleaned with dry cloth.

NOTE: DO NOT place the motor or any other parts of the product in the dishwasher.

Reassemble instructions

1. Place the juicing chamber onto the motor base by sliding the protruding lugs at the back of the juicing cones onto the drive shafts.
2. Place the juicing cones onto the drive shafts.
3. Place the lid in its original location.
4. Slide the drip tray into position along the guide rails, dipping near tab into position.
5. The juicing container will then slide into position for storage.

INSPECTION

Before each use check that:

- The product is undamaged.
- The accessories are in perfect condition.
- The controls are not damaged.
- The vents are clean and clear.

Do not operate a damaged product or accessory.

STORAGE

NOTE!

RISK OF DAMAGE!

Improper storage of the product can result in damage.

- Allow the product to completely cool down.
- Place the product so that it can't fall into water.
- Store the product in a clean, dry, frost-protected place, out of the reach of children.

1. Thoroughly clean the product (see Cleaning and Maintenance section).
2. Roll up the power cord without knots or bends.
3. Always store the products parts and accessories together with the product.
4. If possible, pack the product in the original packaging.

TECHNICAL SPECIFICATIONS

Model Number	ACJ802
Power Supply	220-240V~ 50-60Hz
Rated Power	130W

12 MONTH WARRANTY

Thank you for your purchase.

Your new product is warranted to be free from defects in materials and workmanship for the period stated above, from the date of purchase, provided that the product is used in accordance with accompanying recommendations or instructions where provided. This warranty is in addition to your rights under the Australian Consumer Law.

For New Zealand customers, this warranty is in addition to statutory rights observed under New Zealand legislation.

We will provide you with your choice of a refund, repair (where possible) or exchange (availability dependent) for this product if it becomes defective within the warranty period. The business will bear the reasonable expense of claiming the warranty.

The warranty will no longer apply where the defect is a result of alteration, accident, misuse, abuse, or neglect.

Please retain your receipt as proof of purchase and contact our Customer Service Centre as listed below, for the entity you purchased this product from, for any difficulties with your product. Warranty claims and claims for expenses incurred in returning this product can be addressed with the respective Customer Service Centre.

Our goods come with guarantees that cannot be excluded under the Australian Consumer Law. You are entitled to a replacement or refund for a major failure and compensation for any other reasonably foreseeable loss or damage. You are also entitled to have the goods repaired or replaced if the goods fail to be of acceptable quality and the failure does not amount to a major failure.

Contact for Kmart purchases	Contact for Target purchases
Kmart Australia Ltd. C/-Customer Service Centre 690 Springvale Road, Mulgrave VIC 3170 Customer Service: 1800 124 125 (Australia) or 0800 945 995 (New Zealand) or via Customer Help at kmart.com.au	Target Australia Pty Ltd C/- Customer Service Centre 2 Kendall Street, Williams Landing, VIC, 3027 Customer Service: 1300 753 567 or via Customer Help at target.com.au/help/contact-us