



Street Scooter

Owner's Manual



This manual contains important safety, assembly, operation and maintenance information.

Please read and fully understand this manual before operation.

Save this manual for future reference.



Always wear approved helmet and safety equipment when using this product.

Thank you for your purchase of this product. If you have any queries or parts are missing or damaged, please contact below:

HUNTER LEISURE PTY LTD

94 KEILOR PARK DRIVE

TULLAMARINE VIC 3043

AUSTRALIA

Phone: 1800 632 792 (Australia)

0800 623 792(New Zealand)

Email: spares@hunterleisure.com.au

USER'S MANUAL

ATTENTION! Please read this manual before assembly. Make sure that you understand all warnings, cautions, instructions and safety topics. We recommend you to keep the manual as it contains important information. If you are going to give your scooter to third parties for future use, please provide the scooter along with this user's manual.

WARNINGS

- Adult assembly required.
- THE MAXIMUM WEIGHT LIMIT FOR THIS SCOOTER IS 80KG/176LBS.
- Recommended for user ages 8 and up.
- Wear personal protective equipment such as helmet, knee pads and elbow pads.
- Always wear fully enclosed shoes.
- Do not use scooter at night.
- Do not use on wet surfaces, uneven or unpaved road.
- It is not recommended the scooter be used on steep slopes at high speed.
- Avoid sharp bumps, drainage grates and sudden surface changes.
- This scooter is not designed for off-road use or stunting.
- Never ride with more than one person on the scooter.
- Always follow local traffic laws.
- Always check the brakes before riding.
- Brake will get hot from continuous use, do not touch after braking.
- Read all information supplied by the manufacturer before riding.
- This scooter has been tested to EN14619: 2019 CLASS A.
- Check and secure all fasteners before every ride.
- Ensure the clamp is locked correctly into position before every ride.
- Wheel and Bearings: Periodically check wheels and bearings for wear and tear and correct axle tightness.
- Replace worn and broken parts immediately.
- No modifications other than to the manufacturer's instructions shall be made.
- Make no modifications other than to the manufacturer's instructions.
- Periodically check and tighten all self-locking nuts and fixings as they may lose their effectiveness over time.

ALWAYS WEAR YOUR HELMET WHEN RIDING THIS PRODUCT!

Always read the user manual that comes with your helmet to make sure it is fitted and attached properly to the wearer's head according to the fitting instructions described in the user manual.

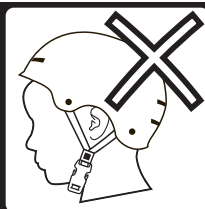
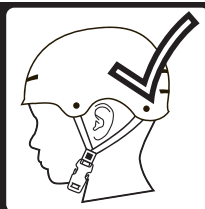

UNFOLDING/FOLDING SCOOTER

NOTE: To FOLD the scooter, REVERSE the steps below.

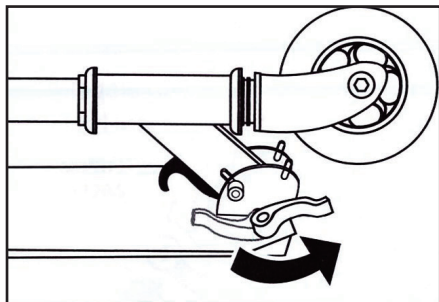

1. Release clamp.

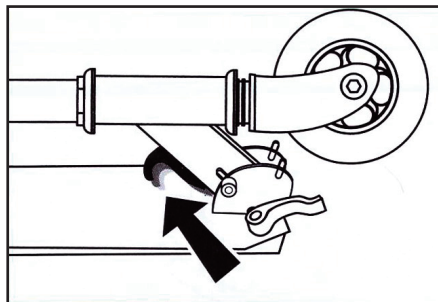

2. To release locking mechanism, pull upward on the release lever.

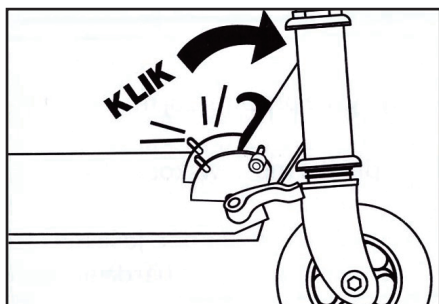

3. While holding the release lever up, push the steering column forward till you hear a "click".

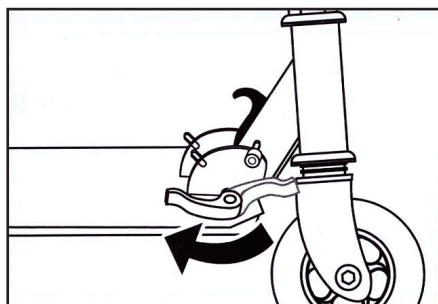

4. Close clamp.

HANDLEBAR PLACEMENT

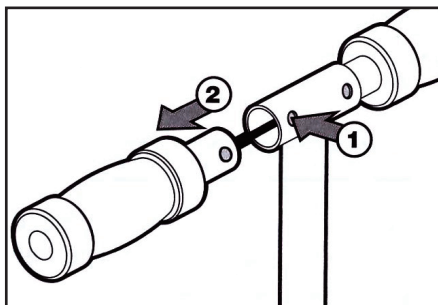
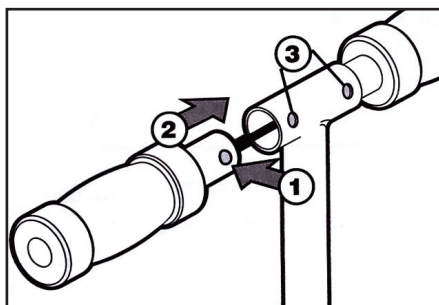

Hold the button (1) in and push the handlebar end into position in the steering tube until the button "clicks" into the steering tube. Reverse the steps to unfold handlebars.

HANDLEBAR HEIGHT ADJUSTMENT

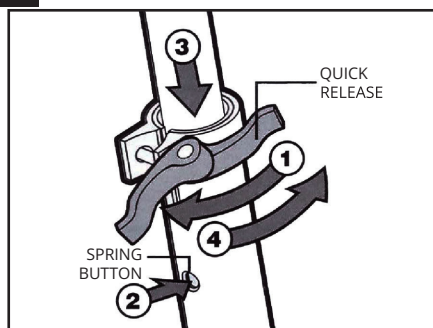
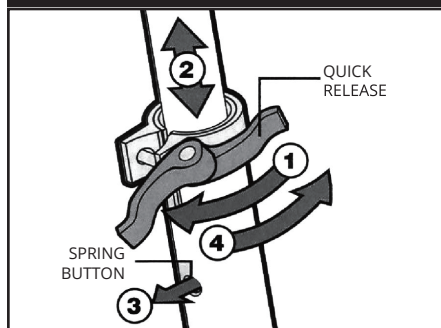

Open the handlebar height adjustment clamp by releasing the adjustment clamp lever. Extend the handlebar to the desired height until a pop button inside the stem will engage into the hole. DO NOT exceed the maximum height.

Hand tighten the adjusting nut on the clamp. Push the lever to the closed (locked) position. You should feel resistance while closing the lever. If no resistance is felt, re-open the lever and tighten the nut a couple more turns, close the lever and test again. Repeat until resistance is felt. Please ensure lever nut is secure.

HANDLEBAR

Always check the scooter steering mechanism before a ride. Failure to properly lock the handlebars into position can result in improper handlebar movement and loss of steering control. Make sure that the steering system is correctly adjusted, all fasteners are firmly fixed and free of cracks. Handlebar is used to maintain a balance during a ride, as well as for turning.

SELF-LOCKING FIXINGS

Self-locking nuts and other self-locking fixings may lose their effectiveness over time. If any of these components are no longer functioning how they should, it is strongly recommended that you will stop using the product and seek replacement parts.

WHEELS

Worn wheels and bearings are considered normal wear-and-tear. It is the responsibility of the owner or guardian to periodically inspect the wheels for wear and tear. Deterioration of the wheels depends on the intensity of the ride.

How to replace wheels:

- Place the hex keys into both sides of the axel heads.
- Turn the hex keys anti clockwise with both hands.
- When the bolts have undone you can push the axel bolt through with the hex key thus removing the wheel.
- Align the wheel back into position and place the long axel both through the fork and wheel holes.
- Screw in the other part of the axle I bolt and fully tighten using the hex keys.

BEARINGS

To ensure optimal performance for your bearings, clean and lubricate the bearings on a regular basis. Use a lubricant dedicated for bearings. This will preserve the durability and lifetime of your bearings. A bearings lifespan will be shortened drastically when used/stored in a moist and dirty environment.

BRAKE

To stop, step on the brake with the rear foot. Try not to use the brake for too long. Brake will get hot from continuous use. Do not touch after breaking.

STUNT SCOOTING

Attention! This scooter is not intended for stunt scooting. No stunt riding, jumping or downhillling.

MAINTENANCE

- It is recommended to remove dirt and dust and wipe dry after each use.
- Wipe with a soft and dry cloth. Clean bearing with a brush dedicated to the bearings cleaning.
- Do not use industrial cleaners or solvents, as they may damage the surfaces.
- Do not use alcohol, alcohol-based or ammonia-based cleaners.
- Do not wash the wheels with a running water: it may wash out the lubricant.
- It is recommended to unscrew the wheels regularly (depending on the intensity of use) and clean the components separately, paying particular attention to the parts requiring lubrication.
- Keep away from heat, fire and dampness.
- Always inspect your scooter before riding and maintain it.
- Replace worn or broken parts immediately.
- Only use parts and accessories approved by the manufacturer.