

## BASECAMP STORAGE TABLE

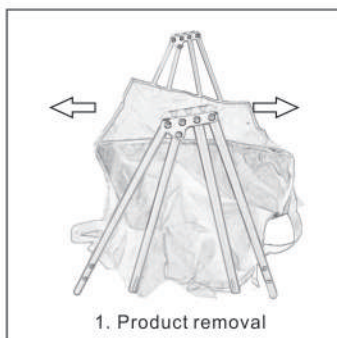

1. Product removal

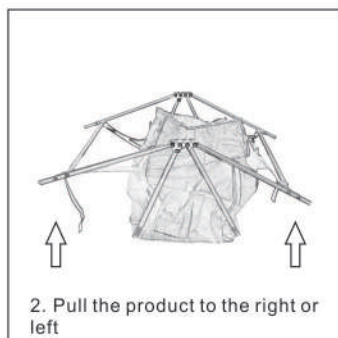

2. Pull the product to the right or left

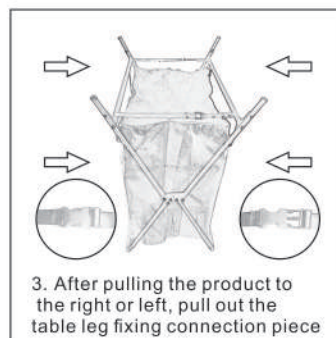

3. After pulling the product to the right or left, pull out the table leg fixing connection piece



4. The product is mounted on a cloth cabinet and fixed with upper and lower aluminum alloy plates

THIS PRODUCT IS FOR OUTDOOR CAMPING USE ONLY  
TO BE ASSEMBLED BY AN ADULT & USED UNDER ADULT SUPERVISION.

### **WARNING!**

Use only on firm and level ground to ensure work surface is level.  
Take extra care with folding parts & the assembly of the item.  
Ensure all locking mechanisms are secure before use.  
Do not use in wet conditions & take care to wipe any spills immediately  
**KEEP DRY**

### **CARE INSTRUCTIONS:**

Spot clean with mild soapy water, allow fabric to dry naturally & wipe surfaces dry. Do not use bleach, acids, solvents or abrasive cleaners. Store in a cool, dry place when not in use.



KEEP AWAY  
FROM FIRE



MAX LOAD  
WEIGHT

Made in China