

size:148mmx210mm

anko

Camp Cooking Set Instruction Manual

Keycode: 43-564-484

Accessories:



OPEN:

Lift the handle and lock it into place until you hear a click.

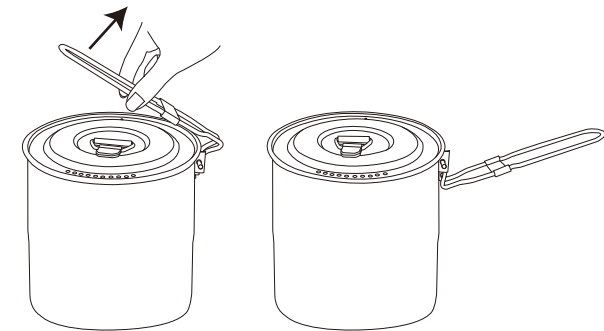

CLOSE:

1. Place all accessories into the pot and close the lid securely.

2. Move the sliding piece to the curved section of the handle.

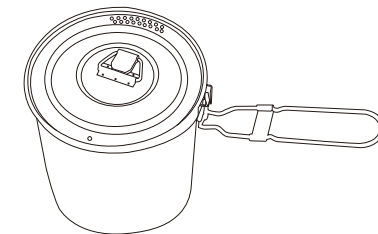

3. Then, hold the front end of the handle with one hand and press it while lifting the handle upward with the other hand until you hear a click.

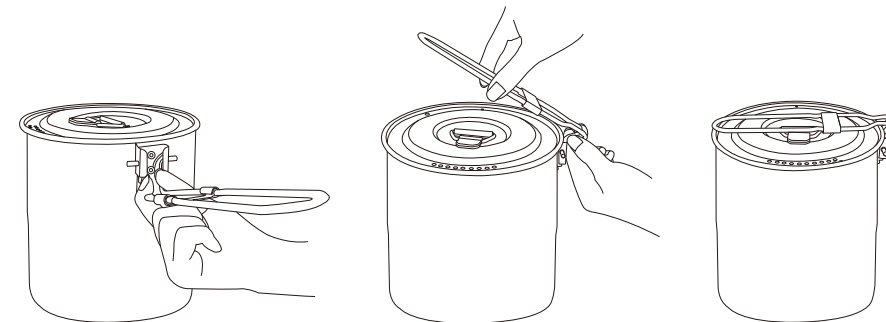

WARNING: KEEP OUT OF REACH OF CHILDREN. NEVER LEAVE EMPTY POTS ON A HOT BURNER OR ALLOW THEM TO BOIL DRY. ALWAYS ALLOW POTS TO COOL BEFORE WASHING, AND USE POTHOLDERS WHEN HANDLING HOT POTS. DO NOT USE POTS IN THE MICROWAVE, AND ALWAYS PLACE THEM ON HEAT-RESISTANT SURFACES. BE CAUTIOUS WHEN TOUCHING LIDS AND HANDLES, AND PERIODICALLY CHECK THAT HANDLES AND KNOBS ARE SECURE. ALWAYS MATCH POTS TO THE CORRECT BURNER SIZE, AND ADJUST THE GAS FLAME SO IT DOES NOT EXTEND UP THE SIDES OF THE POTS. AVOID SLIDING OR DRAGGING POTS, ESPECIALLY ON GLASS-TOP STOVES, AS THIS MAY CAUSE SCRATCHES.

CARE INSTRUCTIONS: BEFORE USING THE POTS, WASH THEM THOROUGHLY IN HOT, SOAPY WATER TO REMOVE ANY RESIDUE FROM THE MANUFACTURING PROCESS. IF NEEDED, CLEAN THE POTS WITH A NON-ABRASIVE CLEANER TO REMOVE STUBBORN STAINS. ALWAYS USE HEAT-RESISTANT PLASTIC, NYLON, OR WOODEN COOKING UTENSILS TO PREVENT SCRATCHING. AVOID USING SHARP-EDGED OR METAL UTENSILS. DO NOT USE OR ATTEMPT TO REPAIR DAMAGED ITEMS.

MADE IN CHINA

CUSTOMER SERVICE:
KMART AU: 1800 124 125
KMART NZ: 0800 945 995
TARGET AU: 1300 753 567