

KMT说明书 折页 128g双铜 尺寸: 89*130mm

anko

12 month warranty

Thank you for your purchase.

This product is warranted to be free from defects in materials and workmanship for the period stated above, from the date of purchase, provided that the product is used in accordance with accompanying recommendations or instructions where provided. This warranty is in addition to your rights under the Australian Consumer Law. For New Zealand customers, this warranty is in addition to statutory rights observed under New Zealand legislation.

We will provide you with your choice of a refund, repair (where possible) or exchange (availability dependent) for this product if it becomes defective within the warranty period. The business will bear the reasonable expense of claiming the warranty. This warranty will no longer apply where the defect is a result of alteration, accident, misuse, abuse or neglect.

Please retain your receipt as proof of purchase and contact our Customer Service Centre as listed below, for the entity you purchased this product from, for any difficulties with your product. Warranty claims and claims for expense incurred in returning this product can be addressed to the respective Customer Service Centre.

Our goods come with guarantees that cannot be excluded under the Australian Consumer Law. You are entitled to a replacement or refund for a major failure and compensation for any other reasonably foreseeable loss or damage. You are also entitled to have the goods repaired or replaced if the goods fail to be of acceptable quality and the failure does not amount to a major failure.

MADE IN CHINA

CUSTOMER SERVICE:

KMART AU: 1800 124 125

KMART NZ: 0800 945 995

TARGET AU: 1300 753 567

WARNING:

- This product shall not be connected to power supply source exceeding PS1 (5V d.c. 3A).
- The marking located on the bottom of charging unit.
- Danger of explosion if battery is incorrectly replaced. Replace only with the same or equivalent type.
- Battery cannot be subjected to high or low extreme temperatures, low air pressure at high altitude during use, storage or transportation.
- Replacement of a battery with an incorrect type that can result in an explosion or the leakage of flammable liquid or gas.
- Disposal of a battery into fire or a hot oven, or mechanically crushing or cutting of a battery, that can result in an explosion.
- Leaving a battery in an extremely high temperature surrounding environment that can result in an explosion or the leakage of flammable liquid or gas.
- A battery subjected to extremely low air pressure that may result in an explosion or the leakage of flammable liquid or gas.
- Please note the product working temperature is 0-40 °C.
- This speaker shall be charged by the supplied charging unit only.

K:43-561-797 | T: 71-040-264

Model : SP550B

Wireless Moon Lamp Speaker User Manual

Includes:

- Speaker
- Plastic stand
- Charging cable
- User manual



Function overview:

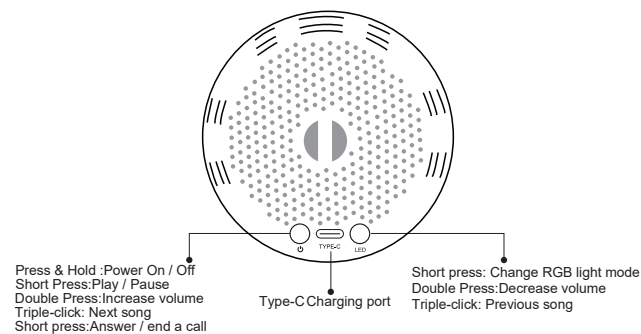

How to assemble the stand :

Assemble the plastic frame by inserting each dowel into its corresponding slot, as shown in the image :

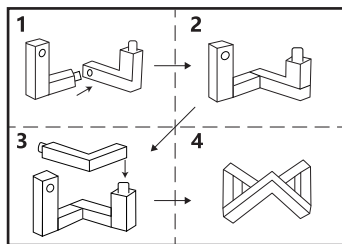

Function operation:

Play / Pause: Click power button

Previous: Triple click LED button

Next: Triple-click power button

Phone call: Click power button to answer or end a call when calling

TWS pairing: Turn on both speakers, before connecting with mobile phone, long press LED button on either one of the speaker, followed by a tone indicates two speakers paired successfully. Disconnected by long press LED button on either one of speaker

Volume up: Double-click power button

Volume down: Double-click LED button

Pairing the speaker with Bluetooth® devices

- ◆ Go to "Bluetooth Settings" on your Bluetooth device (phone, tablet, etc.)
- ◆ Turn the Bluetooth ON at your device, press and hold the power button for 2 seconds to power on the speaker, on your Bluetooth Device, select the pairing name on the list of available devices, select pairing name: **anko43561797**.

- ◆ A tone will alert when connected successfully.

- ◆ Bluetooth speaker will always automatically re-pair with the last paired device as long as it is in range. You should Bluetooth unpair the speaker from the last device before connecting to a new device.

Playing music

Click the power button once to pause playback, click it again to resume playback. Double click power button to increase volume, double click LED button to decrease volume. Triple click the LED button to play previous track, triple click the power button to play next song.

LED light switch

Click LED button to switch the light mode, there're multiple light modes available.

Battery charging

When using for the first time, charge the battery to maximum capacity. To recharge, plug the Type-C charging cable into the charging port. Red LED lights up indicates that charging is in progress. When light turns off, charge is completed.

Technical specification:

Battery capacity: 1200mAh

Frequency response: 20Hz-20KHz

Working distance: 10 meters

Charging port: Type-C

Music time: 10 Hours (Approx. 80% vol, with light on)

Music time: 27 Hours (Approx. 80% vol, with light off)

Charge time: 2 hours

Output power: 5W 3Ω

Unit driver: 52 mm

Rated input: 5V 1A

The Bluetooth® word mark and logos are registered trademarks owned by Bluetooth® SIG, Inc., and any use of such marks by KMART AUSTRALIA is under license