

anko

Upright Vacuum Cleaner For Household Use Only

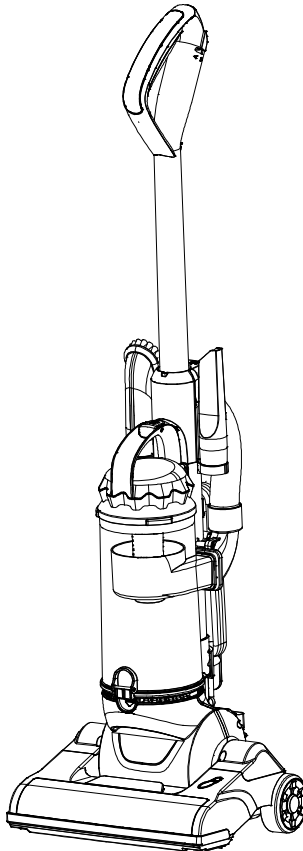

Model No.: DMD301
Rev 1

Note: This appliance's specifications and/or components are subject to change without prior notice.

If any Accessories should fail during use, please call 1300 105 888 (Australia) or 09 8870 447 (New Zealand) for an immediate replacement. This will save you from returning the product to the store.

If we can assist you in any other way, please feel free to contact us

1	Warnings.....	4
2	Safety Direction.....	4
3	Transporting your Vacuum	7
4	Components	7
5	Assembly Method	8
	5.1 Fitting / Removing the Handle	8
	5.2 Flexible Tube.....	9
	5.3 Crevice and Brush Tool Holder	9
6	Power Cord Storage.....	9
7	Safety Devices Operation.....	10
8	Power On / Off Switch.....	11
9	Floor Head Release.....	11
10	Tools	12
	10.1 Crevice	12
11	Flexible Hose	12
12	Emptying the Dust Canister	14
13	User Maintenance	16
	13.1 Cleaning Filters.....	17
	13.1.1 Main Filter.....	17
	13.1.2 Pre-Motor Filter.....	21
	13.1.3 Dust Canister	22
	13.2 Cleaning the Vacuum Cleaner Body and Tools	23
	13.3 Cleaning the Rotary Brush Bar.....	23
	13.4 Replacing the Drive Belt.....	28
14	Troubleshooting.....	29
15	Warranty Against Defect	31

1 Warnings

Before using this appliance, read and follow all warnings and instructions in this manual, even if you are familiar with this product.

This appliance is not intended for use by persons (including children) with reduced physical, sensory, or mental capabilities, or lack of experience and knowledge unless they have been given supervision or instruction concerning the use of the appliance by a person responsible for their safety.

Children should be supervised to ensure that they do not play with the appliance.

2 Safety Direction



Please read this instruction manual carefully before first use. It is advisable to keep this instruction manual for future reference.

DO NOT vacuum water, wet objects, liquids, ashes, hot coals, cigarette butts, matches or any hot, smoking or burning objects, etc.

DO NOT pick up flammable or combustible materials (i.e., lighter fluid, petrol, kerosene, etc.) or use in the presence of explosive liquids or vapour.

DO NOT pick up toxic material (i.e., chlorine bleach, ammonia, drain cleaner, etc.)

DO NOT vacuum Toner (for laser printers, copy machines etc.) as there is a risk of fire and explosion.

DO NOT vacuum plaster, cement etc. as the filter can become blocked.

DO NOT use the vacuum without all the filters fitted.

DO NOT store or use the appliance near high-temperature areas.

DO NOT run over the power cord with the vacuum cleaner.

DO NOT use the vacuum cleaner if it is blocked. Switch off and clear all blockages before continuing.

DO NOT use the vacuum cleaner with blocked filters. Clean filters before continuing. (refer to User Maintenance section).

DO NOT misuse the cord. Never pull the appliance by the cord or pull to disconnect it from the outlet. Instead, grasp the plug and pull to disconnect.

DO NOT use the vacuum cleaner if the appliance malfunctions, has abnormal noise, smells, or smoke, is dropped or damaged in any manner or if any breakage is found during the operation.

For electrical safety, any repairs to the product must be performed by a qualified electrical person only, or the product must be disposed of.

DO NOT use the vacuum cleaner to pick up large objects, hard or sharp objects such as glass, nails, screws, coins, etc. that are likely to cause damage.

DO NOT use the vacuum cleaner if it has been dropped, damaged, left outdoors, or dropped into liquid (water etc.)

DO NOT close the door on the cord or pull the cord around sharp edges or corners.

DO NOT handle the plug or vacuum cleaner with wet hands.

DO NOT put any objects into openings.

DO NOT use with any openings blocked and do not restrict airflow.

DO NOT operate the appliance with a damaged cord or plug.

If the supply cord is damaged, it must be replaced by the manufacturer, its service agent, or similarly qualified persons to avoid a hazard.

DO NOT use without filters in place.

DO NOT attempt to modify this product in any way.

DO empty the Dust Canister regularly for optimal operation of the vacuum.

DO keep hair, loose clothing, fingers, feet, and body parts away from openings or moving parts.

DO switch off controls before you connect or disconnect the appliance to or from the mains supply.

DO disconnect the appliance from the power supply when not in use, before changing the filters, cleaning the filters, or connecting / disconnecting the accessories.

DO use only on dry, indoor surfaces.

DO use only as described in this manual. Use only the manufacturer's recommended attachments.

DO Keep cord away from heated surfaces.

DO Keep all openings free of dust, lint, hair, and anything that may reduce airflow.

DO use extra care when vacuuming on stairs.

DO keep your work area well-lit.

DO store your appliance indoors in a cool, dry area.

DO ensure children and babies cannot play with plastic bags or any packaging materials.

DO operate the appliance from a power source of the same voltage, frequency and rating as indicated on the product identification plate.

If a third party uses this appliance, **DO** supply the instruction manual with it.

No liability can be accepted for any damage caused by non-compliance with these instructions or any other improper use or mishandling of the appliance.

This product has not been designed for any uses other than those specified in this manual.

ONLY for domestic use. Industrial or commercial use invalidates the warranty.

Please note: It is especially important that the filters, dust canister and components are kept clean and free from blockages, etc.

Failure to keep clean and well maintained will reduce the performance of your vacuum cleaner and may cause the motor to overheat.

Please refer to the “User Maintenance” Section for further instruction on cleaning.

Read and Save These Instructions

3 Transporting your Vacuum

To move your vacuum cleaner from room to room, unplug the appliance and either push the appliance or carry using the handle.

Never pull or carry the vacuum cleaner by its cord.

Never carry or pull the vacuum cleaner by the flexible hose.

4 Components

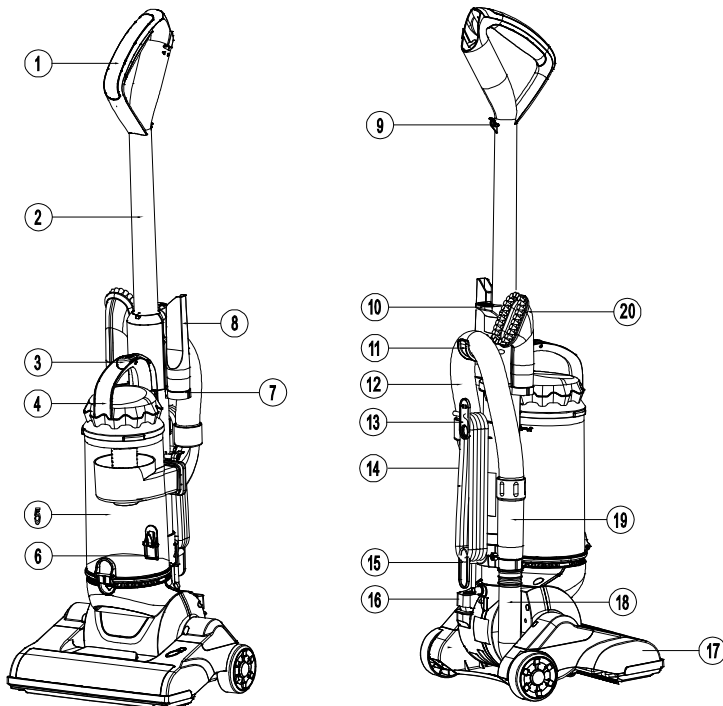

1	Handle	11	Flexible Hose Hook
2	Detachable Wand	12	Flexible Hose
3	Dust Canister Release Button	13	Top Power Cord Hook
4	Carry Handle	14	Power Cord
5	Dust Canister	15	Lower Power Cord Hook
6	Dust Canister Trap Door Release Button	16	On / Off Foot Switch
7	Tool Holder	17	Floor Head
8	Crevice Tool	18	Flexible Hose Handle Holder Post
9	Power Cord Clip	19	Flexible Hose Handle
10	Detachable Wand Release Button	20	Brush Tool

5 Assembly Method

Please Note: Always switch off and remove the plug from the power point before fitting or removing accessories, including the dust canister.

Ensure all Filters are fitted and fitted correctly before using.

5.1 Fitting / Removing the Handle

To fit the handle, place the end of the tube into the hole in the top of the vacuum cleaner.

The Handle Release Lever may need to be pushed down to let the tube in.

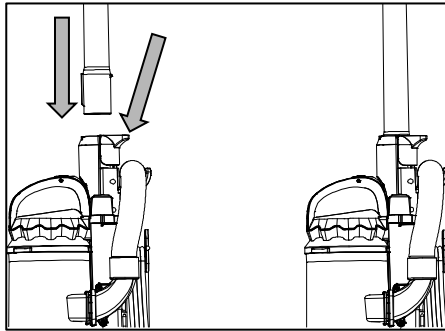

Once the tube is in the hole, release the lever then push down hard until the tube locks in place.

To remove the handle, press the Handle Release Lever down and whilst holding it down, grasp the handle and pull it straight up and out.

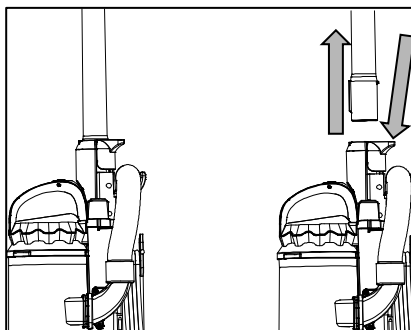

5.2 Flexible Tube

Place the flexible hose into the upper hose holder then insert the hose handle onto the lower hose post.

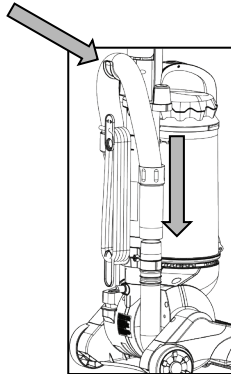

5.3 Crevice and Brush Tool Holder

Take the Crevice and Brush tool and stow it on the back of the vacuum cleaner as shown.

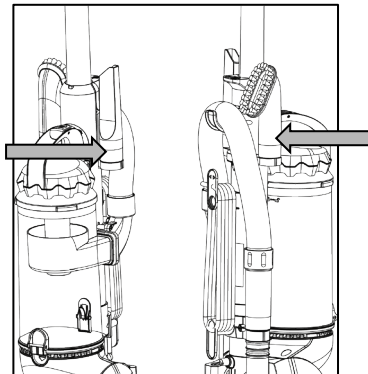

6 Power Cord Storage

There is provision for storing the power cord when not in use.

There are two hooks on the back of the vacuum cleaner for winding the cord.

The top hook can be rotated for easy removal of the cord when getting ready to use the appliance. Simply rotate the top hook 180° and then

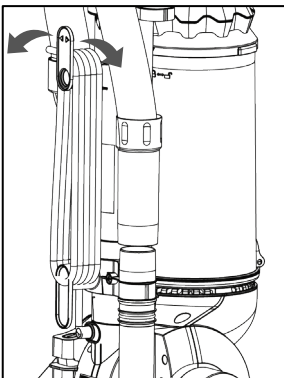

slip the cord off.

When storing the cable back onto the hooks, make sure the top hook is pointing up. (i.e., rotate back to the original position).

7 Safety Devices Operation

NOTE: The motor has an overheating protection device built in.

It will automatically switch off the power to the motor if it overheats. e.g., from blocked nozzles, a full dust canister or uncleaned blocked filters.

If this happens, switch off the vacuum and unplug it from the power point, clean blockage and / or filters and allow it to rest for approximately 1 hour which should be enough time for the motor to cool down depending on ambient temperature.

Important: You must switch off and unplug from the power point for the safety device to reset. It will not reset if you leave it plugged in and switched on.

NOTE: NEVER BLOCK ANY VENTS OR OPENINGS AND KEEP FILTERS CLEAN.

8 Power On / Off Switch

The Motor On / Off switch is located on the floor head.

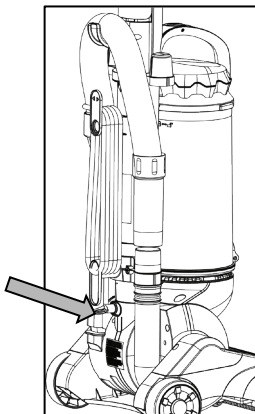

To turn the motor on, using your foot, press and release the On / Off Switch.

Press and release the On / Off switch again to turn it off.

9 Floor Head Release

To Lower the Handle, place your foot on the top of the floor head to hold it firmly on the floor and then pull the vacuum cleaner handle back.

The floor head latching mechanism will release and you are now ready to start vacuuming the floor.

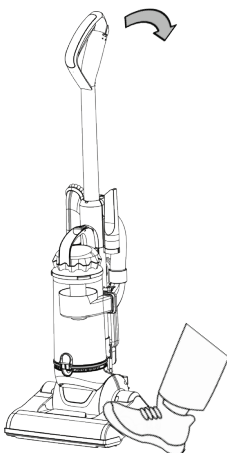

Do Not allow the Floor Head Rotary Brush to spin in the one spot as this will damage the carpet.

Keep the vacuum cleaner moving backward and forward, and when finished, lift the handle up and push it forward to lock in place then turn off.

Note: When the latching mechanism releases, it will make a “click” noise. This is no reason for alarm as it is just the latching mechanism operating.

WARNING: When the handle is lifted back up to the park position, and locked in place, the Floor Head Rotary Brush will continue to rotate.

The floor head will lift slightly; however, it is strongly recommended that you do not allow the Vacuum Cleaner to sit on one spot while the Brush Bar is rotating as this may cause damage to the flooring surface.

10 Tools

10.1 Crevice

The Crevice tool is for getting into tight areas and into corners etc.

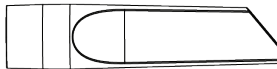

The Brush tool is for cleaning furniture and surfaces.

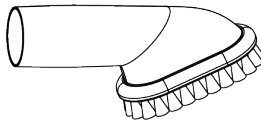

11 Flexible Hose

The vacuum Cleaner comes with a Flexible Hose which can be used with the vacuum cleaners handle (Wand) for extra reach and for cleaning stairs etc.

To use the hose with the crevice or brush tool, first pull out the removable end from the back of the Floor Head by pulling straight out as shown.

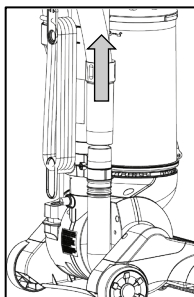

Take the crevice or brush tool and slide it onto the end of the hose connector.

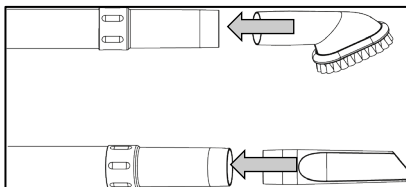

You are now ready to use the crevice or brush tool.

To use the handle (Wand) for the extra reach, remove the Handle from the top of the vacuum cleaner by pressing down the Release Lever and then pull the Handle straight up and out as shown.

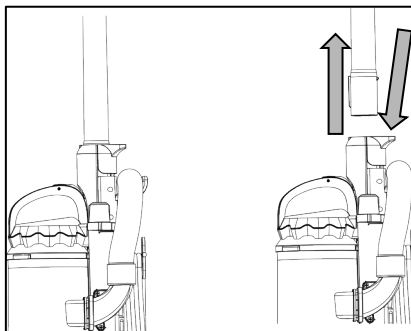

Next, connect the end of the hose coupling to the top end of the Handle.

Align the locking pin on the side of the hose coupling with the slot in the end of the handle, push in and then rotate clockwise to lock as shown.

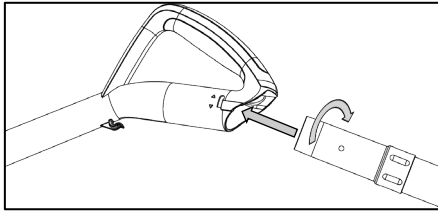

Take the crevice or brush tool and slide it onto the end of the Handle (Wand) as shown.

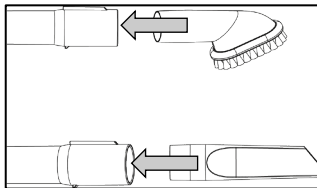

You are now ready to use the crevice or brush tool.

CAUTION

DO use extra care when vacuuming on stairs. Take care not to trip on the power cable or flexible hose and **DO** keep your work area well-lit.

When finished vacuuming, the vacuum cleaner can be reassembled for use as an upright vacuum cleaner.

12 Emptying the Dust Canister

Empty the Dust Canister and clean the filter as frequently as possible or when the suction power is reduced.

To remove the Dust Canister, switch off the power and unplug from the power point.

Grip the handle on the Dust Canister, press the Dust Canister Release Button on the dust canister handle, and pull the Dust Canister forward and out of the housing.

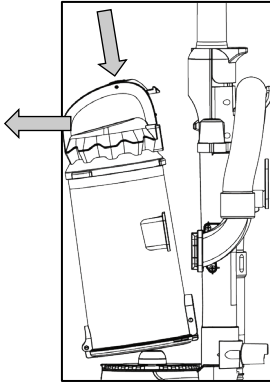

Take the dust Canister to a dust bin.

Press the trap door release button on the side of the dust canister and swing the trap door down emptying the contents into the bin.

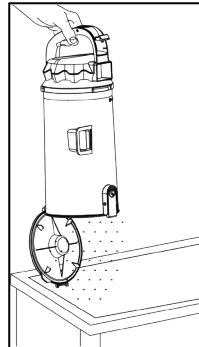
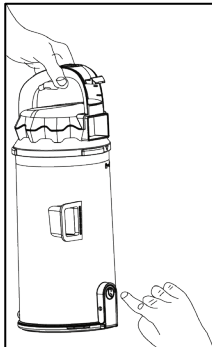

To close the trap door, close it manually until it clips shut.

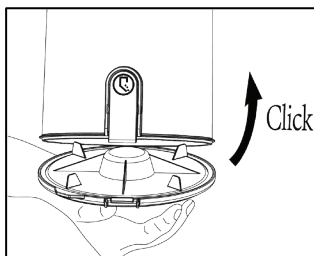

Brush the inside of the dust canister with a small brush or wash. Refer to the section “Cleaning Filters”.

To refit the Dust Canister into the vacuum cleaner, simply align the base of the dust canister into its position and swing the top in until it locks in place.

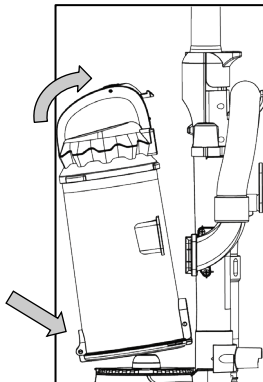

13 User Maintenance

WARNING: The vacuum cleaner **MUST** be switched off and unplugged from the power point before any maintenance or replacement of parts.

Failure to do so may result in injury or damage to your surroundings and vacuum cleaner.

NOTE: To maximise the performance of your vacuum cleaner, you should clean your filters regularly.

If the filters are broken or worn, replace them before continuing to use the vacuum.

Filters can be purchased from our Customer Service.

You can call our customer service number or via email as specified at the bottom of the page under heading “Warranty Against Defect”.

13.1 Cleaning Filters

Important Note – The Filters must be cleaned regularly for best suction performance and to prevent overheating and damage to your vacuum cleaner.

Cleaning is best done at the same time when emptying the dust Canister after you have finished vacuuming for the day.

NOTE: Never use the vacuum cleaner with wet or damp filters or without **ALL** filters fitted.

Using wet or damp filters will damage the filters, may cause serious damage to the vacuum cleaner, and will void your warranty.

13.1.1 Main Filter

Remove the Dust Canister as described previously.

The main filter is located underneath the top lid of the dust canister.

To access this filter for cleaning (or replacement) first open the lid of the dust canister by rotating the lid anticlockwise then pull the lid straight up and off.

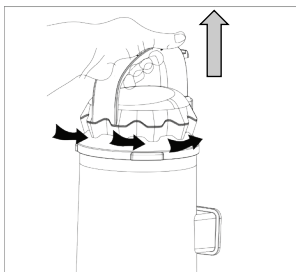

With the lid removed, grasp the filter and pull straight up and out.



Note: Only wash the filter if it is very dirty, otherwise just tap the of the filter on a hard surface to dislodge any dust and remove any large debris.

If washing, wash the filter in warm mild soapy water, rinse in clean fresh cold water and let it completely dry.

DO NOT scrub the filter or place it in a dishwasher.

DO NOT use a hair dryer to dry the filter.

NOTE: Never use the vacuum cleaner with wet or damp filters. Using wet or damp filters will damage the filters, may cause serious damage to the vacuum cleaner, and will void your warranty.

At the same time the filter has been removed for cleaning (or replacement), the filter holder can also be removed and cleaned.

Remove the Filter holder by grasping the sides of the holder and pull straight up and out.

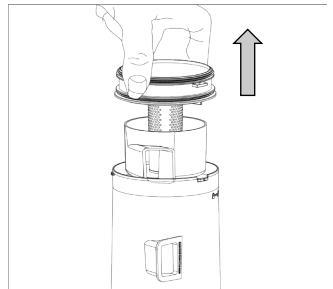

The filter holder has a dust separator attached to the bottom of its post which can be removed for ease of cleaning.

To remove, hold the top part whilst at the same time, rotate the dust separator clockwise to unclip, then pull the two apart.

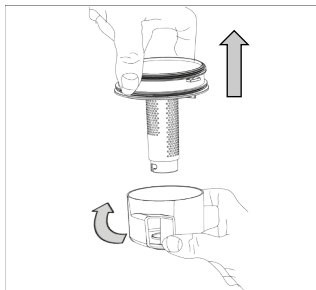

Wash both parts in warm mild soapy water, rinse in clean fresh cold water and let it completely dry.

DO NOT place it in a dishwasher.

DO NOT use a hair dryer to dry.

NOTE: Never use the vacuum cleaner with wet or damp parts.

Using wet or damp parts may cause serious damage to the vacuum cleaner and will void your warranty.

To refit the filter, place the filter into the top of the dust separator and push it down firmly.

Refit the Dust Separator onto the end of the filter holder by pushing on and rotating anticlockwise until it locks in place.

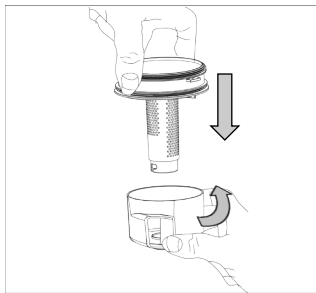

Replace the filter holder back into the Dust Canister ensuring the Locating Lug on the top of the filter holder is aligned with the mating notch in the Dust Canister lip as shown and then push in all the way.

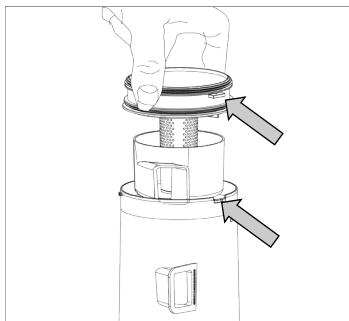

Refit the Dust Canister lid to the top of the dust canister aligning the Triangle Mark on the lid with the Unlocked Padlock Symbol on the dust canister then, rotate clockwise until the lid locks with the Triangle Mark on the lid aligned with the Locked Padlock Symbol on the dust canister.

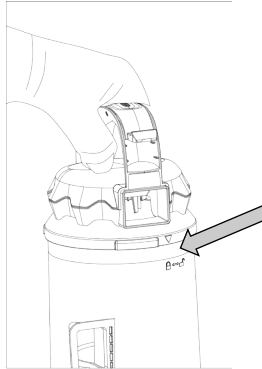

Refit the dust canister to the vacuum cleaner.

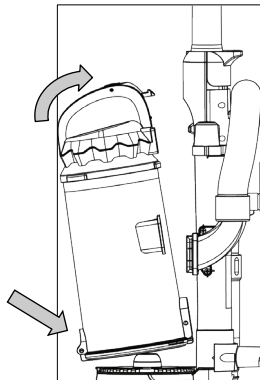

It is recommended to replace the filter every 3 – 6 months, or sooner if required.

13.1.2 Pre-Motor Filter

The pre-motor filter is located in the bottom section of the vacuum cleaner where the dust canister locates.

Lift the front tab upward and pull straight up and off to expose the filter.

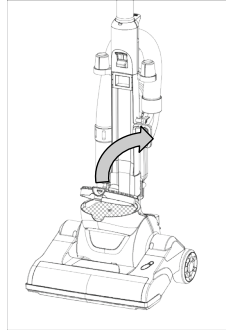
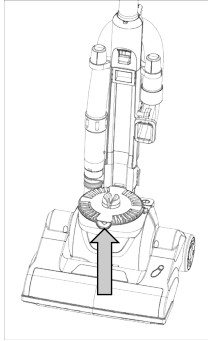

Grasp the Filter and pull it straight up and out.

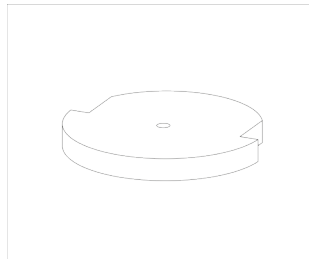
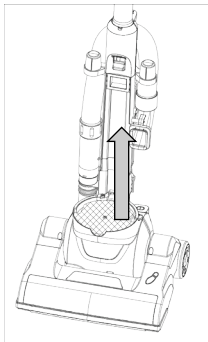

Note: Only wash the filter if it is very dirty, otherwise just tap the filter on a hard surface to dislodge any dust and remove any large debris.

If washing, wash the filter in warm mild soapy water, rinse in clean fresh cold water and let completely dry.

DO NOT scrub the filter or place it in a dishwasher.

DO NOT use a hair dryer to dry the filter.

NOTE: Never use the vacuum cleaner with wet or damp filters. Using wet or damp filters will damage the filters, may cause serious damage to the vacuum cleaner, and will void your warranty.

Refit the Filter (or replace it with a new one) by placing it back into the vacuum cleaner and pushing down firmly to ensure it is seated properly.

It is recommended to replace the filter every 3 – 6 months, or sooner if required.

Refit the cover and push down firmly to lock it in place.

Refit the Dust canister to the vacuum cleaner and now you are ready to use.

13.1.3 Dust Canister

Any time the main filter is removed, you may also wash the dust canister.

Wash in warm mild soapy water, rinse in clean fresh cold water and let completely dry.

DO NOT scrub or place in a dishwasher.

DO NOT use a hair dryer to dry the filter.

NOTE: Never use the vacuum cleaner with wet or damp components. Using wet or damp components may cause serious damage to the vacuum cleaner and will void your warranty.

Reassemble the dust canister with the filter then refit the Dust canister to the vacuum cleaner and now you are ready to use.

13.2 Cleaning the Vacuum Cleaner Body and Tools

Switch Off and Unplug the Vacuum Cleaner before any cleaning.

Do not clean the vacuum cleaner, components or accessories using petrol or any other flammable liquid or solvents, etc.

Clean only the outside of the vacuum cleaner.

Use only a moist cloth and mild detergent for cleaning the vacuum cleaner, components, and accessories.

After cleaning, wipe off the moisture on the vacuum cleaner, components, and accessories with a dry cloth.

Do Not place accessories, tools, or components in a dishwasher.

13.3 Cleaning the Rotary Brush Bar

WARNING: The vacuum cleaner **MUST** be switched off and unplugged from the power point before attempting to clean the rotary brush bar.

Failure to do so may result in injury or damage to your surroundings and vacuum cleaner.

During use of the vacuum cleaner, the brush bar may become entangled with hair or thread etc. which needs to be removed to prevent damage to the brush bar and for it to perform properly.

Ensuring the vacuum cleaner is switched off and unplugged from the power point, lay the vacuum cleaner on the floor so that you have access to the underneath of the floor head.

With a pair of sharp scissors or sharp utility knife, very carefully cut the hair or thread etc. away from the rotary brush and bristles. Take care not to cut the bristles.

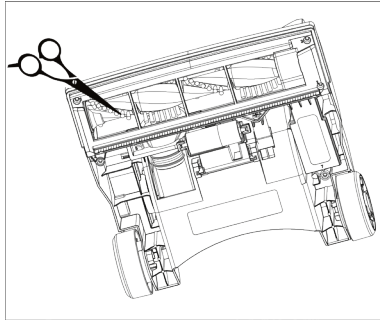

Once you have cleared the brush bar, stand the vacuum cleaner back up and then you are ready to use.

Should you be unable to remove all the debris and hair etc. you may need to remove the brush bar for a deeper clean.

To access the brush bar, you will need to remove the guard surrounding the brush bar.

To do this, you will need a medium size Phillips screws driver to remove seven screws as shown.

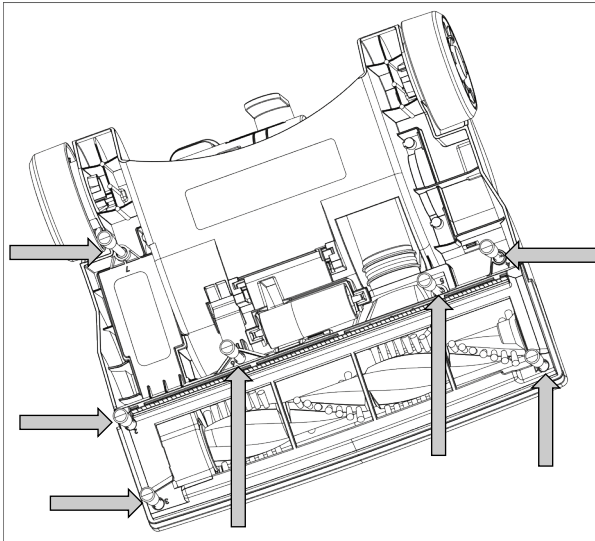

With the seven screws removed, slide the brush guard up and off.

Note: it may be tight so some force will be required.

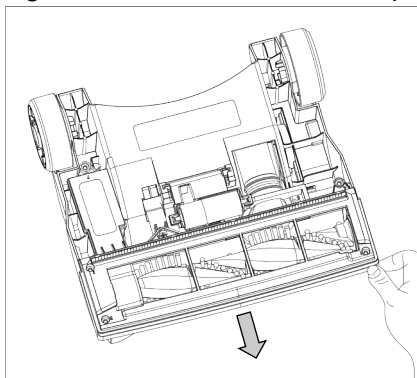

Grasp the right side of the brush bar and pull it out, then pull the left side out.

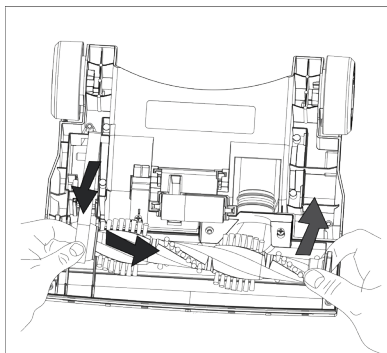
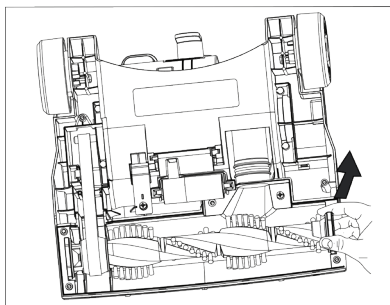

Slip the drive belt off the end on the brush bar and remove the brush bar for cleaning.

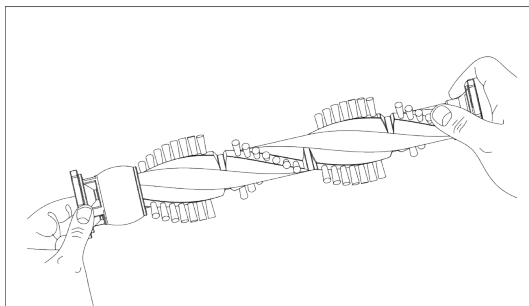

IMPORTANT: Do not wash the brush bar or get it wet.

Use scissors or a utility knife to cut away any hair and debris, and use a brush to clean off any dirt etc.

Before refitting the brush bar, clean the floor head where the brush bar locates to remove any dirt and debris.

After cleaning the brush bar, refit it to the vacuum cleaner in the reverse order of disassembling.

Feed the bulbus end of the brush bar through the drive belt as shown.

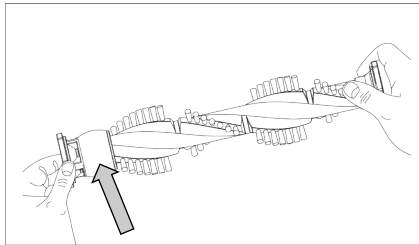

Align the plates on the ends of the brush bar with their mating slots in the floor head, then push in all the way.

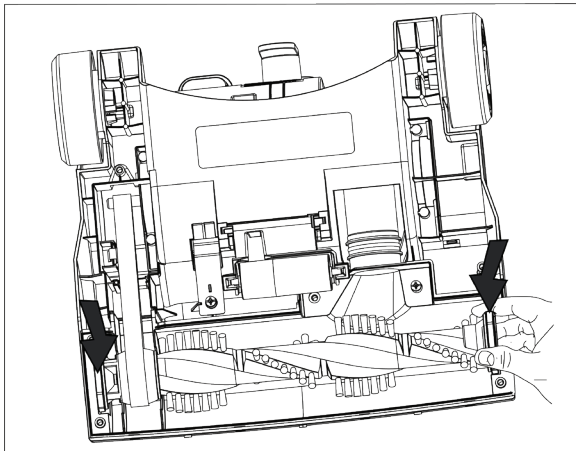

Refit the Brush Guard by locating it over the front of the floor head then push on firmly.

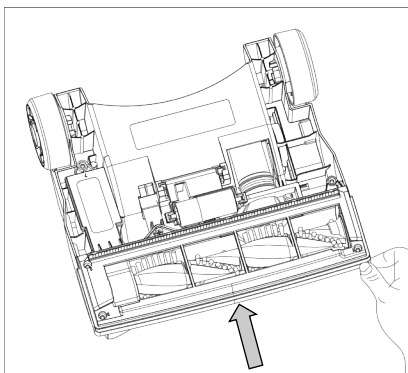

Secure in place with the seven screws and tighten. **Do Not Overtighten.**

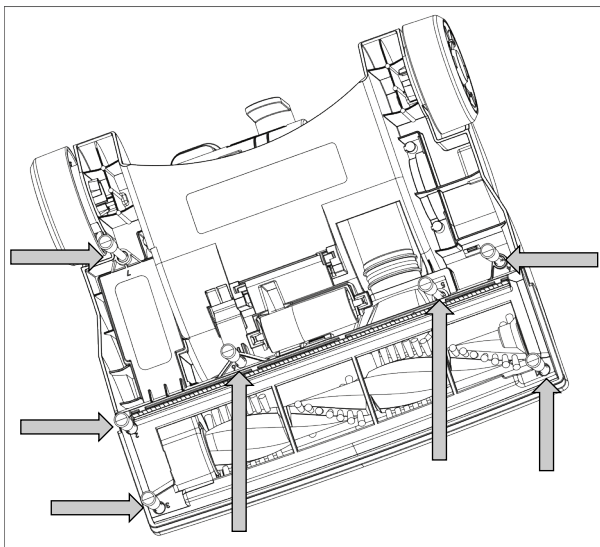

You can now stand the vacuum cleaner upright ready for use.

13.4 Replacing the Drive Belt

Should the rubber drive belt break, this is more than likely due to the rotary brush bar being jammed whilst the motor has been allowed to run.

To access the drive belt, first switch off and unplug the vacuum cleaner.

Remove the bottom of the floor head as described in the section “Cleaning the Rotary Brush Bar” and remove the rotary brush bar.

Remove the broken rubber belt and discard.

Take the new Rubber Drive Belt and slide it onto the motor spindle.

Refit the Rotary Brush Bar as described in the section “Cleaning the Rotary Brush Bar”, then reattach the cover in place with the seven screws and tighten. **Do Not Overtighten.**

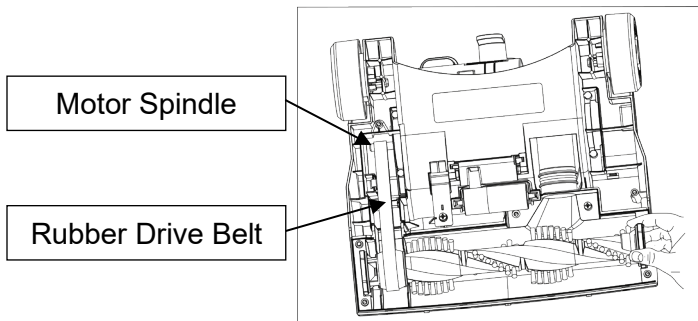

14 Troubleshooting

Problem	Cause	Remedy
Will Not Switch On	Not Plugged in and/or switched on at the Power Point	Ensure the plug is properly plugged into the power point and switched on at the power point.
	No Power supplied to Power Point	Check that there is power at the power point. Use a table lamp or other appliance to check.
	Appliance On / Off switch not switched on.	Press the On/Off switch on the Vacuum cleaner.
	Motor has overheated	The motor thermostat has tripped – Refer to “Overheating / Stopping” in the table below.
Noisy operation	Filters are blocked	Clean the Filters and empty the Dust Canister
	Air Passage is blocked	Check for partial blockages and unblock.
Suction Not Strong	Filters are blocked	Clean the Filters and empty the Dust Canister.
	Air Passage is blocked	Check for blockages and unblock.
	Flexible hose not connected properly to the floor head.	Ensure the flexible hose has been reconnected properly to the floor head.
	Filters have not been installed.	Ensure all filters have been installed and installed correctly.
	Dust Canister has not been attached correctly	Ensure the dust canister has been fitted correctly and that the small arrow on the dust canister aligns with the Locked Padlock Symbol when rotated to the locked position.
Over-heating / Stopping	Motor has overheated	Switch off and unplug from the power point, Clean or replace the Filters, empty the Dust Canister, check for blockages, and unblock then allow it to cool for approximately 1 hour before trying to restart.

Vacuum Cleaner will not restart after overheating and allowing it to rest for approximately 1 hour.	Not enough cooling time has elapsed.	Allow an additional half an hour to cool down.
	Vacuum Cleaner was not switched off and unplugged from the power point.	You must switch off and unplug from the power point for the safety device to reset. It will not reset if you leave it plugged in and switched on.
Smell burning Rubber	The Rotary Brush Bar in the Floor Head is jammed and the rubber drive belt is slipping.	Immediately turn off and unplug. Refer to the Maintenance section for cleaning the brush bar.
Motor is running but Rotary Brush Bar is not rotating	The Rotary Brush Bar in the Floor Head has jammed and the rubber drive belt has broken.	Replace the drive belt as described in the maintenance section.
Static Shock	In some rare instances, one or two users may feel an electric discharge when touching or using the vacuum cleaner during or after use. This is a well know phenomenon of Static Electricity discharge that happens mostly when the user vacuums a synthetic fibre carpet or other synthetic surfaces. It can also be more prevalent in dry and cool environments. Although the feeling of Static Electricity can be unpleasant for the user, it is not dangerous and is not a fault of the vacuum cleaner. If this static discharge is a problem for the user, the user could try wearing insulating footwear during vacuuming (i.e., rubber or leather soles) or increase the humidity / heat level in the surrounding environment or both.	

15 Warranty Against Defect

12 Month Warranty

Thank you for your purchase.

Your new product is warrantied to be free from defects in materials and workmanship for the period stated above, from the date of purchase, provided that the product is used in accordance with accompanying recommendations or instructions where provided. This warranty is in addition to your rights under the Australian Consumer Law. For New Zealand customers, this warranty is in addition to statutory rights observed under New Zealand legislation.

We will provide you with your choice of a refund, repair (where possible) or exchange (availability dependent) for this product if it becomes defective within the warranty period. The business will bear the reasonable expense of claiming the warranty. This warranty will no longer apply where the defect is a result of alteration, accident, misuse, abuse, or neglect.

Please retain your receipt as proof of purchase and contact our Customer Service Centre as listed below, for the entity you purchased this product from, for any difficulties with your product. Warranty claims and claims for expenses incurred in returning this product can be addressed to the respective Customer Service Centre.

Our goods come with guarantees that cannot be excluded under the Australian Consumer Law. You are entitled to a replacement or refund for a major failure and compensation for any other reasonably foreseeable loss or damage. You are also entitled to have the goods repaired or replaced if the goods fail to be of acceptable quality and the failure does not amount to a major failure.

Contact for Kmart purchases	Contact for Target purchases
Kmart Australia Ltd. C/- Customer Service Centre, 690 Springvale Road, Mulgrave Vic 3170 Customer Service: 1800 124 125 (Australia) or 0800 945 995 (New Zealand) or via Customer Help at kmart.com.au	Target Australia Pty Ltd. C/- Customer Service Centre, 2 Kendall Street, Williams Landing, Vic, 3027 Customer Service: 1300 753 567 or via Customer Help at target.com.au/help/contact-us

IMPORTANT! For all technical queries or difficulties in operating the product and for spare parts, contact H.E. Group customer service 1300 105 888 (Australia) and 09 8870 447 (New Zealand).

