



10" RING LIGHT

K: 43351640 | T: 68734992

SLR-23050

IMPORTANT SAFETY INSTRUCTIONS:

The following safety precautions should always be followed, to reduce the risk of electric shock, personal injury or fire. It is important to read all of these instructions carefully before using the product, and to save them for future reference or new users.

1. This product must only be used as intended in accordance with the enclosed operating instructions.
2. If the external flexible cable or cord of this luminaire is damaged, this product should be discarded
3. If the luminaire stops unexpectedly or appears to malfunction, switch off the power supply and stop using immediately. Seek professional advice to rectify the fault or make repairs.
4. Switch off the power supply when not in use, before cleaning or changing accessories.
5. Keep the luminaire and cable away from sources of heat, sharp objects or anything that may cause damage.
6. Be aware that some surfaces may become hot. Do not touch hot surfaces and supervise others accordingly.
7. This product has not been designed for use by children. Children should be closely supervised at all times when they are near any electrical appliance.
8. To protect against electric shock, never allow the luminaire come into contact with water or any other liquid.
9. Never reach this luminaire that has fallen into water. Do not re-use until the product has been inspected and approved by a qualified electrician.
10. Do not use outdoors. This luminaire has been designed for domestic indoor use only.
11. Use only a microfiber and dry cloth for cleaning the product.
12. Operate carefully to not cause any damage by dropping or physical shocking it.
13. Do not leave the product in excessive heat, high temperatures can cause the product to malfunction.
14. The light source of this luminaire is not replaceable; when the light source reaches its end of life the whole luminaire shall be replaced.
15. Not suitable for mounting on tubular material.

SPECIFICATION:

- USB input: 5V DC 2A
- LED wattage: Max. 10W

THE PACK INCLUDES`:

- a. 10 inches ring light
- b. 360° ball head mounting bracket
- c. Tripod stand
- d. Bluetooth Selfie remote control
- e. Reflection screen
- f. Phone clip set to assemble on the ring
- g. Phone clip set to assemble on the tube



INSTRUCTIONS FOR ASSEMBLY:

1. Take out the components from assembling pack.
2. First, take out the tripod stand. Loosen the third screw knob. Pull out the tripod stand. Adjust height to make the adjustable bracket at the horizontal position. It is the most stable position when the adjustable bracket at the horizontal position. Tighten the screw knob.
3. Loosen the first and second screw knobs to adjust the height you need.
4. Install the 360° ball head mounting bracket to the tripod stand.
5. Install the phone clip to the electrical ring. Please pay attention to the width scope of the clip.
6. Install the electrical ring with phone clip to the 360° ball head mounting bracket. You can loosen the screw knob on the 360° ball head mounting bracket to adjust the angle of the ring.
7. There is other phone clip which can be assembled on the tube if you want. Loosen the screw knob, open the tube clip, install it to the tube where you would like to place. Close the tube clip and tighten the screw knob to fix.

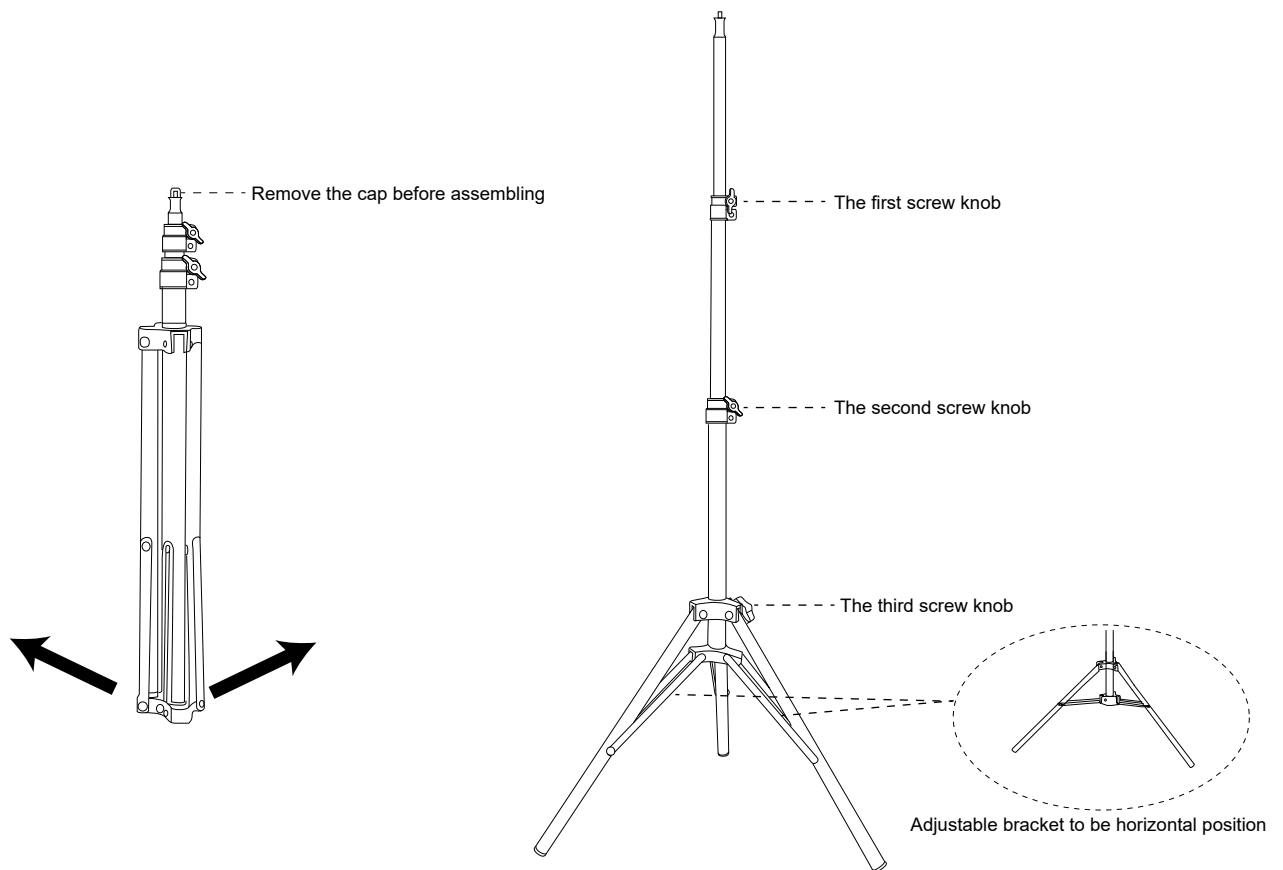

1. Take out the components from assembling pack. Remove the cap on the top before assembling. Loosen the third screw knob. Pull out the tripod stand. Adjust height to make the adjustable bracket at the horizontal position. It is the most stable position when the adjustable bracket at the horizontal position. Tighten the screw knob. Then loosen the first and second screw knobs to adjust the height you need. Then tighten the screw knobs to fix the height.

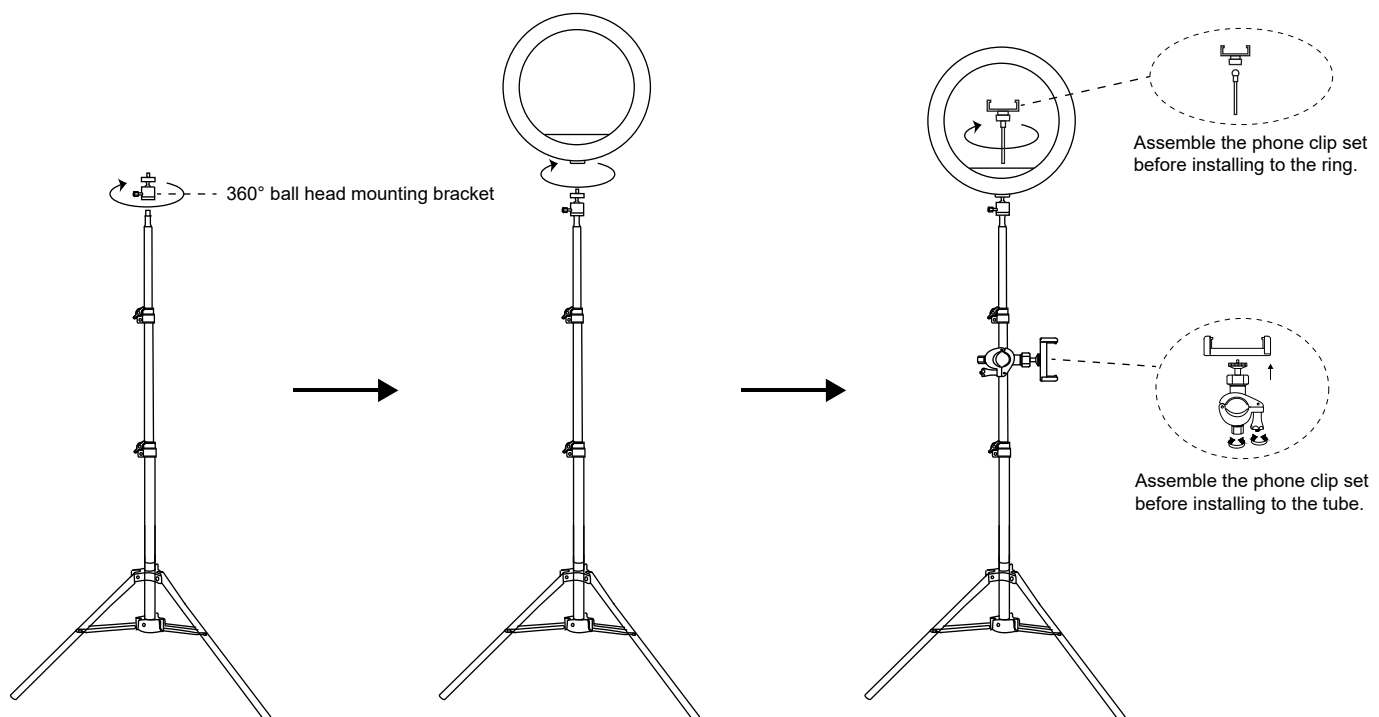

2. Install the 360° ball head mounting bracket to the tripod stand. Install the electrical ring light to the 360° ball head mounting bracket. You can loosen the screw knob on the 360° ball head mounting bracket to adjust the angle of the ring.

COMPONENTS USING INSTRUCTIONS:

Inline switch

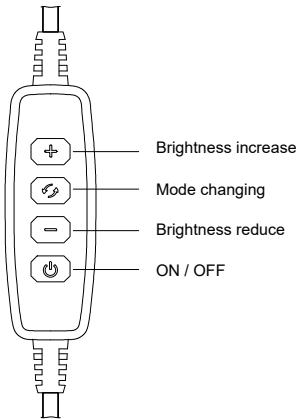

Bluetooth selfie remote control

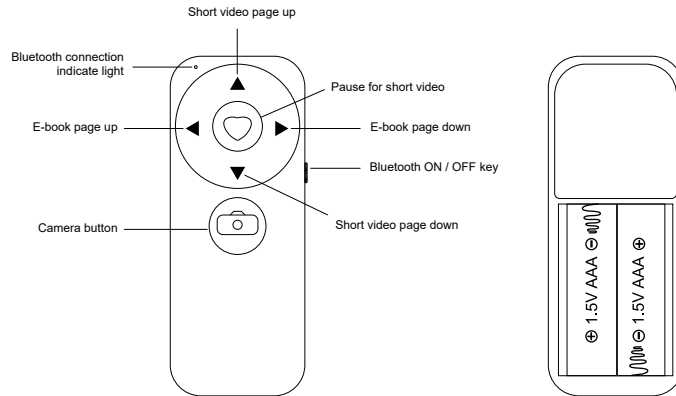

BLUETOOTH SELFIE REMOTE CONTROL WARNING

1. Do not dispose of unit in fire or water
2. Never attempt to disassemble and reassemble.
3. Waste electrical products should not be disposed of with household waste, please recycle where facilities exist.
4. Check with your local guthority for recucleadvice.
5. Keep your device and all accessories out of the reach of children and animals.
6. Small parts may cause choking or seriousinjury if swallowed.
7. Avoid exposing your device to very cold or very hot temperatures (below 0 C or above 45 C).
8. Extreme temperature can cause deforming of the device and reduce the charging capacity and life of your device.
9. Do not allow your device to get wet-liquids can cause serious damage.
10. Do not handle your device with wet hands.

- Please install 2 x 1.5V AAA batteries in Bluetooth selfie remote control before use.
- Push the ON/OFF key to ON, LED light will flash blue when ready to pair to your mobile.
- In the Bluetooth menu on your mobile phone, search for “anko 43351640” and connect.
- Indicator light will turn off after connected successfully.
- Press camera button to take selfie

Note: The indicator light will turn off and remote control will enter sleep mode. Press any button to re-activate the remote.

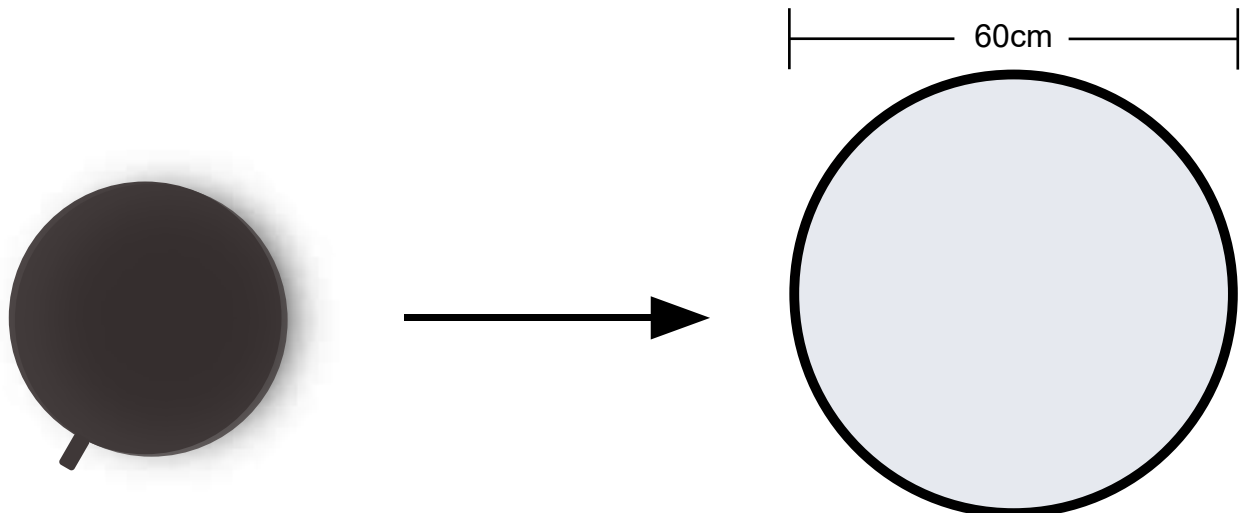

WARNING: OPEN THE REFLECTION SCREEN CAREFULLY. THERE IS STRONG ELASTIC FORCE DURING OPENING THE REFLECTION SCREEN. IT MAY HIT YOUR BODY.

Unfold and fold instructions :



Unfold instructions :



Fold instructions :

