

Battery and appliance disposal:

1. Eco-Friendly Tips

This appliance has a lithium battery. Batteries contain substances harmful to our environment, please do not dispose of the appliance containing batteries with the normal household waste, instead, hand it over to an official recycling point.

2. Trouble Shooting

Problem	Possible Cause	Solution
LED light is not bright enough or it does not work.	The battery is running low or is out of power.	Charge the appliance as guided.
Storage top light doesn't work.	Storage top light control switch does not work	Long press the touch ring active the mirror light is off to open the control gear of overhead light.
Mirror falls down when you want to put it at position.	The knob is loosen.	Bend the mirror a little forward to prevent the mirror falling down.

anko

K: 43-330-959 | T: 68-735-876

SLR-23222

LED STORAGE MIRROR INSTRUCTION MANUAL

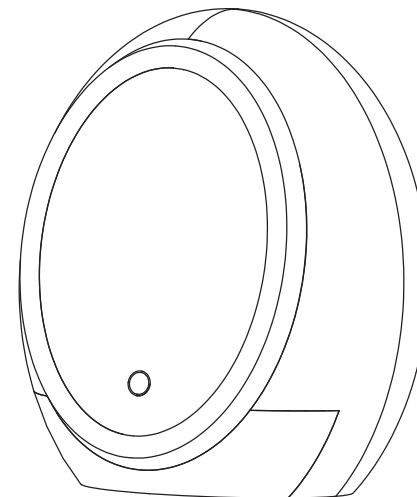

Safety Instructions:

To ensure proper operation of this appliance, please read this instruction manual carefully before you use the appliance and save it for further reference.

Specification:

- Charging Voltage / Current: 5V $\overline{\text{---}}$ / 1A Max. 5W
- Type of Battery: Li-ion 3.7V 2000mAh
- Ta: 25°C

Assembly Instructions:

- To charge, insert the supplied type C plug USB cable into the socket on the top of the body.
- Only charge the mirror with the supplied USB cable.

⚠ WARNING

- Check the appliance before you use it, do not use the appliance if it has any crack, gap or any other damage.
- Make sure the mirror is not in a place or in a position where it can reflect sunlight. Reflected sunlight can cause fire.
- Do not attempt to repair, disassemble, or modify the appliance by yourself to avoid accidents.
- The light source of this luminaire is not replaceable; when the light source reaches its end of life the whole luminaire shall be replaced.
- For indoor use only
- Maximum 1kg can be stored on tray.

⚠ CAUTION

- Avoid touching the mirror with sharp objects in order to prevent scratches that might affect the mirror usage.
- This appliance has a lithium battery. Do not place or store the appliance for long periods of time in a hot or humid environment. If you do not intend to use the appliance for a long time, store the appliance after it is fully charged.
- This appliance contains battery and LED lights that are non-replaceable.
- Ensure charging adapter used is compatible with a 5V / 1A rating.
- Please do not rotate mirror clockwise direction to open storage. Anti-clockwise direction to open only.
- Please do not over rotate the mirror more than 180 degree.

Cleaning & Maintenance:

- Turn the appliance off before you start cleaning it.
- Do not immerse the appliance in water. Clean the appliance surface with a dry cloth or with a cloth moistened with water.
- Do not use any lubricant, detergent, polishing agents, alcohol, steel wool, abrasive cleansers, chemicals or corrosive liquids on this appliance.

Product Description:

- ① Flat mirror
- ② Touch ring
- ③ Storage drawer
- ④ Plastic body
- ⑤ Charging port
- ⑥ USB cable

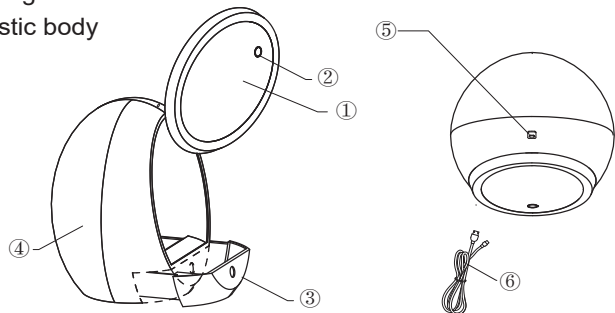

Using the Appliance:

For better use experience, please read below instructions carefully:

1. This appliance needs to be charged if the light ray is not bright enough. Please use 5V DC 1A adaptor(not included) to charge.
2. Charging the appliance takes about 5 hours, and it can be used continuously for up to 3 hours for the most bright status.
3. The charging indicator (at top of the product) will be red while the mirror is charging and will change to green, when fully charged.
4. When the mirror light is off, long press the touch ring for 3 seconds to turn on the control of the internal overhead light. Rotate the mirror in anti-clockwise direction to a position of about 45°, the internal overhead light is on.
5. To use the mirror light, touch the white ring on the mirror. Touch sequentially to change the colour of the light. There are three colours of this product, cool white, warm white and natural white. You can select the colour what you like.
6. The mirror light can be stepless dimming with long press when mirror light on. And the brightness can be memorised at the stage when turned off the light.
7. Please do not rotate the mirror in clockwise direction.
8. Rotate the mirror to the position you want, bending the mirror a little forward to prevent the mirror fallen down.

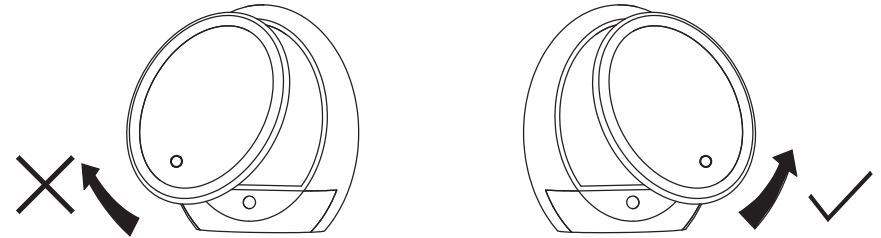

Please do not rotate the mirror in clockwise direction. Just rotate the mirror in anti-clockwise only and not over rotate more than 180°.

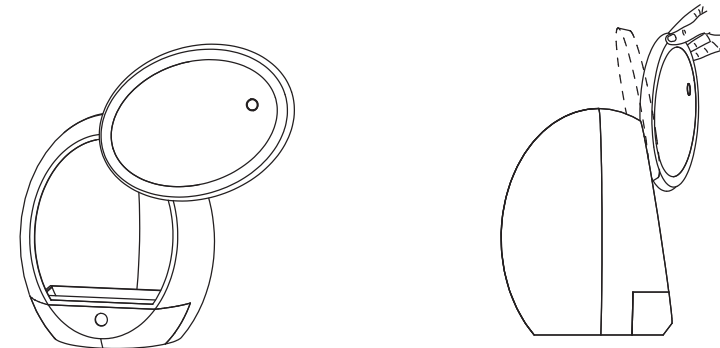

Rotate the mirror to the position you want, bending the mirror a little forward to prevent the mirror falling down.