

INSTRUCTION MANUAL

43233465

BLACK

[KMT088]

43233465_MAN_True Wireless Buds with ENC_v1

Artwork Proof Date: 07.11.2022

PAPER:

80gsm
Bright white uncoated paper

PRINT COLOURS:

BLACK

C:0 M:0
Y:0 K:100

PRINT FINISH:

Double sided
Single Fold

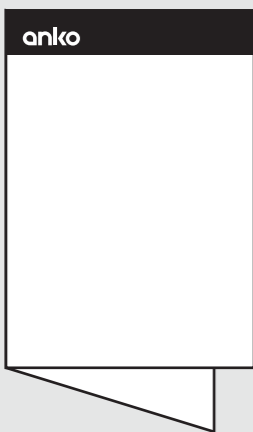

CHANGE LOG CREST INTERNAL USE ONLY

V1 PRODUCT IMAGE CHANGED FROM
PUSH BUTTON TO TOUCH BUTTON

ARTWORK SHOULD NOT BE AMENDED WITHOUT PRIOR AGREEMENT FROM CREST.
ALL ARTWORK MUST BE APPROVED BY CREST PRIOR TO MASS PRODUCTION.

IF THERE ARE QUERIES ABOUT THIS ARTWORK PLEASE CONTACT:
EMAIL: design@crest.com.au

THANK-YOU.

FRONT

12 month warranty

Thank you for your purchase from Kmart.

Kmart Australia Ltd warrants your new product to be free from defects in materials and workmanship for the period stated above, from the date of purchase, provided that the product is used in accordance with the accompanying recommendations or instructions where provided. This warranty is in addition to your rights under the Australian Consumer Law.

Kmart will provide you with your choice of a refund, repair or exchange (where possible) for this product if it becomes defective within the warranty period. Kmart will bear the reasonable expense of claiming the warranty. This warranty will no longer apply where the defect is a result of alteration, accident, misuse, abuse or neglect.

Please retain your receipt as proof of purchase and contact our Customer Service Centre on **1800 124 125 (Australia)** or **0800 945 995 (New Zealand)** or alternatively, via Customer Help at **kmart.com.au** for any difficulties with your product. Warranty claims and claims for expense incurred in returning this product can be addressed to our Customer Service Centre at 690 Springvale Rd, Mulgrave VIC 3170.

Our goods come with guarantees that cannot be excluded under the Australian Consumer Law. You are entitled to a replacement or refund for a major failure and compensation for any other reasonably foreseeable loss or damage. You are also entitled to have the goods repaired or replaced if the goods fail to be of acceptable quality and the failure does not amount to a major failure.

For New Zealand customers, this warranty is in addition to statutory rights observed under New Zealand legislation.

Note: Please remove insulation film from the charging terminals and charge the earphones and case before use.

WARNING Do not dispose of unit in fire or water. > Never attempt to disassemble and reassemble. > Waste electrical products should not be disposed of with household waste, please recycle where facilities exist. > Check with your local authority for recycle advice. > Keep your device and all accessories out of the reach of children and animals. > Small parts may cause choking or serious injury if swallowed. > Avoid exposing your device to very cold or very hot temperatures (below 0°C or above 45°C). > Extreme temperatures can cause deforming of the device and reduce the charging capacity and life of your device. > Do not allow your device to get wet—liquids can cause serious damage. > Do not handle your device with wet hands.

The Bluetooth® word mark and logos are registered trademarks owned by Bluetooth® SIG, Inc., and any use of such marks by KMART AUSTRALIA is under licence.
iPhone, iPad and Mac is a trademark of Apple Inc., registered in the U.S. and other countries.



anko

True Wireless Buds with ENC Operating instructions



Includes:

- > charging case, earbuds
- > USB-C charging cable
- > small, medium & large replacement eartips

43-233-465

Bluetooth name is KM43233465

BACK

CAUTION > The batteries in this product are not replaceable. > During use, storage or transportation the battery should not be subjected to extremely low temperatures, or low air pressure at high altitude. > If the battery is exposed to extremely high temperatures it could result in an explosion or the leaking of flammable liquid or gas. > Please take care when disposing of the unit; disposal in a fire, oven, mechanically crushing or cutting machine could cause explosion.

Product overview

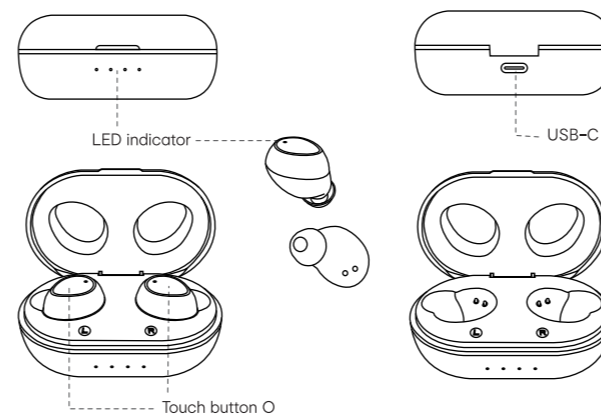

Earphone Function Operation

Pause: Press either O button

Play: Press either O button

Next Track: Press the right O button twice in quick successions

Previous Track: Press the left O button twice in quick successions

Volume Up: Press the right O button 3 times in quick successions

Volume down: Press the left O button 3 times in quick successions

Answer Call: Press either O button

Reject Call: Press and hold either O button for 2 sec.

End call: Press either O button twice in quick successions

Activating Phone Assistant: Press and hold either O button for 2 seconds and release your hand.

Power ON/OFF and Pairing

- > Take both earphones out from the charging case to turn on the earphones.
- > Once the earphones are powered on, they will enter sync mode quickly and move to pairing mode with LED indicators flashing blue and red.
- > Search the Bluetooth list with pairing name **KM43233465**.
- > Click to pair with your Bluetooth device. LED indicators will automatically turn off until the earphone connected with Bluetooth device successfully.
- > Put the earphones into the charging case to turn them off.
- > Manually Power ON/OFF earphone without charging case, you can press and hold earphones button for 5 seconds.

Charging the Case

- > Connect the USB-C charging cable into the Charging Case. Make sure USB-A into a standard USB 5V/1A output to avoid any damage.
- > LED indicator will flash blue while the case is in charging. Blue light will stay on when it fully charged.

Charging the Earphones

- > Put both Earphones into the Charging Case, make sure charging pins fully connected.
- > LED indicator will stay red while earphones are in charging. When they are fully charged, LED indicator will turn off after 10 seconds of blue light.

Safety instructions

- > Earphones built-in rechargeable battery, before using them the first time, we recommend you fully charge the battery.
- > To ensure the battery life, the Earphones and Charging Case should be charged normally once a month.
- > If the Earphones fail to connect to Bluetooth device, put the earphones into the charging case to turn them off. Make sure both earphones are fully connected with the charging pin, turn off Bluetooth in your device. Try to turn on the earphones and then repeat the pairing process.
- > The Earphones can be used with the provided Charging Case only.

Specifications

Model Number: 43233465

Bluetooth version 5.3

Driver Size: 8mm

Impedance: 32Ω

Sensitivity: 100dB ± 3dB at 1kHz

Transmission Distance: 10m

Charging voltage: DC 5V

Charge time (Earphones): 1.5 hours

Charge time (Charging Case): 2 hours