

BABY BOUNCER

INSTRUCTION MANUAL

0-6
months

9
kg

MAXIMUM
WEIGHT OF CHILD

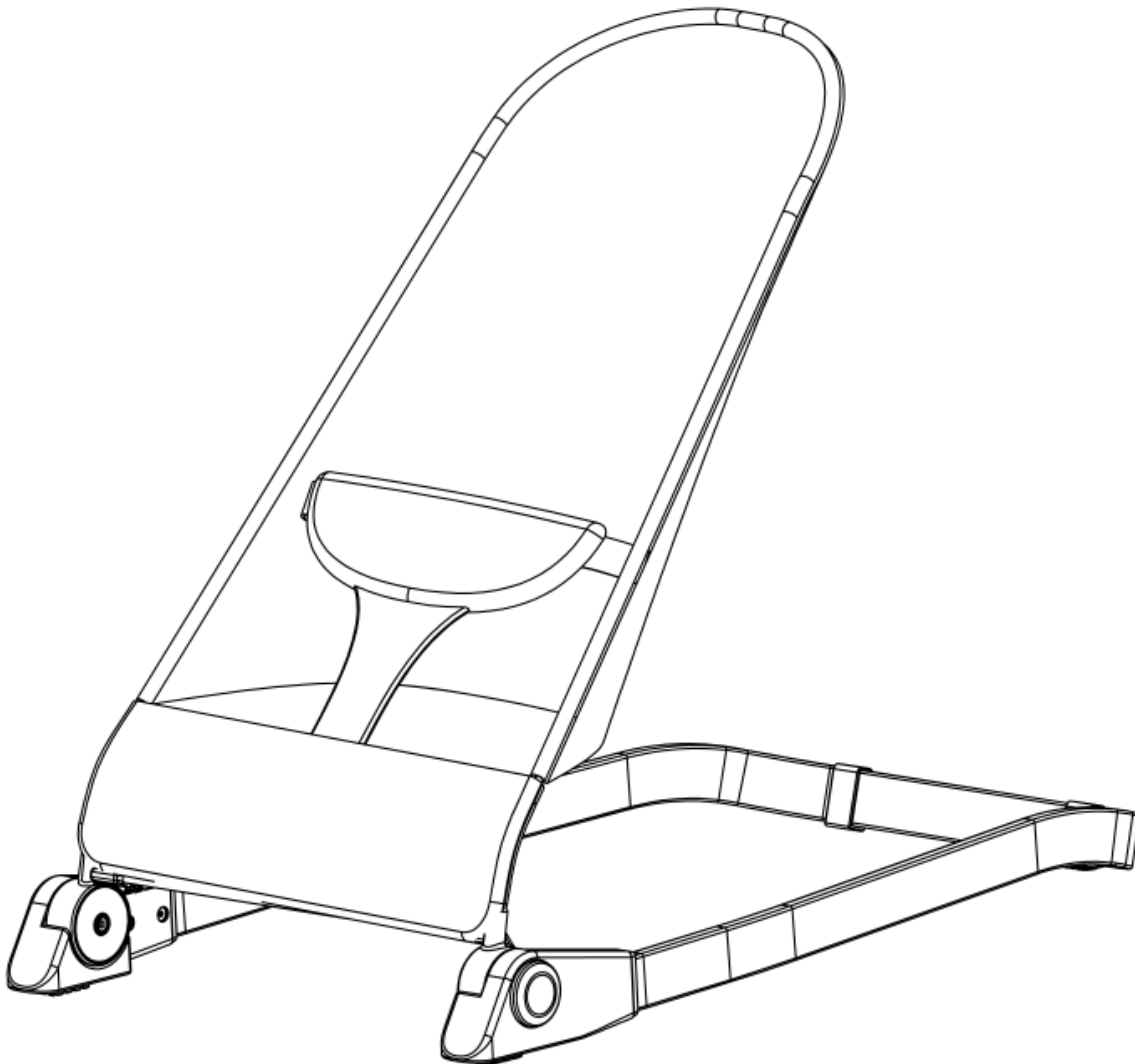

The photos and illustrations shown in this instruction manual are generic.
The manufacturer reserves the right to change any specification or feature without prior notice.

IMPORTANT: KEEP FOR FUTURE REFERENCE. READ CAREFULLY.



WARNING:

RETAIN FOR FUTURE REFERENCE.

READ ALL INSTRUCTIONS CAREFULLY BEFORE ASSEMBLY AND USE OF THIS BOUNCER.

CARE SHOULD BE TAKEN IN UNPACKING AND ASSEMBLY.

ALWAYS FOLLOW THE INSTRUCTIONS.

THE CORRECT USE AND MAINTENANCE OF THIS PRODUCT IS ESSENTIAL.



WARNING



This product is suitable for one child from birth or a maximum weight of 9kg.

This item has 2 backrest positions. The first position is used with a maximum weight of 6kg, and the highest position is used with a maximum weight of 9kg. The lowest position is used for folding only. Do not place baby in this position.

WARNING! Follow the manufacturer's instructions.

WARNING! Prevent serious injury or death.

WARNING! NEVER leave the child in the bouncer without supervision.

WARNING! ALWAYS use the restraint system ensuring it is correctly adjusted at all times.

WARNING! NEVER use for a child who is able to sit up unaided.

WARNING! Do not attempt to move or lift the product when a child is in it.

WARNING! FALL HAZARD: Child's activity may move product. Use only on the floor. Never use on an elevated surface.

WARNING! SUFFOCATION HAZARD: Never use on a soft surface (bed, sofa, cushion etc), as the product may tip over and cause suffocation.

- Do not use the bouncer if any part is broken, torn or missing.
- Before using, check that all parts are properly locked into position and adjusted correctly.
- Check the suspension system of the bouncer regularly.
- Only use a 3 point safety harness.
- Do not use the bouncer without its seat liner.



WARNING:

- This product is not intended for prolonged periods of sleeping.
- This product does not replace a cot or a bed. Should your child need to sleep, then it should be placed in a suitable cot or bed.
- The bouncer is not a carrycot, nor a car seat. Always use the safety harness and ensure to adjust it to safely secure baby.
- Do not adjust the height position with baby in the bouncer.
- Do not use near an open fire or any other kind of heater or heat source.
- Keep the plastic bags of the packaging out of reach of babies and young children to avoid any risk of suffocation.
- Never add any pillows, blankets or padding to the bouncer.
- Do not place objects with strings around the neck of your baby. Do not hang strings from the bouncer or attach string to toys. This could lead to strangulation.
- Do not place the bouncer close to a window where the strings of blinds or curtains could lead to strangulation.
- Do not allow your baby to play with the bouncer in the folded position.
- Do not attach toys other than those supplied (if applicable).
- NEVER place a child over 9kg in the bouncer.
- Discontinue use of the product should it malfunction or become damaged.
- Do not use this product if any components are broken, torn or missing.
- Only use authorized additional replacement parts. Do not use accessories or replacement parts other than those supplied by the manufacturer.
- Keep children away from the product during assembly and when not in use.
- Do not let other children play unattended near the product.
- Adult assembly required.

This product conforms to EN 12790:2009

UNFOLDING

For ease of use, the bouncer comes assembled in the box.

Pull up the backrest of the bouncer with your hand.

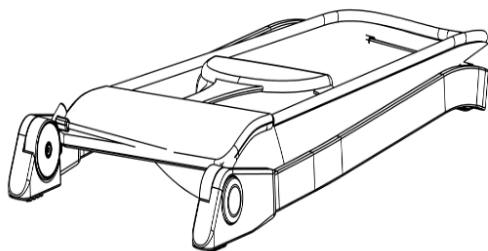

The backrest is secured in position when you hear a "Click."

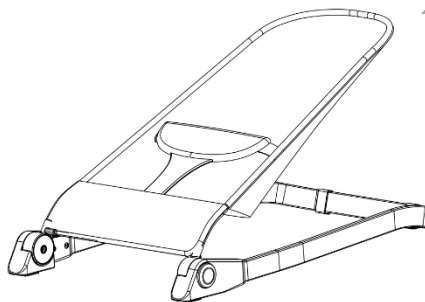

FOLDING

Push both buttons at each side at the bottom of the frame simultaneously to fold.

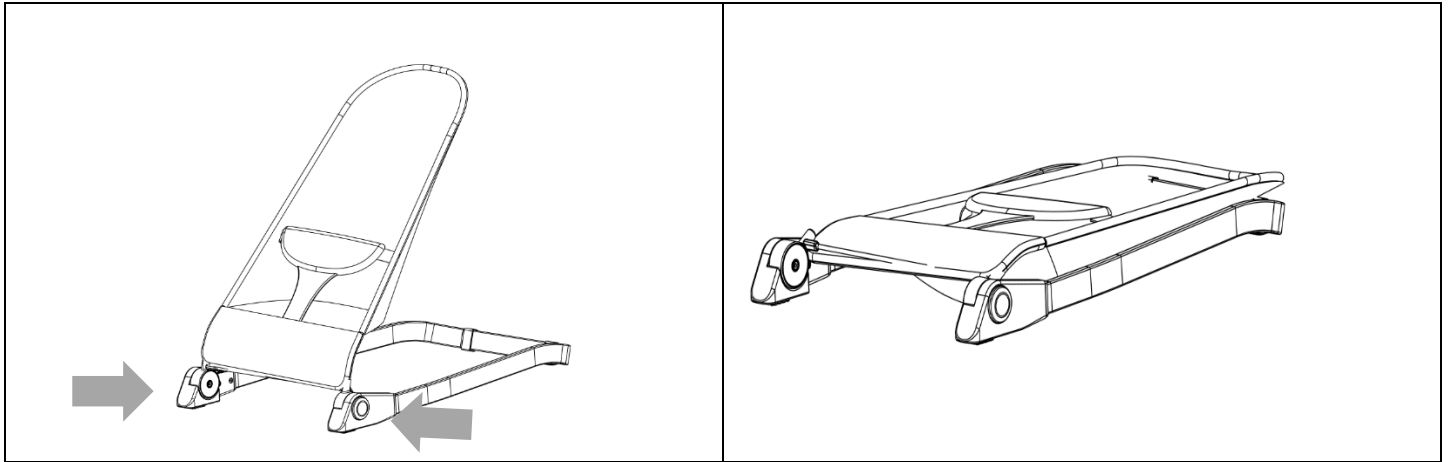

BACKREST ADJUSTMENT

Using the head end of the bouncers headrest, pull up the backrest into the desired height position. The bouncer is in position when you hear a "Click" sound.

To move from the 2nd position to the 3rd position, simply pull up on the head of the bouncer and "Click" into position.

However, if the bouncer is in position 3 and you wish to select height of position 2 or collapse the bouncer, push the 2 buttons located at the bottom of the frame simultaneously into the desired position.

Once the height position is fixed, then you may place the baby in the bouncer.

Do not adjust the height position with baby in the bouncer.

WARNING:

Position 1: Fold only position. Do not place baby in this position.

Position 2: Maximum weight of child is 6kg.

Position 3: Maximum weight of child is 9kg.

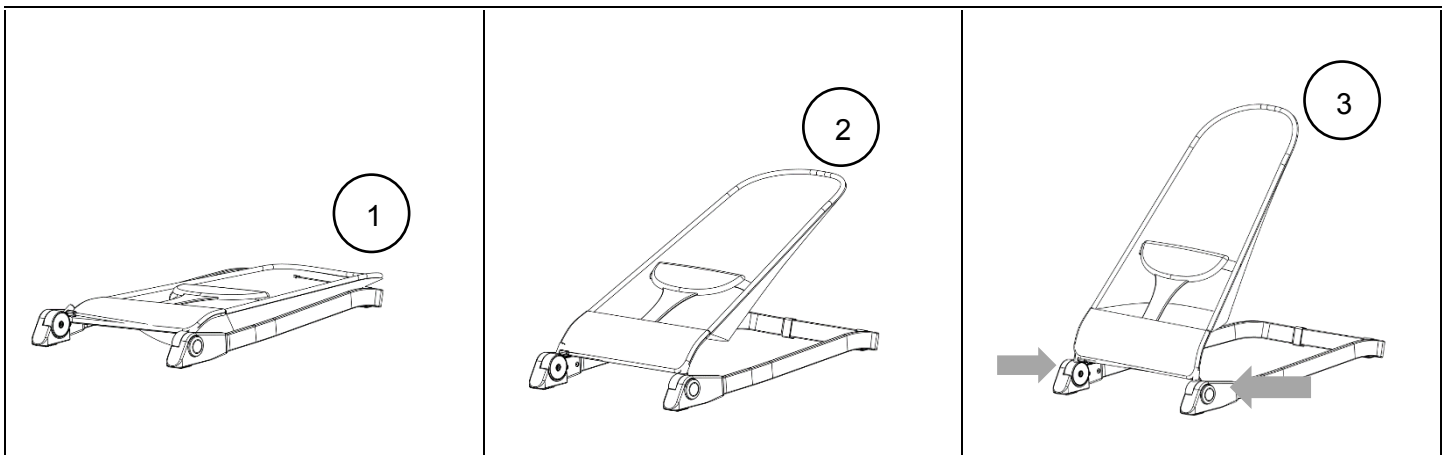

SECURING BABY

Use the 3 point safety harness to secure the baby in the bouncer.

1. Unbuckle both sides of the crotch and place baby in the bouncer.

2. Buckle up both sides of the harness. You will hear a "Click" at both ends when the harness is correctly fitted.

Tighten the strap to secure the baby in the bouncer.

WARNING:

ALWAYS use the restraint system.

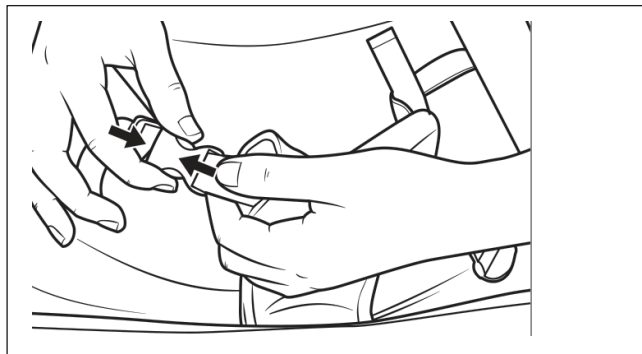

CARE AND MAINTENANCE

- All assembly fittings are to be tightened properly. Inspect regularly and re-tighten as necessary.
- The fabric cover is removable for easy cleaning.
- Wipe with a damp cloth.
- Delicate cold hand wash if required.
- Do not bleach.
- Do not tumble dry.
- Do not iron.
- Do not dryclean. ☒
- Dry thoroughly before re-use or storage.
- Clean metal and plastic components with mild detergent and warm water.
- Never use abrasive pads, ammonia based, bleach based or spirit type cleaners.
- Store product in a dry location away from any heat sources and direct sunlight.

KEYCODE: 43-142-774

MADE IN CHINA

© KMART AUSTRALIA LIMITED

FOR AU / NZ: IMPORTED FOR KMART STORES IN AUSTRALIA AND NEW ZEALAND.

KMART AUSTRALIA - 690 SPRINGVALE ROAD, MULGRAVE, VIC 3170 AUSTRALIA.

KMART NEW ZEALAND - REGIONAL OFFICE C/O KMART PAPATOETOE STORE,
HUNTERS PLAZA, GREAT SOUTH ROAD, PAPATOETOE, AUCKLAND, NEW ZEALAND.

KMART CUSTOMER SERVICE:

AU: 1800 124 125

NZ: 0800 945 995