

anko

18^{kg}
39.7^{lb}

**MAXIMUM
WEIGHT**

WOODEN COT INSTRUCTION MANUAL



Drawings in the manual are for visual purposes only. Actual product may vary slightly.
The manufacturer reserves the right to change any specification or feature without prior notice.

IMPORTANT. KEEP FOR FUTURE REFERENCE. READ CAREFULLY.

Read these instructions carefully before use and keep for future reference. The child may be hurt if you do not follow these instructions.

Supplied loose in box



End Panel
x2



Side Panel
x2



Mattress Base
x2



Filler Bolt and Nut
(Pre-assembled)



35mm / 1.4in Bolt
x12



Allen Key
x1

- It is advisable that two people assemble the cot in the room in which it is to be used.
- As small parts are involved in assembly, children should be kept clear of the assembly area.
- Dispose of all packaging material immediately after the cot is assembled.
- Identify all parts and components.
- Clear an area on the floor for assembly and place a sheet on the floor to ensure the cot is not scratched during assembly.



**DO NOT OVER TIGHTEN BOLTS. OVER TIGHTENING
BOLTS CAN CAUSE PANELS TO CRACK.**

To assemble Cot



- 1 Attach both End Panels to one Side Panel using 4 x 35mm / 1.4in Bolts

Do not tighten bolts completely.



- 2 Cot should now resemble photo above.

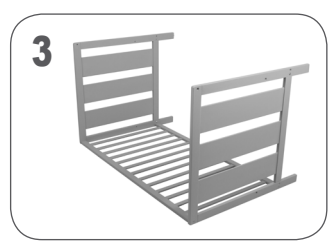

- 3 Carefully lay the cot down on the Side Panel.

NOTE: Ensure that the bolt recesses are facing out.

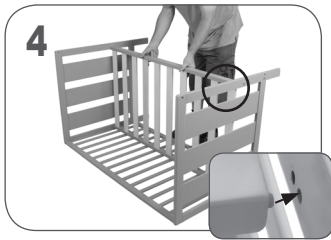

- 4 Slide the Mattress Base between the End Panels.

Ensure the pre-assembled dowel in the Mattress Base correctly inserts into the pre-drilled dowel hole in the End Panel.

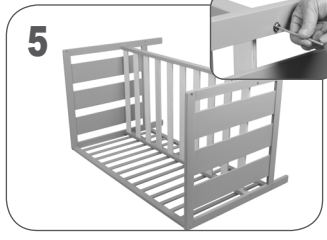

- 5 Secure the Mattress Base using 4 x 35mm / 1.4in Bolts.

Do not tighten completely.



- 6 Carefully stand the cot upright.

⚠ WARNING:
MATTRESS BASE
'THIS SIDE UP' LABEL
MUST BE FACING
UPWARD WHEN
MATTRESS BASE IS
INSTALLED



- 7 Attach the remaining Side Panel between the End Panels using 4 x 35mm / 1.4in Bolts.

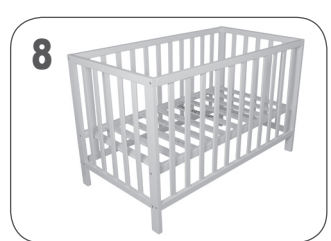

- 8 Tighten all bolts until firm.
Do not over tighten bolts. Over tightening bolts can cause panels to crack.

The cot is now ready for use in high base mode.

Mattress Base Heights



Mattress Base in High Position

The base height is set for when your baby is young and can not sit up unaided.



Mattress Base in Low Position

This is the normal position for an active baby who can sit up unaided.

To adjust Mattress Base Height

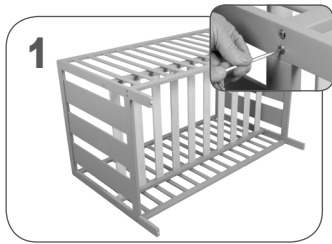

- 1 Carefully lay the cot down on the Side Panel.
Remove the 4 x Filler Bolts and Nuts from the lower base position on the End Panels.

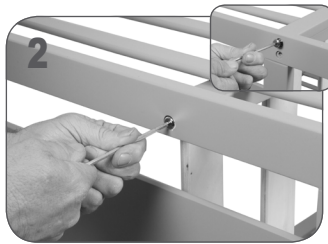

- 2 Remove 4 x 35mm / 1.4in Mattress Base Bolts.
Loosen the bolts of one End Panel.

NOTE: Loosening the bolts of one end panel will assist in avoiding any scratches or dents to your Cot whilst sliding the mattress base down to the lower position. If end panel bolts are loosened during this process, ensure they are re-tightened after you have moved the mattress base.

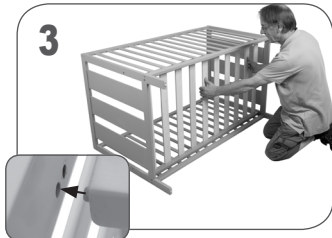

- 3 Carefully slide the Mattress Base to the lower position.
Ensure the pre-assembled dowel in the Mattress Base correctly inserts into the pre-drilled dowel hole in the End Panel.



- 4 Secure the Mattress Base using 4 x 35mm / 1.4in Bolts.
Tighten until firm.



- 5 Refit 4 x Filler Bolts and Nuts to the upper Mattress Base Mounting Holes to prevent possible finger entrapment.



- 6 Carefully stand the cot upright.
Check all Bolts are tightened until firm.
Do not over tighten bolts. Over tightening bolts can cause panels to crack.

The cot is now ready for use in low base mode.

WARNING:

ADULT ASSEMBLY REQUIRED:

DUE TO THE PRESENCE OF SMALL PARTS DURING ASSEMBLY, KEEP OUT OF REACH OF CHILDREN UNTIL ASSEMBLY IS COMPLETE.

TO PREVENT FALLS, THE MATTRESS BASE OF THIS COT SHOULD BE ADJUSTED TO THE LOWEST POSITION BEFORE THE CHILD CAN SIT UP.

RECOMMENDED MATTRESS SIZE:

690mm / 2.3ft WIDE x 1300mm / 4.3ft LONG AND NO MORE THAN 150mm / 5.9in THICK.

FOLLOW THE MANUFACTURER'S ASSEMBLY INSTRUCTIONS TO ENSURE THE SAFETY FEATURES OF THE COT ARE NOT COMPROMISED.

This cot has been manufactured for one child only, with a maximum weight of 18kgs / 39.7lb.

When the mattress base is assembled in the lower position, ensure the higher cot base holes are covered tightly with the filling bolts supplied. This is to prevent finger entrapment, swallowing and inhalation hazards.

ENSURE the cot is placed at a reasonable distance from curtains, blinds, heaters and power points.

ENSURE the cot is completely assembled and check that all parts are securely tightened before placing the child into the cot.

ENSURE medication, string, elastic, small toys or small items such as money etc are always kept out of the child's reach when in the cot.

DO NOT over tighten bolts/screws.

ENSURE that the child is clear of any moving parts when adjusting the cot.

For warranty purposes, keep your sales receipt to provide proof of purchase.

RECOMMENDED MATTRESS SIZE (SOLD SEPARATELY):

THIS COT HAS BEEN MANUFACTURED FOR USE WITH A MATTRESS WHICH MEASURES 690mm / 2.3ft WIDE x 1300mm / 4.3ft LONG AND NO MORE THAN 150mm / 5.9in THICK.

The width and length are specified because it is important that the gaps between the mattress and the sides and ends of the cot will not exceed 40 mm / 1.6in when the mattress is pushed to one side or end, and 20mm / 0.8in when the mattress is centred in the cot.

This is to minimise the danger of a child's limb becoming caught in the gap.

The thickness of the mattress has been specified to ensure that the depth of the cot is greater than 500mm / 1.6ft with the mattress base in the lower position and is greater than 300mm / 1ft with the mattress base in the upper position to minimise the risk of a child climbing or falling out of the cot.

CARE AND MAINTENANCE:

- To ensure the long-lasting use of your cot, wipe down with a damp cloth and use a mild soap solution if necessary.
- Do not use abrasive cleaners.
- Always store product in a clean dry place.
- Always check parts regularly for tightness of screws, nuts and other fasteners – tighten or replace if required.
- To maintain the safety of your cot, seek prompt repairs for bent, torn, worn or broken parts.
- Use only those parts and accessories approved and supplied by the manufacturer.

Keycode: 42836933

MADE IN CHINA

FOR AU / NZ: IMPORTED BY KMART
STORES IN AUSTRALIA AND NEW ZEALAND.

KMART AUSTRALIA - 690 SPRINGVALE ROAD, MULGRAVE, VIC 3170
AUSTRALIA.

KMART NEW ZEALAND - REGIONAL OFFICE C/O KMART PAPATOETOE
STORE, HUNTERS PLAZA, GREAT SOUTH ROAD, PAPATOETOE,
AUCKLAND, NEW ZEALAND.

FOR USA: IMPORTED BY ANKO RETAIL INC.
19500 ALDERWOOD MALL PARKWAY
LYNNWOOD WA 98036 USA.