



Battery Operated Ride-On Vehicle

INSTRUCTION MANUAL & USER GUIDE

**Keycode: 42640264
KL-40050C**



⚠ WARNING: Adult Assembly Required

Please read this manual carefully before assembly and use. This manual contains safety instructions and important information which will help you assemble the unit. Please keep this manual for future purposes.

Vehicle / Battery Specifications:

1. Age: 2-4 years .
2. Maximum weight: 25kgs.
3. Speed: about 2km/h.
4. Power source: 6V-1.3AH.
5. Power input for Charger: A/C 100-240Volt 60Hz.
6. Power output for Charger: DC 7.5V/350mA.
(Use only with provided switching adaptor JT-DC7.5V2.63W-K).

CHARGING CAUTIONS:

- Charging the battery should only be done by adults.
- The charger is not a toy. Do not allow children to play with the charger or to recharge the battery.
- Turn the F/B switch to neutral position when charging.
- Before the first use, you should charge the battery for 8-10 hours. Do not charge the battery for more than 16 hours to avoid overheating the charger.
- It is normal for the charger to feel warm during charging. If the charger feels very hot, stop charging, unplug the charger and check the battery and charger.
- Use the charger in dry locations only.
- Regularly check the charger, battery and their connectors for excessive wear or damage each time you charge the battery. If damage or excessive wear is detected, do not use the charger or the battery until you have replaced the worn or damaged part.
- Only use the charger specified by the manufacturer.

 **WARNING** - Risk of fire. Do not by-pass fuse. Replace only with the correct amperage fuse.

 **WARNING:**
To reduce the risk of injury, adult supervision is required.
Never use on roadways, near motor vehicles, on or near steep inclines or steps, swimming pools or other bodies of water. Always wear shoes and never allow more than 1 rider.

 **WARNING:**
Choking Hazard! Contains small assembly components that are small parts with functional sharp point and edges.

 **WARNING:**
Adult assembly required

 **WARNING:**
Protective equipment should be worn.
Not to be used in traffic

Trouble Shooting Tips:

Problem: The vehicle does not turn on

If the car is not functioning at all please follow these troubleshooting steps listed below. After each step, please put the car in forward gear and step on the pedal to see if the car will move.

1. **Charger:** Unplug the charger completely from the car. The car will not work if the charger is plugged in to the car.
2. **Battery Connection:** Check the positive and negative wire to see if they are properly connected. You may also pull lightly on each wire to see if they are connected.
3. **F/B Switch:** Pull the switch out and you should see wires running into the back of the switch. Use your hand and push each individual wires into the socket. Push each individual wires into the switch and see if it runs.
4. **Foot Pedal Switch:** Remove the 2 screws on the foot pedal cover and open the cover, you will see the foot pedal switch. Use your hands to push each individual wires into the switch and see if it runs.
5. **Motor Connection:** The motor is located on the rear right side of the vehicle. You will see white plastic connectors, please check if the connectors are well connected, you may unplug the connectors and reconnect them.

Problem: The vehicle runs slowly

If the car is not functioning at its normal speed, please recharge the battery for another 8 to 10 hours.

Manufactured by:

Kalee Children's Products Co., Ltd. Quanzhou
Wuli Industrial Zone, Jinjiang, Fujian, China
www.kalee.com

Made in China

BATTERY SAFETY WARNING:

- Only use the battery and charger supplied by the manufacturer.
- Do not connect the battery terminals directly together. This will cause the battery to short-circuit.
- Never short-circuit the battery terminals or modify the electrical system. Alterations may cause a fire resulting in serious injuries.
- Do not mix old and new batteries or batteries of different types.
- Remove batteries during long periods of non-use. Always remove batteries from the product. Dispose of batteries safely. Do not dispose of batteries in fires. The batteries may explode or leak.
- Recharge the battery fully before storage, then full charge it every 3 months to extend the life of the battery.
- Only use the battery specified by the manufacturer.

Caution:

The ride on vehicle is equipped with a built-in thermal circuit breaker. The thermal circuit breaker is a self-resetting safety device which automatically "trips" and shuts down the operation of the vehicle if it is overloaded or the driving conditions are too severe. Once the circuit breaker has tripped it will automatically reset itself after approximately 25 seconds and allow the rider to resume normal operation.

Safety Precautions:

- Adult supervision is required at all times.
- Adults must teach their children about safe driving procedures.
- The toy should be used with caution since skill is required to avoid falls or collisions causing injury to the user or third parties.
- Check the seat to ensure it has been fitted and secured with a bolt before driving.
- Inspect all wires and connections of the vehicle periodically.
- Use the toy only on flat surfaces, such as sidewalks, driveways or playgrounds. Do not ride the vehicle in dangerous places such as busy streets, roads, highways, swimming pools and other bodies of water, in a dark area, hilly muddy or sandy areas.
- To avoid suffocation of children please destroy all plastic bags after assembly of the vehicle.
- Do not use this vehicle outdoors when it is raining.
- Don't allow children to operate the charger or play with the battery.
- Transformers and power supplies for toys are not intended to be used as toys, and the use of these products by children shall be under the full supervision of parents.

- Do not exceed the recommended weight limit of 25kg / 55 lbs. Please follow the correct weight and age limit allowed to drive this vehicle.
- It is prohibited to change the circuit or add other electric parts.
- Always wear a helmet when riding.
- It is not recommended to drive this vehicle on wet surfaces or on slopes greater than 15 degrees.
- Make sure you come to a complete stop before changing directions from forward to reverse.
- Please turn the power off when not in use.
- In order to avoid accidents, please ensure the vehicle is safe before driving.
- Do not let any child touch the wheels or be near them when the vehicle is moving.
- The charger used for the vehicle is to be regularly examined for damage to the cord, plug, enclosure and other parts, and in the event of such damage, they must not be used until that damage has been repaired.
- Clean the vehicle only with a damp cloth and never submerge vehicle in water or spray with water directly from a hose.
- Always wear a helmet, knee & elbow pads and shoes when riding.
- Children must have adult supervision.
- Colours and contents may vary from image shown.
- Where applicable, remove all packaging before giving this item to your children.

Maintaining your vehicle:

- Please keep information for future reference.
- It is a parents responsibility to check main parts of the vehicle before use. Regularly examine the vehicle for potential hazards, such as the battery, charge cable, cord and plug. Ensure screws are tightened. If there are any damages, the vehicle must not be used until these damages have been properly repaired or replaced.
- Occasionally use a lightweight oil to loosen moving parts such as the wheels and steering linkages.
- Keep the vehicle in an upturned position, do not overturn or incline it. It is recommended to store the vehicle indoors when not in use. If stored outdoors, the vehicle needs to be covered by a tarp for protection against weather elements.
- This appliance is not intended for use by young children or infirm persons unless they have been adequately supervised by a responsible person to ensure that they can use the appliance safely.
- Young children should be supervised to ensure that they don't play with the appliance.

Operation of the Vehicle:

1. Make sure the battery is fully charged and the motor plug is connected to the battery plug.
2. Locate the direction switch to the front body. Press the direction switch to "F" and press the accelerator pedal, vehicle will move forward.
3. To stop the vehicle remove foot from accelerator pedal. When stopped press the direction switch to "B" then press the accelerator pedal, vehicle will move backward.

NOTE: Do not change directions while vehicle is in motion.

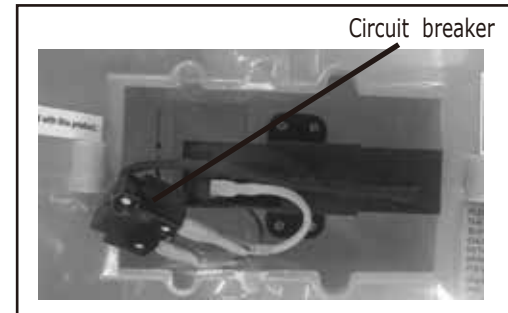

Please undo the prefixed screw from the back of the seat. Connect the long white plug to the motor. Connect the loose Red Plug to the terminal of breaker box. Install the seat and tighten with screw.

Charging the Battery:

- The socket for charging the battery is located near the seat.
- Connect the charger plug into the DC jack, then plug the charger into a household outlet.
- Charge the battery for 8-10 hours. Never charge more than 16 hours.
- When the battery is fully charged, unplug the charger and store it in a cool and dry place.

Note: The car can not be operated when the charger is connecting to the car.



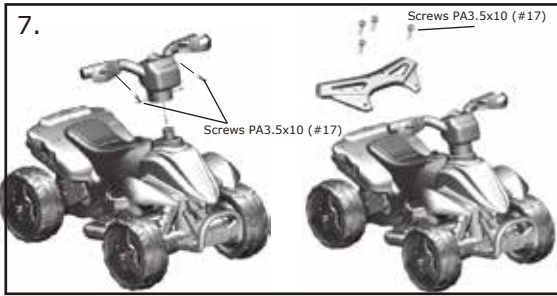

7. Place the handlebar (#7) on the front fork assembly, secure with screw PM5x47 (#14) and M5 nut (#13). Attach the right handguard (#15) and left handguard (#16) on the handlebar, secure with 2pcs of PA3.5x10 screws (#17). Attach the rear bumper (#12) to the rear of the body, and secure with 4pcs of PA3.5x10 screws (#17).

How to replace the battery and fuse:

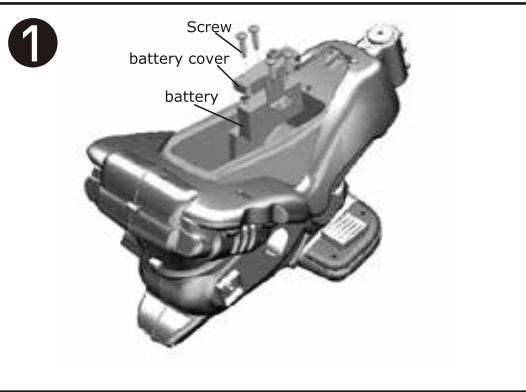

1. Battery is located under the seat. Undo the 4 screws on the battery cover and remove the battery cover, then disconnect the two plugs, replace the old battery with new one, then connect the plugs, red to red, black to black.

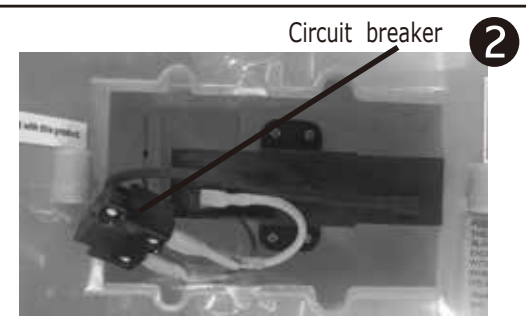

2. The circuit breaker is also located under the seat. Disconnect the two plugs on the circuit breaker, replace the old circuit breaker with new one, then connect the two plugs.

Parts List:

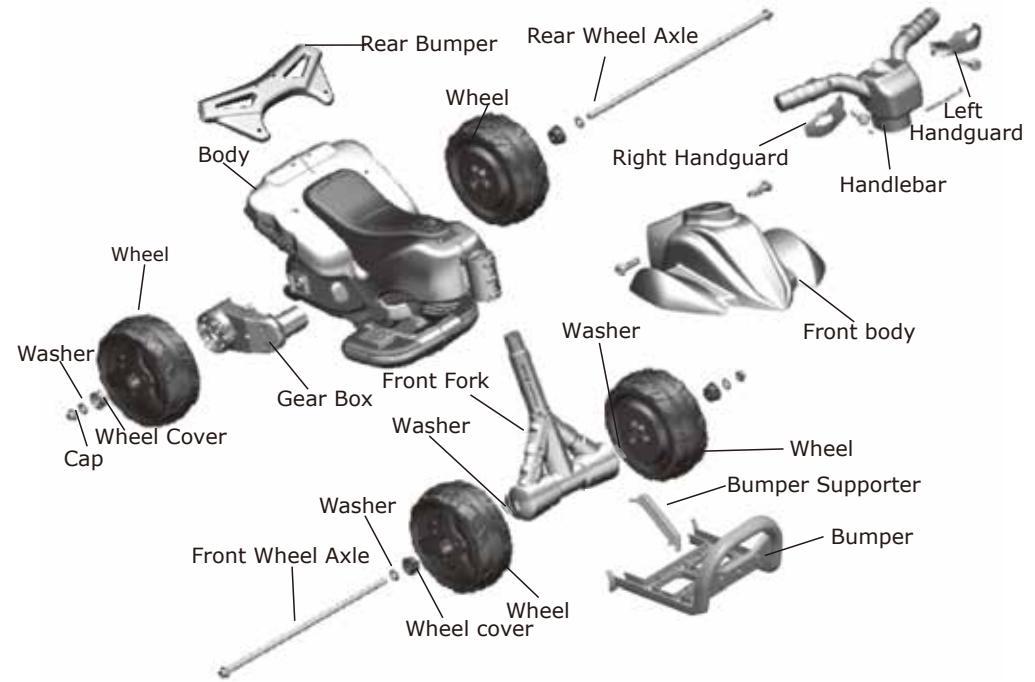

1.	—	Short axle for front wheel	1pc
2.	—	Long axle for rear wheel	1pc
3.		Cap	4pcs
4.		Wheel	4pcs
5.		Washer	6pcs
6.		Front Body	1pc
7.		Handlebar	1pc
8.		Sleeve	1pc
9.		Wheel Cover	4pcs
10.		Gearbox	1pc
11.		Front Fork	1pc
12.		Rear Bumper	1pc
13.		M5 nut	1pc
14.		Screw PM5x47	1pc
15.		Right handguard	1pc
16.		Left handguard	1pc
17.		Screw PA3.5x10	10pcs
18.		Body	1pc
19.		Bumper Supporter	1pc
20.		Bumper	1pc
21.		Screw PA3.5x14	1pc
22.		Charger	1pc

How to Assemble the Vehicle:

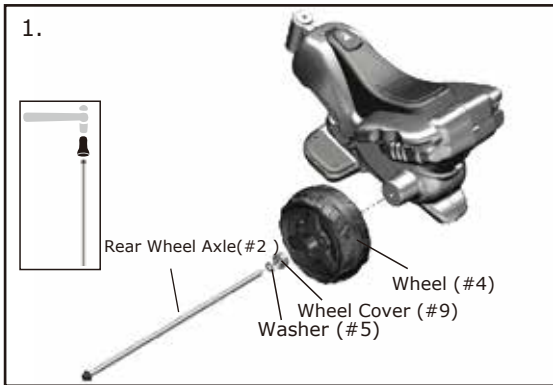

1. Attach cap (#3) on rear wheel axle (#2), then use sleeve (#8) and hammer (not included) to assemble the cap, then insert washer (#5), wheel cover (#9), wheel (#4) into the rear wheel axle (#2). Finally insert the rear wheel axle into the hole of the body.

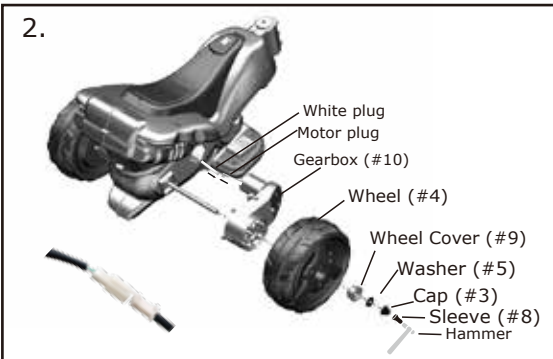

2. Connect the plug of the gearbox with the white plug on the car body. Insert the gearbox (#10), wheel (#4), wheel cover (#9) and washer (#5) into the rear wheel axle, then attach the cap (#3) on the axle and use sleeve (#8) and hammer (not included) to assemble it.

Mark: Please use 1-2 washers to adjust the space when necessary

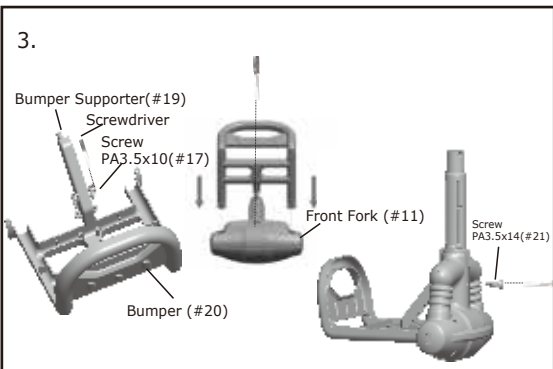

3. Attach the bumper supporter (#19) to the bumper (#20), insert 2pcs of PA3.5x10 screws (#17), then tighten with screwdriver (not included). Attach the bumper (#20) onto the front fork (#11). Finally insert 1pc of PA3.5x14 screw (#21) into the front fork, then tighten with screwdriver.

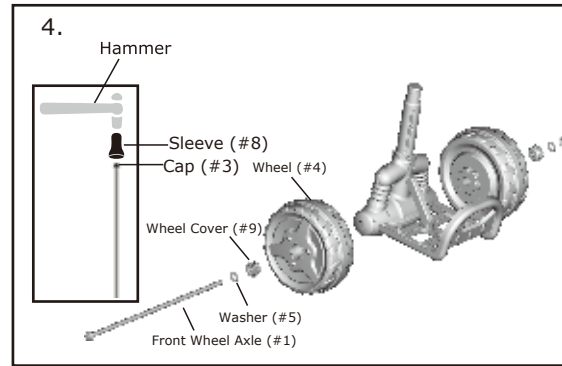

4. Attach the cap (#3) on the front wheel axle (#1), then use sleeve (#8) and hammer (not included) to assemble the cap.

Insert washer (#5), wheel cover (#9), wheel (#4) into the wheel axle, then insert the axle through the front fork. Insert wheel (#4), wheel cover (#9), washer (#5) into the other side of the wheel axle, then attach the cap (#3) by using sleeve (#8) and hammer.

Mark: Please use 1-2 washers to adjust the space when necessary



5. Insert the front fork assembly into the hole on the front of the body.

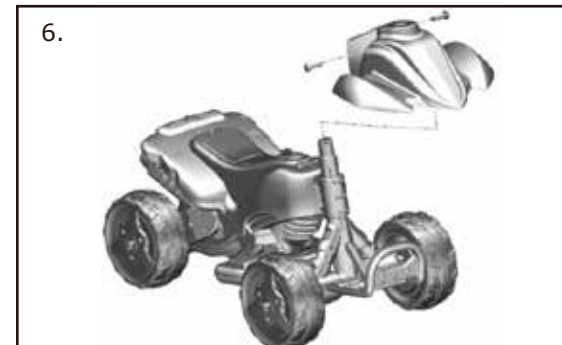

6. Position the front body (#6) to the body, then tighten with 2pcs of PA3.5x10 screws (#17).