

# SLR-16051 USB AROMA DIFFUSER

## IMPORTANT SAFETY INSTRUCTIONS:

The following safety precautions should always be followed, to reduce the risk of electric shock, personal injury or fire. It is important to read all of these instructions carefully before using the product, and to save them for future reference or new users.

1. This product must only be used as intended in accordance with the enclosed operating instructions.
2. Do not carry the appliance by the mains cable or pull the cable to remove the plug from the socket.
3. CAUTION: Electric shock hazard. The external flexible cable, plug or the switch of this luminaire cannot be replaced. If any of these parts are damaged, disconnect from mains power.
4. If the appliance stops unexpectedly or appears to malfunction, switch off the power supply, unplug from the mains and stop using immediately. Seek professional advice to rectify the fault or make repairs.
5. Switch off the power supply or unplug from the mains socket when not in use, before cleaning or changing accessories.
6. Avoid positioning the appliance where the power cable might be accidentally trapped or damaged.
7. Keep the appliance and cable away from sources of heat, sharp objects or anything that may cause damage.
8. Ensure the appliance is switched OFF before connecting the mains power supply.
9. Be aware that some surfaces may become hot. Do not touch hot surfaces and supervise others accordingly.
10. This product has not been designed for use by children.
11. Children should be closely supervised at all times when they are near any electrical appliance.
12. To protect against electric shock, never allow the appliance, the mains cable or plug to come into contact with water or any other liquid.
13. Never reach for any appliance that has fallen into water. Switch off the power supply at the mains immediately and unplug. Do not re-use until the product has been inspected and approved by a qualified electrician.
14. Always ensure that hands are dry before operating or adjusting any switch on the product or touching the plug and mains supply connections.
15. To disconnect, first ensure that all controls are in the OFF position, then remove the plug from the electricity supply.
16. Where relevant keep all ventilation slots, filters, etc. uncovered and clear of debris. Never drop or insert objects into the openings.
17. Do not use outdoors. This appliance has been designed for domestic indoors use only.

## Product specification

Input: DC 5V, 800mA (via USB)  
LED 0.6W Max

## INSTRUCTIONS FOR ASSEMBLY

1. Twist anticlockwise to open the cover.

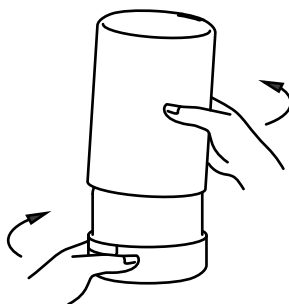

2. Pour suitable amount of water into the tank and make sure it is within the max. water level. Add approximately 6 drops of essential oils to the water.

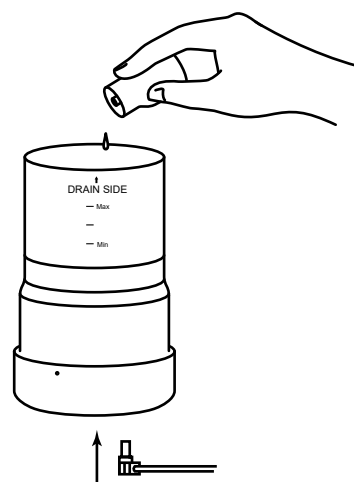

3. Connect the diffuser with the provided USB cable to a USB adaptor DC 5V, 800mA (not included).

4. To turn on, press the "Mist" button to the desired time: 30mins, 60mins, 120mins or 180mins.

5. To turn off, press and hold the "Mist" button for one second.

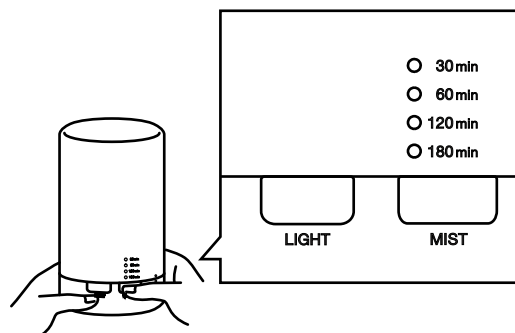

## Precaution

1. Do not use as medical respirator.
2. Do not use the product when there is an abnormal noise or the diffuser is overheating abnormally.
3. Do not cover or block the mist outlet or air inlet.
4. Do not use inferior essential oils. Use 100% pure essential oils.
5. Do not take off the cover during operation of the diffuser.
6. Do not place near an electrical device such as computer, TV or audio equipment.
7. Do not use hot water or mineral water. Always use tap water or distilled water.
8. Keep out reach of children or pets.

## Maintenance

To help ensure a long working life, please properly maintain the diffuser. It's necessary to maintain the diffuser as outlined below once it has been used 5 -6 times or for 2-3 consecutive days.

1. Disconnect the USB power from the diffuser base. Take off the cover while keeping the diffuser completely level.  
DO NOT tip from side to side.
2. If there's water left in the tank, pour it from the drain side.  
DO NOT pour from the air outlet side, as water may flow into the base of the diffuser.
3. Use a gentle diluted mild kitchen detergent on a damp cloth to remove any essential oil residue, ensuring no detergent remains.

**IMPORTANT:** DO NOT press heavily or scratch the ultrasonic mechanism in the water tank during cleaning.

4. Add water into the tank to Max level and set the timer for 30 minutes. After 30 minutes pour out remaining water and gently wipe clean the water tank.  
Please DO NOT use chlorine or acidic based detergents for cleaning outside or inside of the diffuser.  
Please use neutral detergents like diluted kitchen detergents.

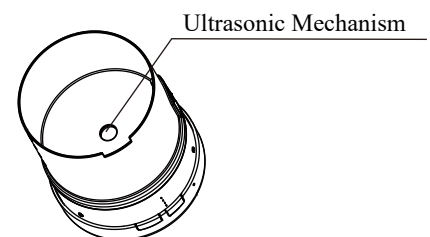
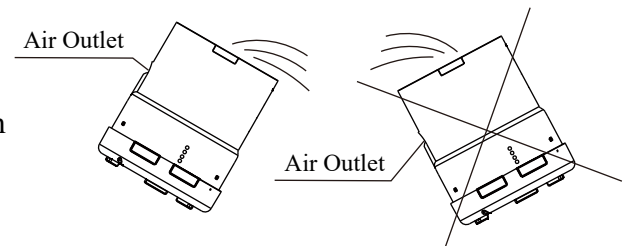
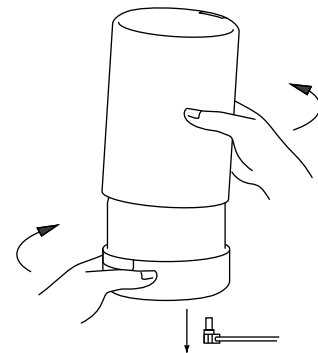

## 12 Month Warranty

Thank you for your purchase from Kmart.

Kmart Australia Ltd warrants your new product to be free from defects in materials and workmanship for the period stated above, from the date of purchase, provided that the product is used in accordance with accompanying recommendations or instructions where provided. This warranty is in addition to your rights under the Australian Consumer Law.

Kmart will provide you with your choice of a refund, repair or exchange (where possible) for this product if it becomes defective within the warranty period. Kmart will bear the reasonable expense of claiming the warranty. This warranty will no longer apply where the defect is a result of alteration, accident, misuse, abuse or neglect.

Please retain your receipt as proof of purchase and contact our Customer Service Centre on 1800 124 125 (Australia) or 0800 945 995 (New Zealand) or alternatively, via Customer Help at [Kmart.com.au](https://www.kmart.com.au) for any difficulties with your product. Warranty claims and claims for expense incurred in returning this product can be addressed to our Customer Service Centre at 690 Springvale Rd, Mulgrave Vic 3170.

Our goods come with guarantees that cannot be excluded under the Australian Consumer Law. You are entitled to a replacement or refund for a major failure and compensation for any other reasonably foreseeable loss or damage. You are also entitled to have the goods repaired or replaced if the goods fail to be of acceptable quality and the failure does not amount to a major failure.

For New Zealand customers, this warranty is in addition to statutory rights observed under New Zealand legislation.